

Arozzi AVANTI-SFB-PPL

Arozzi Avanti Soft Upholstery Fabric Ergonomic Office and Gaming Chair User Manual

Model: AVANTI-SFB-PPL

Brand: Arozzi

1. PRODUCT OVERVIEW

The Arozzi Avanti Soft Upholstery Fabric Ergonomic Office and Gaming Chair is designed to provide exceptional comfort and support for extended periods of use, whether for gaming or office work. It features Arozzi's signature ergonomic design, premium soft upholstery fabric, and a robust steel frame. Key functionalities include adjustable reclining, a rocking mechanism, and 3-dimensional adjustable armrests, ensuring a customizable and comfortable seating experience.





Image 1.1: Front view of the Arozzi Avanti Soft Upholstery Fabric Ergonomic Office and Gaming Chair.

2. SAFETY GUIDELINES

Please read and adhere to the following safety instructions to ensure safe operation and longevity of your Arozzi Avanti chair:

- Always follow the assembly instructions carefully.
- Do not exceed the maximum weight capacity of 265 lbs (120 kg).
- Be cautious when adjusting the lumbar support to avoid injury.
- Keep the chair away from heat sources to prevent damage to the materials.
- Always use the chair on a stable, hard floor surface.

3. PACKAGE CONTENTS

Before beginning assembly, please ensure all components are present and undamaged. If any parts are missing or damaged, contact Arozzi customer support.

- Chair Backrest
- Chair Seat
- Armrests (2)
- Star Base
- Casters (5)
- Gas Lift Cylinder
- Gas Lift Cover
- Mechanism Plate
- Headrest Pillow
- Assembly Hardware (screws, washers, etc.)
- Assembly Tools (Allen key)
- User Manual (this document)

4. ASSEMBLY GUIDE

Follow these general steps to assemble your Arozzi Avanti chair. Refer to the detailed assembly instructions included in your package for specific diagrams and hardware details.

1. **Attach Casters to Base:** Insert the five casters firmly into the holes at the end of each leg of the star base until they click into place.
2. **Insert Gas Lift:** Place the gas lift cylinder into the center hole of the star base. Cover it with the gas lift cover.
3. **Attach Armrests to Seat:** Secure the armrests to the underside of the chair seat using the provided screws and assembly tools. Ensure they are oriented correctly.
4. **Attach Mechanism Plate:** Fasten the mechanism plate to the underside of the chair seat, aligning it with the pre-drilled holes. Ensure the front of the mechanism faces the front of the seat.
5. **Attach Backrest to Seat:** Connect the backrest to the seat assembly using the side brackets and screws. Tighten all connections securely.
6. **Connect Seat to Base:** Carefully place the assembled seat and backrest onto the gas lift cylinder, ensuring the mechanism plate's center hole aligns with the top of the gas lift. Press down firmly to secure.
7. **Attach Headrest Pillow:** Position the headrest pillow as desired on the backrest.

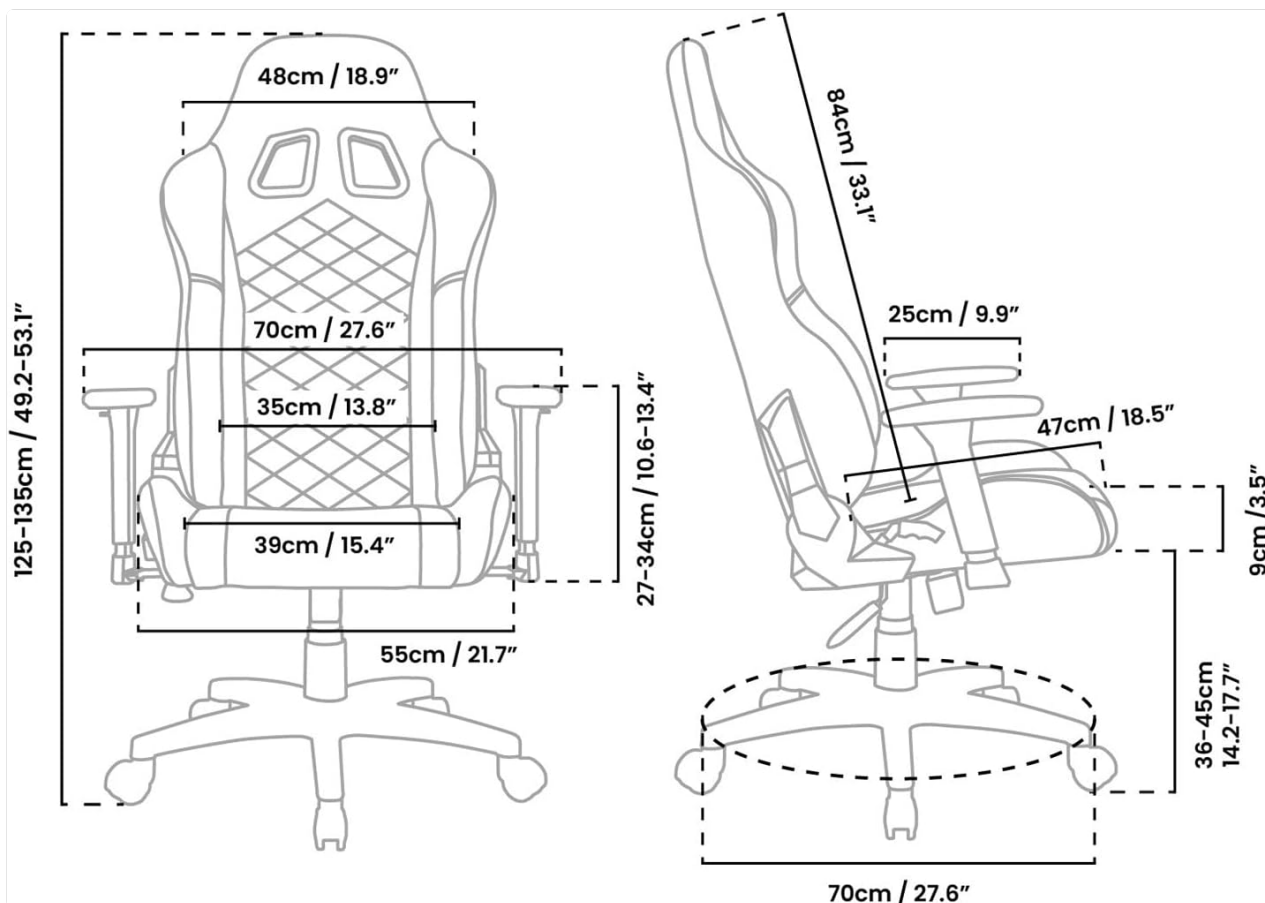

Image 4.1: Front view of the fully assembled Arozzi Avanti chair.

5. OPERATING INSTRUCTIONS AND ADJUSTMENTS

Your Arozzi Avanti chair offers several adjustment options to optimize your comfort and posture.

- **Height Adjustment:** Use the lever located on the right side, beneath the seat, to adjust the chair's height. Pull the lever up while seated to lower, or pull up while standing to raise. Release the lever to lock the height.
- **Reclining Backrest:** The backrest can be reclined up to 165 degrees. Use the lever on the left side of the seat to unlock the recline. Lean back to your desired angle and push the lever down to lock it in place.
- **Rocking Function:** The chair features a rocking function that tilts the seat and backrest up to 12 degrees. This function can be activated or deactivated using the knob or lever under the seat (consult specific assembly manual for exact control).
- **3-Dimensional Adjustable Armrests:** The armrests can be adjusted in three dimensions: height, forward/backward, and pivot (left/right rotation). Use the buttons or levers on the armrests to unlock and adjust them to your preferred position.
- **Adjustable Headrest Pillow:** The headrest pillow can be moved up or down along the backrest straps to provide optimal neck and head support.



Image 5.1: Key features and adjustable components of the Arozzi Avanti chair.

6. CARE AND MAINTENANCE

Proper care will extend the life and maintain the appearance of your Arozzi Avanti chair.

- **Cleaning:** For general cleaning, spot clean the fabric upholstery with a damp cloth and mild soap. Wipe clean the PU leather back and plastic/metal parts with a soft, dry cloth. Avoid abrasive cleaners or harsh chemicals.
- **Spills:** Immediately blot any spills with a clean, dry cloth to prevent staining.
- **Inspection:** Periodically check all screws and bolts to ensure they are tight. Re-tighten if necessary to maintain stability and prevent squeaking.
- **Environment:** Avoid prolonged exposure to direct sunlight or extreme temperatures, which can cause fading or material degradation.

7. TROUBLESHOOTING

If you encounter any issues with your Arozzi Avanti chair, refer to the following common troubleshooting tips:

- **Chair Squeaks:** Check and tighten all assembly screws, especially those connecting the seat, backrest, and mechanism. A small amount of silicone lubricant can be applied to moving parts if the squeaking persists.
- **Chair Does Not Adjust Height:** Ensure the gas lift lever is fully engaged. If the issue persists, the gas lift cylinder may need replacement.
- **Chair Feels Unstable/Wobbly:** Verify that all casters are securely inserted into the base and that the gas lift is properly seated. Check all frame connections for tightness.
- **Armrests Are Loose:** Tighten the screws securing the armrests to the seat.

For issues not covered here, please contact Arozzi customer support.

8. TECHNICAL SPECIFICATIONS

Detailed specifications for the Arozzi Avanti Soft Upholstery Fabric Ergonomic Office and Gaming Chair:

Model Name	Arozzi Avanti Soft Fabric Chair
Item Model Number	AVANTI-SFB-PPL
Color	Purple
Product Dimensions (D x W x H)	27.6"D x 21.65"W x 54.3"H (70cm D x 55cm W x 138cm H)
Maximum Weight Recommendation	265 Pounds (120 kg)
Back Style	Solid Back
Special Features	Adjustable Backrest, Adjustable Headrest, Adjustable Height, Arm Rest, Ergonomic
Reclining Position Count	2 (up to 165°)
Tilting Function	Yes (up to 12°)
Arm Style	3D Adjustable
Fill Material	Cold Curred Molded Foam
Upholstery Material	Soft Upholstery Fabric (front), PU Leather (back)
Frame Material	Robust Treated Durable Steel Frame
Item Weight	51.9 pounds (23.5 kg)
Manufacturer	Arozzi North America

UPC

850054766229





Image 8.1: Dimensional specifications of the Arozzi Avanti chair.





9. WARRANTY AND SUPPORT

Arozzi stands behind the quality of its products. For specific warranty information, including terms and conditions, please refer to the warranty card included with your product or visit the official Arozzi website.

For customer support, technical assistance, or to inquire about replacement parts, please contact Arozzi North America directly. You can find contact information on the official Arozzi website or through your point of purchase.

Visit the official Arozzi Store for more information:[Arozzi Amazon Store](#)

Related Documents - AVANTI-SFB-PPL

<p>AVANTI</p>  <p><small>© Arozzi 2024</small></p> 	<p>Arozzi AVANTI Gaming Chair Assembly Guide</p> <p>Comprehensive assembly instructions for the Arozzi AVANTI gaming chair, detailing each step with clear descriptions and safety information. Includes support links and product details.</p>
<p>TORRETTA</p>  <p><small>© Arozzi 2024</small></p> 	<p>Arozzi Torretta Gaming Chair Assembly Guide</p> <p>Step-by-step assembly instructions for the Arozzi Torretta gaming chair, including safety precautions and support information.</p>



[Arozzi Verona V2 Pro, Verona V2, Vernazza, Mezzo Gaming Chair Assembly Instructions](#)

Comprehensive assembly guide for Arozzi Verona V2 Pro, Verona V2, Vernazza, and Mezzo gaming chairs. Includes step-by-step instructions, safety precautions, and parts list.



[Arozzi Vernazza, Mezzo, Verona Gaming Chair Assembly Instructions](#)

Step-by-step assembly guide for Arozzi Vernazza, Mezzo, and Verona family gaming chairs. Includes safety warnings, part identification, and assembly steps with visual aids described in text.



[Arozzi Alzare Neo Duo Dual Monitor Arm Installation Guide](#)

User manual for the Arozzi Alzare Neo Duo dual monitor arm, detailing installation, assembly, and adjustment procedures for dual monitor setups.



[Arozzi Gaming Chair Comparison Chart - Features and Specifications](#)

Compare detailed specifications and features of Arozzi gaming chairs including Vernazza, Torretta, Avanti, and Enzo models. Find the perfect chair based on upholstery, support, dimensions, weight capacity, and more.