

Manuals.plus /

› Bene Casa /

› Bene Casa Portable Butane Burner BC-99473 Instruction Manual

Bene Casa BC-99473

Bene Casa Portable Butane Burner BC-99473 Instruction Manual

Model: BC-99473 | Brand: Bene Casa

1. INTRODUCTION

This manual provides essential instructions for the safe and efficient use of your Bene Casa Portable Butane Burner, Model BC-99473. This portable burner is designed for outdoor cooking, offering 7,650 BTU of heat output, adjustable flame control, and integrated safety features. Please read this manual thoroughly before operation to ensure proper setup, use, and maintenance.



Image 1.1: Front view of the Bene Casa Portable Butane Burner.

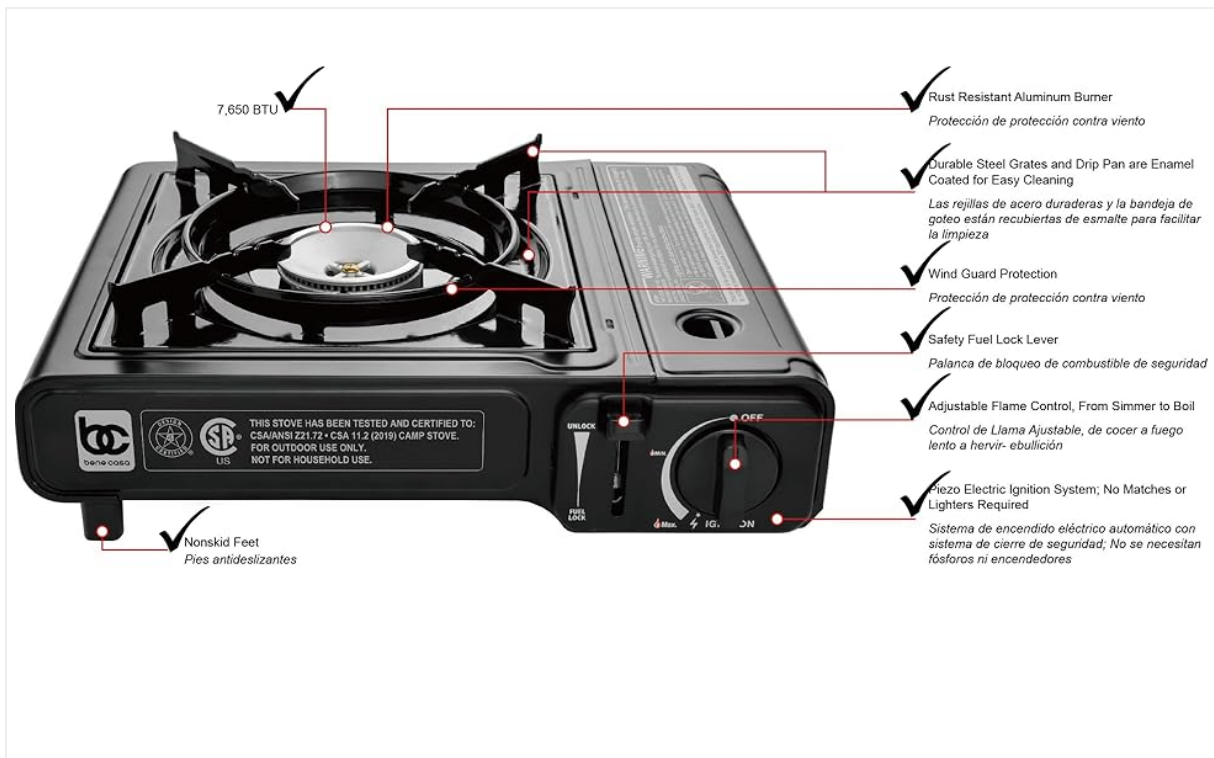

Image 1.2: The portable butane burner is suitable for various outdoor activities including camping, fishing, and emergency preparedness.

2. IMPORTANT SAFETY INFORMATION

WARNING: FOR OUTDOOR USE ONLY. DO NOT USE INDOORS OR IN ENCLOSED SPACES. IMPROPER USE CAN RESULT IN CARBON MONOXIDE POISONING, INJURY, OR DEATH.

- Read all instructions before operating the appliance.
- Keep children and pets away from the burner during operation.
- Use only 8-ounce butane fuel canisters. Do not use other fuel types.
- Ensure adequate ventilation when operating.
- Do not store or use gasoline or other flammable vapors and liquids in the vicinity of this or any other appliance.
- Always place the burner on a stable, level, non-combustible surface.
- Do not leave the operating burner unattended.
- Allow the burner to cool completely before handling or storing.

The Bene Casa Portable Butane Burner is equipped with advanced safety features:

- **Built-in Pressure Sensor:** Detects abnormal pressure and activates the auto shutoff.
- **Auto Shutoff Mechanism:** Automatically turns off the gas supply if pressure becomes too high.
- **Safety Lock:** Prevents accidental ignition and ensures the fuel canister is properly seated.



Image 2.1: Internal view of the burner's safety mechanism, including the pressure sensor and auto shutoff device.

3. PRODUCT COMPONENTS

Familiarize yourself with the main parts of your Bene Casa Portable Butane Burner:



Image 3.1: Labeled diagram of the portable butane burner components.

- **Burner Head:** The central component where the flame is produced. Made of rust-resistant aluminum.
- **Pot Support / Grates:** Durable steel grates with an enamel coating for easy cleaning, designed to hold cookware.
- **Wind Guard:** Integrated protection to maintain a consistent flame in windy conditions.
- **Fuel Compartment:** Area for inserting the butane fuel canister.

- **Fuel Lock Lever:** Secures the butane canister in place.
- **Ignition Knob:** Controls gas flow and activates the piezo electric ignition.
- **Adjustable Flame Control:** Allows precise adjustment of flame intensity.
- **Non-Skid Feet:** Provides stability during use.
- **Carrying Case:** A durable plastic case for transport and storage.

4. SETUP INSTRUCTIONS

Follow these steps to prepare your burner for use:

1. **Unpack:** Remove the burner from its carrying case and all packaging materials.
2. **Placement:** Place the burner on a firm, level, non-combustible surface outdoors, away from any flammable materials, structures, or obstructions. Ensure there is adequate clearance above and around the burner.
3. **Open Fuel Compartment:** Open the fuel compartment cover located on the side of the burner.
4. **Insert Butane Canister:** Align the collar of an 8-ounce butane fuel canister with the nozzle connector inside the fuel compartment. Push the canister firmly into place.
5. **Secure Canister:** Push the fuel lock lever down to the "LOCK" position. This will secure the canister and connect it to the burner's gas line. Ensure the canister is securely locked before proceeding.
6. **Close Cover:** Close the fuel compartment cover.



Image 4.1: Proper insertion and locking of the butane fuel canister.

5. OPERATING INSTRUCTIONS

Once the burner is set up and the fuel canister is installed, follow these steps to operate:

1. **Ignition:** Turn the ignition knob counter-clockwise to the "IGNITE" position. You will hear a click as the piezo electric igniter sparks, lighting the gas. If the burner does not ignite on the first attempt, turn the knob back to "OFF" and try again.

2. **Adjust Flame:** Once ignited, continue turning the knob counter-clockwise to increase the flame intensity (towards "MAX") or clockwise to decrease it (towards "MIN"). Adjust the flame to your desired cooking level.
3. **Cooking:** Place your cookware on the pot support grates and begin cooking. The integrated wind guard helps maintain a consistent flame.
4. **Turn Off:** To turn off the burner, turn the ignition knob clockwise until it clicks into the "OFF" position. Ensure the flame is completely extinguished.
5. **Remove Canister (After Cooling):** After the burner has completely cooled down, push the fuel lock lever up to the "UNLOCK" position and remove the butane fuel canister. Store the canister and burner separately in a cool, dry place.

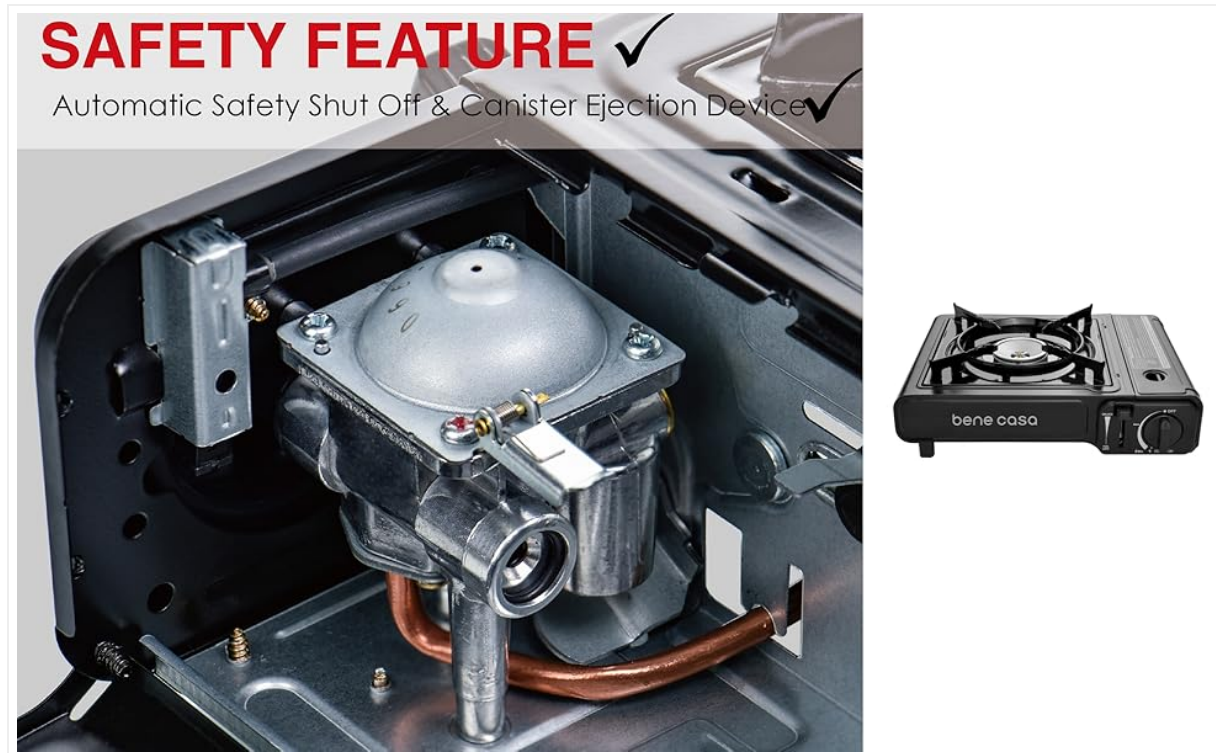

Image 5.1: The burner in operation, demonstrating its ease of use for outdoor cooking.

6. MAINTENANCE AND CARE

Proper maintenance ensures the longevity and safe operation of your burner:

- **Cleaning:** After each use, ensure the burner is completely cool. Wipe down the exterior surfaces with a damp cloth. The enamel-coated pot support grates can be removed for easier cleaning. Do not use abrasive cleaners or harsh chemicals.
- **Storage:** Always remove the butane fuel canister before storing. Store the burner in its carrying case in a cool, dry, well-ventilated area, away from direct sunlight and heat sources.
- **Inspection:** Periodically inspect the burner for any signs of damage, wear, or gas leaks. If any damage is found, do not use the burner and contact customer support.

7. TROUBLESHOOTING

Refer to the table below for common issues and their solutions:

Problem	Possible Cause	Solution
Burner does not ignite.	<ul style="list-style-type: none"> Fuel canister not properly installed or locked. Fuel canister is empty. Ignition knob not turned to "IGNITE" position. Igniter is dirty or damaged. 	<ul style="list-style-type: none"> Ensure fuel lock lever is in "LOCK" position. Replace with a new butane canister. Turn knob fully to "IGNITE" and listen for click. Clean igniter area or contact support.
Weak or inconsistent flame.	<ul style="list-style-type: none"> Low fuel in canister. Gas flow partially obstructed. Wind interference (despite wind guard). 	<ul style="list-style-type: none"> Replace fuel canister. Ensure no debris is blocking gas ports. Relocate burner to a more sheltered area.
Smell of gas without flame.	<ul style="list-style-type: none"> Gas leak. Canister not properly sealed. 	<ul style="list-style-type: none"> Immediately turn off burner and remove canister. Check canister connection. If smell persists, do not use and contact support.

8. TECHNICAL SPECIFICATIONS

Feature	Detail
Model Number	BC-99473
Heat Output	7,650 BTU
Fuel Type	Butane (8-ounce canisters, not included)
Ignition Type	Piezo Electric
Material	Cast Iron, Metal
Product Dimensions (L x W x H)	13.4" x 11" x 4.3" (34 cm x 27.9 cm x 10.9 cm)
Item Weight	5 Pounds (2.27 kg)
Special Features	Wind Guard Protection, Safety Lock, Piezo Electric Ignition, Adjustable Flame Control, Portable Carrying Case
UPC	037005994737



bene casa

Designed to inspire

Butane Burner BC-99473



DIMENSIONS:
14" x 12" x 4"



DIMENSIONS:
13.4" x 11" x 4.3"
WEIGHT: 3.5 LBS



Connect with us @ClubBeneCasa
www.BeneCasa.com

Image 8.1: Dimensions of the burner and its included carrying case.

9. WARRANTY INFORMATION

For specific warranty details regarding your Bene Casa Portable Butane Burner, please refer to the warranty card included with your purchase or visit the official Bene Casa website. Keep your proof of purchase for any warranty claims.

10. CUSTOMER SUPPORT

If you have any questions, require assistance, or need to report an issue with your Bene Casa Portable Butane Burner, please contact Bene Casa customer support. Refer to the contact information provided in your product packaging or on the official Bene Casa website for the most current support options.