

FORTSTRONG 3ff42248-c128-4d24-8f50-e7a20369a35b

Fortstrong Mechanical Keyless Entry Door Lock User Manual

Model: 3ff42248-c128-4d24-8f50-e7a20369a35b

1. INTRODUCTION

Thank you for choosing the Fortstrong Mechanical Keyless Entry Door Lock. This manual provides essential information for the proper installation, operation, and maintenance of your new door lock. Please read these instructions carefully before installation and retain them for future reference to ensure optimal performance and security.

This mechanical lock offers a reliable and convenient keyless entry solution, designed for durability and ease of use without the need for batteries or external power.

2. SAFETY INFORMATION

- Always handle components with care to prevent damage.
- Ensure all screws are tightened securely during installation to prevent loosening over time.
- Do not attempt to modify the lock's internal mechanism, as this may compromise its security and void the warranty.
- Keep the combination code confidential and do not share it with unauthorized individuals.
- Regularly inspect the lock for any signs of wear or damage.

3. PACKAGE CONTENTS

Verify that all components listed below are present in your package:

- 1 x Mechanical Combination Lock (Front and Rear Assemblies)
- 2 x Neoprene Seals
- 1 x Spindle
- 1 x Latch Mechanism
- 1 x Strike Plate

- 4 x Wood Screws
- 2 x Fixing Bolts
- 1 x Installation Guide (Life-size template included)

INCLUDES

1 x Mechanical combination lock; 2 x Neoprene seals; 4 x Screws; 1 x Guide



Image: All components of the Fortstrong Mechanical Keyless Entry Door Lock, including the front and rear lock assemblies, neoprene seals, spindle, latch, strike plate, screws, and installation guide.

4. FEATURES OVERVIEW

- **Convenient Keyless Entry:** Eliminates the need for physical keys. Access is granted by entering a unique 4 to 6-digit password on the combination panel.
- **Reliable and Durable Construction:** Crafted from sturdy zinc alloy, designed for long-term performance. Neoprene seals provide sun-proof and waterproof protection, enhancing longevity.
- **Energy Efficient:** Operates entirely mechanically, requiring no batteries or electrical wiring. This makes it an eco-friendly and cost-effective security solution.
- **Versatile Installation:** Compatible with doors that open to either the left or right, ensuring broad applicability.



ALL-WEATHER RELIABILITY

Can easily withstand extreme conditions

Image: The lock's robust design ensures functionality in diverse weather conditions, from snow to rain and sun.

VERSATILE LOCKING SYSTEM

Adaptable for any door,
with right or left
orientation

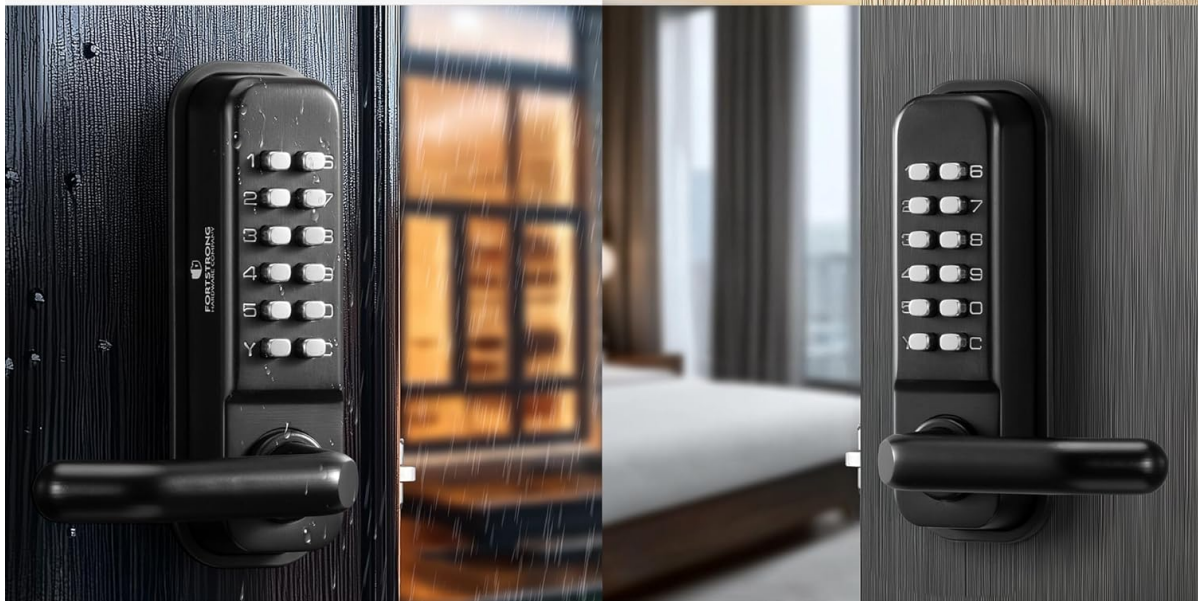

Image: The lock is adaptable for various door types and orientations, including left or right opening doors.

5. SETUP AND INSTALLATION

Installation of the Fortstrong Mechanical Keyless Entry Door Lock is designed to be straightforward. A detailed installation guide and a life-size template are included in your package to assist you. Follow these general steps:

1. **Prepare the Door:** Use the provided life-size template to mark and drill holes on your door if necessary. Ensure the door thickness is compatible with the lock.
2. **Install the Latch:** Insert the latch mechanism into the edge of the door and secure it with screws.
3. **Install Neoprene Seals:** Place the neoprene seals on both sides of the door, aligning them with the drilled holes. These seals provide weather protection.
4. **Assemble Lock Components:** Insert the spindle through the latch and align the front and rear lock assemblies. Secure them using the fixing bolts.
5. **Install Strike Plate:** Attach the strike plate to the door frame, ensuring it aligns correctly with the latch.
6. **Test Operation:** After installation, test the lock's functionality to ensure smooth operation and proper locking.

For detailed, step-by-step instructions, refer to the dedicated installation guide included in your package.

EASY & QUICK INSTALLATION

Straightforward setup for effortless security

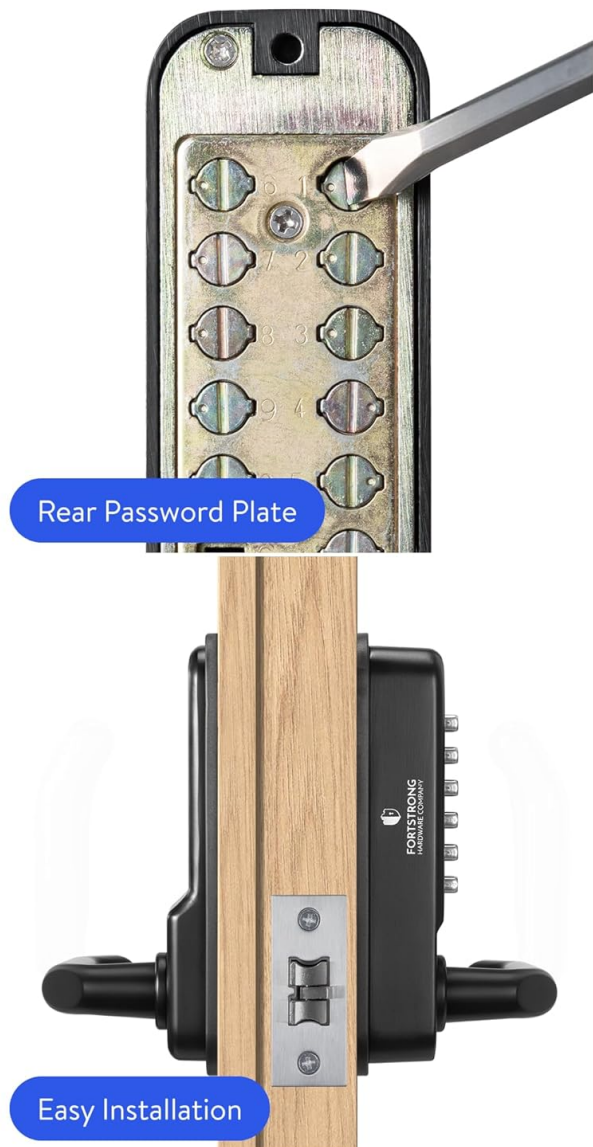

Image: Visual guide highlighting the rear password plate and the ease of installation for the lock.

6. OPERATING INSTRUCTIONS

6.1. Setting or Changing the Combination Code

The combination code can be set or changed using a flathead screwdriver on the rear password plate. Refer to the specific instructions in your installation guide for the exact procedure, as it involves adjusting internal pins corresponding to your desired code.

6.2. Using the Combination Code for Entry

1. Ensure the door is closed and the lock is engaged.
2. Press the buttons corresponding to your 4 to 6-digit combination code in the correct sequence.
3. Turn the handle to retract the latch and open the door.
4. Release the handle, and the lock will automatically re-engage when the door is closed.

SECURE KEYLESS ENTRY FOR ANY DOOR

Effortless access with a 4-6 digit code

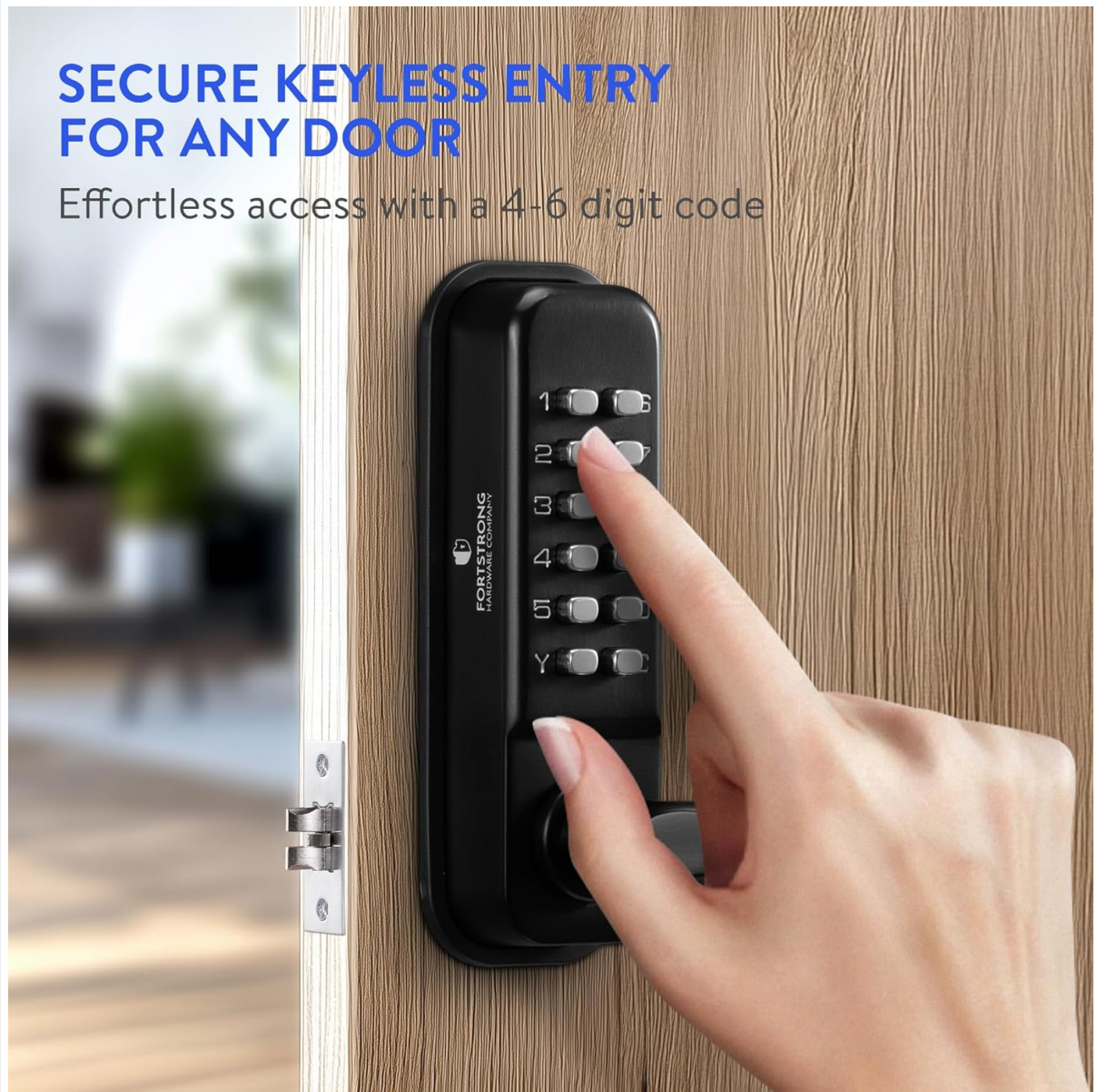

Image: A user entering the combination code on the lock's keypad for keyless entry.

7. MAINTENANCE

To ensure the longevity and smooth operation of your Fortstrong Mechanical Keyless Entry Door Lock, follow these maintenance guidelines:

- **Cleaning:** Wipe the exterior of the lock with a soft, damp cloth. Avoid abrasive cleaners or solvents that could damage the finish or internal components.
- **Lubrication:** Periodically apply a small amount of graphite-based lubricant to the latch mechanism and spindle to ensure smooth movement. Do not use oil-based lubricants, as they can attract dust and debris.
- **Inspection:** Regularly check all screws and bolts for tightness. Ensure the neoprene seals are intact and providing adequate weather protection.
- **Code Integrity:** If the code becomes difficult to enter or buttons stick, inspect for debris. If issues persist, refer to the troubleshooting section or contact support.

8. TROUBLESHOOTING

If you encounter issues with your Fortstrong Mechanical Keyless Entry Door Lock, consult the following table:

Problem	Possible Cause	Solution
Lock does not open after entering code.	Incorrect code entered; internal mechanism obstruction; worn components.	Verify the code. Check for debris in buttons. Re-enter code carefully. If issue persists, re-set the code.
Handle is stiff or difficult to turn.	Lack of lubrication; debris in mechanism; misaligned installation.	Apply graphite lubricant to the spindle and latch. Clean any visible debris. Check installation alignment.
Lock does not engage automatically.	Latch mechanism obstruction; strike plate misalignment.	Clear any obstructions around the latch. Adjust the strike plate position if necessary.
Buttons are sticking.	Dirt or debris under buttons; internal spring issue.	Attempt to clean around the buttons. If persistent, contact customer support.

9. SPECIFICATIONS

Feature	Detail
Brand	FORTSTRONG
Model Number	3ff42248-c128-4d24-8f50-e7a20369a35b
Lock Type	Mechanical Combination Lock
Material	Zinc Alloy (body), Stainless Steel (internal components)
Color	Black
Dimensions (L x W x H)	5.59 x 1.65 x 1.73 inches
Item Weight	3.05 pounds (1.39 Kilograms)
Control Method	Mechanical Push Button
Batteries Required	No
UPC	810164662163

10. WARRANTY AND SUPPORT

For warranty information or technical support, please refer to the contact details provided with your purchase documentation or visit the official Fortstrong website. Keep your proof of purchase for any warranty claims.