

BIYTC 230W

BIYTC 230W Laptop Charger Instruction Manual

Model: 230W

1. INTRODUCTION

Thank you for choosing the BIYTC 230W Laptop Charger. This power adapter is designed to provide efficient and reliable power to compatible Acer Predator Helios 300, Nitro 5, and Triton series gaming laptops. This manual provides essential information for safe and proper use, installation, maintenance, and troubleshooting.



Image 1.1: Overview of the BIYTC 230W Laptop Charger connected to a laptop.

2. SAFETY INFORMATION

Please read and follow these safety guidelines to prevent damage to the product or injury to yourself.

- Use only with compatible devices as specified in this manual.
- Do not expose the charger to water, moisture, or extreme temperatures.
- Avoid dropping or subjecting the charger to severe impacts.
- Do not attempt to disassemble or modify the charger. This will void the warranty and may cause electrical hazards.
- Ensure the power outlet is easily accessible and properly grounded.
- Disconnect the charger from the power outlet during lightning storms or when unused for extended periods.
- Keep the charger away from heat sources and ensure adequate ventilation to prevent overheating.

3. PACKAGE CONTENTS

Verify that all items are present in the package:

- 1x BIYTC 230W Laptop Charger Adapter
- 1x AC Power Supply Cord



Image 3.1: The BIYTC 230W laptop charger adapter and its accompanying AC power cord.

4. COMPATIBILITY

This 230W charger is compatible with various Acer gaming laptop models. It also supports 180W power delivery for compatible devices.

Compatible Acer Models:

- **Predator Helios 300 Series:** PH315-53-72XD, PH315-53-781R, PH315-53-7426, PH315-53-71HN, PH315-53-71QX, PH315-53-71VG, PH315-54-760S, PH315-54-714U, PH315-54-74FG, PH315-55
- **Nitro 5 Series:** AN16-51, AN17-71, AN517-4216
- **Predator Triton Series:** 300, 500, 15 Neo 16, PHN16-71

Important: Confirm the DC plug size of your laptop. This charger features a 5.5mm * 1.7mm round connector. Incompatible plug sizes will prevent proper connection and charging.



Image 4.1: Visual guide for confirming the correct DC plug size (5.5mm * 1.7mm).

PROFESSIONAL GRADE CHIP DESIGN

Compliance With Top Industry Standards

VOLTS	AMPS	WATTS	COMPATIBLE
19V	7.1A	135W	YES ✔
19.5V	9.23A	180W	YES ✔
19.5V	11.8A	230W	YES ✔

Image 4.2: Technical specifications and compatibility overview for different voltage, amperage, and wattage outputs.

5. SPECIFICATIONS

Detailed technical specifications for the BIYTC 230W Laptop Charger:

Feature	Specification
Output Voltage	19.5V
Output Current	11.8A
Output Wattage	230W (180W compatible)
DC Plug Size	5.5mm * 1.7mm (Round Connector)
Product Dimensions	5 x 3 x 3 inches (Adapter block)
Item Weight	1.43 pounds (0.65 kg)
Cooling Method	Air
Cable Length (Adapter to DC Plug)	Approximately 4.5 FT
Cable Length (AC Power Cord)	Approximately 3.9 FT



6. SETUP

Follow these steps to set up your BIYTC 230W Laptop Charger:

1. **Connect the AC Power Cord:** Insert the 3-pin connector of the AC power cord firmly into the corresponding port on the charger adapter.
2. **Connect to Power Outlet:** Plug the other end of the AC power cord into a standard, grounded wall outlet.
3. **Connect to Laptop:** Carefully insert the DC plug (5.5mm * 1.7mm) from the charger adapter into the power input port on your compatible Acer laptop. Ensure a secure connection.

Once connected, your laptop should begin charging, and an indicator light on your laptop (if present) may illuminate.



Image 6.1: Close-up views of the charger components, including the AC input and DC output connections.

7. OPERATING INSTRUCTIONS

The BIYTC 230W Laptop Charger operates automatically once connected. It provides power to your laptop and charges its internal battery.

- **Charging Indication:** Refer to your laptop's user manual for specific charging indicators (e.g., LED lights, on-screen battery icon).
- **Optimal Performance:** For optimal performance, ensure the charger is placed in a well-ventilated area, away from direct sunlight or heat sources.
- **Protection Features:** The charger incorporates multiple protection mechanisms including over-current,

short-circuit, over-voltage, and over-temperature protection to safeguard your devices.

Protect Your Devices While Charging



Image 7.1: Diagram illustrating the internal protection features of the charger, including over-current, short-circuit, over-voltage, and over-temperature protection.

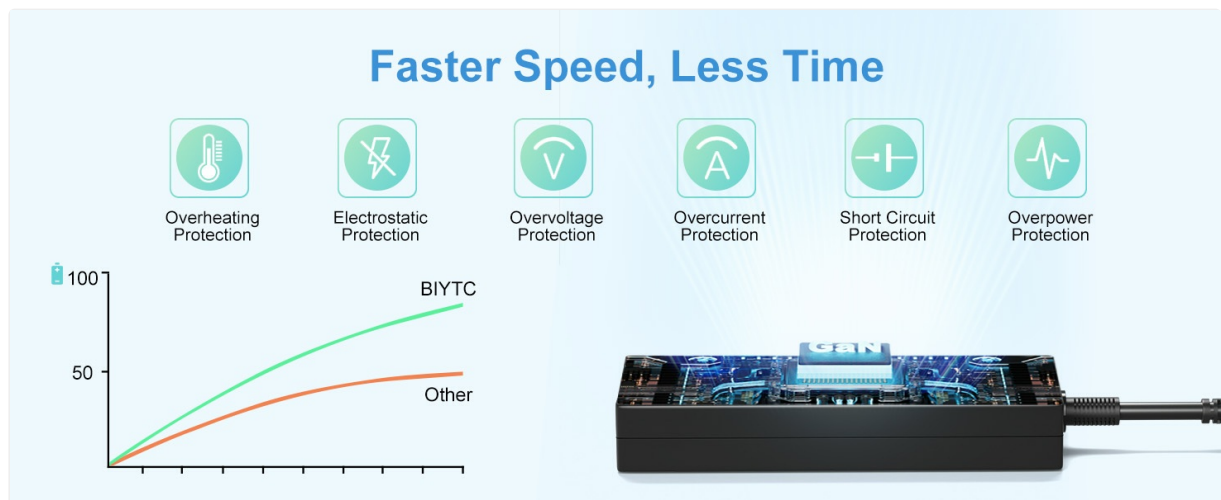

Image 7.2: Overview of the charger's protection features and charging efficiency compared to other chargers.

8. MAINTENANCE

Proper maintenance ensures the longevity and optimal performance of your charger:

- **Cleaning:** Disconnect the charger from all power sources before cleaning. Use a soft, dry cloth to wipe the adapter and cables. Do not use liquid cleaners or solvents.
- **Cable Care:** Avoid sharp bends, twists, or excessive pulling on the cables. Store cables neatly to prevent tangling and damage.
- **Storage:** When not in use, store the charger in a cool, dry place, away from direct sunlight and extreme temperatures.

ULTRA-DURABLE FAST CHARGING CABLE

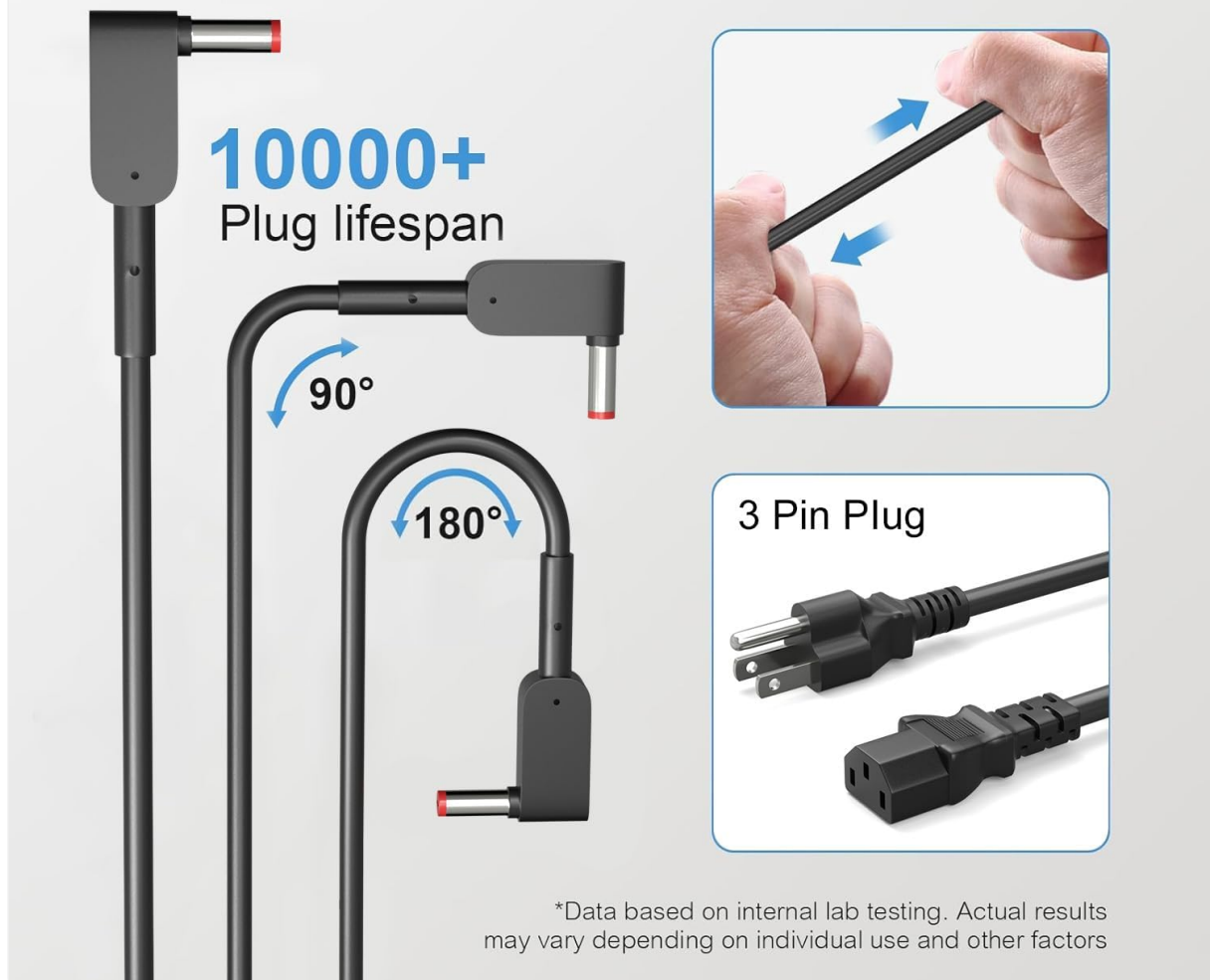

Image 8.1: Illustration of the durable and flexible design of the charging cable, highlighting its lifespan and bend resistance.



Image 8.2: Detailed view of the cable's construction, including pure copper core and protective layers for durability and efficient transmission.

9. TROUBLESHOOTING

If you encounter issues with your charger, refer to the following common problems and solutions:

Problem	Possible Cause	Solution
Laptop not charging	<ul style="list-style-type: none"> Loose connection Incorrect DC plug size Faulty power outlet Charger or laptop issue 	<ul style="list-style-type: none"> Ensure all connections (AC cord to adapter, adapter to wall, DC plug to laptop) are secure. Verify your laptop's DC input matches the charger's 5.5mm * 1.7mm plug. Test the power outlet with another device. Try a different compatible charger if available to isolate the problem.
Charger feels hot	<ul style="list-style-type: none"> Normal operation under load Poor ventilation Overload 	<ul style="list-style-type: none"> It is normal for the charger to warm up during use, especially under heavy load. Ensure the charger is in a well-ventilated area, not covered by blankets or other materials. If excessively hot, disconnect immediately and contact support.
Intermittent charging	<ul style="list-style-type: none"> Loose connection Damaged cable/connector 	<ul style="list-style-type: none"> Check all connections for tightness. Inspect the cables and connectors for any visible damage. If damaged, discontinue use.

10. WARRANTY AND SUPPORT

For warranty information or technical support, please refer to the contact details provided with your purchase or visit the official BIYTC website. Keep your purchase receipt as proof of purchase for warranty claims.