

## Manuals+

[Q & A](#) | [Deep Search](#) | [Upload](#)

[manuals.plus](#) /

› [GeekTale](#) /

› [GeekTale Fingerprint Deadbolt, Fingerprint Door Knob, Smart Deadbolt Lock, Smart Door Lock, Twist to Lock&Unlock, Keyless Entry Door Lock with App, for Front Door, Garage, Easy Installation Black Round User Manual](#)

## GeekTale F08

# GeekTale Fingerprint Deadbolt User Manual

Model: F08  
Brand: GeekTale

## INTRODUCTION

This manual provides comprehensive instructions for the installation, operation, and maintenance of your GeekTale Fingerprint Deadbolt (Model F08). This smart deadbolt offers multiple unlocking methods including fingerprint, app control, and traditional key, ensuring convenience and security for your home or office.

Key features include:

- **Fingerprint Deadbolt:** 99.99% recognition accuracy, one-touch unlocking, supports up to 50 unique user profiles.
- **App Control:** Manage fingerprints, Bluetooth unlocking (within 10 meters), and review access logs. No subscription fees.
- **Remote Control:** Requires a separate gateway (sold separately) for remote smartphone unlocking and real-time status notifications.
- **Built-in Rechargeable Battery:** Up to 8 months of use on a 2-hour charge, with low-battery alerts and emergency USB power.
- **Universal Application:** Suitable for indoor and outdoor use (under covered entries for exterior doors). Constructed with durable aluminum alloy.

## SETUP AND INSTALLATION

Follow these steps for proper installation of your GeekTale Fingerprint Deadbolt. Ensure you have the necessary tools before beginning.

### 1. Prepare the Door

Verify your door's dimensions are compatible with the deadbolt. The door hole diameter should be 2-1/8 inches (54mm) and door thickness between 1-3/8 inches and 2-1/8 inches (35mm to 54mm). The backset can be 2-3/4 inches (70mm) or 2-3/8 inches (60mm). If your backset is 2-3/4 inches, pull out the face plate to extend.

# Easy to Install

Simple & Quick & Safe



Image: Door measurement guidelines for installation.

## 2. Install the Latch

Insert the latch into the door edge. Ensure it is oriented correctly for your door's swing. Secure it with the provided screws.

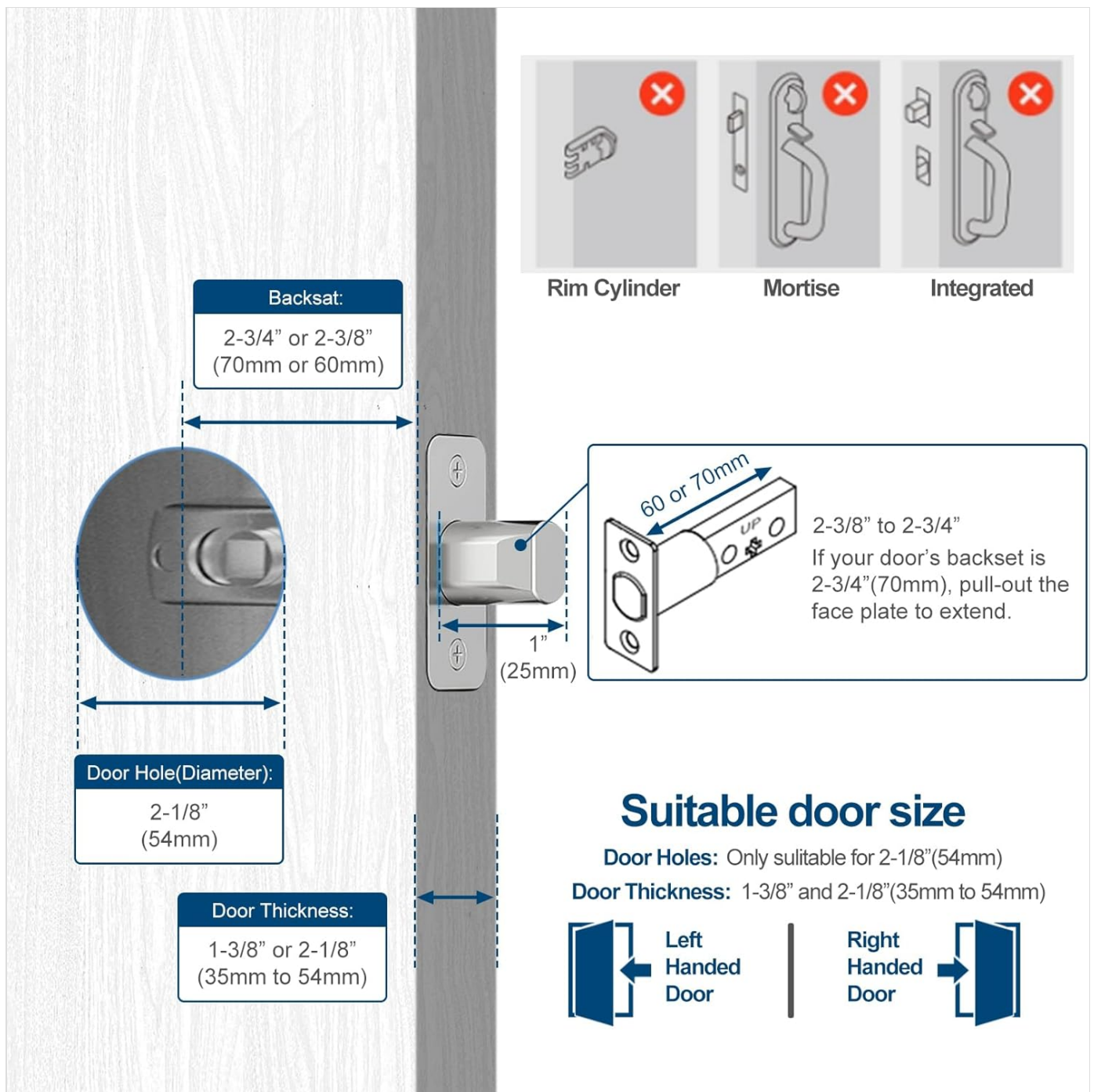

Image: Visual guide for installing the deadbolt latch.

### 3. Connect Wires and Assemble

Connect the internal and external components of the deadbolt, ensuring the wires are properly connected and tucked away. Secure the assembly with the provided screws.



*Image: The GeekTale Fingerprint Deadbolt installed on a door.*

## Installation Video Guide

Your browser does not support the video tag.

*Video: "F08 Deadbolt Lock-Installation Completed in Just 15 Minutes" - This video demonstrates the quick and easy installation process for the F08 deadbolt lock.*

## OPERATING INSTRUCTIONS

### 1. Fingerprint Unlock

The deadbolt features a highly accurate fingerprint scanner. Simply place your registered finger on the sensor for instant unlocking. The lock recognizes fingerprints in approximately 0.3 seconds.



# Fingerprint Quick Unlock



**0.3s**  
Recognize  
Speed

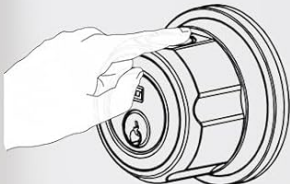

*Image: Demonstrates quick fingerprint recognition.*

To lock, simply twist the deadbolt knob after closing the door.

# Keyless Entry Deadbolt for Front Door

## Twist to Unlock



Fingerprint scan



Twist to unlock  
after scanning

## Twist to Lock

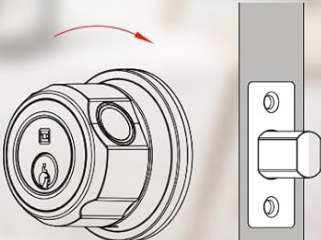

Twist to lock



*Image: Instructions for twisting to lock and unlock.*

## 2. App Control (Bluetooth)

Download the dedicated GeekTale app to manage your lock. Within 10 meters, you can use Bluetooth to unlock the door, add or delete fingerprints, and review a detailed log of all entries and exits.



# Smart App to Manage



Manage users



Bluetooth unlock



Check unlock records



Remote unlock

## Remote Unlock with Gateway



Gateway  
Need to purchase separately



Image: Overview of smart app management features.

Your browser does not support the video tag.

Video: "How to connect the app for control and add fingerprints" - This video guides you through connecting the lock to the app and adding new fingerprints.

### 3. Remote Control (with Gateway)

For remote unlocking and real-time notifications from anywhere, pair your deadbolt with a GeekTale gateway (sold separately). This allows you to grant access to family or friends even when you are away.



*Image: Remote access and family sharing features.*

#### 4. Key Unlock

In case of battery depletion or other issues, you can always use the traditional backup keys provided with your deadbolt to unlock the door manually.



# 3 In 1 Unlock



APP  
Unlock



Fingerprint  
Unlock



Key  
Unlock



Build a smarter and safer home with the K13  
\*K13 needs to be purchased separately

*Image: Three primary unlocking methods for the deadbolt.*

## MAINTENANCE

### Battery Management

The GeekTale F08 deadbolt is equipped with a built-in rechargeable battery. A full charge takes approximately 2 hours and provides up to 8 months of use. The lock will provide low-battery alerts to notify you when charging is needed. In an emergency, you can power the lock via a USB cable for temporary access.

# Charge for 30 Minutes, Use for 8 Months



**Built-in  
Rechargeable Battery**

## Cost Effective



**Low Battery  
Alert**

*Image: Battery charging and low battery alert features.*

To charge, connect a USB-C cable to the port on the deadbolt. Ensure the lock is fully charged before initial use.

## TROUBLESHOOTING

If you encounter issues with your GeekTale Fingerprint Deadbolt, please refer to the following common solutions:

- **Fingerprint Not Recognized:** Ensure your finger is clean and dry. Try re-registering your fingerprint through the app. Ensure the sensor is clean.
- **Lock Not Responding:** Check the battery level. If low, charge the deadbolt using a USB-C cable.
- **App Connectivity Issues:** Ensure Bluetooth is enabled on your device and you are within 10 meters of the lock. Restart the app or your phone.
- **Remote Unlock Not Working:** Verify that your gateway is properly connected and online. Check your internet connection.
- **Physical Key Not Working:** Ensure you are using the correct key and inserting it fully.

For further assistance, please contact GeekTale customer support.

SPECIFICATIONS

Feature	Detail
Brand	GeekTale
Model Name	F08
Lock Type	Keyless Entry Deadbolt
Special Features	Twist to Lock & Unlock, Fingerprint Deadbolt, App Control, Built-in Rechargeable Battery, Easy Install
Item Dimensions (L x W x H)	2.67 x 2.67 x 1.87 inches
Material	Aluminum
Item Weight	1.37 pounds
Connectivity Protocol	Bluetooth
Battery Type	Lithium Ion (included)
Recommended Uses	Residential front doors, outdoor equipment, and storage units

WARRANTY AND SUPPORT

For warranty information or technical support, please refer to the contact details provided with your product packaging or visit the official GeekTale website. Keep your purchase receipt for warranty claims.