

[Manuals.plus](#) /

> [NEEWER](#) /

> Neewer NB-Z1 PRO 7.2V/3000mAh Li-ion Replacement Battery Instruction Manual

## NEEWER NB-Z1 PRO (Model 10104773)

# Neewer NB-Z1 PRO 7.2V/3000mAh Li-ion Replacement Battery Instruction Manual

Model: NB-Z1 PRO (10104773)

## 1. INTRODUCTION

This manual provides essential instructions for the safe and effective use of your Neewer NB-Z1 PRO 7.2V/3000mAh Li-ion Replacement Battery. This battery is designed to provide reliable power for compatible Neewer flash speedlites. Please read this manual thoroughly before first use and retain it for future reference.

## 2. PRODUCT FEATURES

- **3000mAh High Capacity Li-ion Battery:** Features a 7.2V/3000mAh high-capacity li-ion polymer cell for extended operational time.
- **Broad Compatibility:** Specifically designed for Neewer Z3R-C/S/N/F, Z3-C/S/N/F, Z2PRO-C/S/N, Z2-C/S/N, Z1-C/S/N, Z760-C/S/N, Z880-C/S/N Q120 TTL flash speedlites.
- **Quick & Efficient Charging:** Achieves a full charge in approximately 2.5 hours using the included Type-C charging cable, or 3 hours with a dedicated charging dock (not included).
- **Advanced Safety & Reliability:** Incorporates built-in protection mechanisms against overcharge, over-discharge, over-voltage, over-current, and overheating to ensure safe operation.
- **Portable Design:** Offers high energy density, excellent recycle life, and a long lifespan in a compact, easy-to-carry form factor.

# 3000MAH HIGH CAPACITY LI ION BATTERY

7.2V/3000mAh high capacity li ion polymer battery uses high quality battery cells for extended run time.



**7.2V/3000mAh**  
Large Capacity



**Z1/Z2/Z2PRO/  
Z3/Z3R/Z760/Z880**  
Compatibility



Only compatible with NEEWER Z1/Z2/Z2PRO/Z3/Z3R/Z760/Z880 Flash Speedlite.

Image: The Neewer NB-Z1 PRO battery highlighting its 3000mAh capacity and compatibility with Z1, Z2, Z2PRO, Z3, Z3R, Z760, Z880 series flash speedlites.

# BUILT IN INTELLIGENT PROTECTION



Overheating



Electric Shock



Overvoltage



Short Circuit



Overcharge



Overcurrent

Image: A visual representation of the battery's intelligent protection features, including safeguards against overheating, electric shock, overvoltage, short circuit, overcharge, and overcurrent.

## 3. SETUP AND INSTALLATION

Follow these steps to properly install the battery into your compatible flash speedlite:

1. **Power Off Device:** Ensure your Neewer flash speedlite is completely powered off before attempting to insert or remove the battery.
2. **Open Battery Compartment:** Locate and open the battery compartment on your flash speedlite. Refer to your speedlite's manual for specific instructions if needed.
3. **Insert Battery:** Align the battery's contacts with the terminals inside the compartment. Gently push the battery into place until it is securely seated and the compartment cover can be closed.
4. **Close Compartment:** Close the battery compartment cover firmly.



## COMPATIBLE WITH Z1/Z2/Z2PRO/Z3/Z3R/ Z760/Z880 SPEEDLITE FLASH

Compatible with NEEWER Z1-C Z1-S Z1-N,Z2-C Z2-S Z2-N,  
Z2PRO-C Z2PRO-S Z2PRO-N,Z3-C Z3-S Z3-N Z3-F,Z3R-C  
Z3R-S Z3R-N Z3R-F,Z760-C Z760-S Z760-N, Z880-C Z880-S  
Z880-N TTL flash speedlites.

Image: The Neewer NB-Z1 PRO battery shown alongside a compatible flash speedlite, illustrating its intended use and fit.

## 4. OPERATING INSTRUCTIONS

### 4.1 Charging the Battery

The NB-Z1 PRO battery can be charged using the included Type-C cable.

1. **Connect Cable:** Plug the Type-C end of the charging cable into the battery's charging port.
2. **Connect to Power:** Connect the USB-A end of the charging cable to a compatible USB power adapter (not included), a car charger, or a portable power bank.
3. **Monitor Charging:** The charging indicator light on the battery will illuminate (typically red) to indicate charging is in progress. It will change color (typically green) when charging is complete.
4. **Charging Time:** A full charge takes approximately 2.5 hours via the Type-C cable. If using a dedicated charging dock (not included), it may take up to 3 hours.
5. **Disconnect:** Once fully charged, disconnect the cable from the battery and the power source.

**Important: A wall charger is not included. Use a certified USB power adapter for optimal charging.**

# QUICK & EFFICIENT CHARGING OPTIONS

Note: Wall charger not included.

**2.5h**

Fully charges in just 2.5 hours using the included Type C charging cable.

**3h**

Fully charges in just 3 hours using the charging dock (not included).

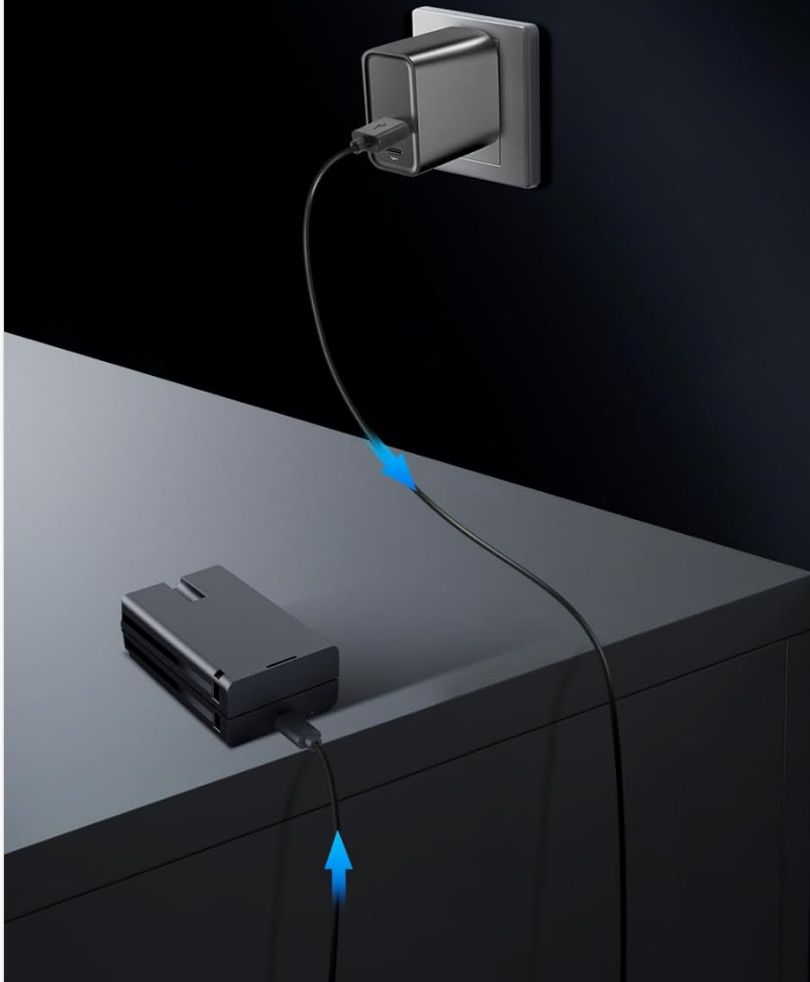

**Charging**



**Fully charged**

Image: Illustration of the battery charging process using a Type-C cable, showing the charging indicator light and different power source options like a USB power adapter, car charger, and portable charger.

## 4.2 Using the Battery

After installation and charging, the battery is ready for use:

1. **Power On:** Turn on your compatible Neewer flash speedlite.
2. **Verify Battery Level:** Check the battery level indicator on your flash speedlite to confirm sufficient power.
3. **Operation:** Operate your flash speedlite as per its specific instruction manual. The NB-Z1 PRO battery will provide consistent power for your photography needs.

## 5. MAINTENANCE

Proper maintenance ensures the longevity and performance of your battery:

- **Storage:** Store the battery in a cool, dry place, away from direct sunlight, moisture, and extreme temperatures (both high and low).
- **Avoid Full Discharge:** Do not allow the battery to remain fully discharged for extended periods, as this can reduce its

lifespan.

- **Periodic Charging:** If the battery will not be used for a long time, charge it to approximately 50% every three months to maintain its health.
- **Clean Contacts:** Periodically clean the metal contacts on the battery with a dry, soft cloth to ensure good electrical connection.
- **Handling:** Handle the battery with care. Avoid dropping it or subjecting it to strong impacts.

## EASY TO CARRY

Lightweight and portable, without taking up much space.



Image: A hand demonstrating the ease of carrying the lightweight and portable Neewer NB-Z1 PRO battery, fitting it into a small bag compartment.

## 6. TROUBLESHOOTING

If you encounter issues with your battery, refer to the following common problems and solutions:

- **Battery Not Charging:**
  - Ensure the Type-C charging cable is securely connected to both the battery and the power adapter.
  - Verify that the USB power adapter or power source is functional. Try a different adapter or USB port.

- Check if the charging cable is damaged. Try using a different Type-C cable.

- **Battery Not Powering Device:**

- Confirm the battery is correctly inserted into the flash speedlite's compartment.
- Ensure the battery is sufficiently charged.
- Clean the battery contacts and the device's terminals with a dry, soft cloth to remove any dust or debris.

- **Shortened Battery Life:**

- Battery performance naturally degrades over time with repeated charge cycles.
- Ensure you are following proper charging and storage guidelines as outlined in the Maintenance section.
- Extreme temperatures during use or storage can affect battery performance.

## 7. SPECIFICATIONS

Feature	Specification
Model	NB-Z1 PRO (10104773)
Item Type	Li-ion Battery
Voltage	7.2V
Capacity	3000mAh / 21.6Wh
Charging Time (Type-C)	Approx. 2.5 hours
Charging Time (Dock)	Approx. 3 hours (dock not included)
Compatibility	Z1/Z2/Z2PRO/Z3/Z3R/Z760/Z880 Flash Speedlite series
Dimensions	2.7" x 1.7" x 1" (6.8 x 4.2 x 2.5 cm)
Weight	0.3 lb (0.13 kg)
Battery Cell Composition	Lithium Ion
Manufacturer	NEEWER
Country of Origin	China

# PACKAGE CONTENTS



1 x Lithium Battery for  
Z1/Z2/Z2PRO/Z3/Z3R/Z760/Z880  
Flash Speedlite



1 x Type C Charging Cable

## SPECIFICATIONS

Model: NB-Z1 PRO

Charging Time: 3h (charging dock), 2.5h (type c cable)

Item Type: Li ion Battery

Compatibility: Z1/Z2/Z2PRO/Z3/Z3R/Z760/Z880

Voltage: 7.2V

Dimensions: 2.7"x1.7"x1"/6.8x4.2x2.5cm

Capacity: 3000mAh/21.6Wh

Weight: 0.3lb/0.13kg

Image: A visual summary of the package contents, including one Lithium Battery for Z1/Z2/Z2PRO/Z3/Z3R/Z760/Z880 Flash Speedlite and one Type-C Charging Cable, along with a detailed specifications table.

## 8. SAFETY INFORMATION

Please observe the following safety precautions to prevent damage to the battery or personal injury:

- Do not disassemble, crush, puncture, or modify the battery.
- Keep the battery away from fire, water, and extreme temperatures (above 60°C/140°F or below -10°C/14°F).
- Avoid short-circuiting the battery terminals with metal objects.
- Dispose of used batteries according to local regulations. Do not dispose of in household waste.
- Keep out of reach of children and pets.
- If the battery swells, leaks, or emits an unusual odor, discontinue use immediately and dispose of it safely.
- Use only the included Type-C cable or a compatible charging dock for charging.

## 9. WARRANTY AND SUPPORT

Your Neewer NB-Z1 PRO Li-ion Replacement Battery comes with a **1-Year Manufacturer Warranty**.

For technical support, warranty claims, or any product-related inquiries, please contact NEEWER customer service through their official website or the retailer where the product was purchased.

You can visit the official NEEWER store for more information: [NEEWER Store](#)

