

Manuals+

[Q & A](#) | [Deep Search](#) | [Upload](#)

manuals.plus /

› [SANWA](#) /

› [SANWA Bluetooth Ergonomic Mouse User Manual](#)

SANWA GMAERGBT11N2

SANWA Bluetooth Ergonomic Mouse

Model: GMAERGBT11N2

User Manual

1. INTRODUCTION

Thank you for choosing the SANWA Bluetooth Ergonomic Mouse. This vertical mouse is designed to provide a natural and comfortable hand position, reducing wrist strain and muscle tension during prolonged use. With its silent click buttons, adjustable DPI settings, and versatile compatibility, it aims to enhance your productivity and comfort across various devices.



Figure 1: SANWA Bluetooth Ergonomic Mouse

2. KEY FEATURES

- **Ergonomic Vertical Design:** Places your hand in a natural "handshake" position (approximately 55-degree angle) to alleviate wrist and arm tension, promoting smoother movement and reducing discomfort.



Ergonomic Vertical Mouse

Fit your palm perfectly and relief wrist pain

Normal



Ergonomic



Figure 2: Ergonomic Vertical Design for Natural Hand Position

- **Noiseless Click Buttons:** Equipped with silent click buttons for the left, right, and side buttons, ensuring a quiet working environment suitable for offices, libraries, or late-night use.



Silent Click Buttons & Scroll

No noise on working, No disturbing others.

Figure 3: Silent Click Buttons

- **Adjustable DPI Settings:** Easily switch between 800, 1200, and 1600 DPI (Dots Per Inch) to adjust cursor sensitivity and responsiveness according to your task requirements. Features Blue LED tracking technology for use on various surfaces.

Precise Movement with Adjustable DPI

800-1200-1600 DPI



Figure 4: Adjustable DPI Settings

- **3 Programmable Buttons:** Includes advanced "Back" and "Forward" functionality buttons conveniently located near the thumb area for easier web browsing. These buttons can be customized using SANWA's exclusive software (Windows system only).

3 Programmable Buttons

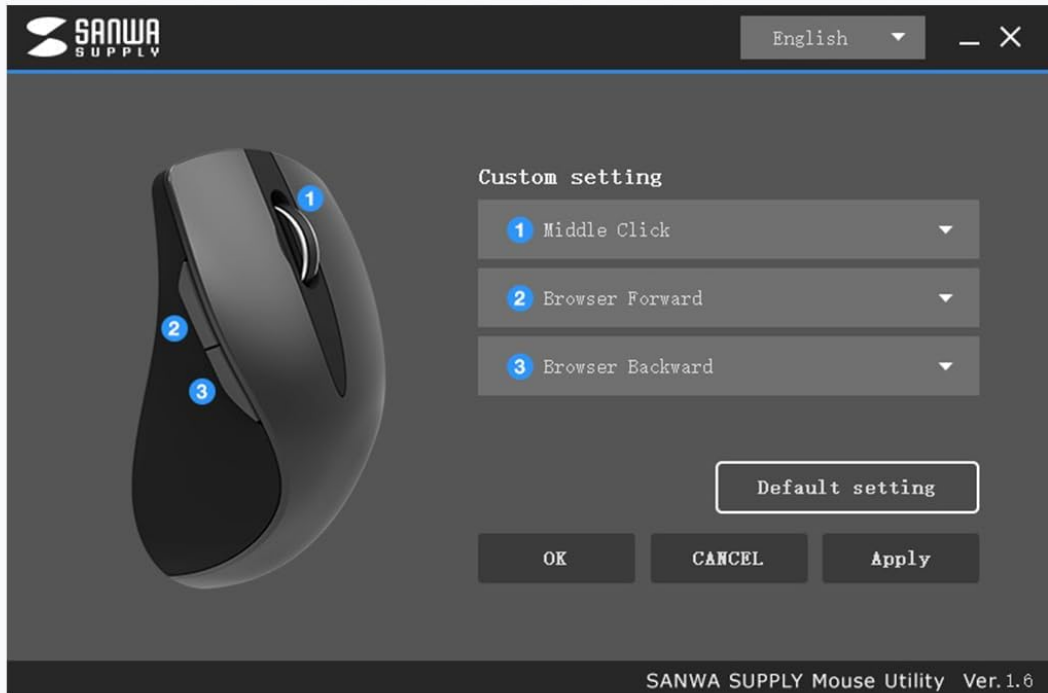

Customize your work and media control needs



① Scroll Wheel

② Forward

③ Backward

Note: This function only works on Windows system.

Figure 5: Programmable Buttons Interface

- **Wide System Compatibility:** Compatible with most operating systems, including Windows 11 / 10 / 8.1 / 8, macOS (Sonoma)14, (Ventura) 13, (Monterey) 12, (BigSur) 11, macOS 10.12~10.15, Chrome OS, and later versions. Suitable for notebooks, PCs, laptops, computers, and other devices. *Note: Not fully compatible with Apple products; Forward/Backward buttons may not work on Mac series.*

Wide System Compatibility

Suitable for main operating systems on the market



Compatible Systems

Windows 11 / 10 / 8.1 / 8 / 7, XP
Vista MacOS 10.12~10.14, X 10.3~10.11
iPadOS 13+
Android 3.0+

Figure 6: Wide System Compatibility

- **Bluetooth Connectivity:** Enjoy a stable and quick wireless connection, freeing you from tangled wires and providing a clean workspace.

Bluetooth Connection

22.8ft work distance, stable data transmission



Figure 7: Bluetooth Connection

3. SETUP

3.1 Battery Installation

The SANWA Bluetooth Ergonomic Mouse requires **two (2) AA batteries** (not included). To install:

1. Locate the battery compartment on the underside of the mouse.
2. Slide the battery compartment cover open.
3. Insert two AA batteries, ensuring correct polarity (+/-).
4. Close the battery compartment cover securely.



Figure 8: Mouse Underside with Battery Case and Switches

3.2 Bluetooth Pairing

Follow these steps to pair your mouse with your device:

1. Turn on the mouse using the On/Off switch located on the underside.
2. Press and hold the Bluetooth pairing button (usually indicated by a Bluetooth icon) on the underside of the mouse until the LED indicator starts blinking, indicating it's in pairing mode.
3. On your computer or device, go to Bluetooth settings.
4. Search for new devices and select "SANWA Ergonomic Mouse" (or similar name) from the list.
5. Confirm the pairing on your device if prompted. The LED indicator on the mouse will stop blinking and remain solid once connected.

4. OPERATING INSTRUCTIONS

4.1 DPI Adjustment

To change the cursor speed (DPI), press the DPI switch button located on the top of the mouse, near the scroll wheel. Each press cycles through the available DPI settings: 800, 1200, and 1600 DPI.

4.2 Button Functions

Button	Function	Notes
Left Click	Primary click function	Silent click
Right Click	Secondary click function (context menu)	Silent click
Scroll Wheel	Scroll up/down, Middle click	Silent scroll
Forward Button	Navigate forward in web browser/file explorer	Silent click. Functionality limited on Mac systems.
Back Button	Navigate backward in web browser/file explorer	Silent click. Functionality limited on Mac systems.

For advanced customization of buttons, please download and install the SANWA Mouse Utility software from the official SANWA website (Windows only).

Your browser does not support the video tag.

Video: GMAERGBT11N2 Using Experience. This video demonstrates the ergonomic design and silent click features of the mouse, showcasing its comfortable use in an office setting.

5. MAINTENANCE

- **Cleaning:** Use a soft, dry cloth to clean the mouse. For stubborn dirt, slightly dampen the cloth with water or a mild cleaning solution. Avoid harsh chemicals or abrasive materials.
- **Battery Replacement:** Replace batteries when the mouse's performance degrades or the LED indicator (if present) signals low power. Always use fresh AA batteries.
- **Storage:** When not in use for extended periods, turn off the mouse to conserve battery life. Store in a cool, dry place away from direct sunlight.

6. TROUBLESHOOTING

Problem	Possible Solution
Mouse not connecting/pairing	Ensure batteries are correctly installed and charged. Turn the mouse off and on again. Re-initiate Bluetooth pairing mode on the mouse and re-scan for devices on your computer. Ensure your device's Bluetooth is enabled.
Cursor movement is erratic or unresponsive	Check the surface you are using the mouse on; a smooth, non-reflective surface is ideal. Clean the optical sensor on the underside of the mouse. Try adjusting the DPI setting.
Buttons not responding	Ensure the mouse is powered on and connected. For programmable buttons, verify software settings (Windows only). Replace batteries if low.
Forward/Back buttons not working on Mac	This is a known compatibility limitation. These buttons are not fully supported on macOS.

7. SPECIFICATIONS

Feature	Detail
---------	--------

Feature	Detail
Model Number	GMAERGBT11N2
Product Dimensions	4.65 x 2.66 x 0.1 inches
Item Weight	3.2 ounces
Batteries Required	2 AA batteries
Connectivity Technology	Bluetooth
Movement Detection	Optical
DPI Settings	800 / 1200 / 1600
Special Features	Portable, Programmable Buttons, Ergonomic Design, Soundless

8. WARRANTY AND SUPPORT

For warranty information or technical support, please refer to the product packaging or visit the official SANWA website. You may also contact SANWA customer service directly for assistance with your product. Thank you for choosing SANWA.