

WONLINK WL-NA1501

WONLINK USB WiFi Adapter

MODEL: WL-NA1501 USER MANUAL

1. Introduction

Thank you for choosing the WONLINK USB WiFi Adapter WL-NA1501. This manual provides detailed instructions for the proper installation, operation, and maintenance of your new wireless network adapter. Please read this manual thoroughly before use to ensure optimal performance and to prevent any issues.

The WONLINK WL-NA1501 is a dual-band 802.11AC USB WiFi adapter designed to provide high-speed wireless connectivity for your desktop or laptop computer. It supports both 5GHz and 2.4GHz bands, offering speeds up to 1300Mbps for seamless streaming, gaming, and browsing.

2. Package Contents

- WONLINK USB WiFi Adapter (Model: WL-NA1501)
- User Manual

Please check the package contents carefully. If any items are missing or damaged, contact your retailer or WONLINK customer support.

3. Product Overview

The WONLINK WL-NA1501 features a compact design with rotatable high-gain antennas for enhanced signal reception and transmission. It connects to your computer via a USB port and is compatible with various operating systems.



Image 3.1: WONLINK USB WiFi Adapter WL-NA1501. This image shows the adapter with its two rotatable antennas extended, highlighting its compact form factor and USB connector.



Image 3.2: Key Features. This graphic illustrates the main features of the adapter, including its 1300Mbps speed, advanced chip, USB connectivity, dual-band support (5G & 2.4G), WPA3/WPA2 security, and multi-system compatibility.

4. Setup Instructions

Follow these steps to install and set up your WONLINK USB WiFi Adapter:

1. **Plug in the Adapter:** Switch on your computer (desktop or laptop) and plug the USB WiFi adapter into an available USB port. For optimal performance, use a USB 3.0 port if available.
2. **Driver Installation:** The adapter features built-in drivers. In most cases, the operating system will automatically detect the device and install the necessary drivers. If automatic installation does not occur, navigate to 'This PC' or 'My Computer', locate the virtual CD-ROM drive for the adapter, and run the installer.
3. **Connect to a Network:** Once the drivers are installed, open your computer's network settings. Select the desired wireless network (either 2.4 GHz or 5 GHz band), enter the WiFi password, and connect.

Quick and Easy Setup

Has built-in drivers, no need for CD drivers.

Switch on your computer/desktop/laptop and plug the WiFi adapter into the USB port of your computer.

1

2

Open the driver and start the installation package, the WiFi driver will be installed automatically.

Select a network (2.4 GHz or 5 GHz network), enter your WiFi password and enjoy your time online!

3



Image 4.1: Quick Setup Guide. This image visually outlines the three main steps for setting up the adapter: plugging it into a USB port, installing the driver, and connecting to a WiFi network.

No Latency and Delay Enjoy a Stable Network

It is the first choice for desktop computers. Stable and fast like wired internet.



Image 4.2: Desktop PC Setup. This image depicts the USB WiFi adapter connected to a desktop computer, illustrating its use for stable network connectivity.

5. Operating Instructions

The WONLINK WL-NA1501 adapter supports two primary operating modes:

- **Conventional Mode (Station Mode):** In this mode, the adapter functions as a client device, connecting your computer to an existing wireless network provided by a router. This is the standard mode for accessing the internet wirelessly.
- **AP Mode (Access Point Mode):** This mode allows the adapter to act as a wireless access point. If your computer is connected to the internet via a wired connection, the adapter can share this internet connection wirelessly with other devices (e.g., smartphones, tablets) by creating a WiFi hotspot.

To switch between modes or configure AP mode, refer to the network settings in your operating system or the utility provided with the driver software.

Multiple Operating Modes

The WiFi adapter supports receive and AP modes. In AP mode, you can turn a wired computer into a WiFi access point so that other devices can connect to it.

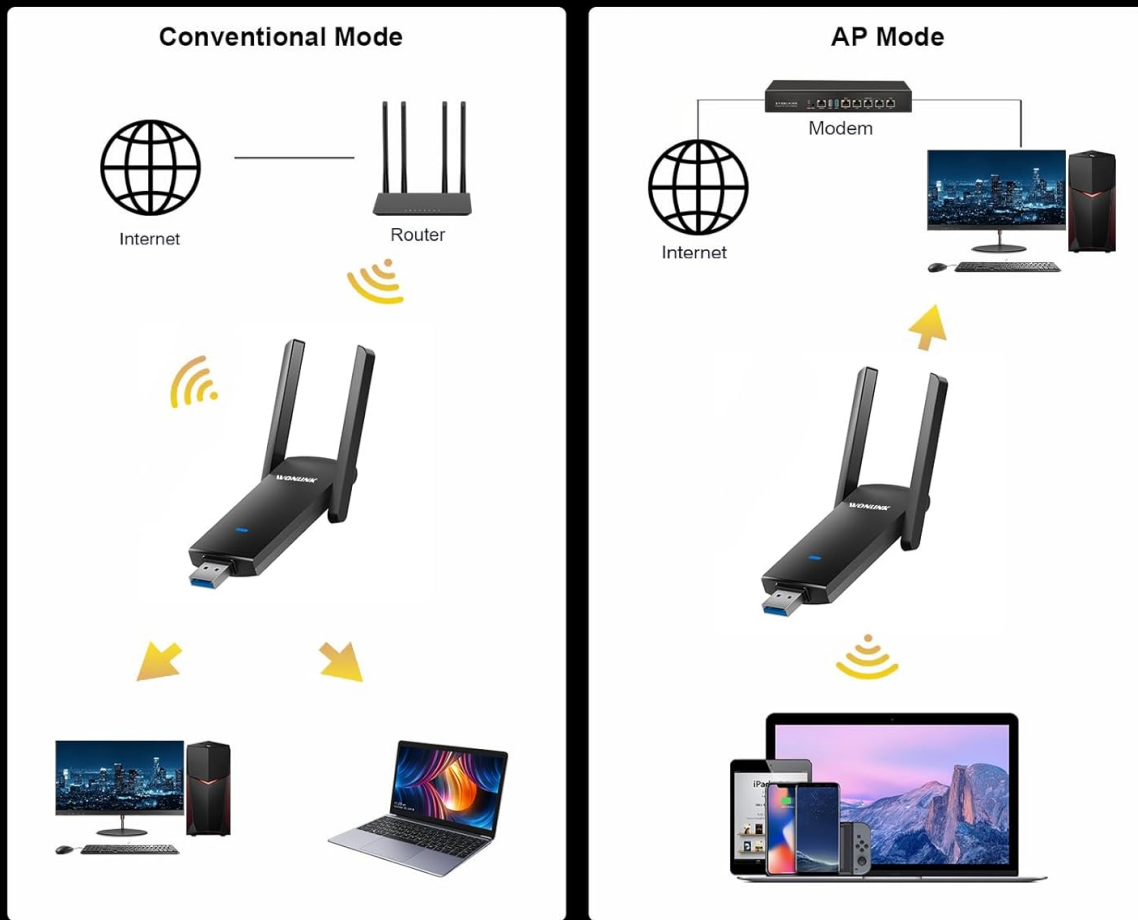

Image 5.1: Multiple Operating Modes. This diagram illustrates the two main operating modes: Conventional Mode, where the adapter connects to a router, and AP Mode, where it creates a WiFi hotspot from a wired internet connection.

6. Maintenance

To ensure the longevity and optimal performance of your WONLINK USB WiFi Adapter, consider the following maintenance tips:

- **Keep Clean:** Gently wipe the adapter with a dry, soft cloth to remove dust. Avoid using liquid cleaners or solvents.
- **Proper Storage:** When not in use, store the adapter in a cool, dry place away from direct sunlight and extreme temperatures.
- **Handle with Care:** Avoid dropping the adapter or subjecting it to strong impacts. Do not force the adapter into a USB port.
- **Software Updates:** Periodically check the WONLINK website for updated drivers to ensure compatibility and performance improvements.

7. Troubleshooting

If you encounter issues with your WONLINK USB WiFi Adapter, refer to the following common problems and

solutions:

| Problem | Solution |
|-----------------------------------|---|
| Adapter not detected by computer. | <ul style="list-style-type: none">• Try plugging the adapter into a different USB port.• Restart your computer.• Ensure drivers are installed correctly (check Device Manager). |
| Cannot connect to WiFi network. | <ul style="list-style-type: none">• Verify the WiFi password is correct.• Ensure the adapter is within range of the router.• Restart your router and modem.• Check if other devices can connect to the network. |
| Slow connection speed. | <ul style="list-style-type: none">• Ensure you are connected to the 5GHz band for higher speeds (if your router supports it).• Reduce interference by moving the adapter or router away from other electronic devices.• Update adapter drivers.• Check your internet service provider's speed. |
| Frequent disconnections. | <ul style="list-style-type: none">• Ensure the adapter is securely plugged into the USB port.• Check for strong signal strength.• Update adapter drivers.• Adjust antenna position for better reception. |

If the problem persists after trying these solutions, please contact WONLINK customer support for further assistance.

8. Specifications

| Feature | Detail |
|------------------------------|--|
| Model Number | WL-NA1501 |
| Hardware Interface | USB |
| Data Link Protocol | USB, IEEE 802.11ac |
| Data Transfer Rate | Up to 867 Mbps (5GHz), Up to 400 Mbps (2.4GHz) |
| Frequency Bands | 2.4 GHz, 5 GHz |
| Compatible Operating Systems | Windows 8/8.1/10/11, Mac OS 10.9-10.15 |
| Compatible Devices | Desktop, Laptop |

| Feature | Detail |
|--------------------|---------------------------|
| Item Weight | 1.76 ounces |
| Package Dimensions | 5.83 x 3.62 x 0.87 inches |

9. Warranty and Support

WONLINK products are designed for reliability and performance. This product is covered by a limited warranty against defects in materials and workmanship. For specific warranty terms and conditions, please refer to the warranty card included with your product or visit the official WONLINK website.

For technical support, troubleshooting assistance, or warranty claims, please contact WONLINK customer support through the contact information provided on the official WONLINK website or your purchase platform. Please have your product model number (WL-NA1501) and purchase details ready when contacting support.

© 2024 WONLINK. All rights reserved.

Related Documents - WL-NA1501

| | |
|--|--|
| | WONLINK WL-NE3502 WiFi Extender: 1200Mbps Dual Band WiFi Booster Setup Guide |
|--|--|

User guide for the WONLINK WL-NE3502 WiFi Extender, a 1200Mbps dual-band WiFi booster and repeater. Includes setup instructions, features, and specifications for enhanced wireless network coverage.

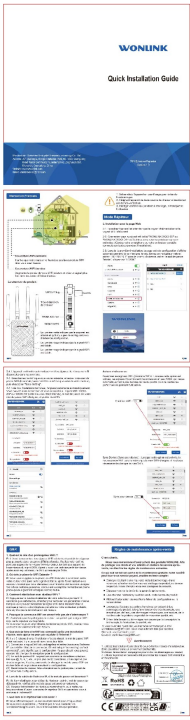

[WONLINK NE3503B WiFi Repeater Quick Installation Guide](#)

This guide provides instructions for installing the WONLINK NE3503B WiFi Repeater, a 1200Mbps dual-band device designed to extend wireless network coverage up to 120 . Learn about setup, configuration, and compliance.

WONLINK

Quick Installation Guide



[WONLINK WL-NE3503 WiFi Extender/Repeater Quick Installation Guide](#)

This guide provides step-by-step instructions for installing and configuring the WONLINK WL-NE3503 WiFi Extender/Repeater, including setup, troubleshooting tips, and important safety and regulatory information.



[FCC Compliance Statement for WONLINK WL-NA1602 Wireless Network Adapter](#)

Detailed FCC compliance information for the WONLINK WL-NA1602 wireless network adapter, covering Part 15 rules, interference, and RF exposure requirements.

五国语言说明书V3
骑马钉 80g双胶纸 单色印刷
75*95mm
黑色边框为刀模线 不做印刷

[WONLINK Wireless Adapter Quick Installation Guide](#)

A comprehensive guide for installing and using the WONLINK Wireless Adapter, including hardware and driver installation, network connection, and troubleshooting.

| | |
|--|--|
| <div><div>WONLINK</div><div>Quick Installation Guide</div><div> Repeater M0305498 Version 1.0/2</div></div> | <div>WONLINK Repeater Quick Installation Guide</div> <div>Comprehensive quick installation guide for the WONLINK Repeater (Model M0305498), covering setup, working modes, Mesh networking, and troubleshooting.</div> |
|--|--|

Documents - WONLINK – WL-NA1501





[\[pdf\]](#)

WL NA1501 WONLINK V1 Driver installation is complete you can move the mouse to My Computer right click and then select Manage enter management interface view C1kK5Ksa1jL m media amazon images I |||

...

lang: **score:17** filesize: 5.24 M page_count: 1 document date: 2023-11-15