

INTETURE JR400

INTETURE JR400 Cordless Vacuum Cleaner User Manual

Model: JR400

1. INTRODUCTION

Thank you for choosing the INTETURE JR400 Cordless Vacuum Cleaner. This manual provides essential information for the safe and effective use of your new appliance. Please read it thoroughly before operation and retain it for future reference.

The INTETURE JR400 is designed for versatile cleaning, featuring a 450W motor, up to 40Kpa suction, and a runtime of up to 55 minutes. It includes a smart touch display and an anti-tangle brush suitable for various floor types.

2. IMPORTANT SAFETY INSTRUCTIONS

To reduce the risk of fire, electric shock, or injury, always follow basic safety precautions when using an electrical appliance. Read all instructions before using this vacuum cleaner.

- Do not use outdoors or on wet surfaces.
- Do not allow to be used as a toy. Close attention is necessary when used by or near children.
- Use only as described in this manual. Use only manufacturer's recommended attachments.
- Do not use with a damaged cord or plug. If the appliance is not working as it should, has been dropped, damaged, left outdoors, or dropped into water, return it to a service center.
- Do not pull or carry by cord, use cord as a handle, close a door on cord, or pull cord around sharp edges or corners. Do not run appliance over cord. Keep cord away from heated surfaces.
- Do not unplug by pulling on cord. To unplug, grasp the plug, not the cord.
- Do not handle plug or appliance with wet hands.
- Do not put any object into openings. Do not use with any opening blocked; keep free of dust, lint, hair, and anything that may reduce airflow.
- Keep hair, loose clothing, fingers, and all parts of body away from openings and moving parts.

- Do not pick up anything that is burning or smoking, such as cigarettes, matches, or hot ashes.
- Use extra care when cleaning on stairs.
- Do not use to pick up flammable or combustible liquids, such as gasoline, or use in areas where they may be present.
- Prevent unintentional starting. Ensure the switch is in the off-position before connecting to battery pack, picking up or carrying the appliance.
- Recharge only with the charger specified by the manufacturer.
- Under abusive conditions, liquid may be ejected from the battery; avoid contact. If contact accidentally occurs, flush with water. If liquid contacts eyes, additionally seek medical help.

3. PACKAGE CONTENTS

Carefully unpack your INTETURE JR400 Cordless Vacuum Cleaner and verify that all items are present and in good condition. If any items are missing or damaged, please contact customer support.



Image: The INTETURE JR400 Cordless Vacuum Cleaner shown with all its components and accessories laid out.

- Vacuum Main Body
- Battery (1 pc)
- Dust Cup (1 pc)
- "S" Shape Anti-Tangle Floor Brush (1 pc)

- Telescopic Tube (1 pc)
- Crevice Brush (1 pc)
- Round Brush (1 pc)
- HEPA Filter (3 pcs: 1 installed, 2 for replacement)
- Air Filter (1 pc)
- Small Cleaning Tool (1 pc)
- Charger (1 pc)
- Wall Mount Stand (1 pc)
- User Manual (1 pc)

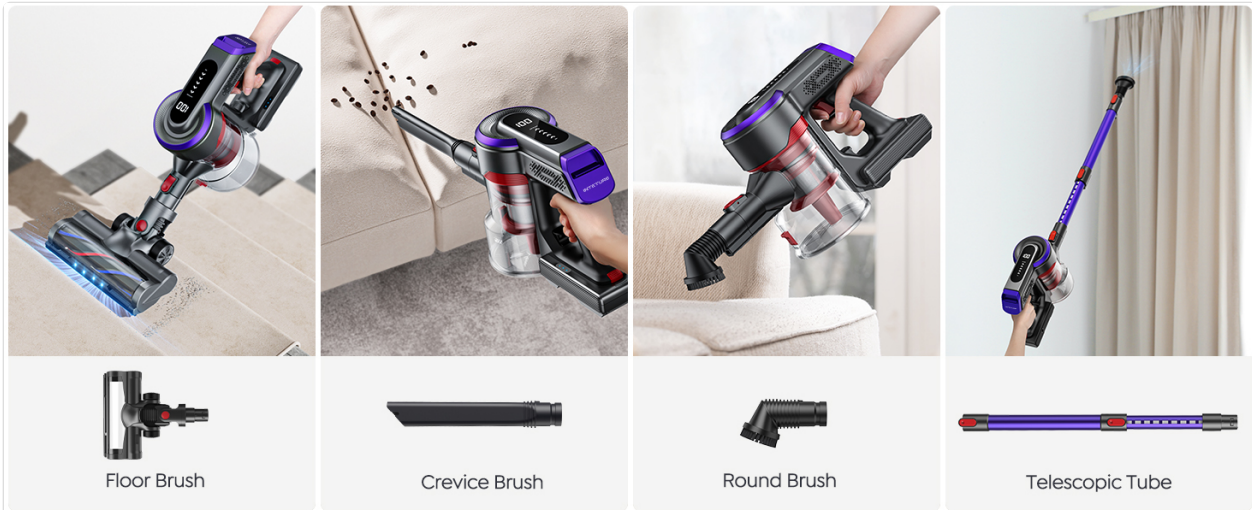

Image: A visual breakdown of the various cleaning attachments included with the vacuum cleaner.

4. ASSEMBLY AND SETUP

4.1 Assembling the Vacuum

1. **Attach the Telescopic Tube:** Insert the telescopic tube into the main vacuum body until it clicks securely into place.
2. **Attach the Floor Brush:** Connect the "S" shape anti-tangle floor brush to the other end of the telescopic tube. Ensure it clicks firmly.
3. **Install the Battery:** Slide the battery pack into the designated slot on the main vacuum body until it locks.

4.2 Attaching Accessories

The JR400 can be used in stick or handheld mode. To use as a handheld vacuum, detach the telescopic tube and connect accessories directly to the main body.

- **Crevice Brush:** Ideal for narrow gaps, corners, and edges.
- **Round Brush:** Suitable for delicate surfaces, upholstery, and irregular shapes.

5. CHARGING THE BATTERY

The INTETURE JR400 is equipped with a removable 7*2200mAh battery. Ensure the battery is fully charged before first use.



Image: Illustration of the removable battery being inserted into the vacuum, highlighting its capacity and charging time.

1. **Connect the Charger:** Plug the charger into a power outlet and connect the charging cable to the battery pack. The battery can be charged while attached to the vacuum or separately.
2. **Charging Indicator:** The smart touch display will show the charging status. A full charge typically takes 4-5 hours.
3. **Runtime:** A fully charged battery provides up to 55 minutes of runtime on low suction and approximately 15 minutes on high suction.

6. OPERATING INSTRUCTIONS

6.1 Power On/Off and Suction Adjustment



Image: A detailed view of the intelligent touch display on the vacuum's handle, indicating battery level and suction adjustment.

1. **Power On:** Press the power button on the handle to start the vacuum.
2. **Adjust Suction:** The smart touch display allows for stepless adjustment of suction power. Slide your finger on the display to select one of the 5 available suction levels, ranging up to 40Kpa.
3. **Power Off:** Press the power button again to turn off the vacuum.

6.2 Using the Floor Brush



Image: The anti-winding brush head with LED lights, demonstrating its flexible movement for cleaning various areas.

- The integrated soft and hard bristles in the floor brush are suitable for both hard floors and carpets, eliminating the need to switch brush heads.
- The brush head features LED lights to illuminate dark areas, helping to identify hidden dust.
- The brush head offers 180° horizontal and 90° vertical rotation for easy maneuverability around furniture and into corners.

6.3 Versatile Cleaning



Image: The vacuum cleaner configured for different cleaning scenarios, including floor cleaning, high-reach cleaning, and handheld use for upholstery and keyboards.

The JR400 can be easily converted into a handheld vacuum for cleaning upholstery, car interiors, and other hard-to-reach areas using the crevice or round brush attachments.

7. MAINTENANCE

Regular maintenance ensures optimal performance and extends the lifespan of your vacuum cleaner.

7.1 Emptying the Dust Cup



Image: A hand demonstrating the one-touch emptying mechanism of the 1.5L dust cup, releasing collected debris.

1. Ensure the vacuum is turned off.
2. Press the dust cup release button to detach the dust cup from the main body.
3. Position the dust cup over a trash bin and press the bottom release latch to open the lid and empty the contents.
4. Close the lid and reattach the dust cup to the vacuum until it clicks.

7.2 Cleaning the Filters

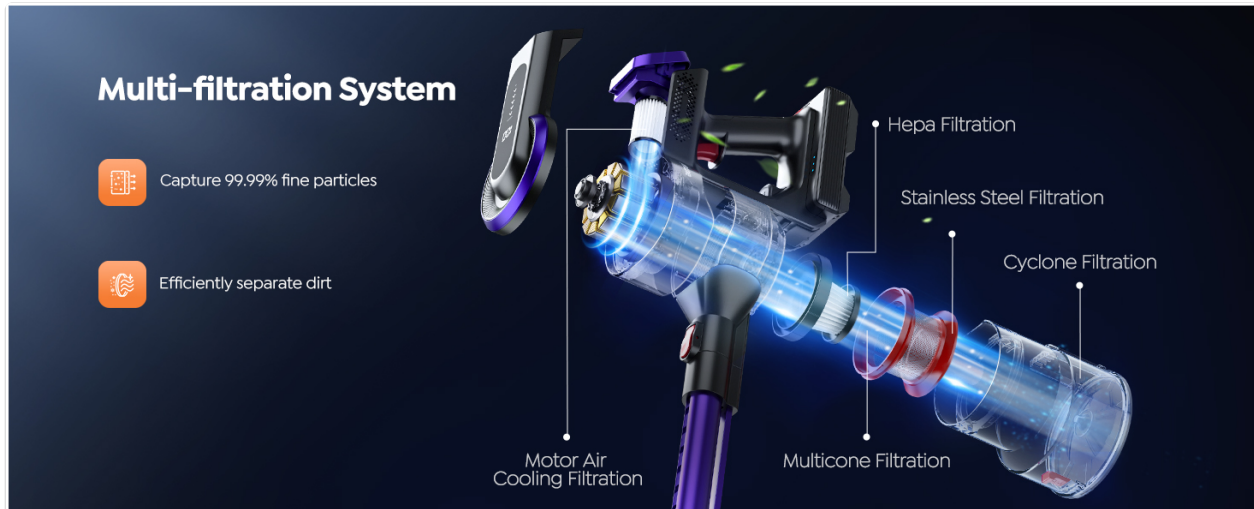

Image: A cutaway diagram showing the multi-stage filtration system, including HEPA, stainless steel, cyclone, and multicone filters.

The JR400 features a multi-stage filtration system including a stainless steel sieve filter, HEPA filter, and air filter. Clean filters regularly to maintain suction power.

1. Remove the dust cup.
2. Twist and pull out the filter components (HEPA filter, stainless steel filter).
3. Tap filters gently over a trash bin to remove loose dust. For thorough cleaning, rinse the filters under running water.
4. Allow all filter components to air dry completely for at least 24 hours before reassembling. Do not use the vacuum with wet filters.
5. Replace filters as needed. Two replacement HEPA filters are included.

7.3 Cleaning the Brush Roll

The anti-tangle brush roll minimizes hair wrapping, but occasional cleaning may be necessary.

1. Ensure the vacuum is off and disconnected from the telescopic tube.
2. Locate the release tab on the side of the floor brush and open it to remove the brush roll.
3. Use the small cleaning tool provided to cut and remove any tangled hair or debris from the brush roll.
4. Reinsert the brush roll and secure the release tab.

8. TROUBLESHOOTING

If you encounter issues with your vacuum cleaner, refer to the table below for common problems and solutions. If the problem persists, contact customer support.

Problem	Possible Cause	Solution
Vacuum does not turn on	Battery not charged or improperly installed.	Ensure battery is fully charged and correctly inserted.
Low suction power	Dust cup full, filters clogged, or blockage in the hose/brush head.	Empty dust cup, clean filters, check for and remove blockages.
Brush roll not spinning	Hair or debris tangled in brush roll, or brush roll jammed.	Clean brush roll, remove any obstructions.
Short battery runtime	Battery not fully charged, or operating on high suction mode.	Fully charge battery. Use lower suction modes for longer runtime.
Smart display shows error	Indicates roller tangled or channel blocked.	Refer to the display icon and clear the indicated blockage or tangle.

9. SPECIFICATIONS

Feature	Detail
Model	JR400
Motor Wattage	450W Brushless Motor
Suction Power	Up to 40Kpa (5 adjustable levels)
Battery Capacity	7 * 2200 mAh (Removable)
Runtime	Up to 55 minutes (low suction), 15 minutes (high suction)
Charging Time	4-5 hours
Dust Cup Capacity	1.5 Liters
Filtration System	Multi-stage (Stainless steel sieve, HEPA, Air filter)
Special Features	Intelligent Touch Screen, Anti-winding Brush, LED Headlights, Adjustable Extension Tube (40-64cm)
Product Dimensions	10"L x 7"W x 17"H
Item Weight	8 pounds

10. WARRANTY AND SUPPORT

INTETURE provides a 3-year free warranty for valued customers after registration. For any product inquiries, technical assistance, or warranty claims, please contact our customer service team.

Our customer support is available 24/7 to assist you.

For more information, visit the [INTETURE Store on Amazon](#).