

Manuals+

[Q & A](#) | [Deep Search](#) | [Upload](#)

manuals.plus /

- › [Inateck](#) /
- › [Inateck Sling Bag X-Lite Instruction Manual](#)

Inateck FB01001-BK

Inateck Sling Bag X-Lite Instruction Manual

Model: FB01001-BK

Product
Overview

Key Features
Technical
Specifications

Usage
Instructions

Care and
Maintenance

Support Information

PRODUCT OVERVIEW

The Inateck Sling Bag X-Lite is a versatile and lightweight bag designed for daily use, travel, and various activities. It features multiple compartments for organized storage and a water-resistant exterior.

Dimensions and Weight

The bag measures approximately 32 cm (L) x 7 cm (W) x 17 cm (H) and weighs 270 grams.

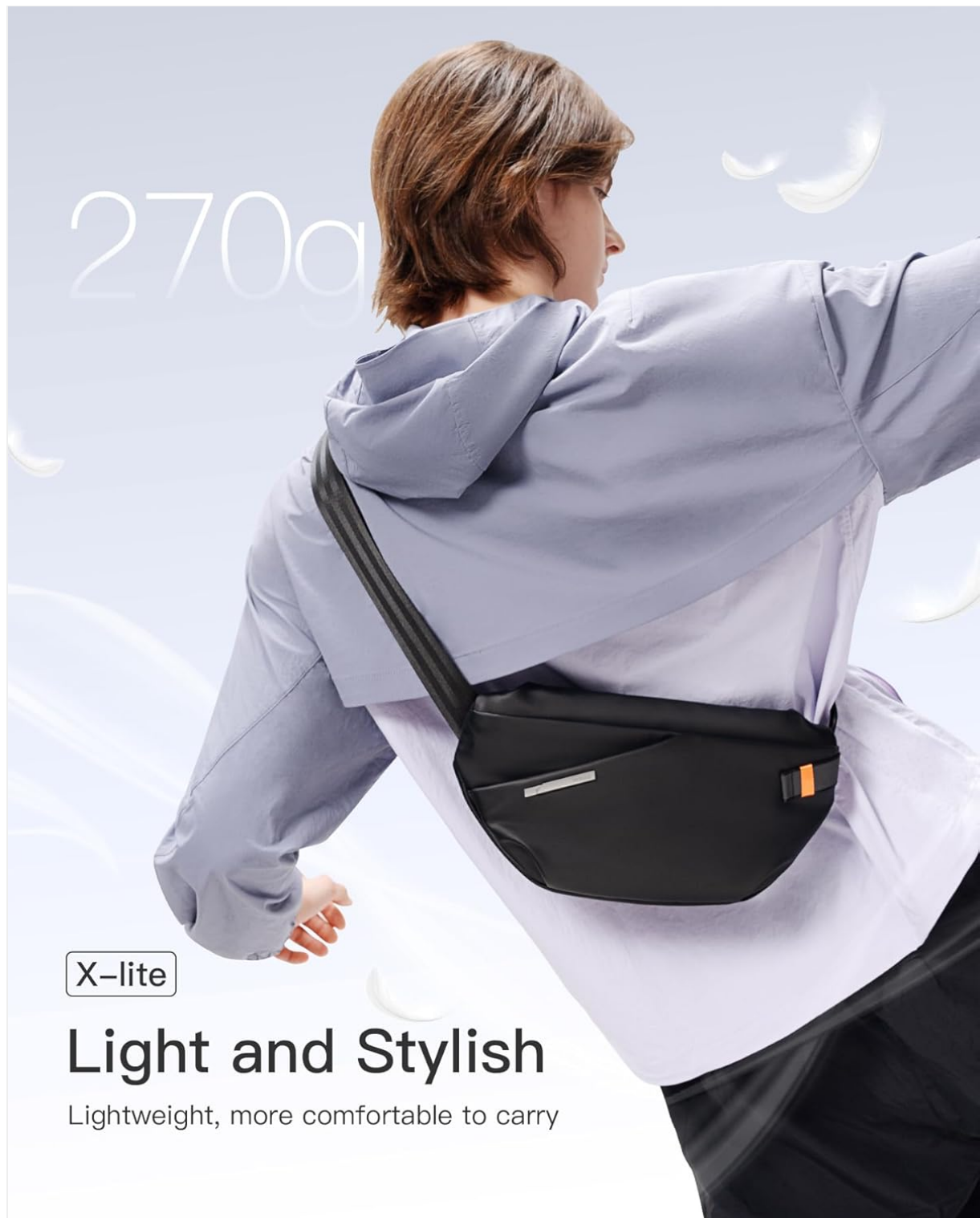

Image: Detailed diagram showing the dimensions of the Inateck Sling Bag X-Lite, including length (32 cm / 12.6 in), height (17 cm / 6.7 in), and width (7 cm / 2.8 in). The image also lists key specifications such as brand (Inateck), product name (Sling Bag), weight (270g / 0.59lb), main material (Glossy Film + 900D Polyester), dimensions (37x7x17 cm / 12.6x2.8x6.7 in), and shoulder strap range (74-122cm / 29-48in). It also shows compatibility icons for iPad Mini, Switch, Phone, Wallet, AirPods, Cards, and Sunglasses.

KEY FEATURES

Lightweight Design

Weighing only 270g, the X-Lite sling bag is designed for comfortable, extended wear without added bulk.



X-lite

Light and Stylish

Lightweight, more comfortable to carry

Image: A person wearing the Inateck Sling Bag X-Lite across their back, demonstrating its lightweight and stylish appearance. The text "X-lite Light and Stylish" is visible, emphasizing its comfort and portability.

Orderly Storage

The bag features multiple compartments with an orange lining for easy visibility of contents.

- **Front Quick-Access Compartment:** Suitable for smaller items like sunglasses or a phone.
- **Main Storage Compartment:** Compatible with devices like a Nintendo Switch or iPad Mini. Includes two mesh pockets, one key hook, and one zipper pocket.
- **Rear Hidden Pocket:** Features one hidden zipper pocket and three card slots for secure storage.

Orderly Storage

Orange lining, easy to find items



Front Quick-Access Compartment

Suitable for Sunglasses, Phone, etc



Main Storage Compartment

Compatible with Switch or iPad Mini

2* Mesh pockets
1* Key hook
1* Zipper pocket



Rear Hidden Pocket

1* Hidden zipper pocket
3* Card slots



Image: A composite image illustrating the internal organization of the Inateck Sling Bag X-Lite. It shows the front quick-access compartment, the main storage compartment with mesh pockets, a key hook, and a zipper pocket, and the rear hidden pocket with card slots. The orange interior lining is visible in all compartments.

Quick Adjustment Design

The strap can be quickly adjusted for length and features a flexible quick-release buckle for easy removal.

Quick Adjustment Design

Quick-adjust straps with one pull

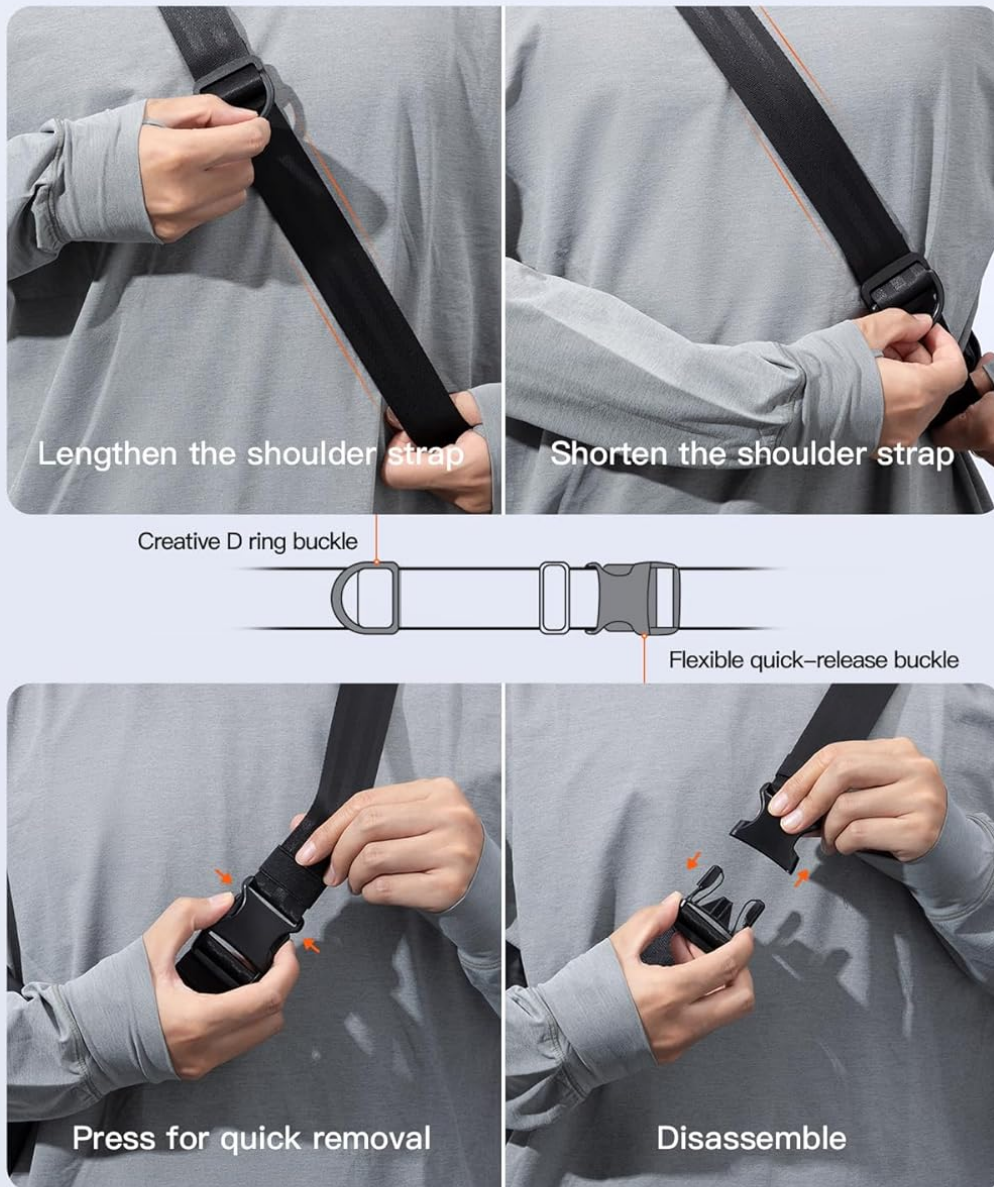

Image: A four-panel image demonstrating the quick adjustment features of the Inateck Sling Bag X-Lite strap. It shows how to lengthen and shorten the shoulder strap with one pull, the creative D-ring buckle, the flexible quick-release buckle, and how to press for quick removal and disassemble the buckle.

Durable and Protective Materials

Constructed with quality materials for longevity and protection.

- **YKK Zipper:** Ensures smooth and reliable opening and closing.
- **Reflective Webbing:** Enhances visibility for night travel protection.
- **Splashproof Fabric:** Provides resistance against water splashes.

Durable and Protective



Image: A three-panel image showcasing the durable and protective features of the Inateck Sling Bag X-Lite. It includes close-ups of the YKK zipper for smooth operation, reflective webbing for night visibility, and the splashproof fabric with water droplets on its surface.

Flexible Storage Capacity

The bag's design allows for flexible storage of various daily essentials.



Flexible Storage

Image: An artistic image depicting the Inateck Sling Bag X-Lite with various items such as a smartwatch, earbuds, power bank, cables, and a USB hub floating around it, illustrating its flexible storage capabilities for everyday carry items.

USAGE INSTRUCTIONS

Wearing the Bag

The Inateck Sling Bag X-Lite can be worn in multiple ways, including as a crossbody bag, shoulder bag, chest bag, or waist pack.

1. Place the bag on your preferred position (e.g., across your chest, back, or waist).
2. Adjust the strap length using the quick-adjust mechanism until it fits comfortably and securely. Refer to the "Quick Adjustment Design" section for details.
3. Ensure the bag does not impede your movement or cause discomfort.



Image: A man wearing the Inateck Sling Bag X-Lite across his back while sitting on a skateboard, demonstrating a typical way to wear the bag for casual use.

Accessing Compartments

Utilize the YKK zippers to open and close the compartments. The front compartment is ideal for items needing quick access, while the main and rear pockets offer more secure storage.

CARE AND MAINTENANCE

Cleaning Instructions

To clean the Inateck Sling Bag X-Lite, wipe it with a damp cloth. Do not machine wash, bleach, tumble dry, or iron. Avoid harsh detergents or abrasive cleaners.

Storage

Store the bag in a cool, dry place away from direct sunlight when not in use.

TROUBLESHOOTING

Zipper Issues

If a zipper becomes stiff, apply a small amount of zipper lubricant or a graphite pencil lead to the teeth. Avoid forcing the zipper.

Water Resistance

While the fabric is splashproof, the bag is not fully waterproof. Avoid submerging the bag in water or exposing it to heavy rain for extended periods.

TECHNICAL SPECIFICATIONS

Feature	Detail
Product Dimensions	32 x 7 x 17 cm
Item Weight	270 g
Item Model Number	FB01001-BK
Department	Unisex
Closure Type	Zipper
Water Resistance Level	Water Resistant (Splashproof)
Care Instructions	Wipe with a damp cloth

SUPPORT INFORMATION

Customer Service

For any questions, concerns, or support regarding your Inateck Sling Bag X-Lite, please contact Inateck customer service. Refer to the official Inateck website for contact details.

Warranty

Information regarding product warranty can typically be found on the official Inateck website or included with your purchase documentation. Please retain your proof of purchase for warranty claims.