

## Solareye TCYW

# Solareye Wildlife Camera User Manual

Model: TCYW

## INTRODUCTION

This manual provides detailed instructions for the setup, operation, maintenance, and troubleshooting of your Solareye Wildlife Camera (Model TCYW). Please read this manual thoroughly before using the camera to ensure optimal performance and longevity.

The Solareye Wildlife Camera is designed for outdoor use, featuring 2.7K video recording, 48MP photo resolution, and advanced night vision capabilities. It offers multiple power options, including an integrated solar panel, a built-in 5000mAh lithium battery, and support for AA batteries, ensuring continuous operation in various environments. Its IP66 waterproof rating makes it suitable for diverse weather conditions.

## PACKAGE CONTENTS

Upon opening the package, verify that all the following items are included:

- Solareye Wildlife Camera
- Solar Panel
- 32GB SD Card
- Mounting Strap
- USB-C Cable
- Mounting Brackets
- Metal Base
- Screws
- Rubber Plugs
- User Manual

## Schritte zur Verbindung mit der App „Trailcam Go“

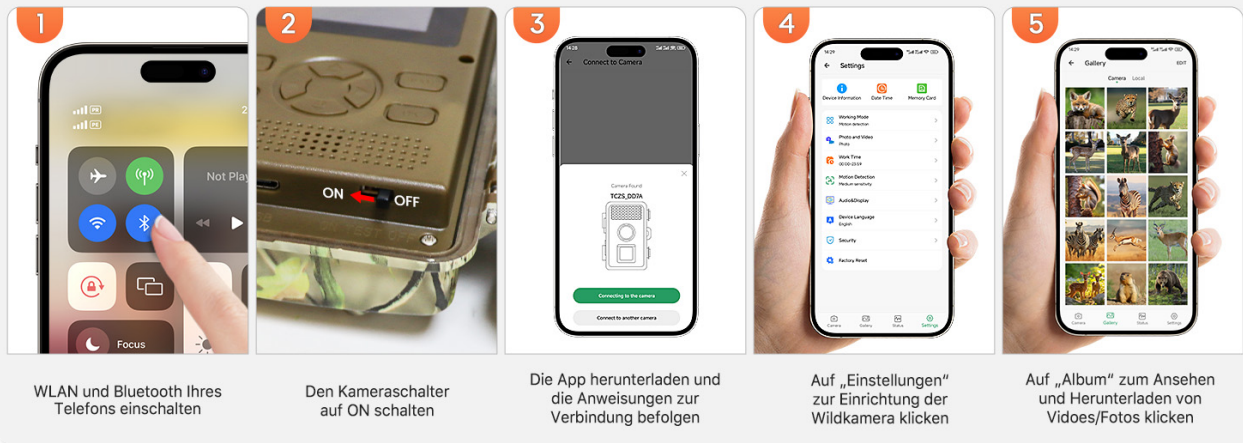

Figure 1: Included components of the Solareye Wildlife Camera package.

## SETUP

### 1. Power Supply Options

The Solareye Wildlife Camera offers three power supply methods:

1. **Integrated Solar Panel:** The camera features a built-in 5000mAh lithium battery that can be continuously charged by the external 3W solar panel. This is the primary recommended power source for long-term outdoor deployment.
2. **USB-C Cable:** The camera's internal battery can be recharged using the provided USB-C cable and a compatible power adapter (not included).
3. **AA Batteries:** For emergency backup or in situations where solar charging is not feasible, 4 AA batteries (not included) can be inserted.

# Lange Nutzungsdauer im Freien, 3 Stromversorgungsmethoden



Figure 2: Power supply options for the Solareye Wildlife Camera.



Figure 3: Solar panel providing continuous power to the camera.

## 2. Inserting SD Card and Batteries

Before initial use, ensure the SD card is inserted and power is supplied.



1. Open the camera casing.
2. Insert the provided 32GB SD card into the designated slot. Ensure it clicks into place.
3. If using AA batteries, insert 4 AA batteries into the battery compartment, observing correct polarity.
4. Close the camera casing securely to maintain its IP66 waterproof rating.

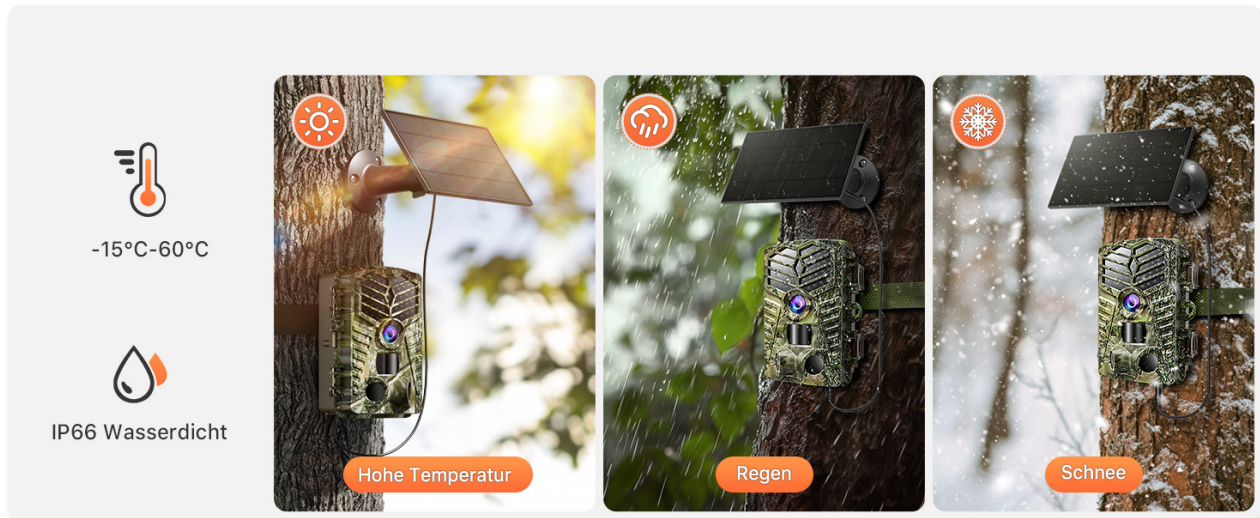

Figure 4: Steps for battery and SD card installation.

### 3. Mounting the Camera

The camera can be mounted using the provided strap or mounting brackets.

- **Strap Mounting:** Thread the mounting strap through the slots on the back of the camera and secure it around a tree or pole.
- **Bracket Mounting:** Use the metal base, screws, and rubber plugs to attach the mounting brackets to a desired surface. Then, secure the camera to the brackets. The ball joints on the brackets allow for flexible adjustment of the camera's angle.

Position the camera to ensure the solar panel receives adequate sunlight throughout the day for optimal charging. Consider the 120° detection angle and 25-meter detection distance when choosing a location.



Figure 5: Solareye Wildlife Camera and accessories.

## Drei Stromversorgungsmethoden

Wiederaufladbare Wildkamera mit Solarpanel und Typ C-Netzkabel im Lieferumfang enthalten, AA-Batterien nicht im Lieferumfang enthalten.



Figure 6: Camera detection area and PIR sensors.



## 1. Camera Modes

The camera has three main modes controlled by a switch inside the casing:

- **OFF:** Camera is powered off.
- **TEST:** The screen lights up, allowing you to set operating mode, parameters, and view images/videos. In this mode, the camera will not record automatically.
- **ON:** After a 10-second countdown, the screen turns off, and the camera enters motion detection mode, ready to record.

**Note:** For first-time use, set the switch to TEST to configure settings like video/photo resolution and other parameters before switching to ON.

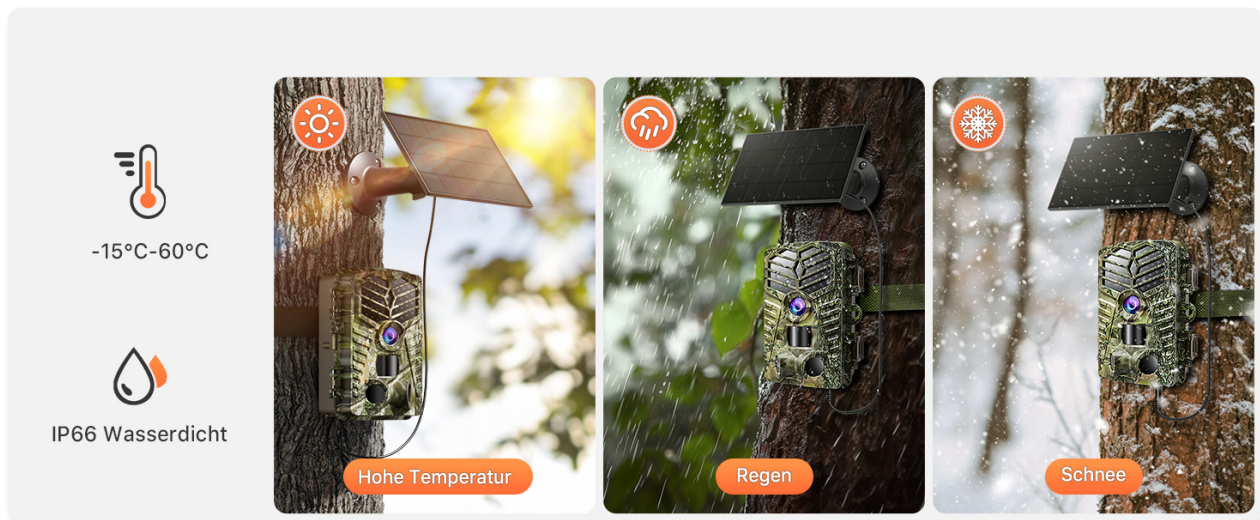

Figure 7: Camera mode switch and functions.

## 2. Connecting to the "Trailcam Go" App

The camera can be connected to your smartphone via Wi-Fi and Bluetooth for remote access and control within a 15-meter range. **Note: The camera does not support connection to home routers.**

1. Enable Wi-Fi and Bluetooth on your smartphone.
2. Switch the camera to the ON position.
3. Download the "Trailcam Go" app from your smartphone's app store.
4. Follow the in-app instructions to connect to the camera.
5. Once connected, click on "Settings" in the app to configure camera parameters.
6. Access the "Album" section to view and download recorded videos and photos.

# WLAN Verbindung & App Fernzugriff

**Hinweis:** Unterstützt keine Verbindung zu Heimroutern

15M

TrailCam Go APP

Live Video ansehen

50 ft

Verbindung zur Kamera-WLAN (innerhalb von 15 Metern)

Videos herunterladen

Figure 8: App connection and remote access.

## Ultraschnelle Auslösegeschwindigkeit von 0,2s

Schnell Auslösen, verpassen Sie nie wieder die Tieraufnahme.

0.2s

Figure 9: Step-by-step guide for app connection.

### 3. Recording Features

- Photo Resolution: 48MP



- **Video Resolution:** 2.7K
- **Trigger Speed:** 0.2 seconds, ensuring quick capture of moving subjects.
- **Photo Burst:** 1-5 photos per trigger.
- **Night Vision:** Equipped with 40-940nm non-glowing infrared lights for clear black-and-white images at night without disturbing animals. Night vision range is up to 20 meters.
- **Fill Light Technology:** Prevents overexposure or excessive dimming in night recordings.
- **Other Functions:** Time-lapse recording, timed recording, continuous shooting, audio recording, and password protection.

## Klare Nachtsicht

26pcs 940nm Now-Glow Nachtsicht, zeichnet sich bewegende Tiere im Umkreis von 20 Metern im Dunkeln deutlich auf

20M

26pcs 940nm Infrarotlichter

Zu dunkel

Überbelichtet

Figure 10: Night vision capabilities.



# WLAN Bluetooth-Verbindung & App-Fernzugriff

Greifen Sie aus der Ferne auf Wildtierkamera Solar innerhalb von 15 Metern zu.  
**Hinweis:**Unterstützt keine Heim-Router-Verbindungen.

15M

Hinweis:Die effektive WLAN-Reichweite beträgt 15 Meter.

Figure 11: Ultra-fast trigger speed.

REC

# klare Nachtsicht

940 nm No-Glow Nachtsicht,20 Meter lange Nachtsichtweite, um sicherzustellen, dass Sie Tiere weit genug entfernt sehen.

20M

Figure 12: Detailed night vision performance.

# Schnelle Installation

1

4 Batterien einlegen (optional)

2

SD Karte einlegen

3

Auf „TEST“zum Einstellen der Kameraparameter schalten

# Einfache Bedienung

OFF	Kamera ausschalten
Test	Der Bildschirm leuchtet auf und Sie können den Arbeitsmodus, Parameter usw. einstellen und Videos/Fotos ansehen.ansehen.
ON	Warten Sie 10 Sekunden, bis sich der Bildschirm ausschaltet und die Kamera in den Bewegungserkennungsmodus wechselt.
Hinweis	Wenn Sie es zum ersten Mal verwenden, schalten Sie bitte zuerst auf TEST, stellen Sie die Kamerabetriebszeit, den Arbeitsmodus, die Video-/Fotoauflösung und andere Parameter ein, schalten Sie dann auf "ON" und die Wildkamera wechselt in den Arbeitsmodus und der Bildschirm geht aus.

Figure 13: 2.7K Video and 48MP Photo quality.

# MAINTENANCE



- **Cleaning:** Regularly clean the camera lens and solar panel with a soft, dry cloth to ensure clear images and efficient charging.
- **Battery Check:** Periodically check the battery level via the app or on the camera's internal screen. Recharge or replace AA batteries as needed.
- **SD Card Management:** Format the SD card regularly to prevent data corruption and ensure optimal recording performance. Back up important footage before formatting. The camera supports loop recording, overwriting the oldest files when the SD card is full.
- **Environmental Protection:** The camera is IP66 waterproof, making it resistant to rain, snow, and dust. However, avoid submerging the camera in water. Ensure the casing is securely closed at all times.

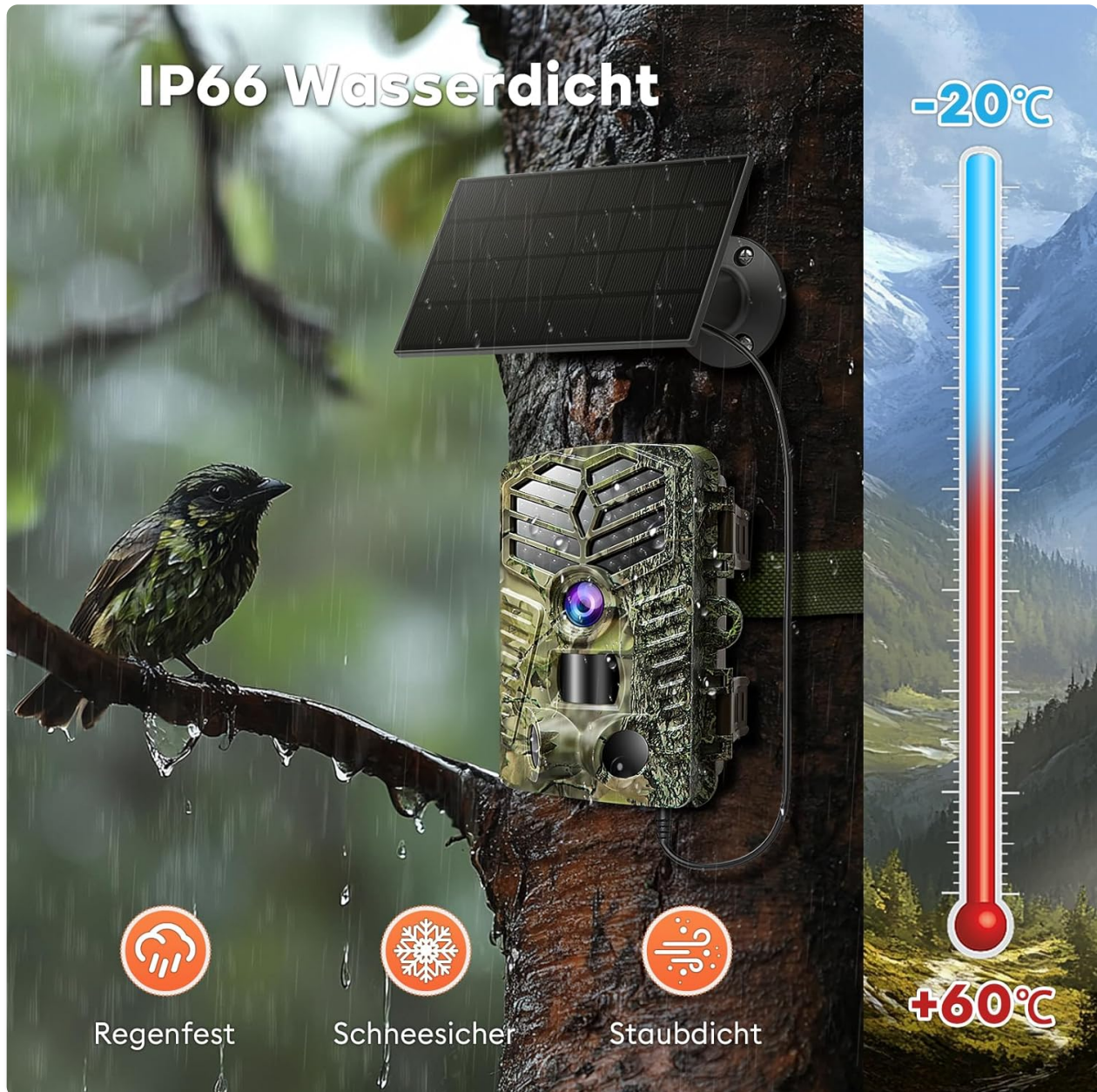

Figure 14: IP66 Waterproof and weather resistance.



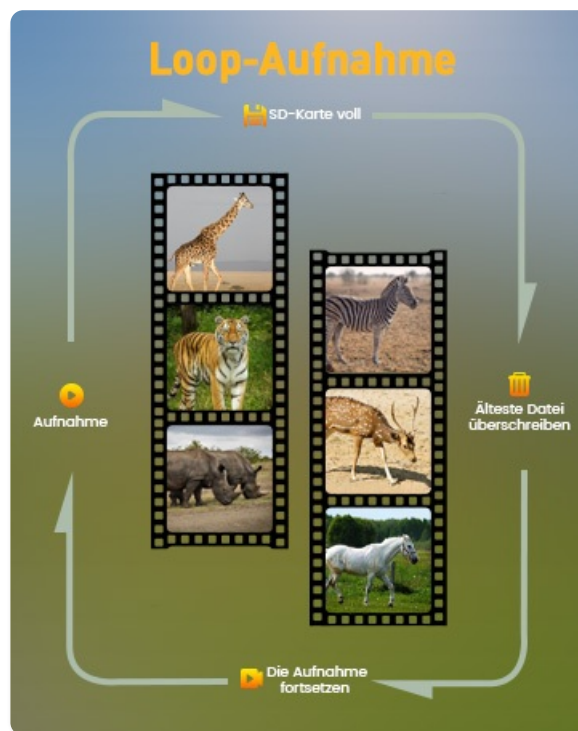

Figure 15: Loop recording functionality.

## TROUBLESHOOTING

Problem	Possible Cause	Solution
Camera not turning on.	Low battery or no power. Incorrect battery insertion.	Ensure the solar panel is exposed to sunlight, recharge via USB-C, or insert fresh AA batteries with correct polarity.
Cannot connect to the app.	Wi-Fi/Bluetooth not enabled on phone. Camera not in ON mode. Out of 15m range. Attempting to connect to home router.	Ensure phone's Wi-Fi and Bluetooth are on. Set camera to ON. Move closer to the camera (within 15 meters). Remember, router connection is not supported.
Poor image/video quality at night.	Lens dirty. Subject too far. Obstruction in front of IR lights.	Clean the lens. Ensure subjects are within 20m night vision range. Clear any obstructions.
Camera not recording motion.	PIR sensor obstructed. Sensitivity settings too low. Camera in TEST mode.	Ensure PIR sensors are clear. Adjust PIR sensitivity in settings. Switch camera to ON mode.
SD card error.	SD card full, corrupted, or incompatible.	Format the SD card (back up data first). Try a different compatible SD card (up to 128GB).

## SPECIFICATIONS

---

- Model: TCYW
- Photo Resolution: 48MP
- Video Resolution: 2.7K
- Trigger Speed: 0.2 seconds
- Detection Angle: 120°
- Detection Distance: 25 meters
- Night Vision Range: 20 meters
- Infrared Lights: 40-940nm No-Glow IR LEDs
- Connectivity: Wi-Fi, Bluetooth (App connection within 15m)
- Power Source: Integrated 5000mAh Lithium Battery, 3W Solar Panel, 4x AA Batteries (not included)
- Storage: Supports up to 128GB SD card (32GB included)
- Waterproof Rating: IP66
- Operating Temperature: -20°C to +60°C
- Dimensions (L x W x H): 10.2 x 8.1 x 13.8 cm
- Weight: 258 grams





## 2.7K & 48MP Wildkamera WLAN mit Solarpanel

				
2.7K Video	48MP Foto	0.2S Auslösezeit	5 Fotoserien	Bewegungs erkennung
				
Zeitraffer aufnahme	WLAN & Bluetooth	IP66 Wasserdicht	Aufladen über Typ-C	Solarpanel

Figure 16: Product dimensions and key features.

## WARRANTY AND SUPPORT

Solareye offers a standard warranty for this product. For specific warranty terms and conditions, please refer to the documentation included with your purchase or contact Solareye customer support.

For technical assistance, troubleshooting, or warranty claims, please contact Solareye customer support.

Contact information can typically be found on the product packaging or the official Solareye website.

This product is verified by Transparency, with each item having a special code checked before shipping to ensure authenticity.

The product was first available on Amazon.de on **August 20, 2024**.

## IMPORTANT INFORMATION

## Recycling and Disposal

Please dispose of the product and its components responsibly according to local regulations. Information regarding the recycling of lamps and disposal of broken or damaged lamps can be found through relevant local authorities or recycling centers.

© 2024 Solareye. All rights reserved.