

Spacekey TM-8007

Spacekey Electric Body Hair Trimmer User Manual

Model: TM-8007

INTRODUCTION

This manual provides essential information for the safe and effective operation, maintenance, and troubleshooting of your Spacekey Electric Body Hair Trimmer. Please read this manual thoroughly before first use and retain it for future reference.



Image: The Spacekey Electric Body Hair Trimmer, showcasing the device and its retail packaging.

SAFETY INFORMATION

For your safety and to prevent damage to the device, observe the following precautions:

- Avoid use on open wounds or irritated skin.
- Do not use the trimmer while it is charging.
- Exercise caution when trimming sensitive areas.
- Keep the device out of reach of children.
- When trimming in low light conditions, utilize the built-in LED light to ensure clear visibility and reduce the risk of injury.

SETUP

Package Contents

Verify that all items are present in the package:

- 1 x Body Trimmer
- 1 x Charging Dock
- 4 x Guide Combs (3mm, 6mm, 9mm, 12mm)
- 1 x Cleaning Brush
- 1 x USB Cable
- 1 x Lubricating Oil
- 1 x Storage Bag
- 1 x User Manual (this document)



Image: The Spacekey Electric Body Hair Trimmer displayed with its full set of accessories, including guide combs, charging dock, USB cable, cleaning brush, lubricating oil, and storage bag.

Initial Charging

Before first use, fully charge the trimmer. Connect the USB-C cable to the charging dock and then to a compatible USB power source (e.g., adapter, PC, laptop, power bank, car charger). Place the trimmer onto the charging dock. A full charge typically takes approximately 1.5 hours and provides up to 90 minutes of runtime.



Image: The Spacekey Electric Body Hair Trimmer shown connected to its charging dock via a USB-C cable, illustrating the charging process.

Blade Installation and Removal

The trimmer features a detachable ceramic blade for easy cleaning and maintenance.

1. **To Remove:** With your thumb, press the blade forward and push it out from the trimmer head.
2. **To Install:** Align the blade with the slot on the trimmer head and snap it into place until it clicks securely.

HOW TO USE

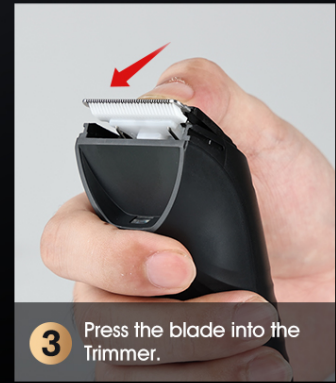
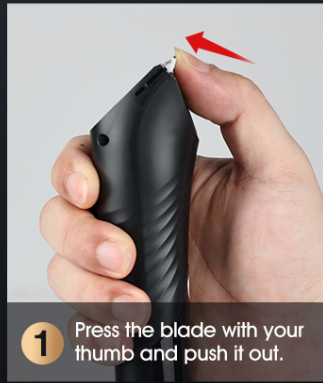

Image: A step-by-step visual guide demonstrating the process of detaching and reattaching the trimmer blade for cleaning or replacement.

Attaching Guide Combs

Select the desired trimming length using one of the four adjustable guide combs (3mm, 6mm, 9mm, 12mm). Snap the chosen comb securely onto the trimmer blade until it locks into position.

OPERATING INSTRUCTIONS

Power On/Off and LED Display

Press the power button to turn the trimmer on or off. The integrated LED display shows the current RPM, available trimming time, and battery percentage, providing clear operational status.



Image: A detailed view of the trimmer's LED screen, highlighting the digital display of RPM, available time, and battery charge level.

Wet and Dry Use (IPX7 Waterproof)

The Spacekey trimmer is IPX7 waterproof, allowing for safe and convenient use in both wet and dry conditions. You can comfortably trim in the shower, as water helps to rinse away trimmed hair, simplifying cleanup.

IPX7

WATERPROOF



Image: The Spacekey Electric Body Hair Trimmer partially submerged in water, illustrating its IPX7 waterproof capability for wet use.

Trimming Techniques and Blade Features

The trimmer is equipped with an upgraded R-shaped ceramic blade designed to minimize nicks, cuts, and irritation. Its high-speed 7000 RPM motor ensures efficient trimming across various body regions.

- **General Body Trimming:** Suitable for chest, armpits, back, arms, and legs. Use with or without a guide comb depending on desired length.
- **Sensitive Areas:** Designed for below-the-waist grooming (pubic and groin areas). The ceramic blade and protective design help ensure a smooth and comfortable experience, reducing the risk of pulling or snagging.
- **LED Light:** Activate the built-in LED light for enhanced visibility in dimly lit areas, ensuring precise and safe trimming.

UPGRADED R-SHAPED CERAMIC BLADE



Security



Detachable



LDE Light

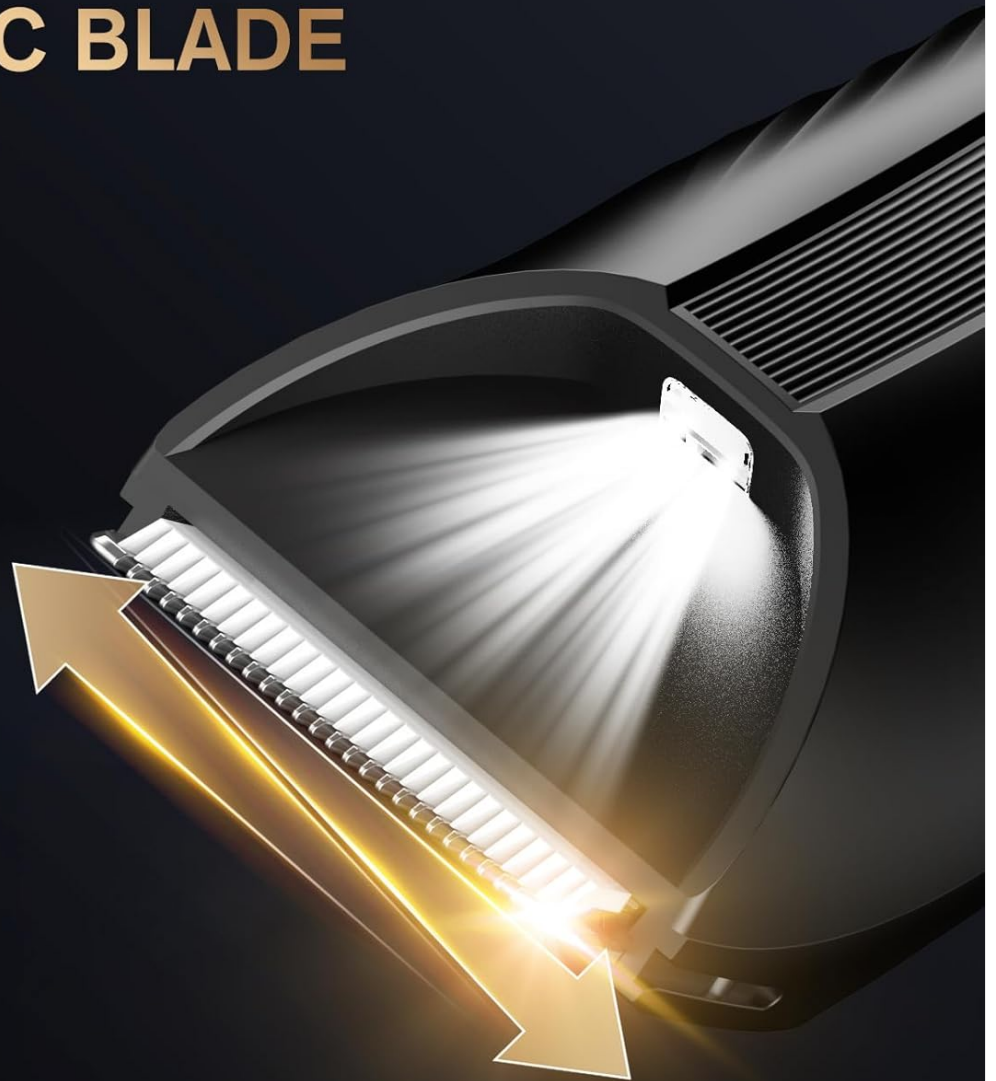

Image: A detailed view of the trimmer's R-shaped ceramic blade and the integrated LED light, highlighting features for safe and precise trimming.

NO PAIN, NO PULLING

Say Goodbye to Cuts, Nicks, Pulling, Tugging and Sings.



Image: An illustration of the trimmer being used for body grooming, emphasizing its design for comfortable and effective hair removal without pain or pulling.

Travel Lock Function

To prevent accidental activation during travel or storage, the trimmer features a travel lock. Press and hold the power button for 3 seconds to activate the travel lock. Repeat the action (press and hold for 3 seconds) to deactivate it.



Image: The trimmer's LED display showing the activated travel lock icon, indicating the device is secured against accidental power-on.

MAINTENANCE

Cleaning the Trimmer

Regular cleaning ensures optimal performance and hygiene:

- After each use, turn off the trimmer and remove the guide comb.
- Detach the blade as described in the Setup section.
- Use the provided cleaning brush to remove any trapped hair from the blade and the trimmer body.
- Since the trimmer is waterproof, you can rinse the blade and the trimmer head under running water. Ensure the trimmer is off and disconnected from any power source before rinsing.
- Allow all parts to air dry completely before reassembling or storing.

Lubrication

To maintain blade sharpness and smooth operation, apply a small drop of the provided lubricating oil to the blades after every few uses, especially after rinsing with water. Turn the trimmer on for a few seconds to distribute the oil evenly.

Storage

Store the trimmer in a cool, dry place, away from direct sunlight and moisture. Use the provided travel bag for protection when not in use or during travel.

TROUBLESHOOTING

Problem	Possible Cause	Solution
Trimmer does not turn on.	Battery is depleted. Travel lock is activated.	Charge the trimmer fully. Deactivate the travel lock by pressing and holding the power button for 3 seconds.
Blade not cutting effectively or pulling hair.	Hair buildup on blade. Blade needs lubrication. Blade is dull or damaged.	Clean the blade thoroughly with the brush and water. Apply lubricating oil to the blade. Consider replacing the blade if it remains dull after cleaning and lubrication.

Problem	Possible Cause	Solution
Trimmer stops working during use.	Battery is low.	Recharge the trimmer.
LED display is not working.	Device malfunction.	Contact customer service for assistance.

If you encounter issues not listed here or if the problem persists after attempting the solutions, please refer to the [Warranty and Customer Support](#) section for assistance.

SPECIFICATIONS

Feature	Detail
Model Number	TM-8007
Brand	Spacekey
Power Source	USB-C Rechargeable (1 AA battery included)
Motor Speed	7000 RPM
Blade Type	R-shaped Ceramic Blade
Waterproof Rating	IPX7
Battery Life	Up to 90 minutes per full charge
Charging Time	Approx. 1.5 hours
Included Guide Combs	3mm, 6mm, 9mm, 12mm
Item Weight	0.33 Kilograms (11.68 ounces)
Color	Black
Recommended Uses	Genital, Leg, Pubic, Under Arm

WARRANTY AND CUSTOMER SUPPORT

Spacekey stands behind the quality and durability of its products. Your purchase includes:

- **30-Day Refund Policy:** If you are not satisfied with your purchase, you may be eligible for a refund within 30 days.
- **2-Year Replacement Warranty:** The product is covered by a 2-year replacement warranty for manufacturing defects.
- **Lifetime Customer Service:** For any questions, concerns, or assistance, our customer service team is available to help. We aim to reply to all inquiries within 24 hours.

For support, please contact Spacekey customer service through the platform where you purchased the product or refer to the contact information provided on the product packaging or official Spacekey website.

