

YUNZII B75 PRO

YUNZII B75 PRO Wireless Mechanical Keyboard User Manual

Model: B75 PRO

1. INTRODUCTION

Thank you for choosing the YUNZII B75 PRO Wireless Mechanical Keyboard. This manual provides detailed instructions for setting up, operating, and maintaining your keyboard to ensure optimal performance and user experience. The B75 PRO features a 75% layout, tri-mode connectivity, hot-swappable switches, and customizable RGB backlighting.



2. PACKAGE CONTENTS

Please verify that all items are present in your package:

- YUNZII B75 PRO Wireless Mechanical Keyboard
- Keycap Puller
- USB Type-C Cable
- User Manual (this document)



Image 2.1: Contents of the YUNZII B75 PRO keyboard package, including the keyboard, USB cable, and keycap puller.

3. SETUP AND CONNECTIVITY

3.1 Connection Modes

The YUNZII B75 PRO supports three connection modes: Bluetooth, 2.4GHz Wireless, and Wired (USB Type-C).

Wired Mode:

Connect the keyboard to your device using the provided USB Type-C cable. The keyboard will automatically switch to wired mode. This mode also charges the keyboard battery.

2.4GHz Wireless Mode:

Press **FN + 4** to activate 2.4GHz wireless mode. Insert the 2.4GHz USB receiver into your device. The keyboard will connect automatically.

Bluetooth Mode:

The keyboard supports up to three Bluetooth devices. Press **FN + 1**, **FN + 2**, or **FN + 3** to select a Bluetooth channel. The indicator light will flash, indicating pairing mode. On your device, search for "YUNZII B75 PRO" and connect.

3 CONNECTION MODES

Support Bluetooth / 2.4GHz Wireless / Wired



Bluetooth

FN + 1 / 2 / 3



3 bluetooth devices switchable

2.4GHz Wireless

FN + 4



Polling rate: 1000hz

Type-C wired

Plug and play



Wired connection

Image 3.1: Visual guide for switching between Bluetooth, 2.4GHz wireless, and wired Type-C connection modes.

3.2 Battery Information

The keyboard is equipped with a 4000mAh battery. To check the battery level in wireless mode, press **FN + Right Ctrl**. The corresponding number row keys will light up to indicate the charge level (e.g., 1-3 for 25%, 1-5 for 50%, etc.).

When the battery is below 15%, the red light below the spacebar will flash slowly. During charging, the spacebar will glow green. Once fully charged, the spacebar light will return to its normal RGB mode.



Image 3.2: Illustration of how to check the battery level using the FN + Right Ctrl key combination.

3.3 Compatibility

The YUNZII B75 PRO is compatible with Windows and MacOS operating systems, and can be used with various devices including laptops, PCs, smartphones, and tablets.



Image 3.3: The YUNZII B75 PRO keyboard connected to various devices, demonstrating its multi-device compatibility.

4. OPERATING INSTRUCTIONS

4.1 Multimedia Control Knob

The multi-function knob located on the top right of the keyboard provides quick control over multimedia and RGB settings.

Mode Switching: Long press the knob to switch between Multimedia Mode (default) and RGB Mode.

Multimedia Mode:

- Rotate the knob: Adjust volume (up/down).
- Press the knob: Mute/unmute audio.

RGB Mode:

- Rotate the knob: Increase/decrease RGB backlight brightness.
- Press the knob: Change RGB backlight effect.



Image 4.1: Detailed view of the multi-function knob and its controls for multimedia and RGB settings.

4.2 RGB Backlighting Control

The keyboard features over 20 built-in RGB backlight modes. Use the following key combinations to control the lighting effects:

- FN + INSERT:** Change backlight effect.
- FN + Backspace:** Turn backlight effect ON/OFF.
- FN + ↑ / ↓:** Adjust backlight brightness.
- FN + ← / →:** Adjust backlight blinking speed.
- FN + END:** Change backlight color.
- FN + PGUP:** Change lighting effect direction.
- FN + Space:** Customize backlight color (requires software).

GASKET STRUCTURE

Gasket Structure 5-Layer Padding

- | | |
|-------------------------------|--------------------------|
| 1. Function knob | 11. IXPE switch pad |
| 2. 2.4GHz receiver | 12. PET pad |
| 3. Double shot PBT keycaps | 13. PCBA |
| 4. Keyboard Frame | 14. Switch Foam |
| 5. Pre lubed Stabilizer | 15. Switch socket |
| 6. Silicone spacebar Fillings | 16. Bottom silicone pad |
| 7. Mechanical switches | 17. 4000mAh battery |
| 8. Elastic arm | 18. Keyboard bottom Case |
| 9. PC plate | 19. Kickstand |
| 10. Sandwich Foam | 20. Anti-slip bottom pad |

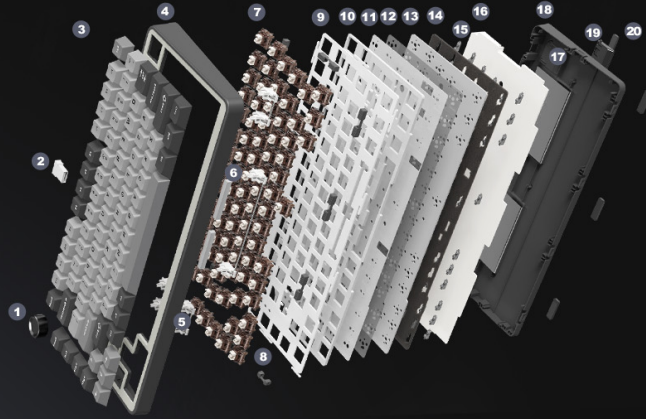

Image 4.2: Key combinations for controlling RGB backlight effects, brightness, speed, and color.

4.3 FN Key Shortcuts (Windows)

The keyboard includes dedicated FN key shortcuts for quick access to various functions in Windows:

Key Combination	Function
FN + F1	Open Computer
FN + F2	Open Homepage
FN + F3	Open Calculator
FN + F4	Open Media Player
FN + F5	Previous Song
FN + F6	Next Song
FN + F7	Play/Pause
FN + F8	Stop
FN + F9	Mute
FN + F10	Volume Down
FN + F11	Volume Up
FN + F12	Open Mail



Image 4.3: A visual representation of the FN key shortcuts for Windows operating systems.

4.4 Programmable Software

The YUNZII B75 PRO features programmable software for advanced customization of key assignments, macros, and RGB lighting effects. **Note: This software is compatible only with Windows operating systems.**

Please refer to the official YUNZII website for software download and detailed instructions on its usage.



Image 4.4: Screenshots of the YUNZII B75 PRO programmable software interface, showing options for light settings, button settings, and macro management.

5. MAINTENANCE

5.1 Cleaning

To maintain the keyboard's appearance and functionality, regularly clean it with a soft, dry cloth. For deeper cleaning, you may use a keycap puller to remove keycaps and clean dust or debris from beneath them. Avoid using harsh chemicals or abrasive materials.

5.2 Hot-Swappable Switches

The B75 PRO features hot-swappable sockets, allowing you to easily change mechanical switches without soldering. It is compatible with both 3-pin and 5-pin switches. Use the provided switch puller to carefully remove and insert switches.

Image 5.1: Demonstration of the hot-swappable feature, showing switches being removed and inserted into the keyboard's PCB.



Image 5.2: Close-up of the Cocoa Cream V2 switch, detailing its specifications and linear type.

6. TROUBLESHOOTING

If you encounter any issues with your YUNZII B75 PRO keyboard, please refer to the following common solutions:

Q1: Why is the red light flashing below the spacebar?

A: This indicates that the keyboard battery is below 15%. Please connect the keyboard to a power source using the USB Type-C cable to charge it. During charging, the spacebar will glow green. Once fully charged, the light will return to normal RGB mode.

Q2: The keyboard is not working or charging. How do I resolve this?

A: First, ensure the USB Type-C cable is securely connected to both the keyboard and your device. If the issue persists, try updating the keyboard's firmware. Download the latest firmware from the official YUNZII website. Ensure no other software is running in the background during the update process. Perform the firmware update while the keyboard is in wired mode.

Q3: The Windows (Win) key is not working.

A: Press **FN + WIN** to unlock the Windows key. This should resolve the issue.



Image 6.1: Common troubleshooting questions and their solutions for the YUNZII B75 PRO keyboard.

7. SPECIFICATIONS

Detailed technical specifications for the YUNZII B75 PRO Wireless Mechanical Keyboard:

Feature	Specification
Model Number	B75 PRO
Layout	75% (82 keys + knob)
Connectivity	Bluetooth, 2.4GHz Wireless, USB Type-C Wired
Switches	Hot-swappable (3-pin/5-pin compatible), Pre-lubed Cocoa Cream V2 Linear Switches
Keycaps	Double Shot PBT
Backlighting	RGB (South-facing LEDs, 20+ modes)
Battery Capacity	4000mAh
Gasket Structure	Yes, with 5-layer padding
Programmable	Yes (Windows software only)
Product Dimensions	13.17 x 13.17 x 1.66 inches
Item Weight	1.98 pounds
Material	Plastic
Manufacturer	YUNZII

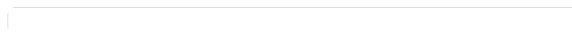

Image 7.1: Exploded view of the YUNZII B75 PRO's gasket structure with 5-layer padding, highlighting internal components.

8. WARRANTY AND SUPPORT

For warranty information, technical support, or further assistance, please visit the official YUNZII website or contact their customer service directly. Keep your purchase receipt as proof of purchase for warranty claims.