

HUOTO D11

HUOTO Portable Power Bank for Apple Watch

Model: D11 | Brand: HUOTO

1. INTRODUCTION

The HUOTO Portable Power Bank is a compact and efficient wireless charger designed specifically for Apple Watch models. With its built-in 1200mAh battery and magnetic charging capability, it offers a convenient solution for charging your Apple Watch on the go without the need for cables.

Key Features:

- **Designed for Apple Watch:** Compatible with Apple Watch Series 1 through 10, SE, Ultra, and Ultra 2 (49mm, 45mm, 44mm, 42mm, 41mm, 40mm, 38mm).
- **Integrated Power Bank:** Features a 1200mAh battery, providing 1-1.5 full charges for your Apple Watch.
- **Magnetic Wireless Charging:** Ensures correct alignment and instant charging upon contact.
- **Mini & Compact Design:** Keychain design for easy portability, ideal for travel and daily use.
- **Intuitive Indicator Lights:** Displays battery level (0-30% Red, 30-60% Blue, 60-100% Green).
- **Safety Protection:** Built-in safeguards against over-current, over-voltage, short-circuit, and over-heat.
- **USB-C Input:** Recharges the power bank via the included Type-C cable.



Figure 1.1: HUOTO Portable Power Bank for Apple Watch (Dark Orange)

Small and Portable

The small size is suitable for daily work or travel carry, never worry about your Apple Watch running out of battery



Figure 1.2: The compact size and keychain design make it highly portable for various uses.

2. WHAT'S IN THE BOX

- 1 x Wireless Watch Charger (HUOTO Portable Power Bank)
- 1 x Metal Keychain
- 1 x USB-C Charging Cable
- 1 x User's Manual (this document)

3. SETUP

3.1 Initial Charging of the Power Bank

Before first use, fully charge your HUOTO Power Bank. Connect the included USB-C charging cable to the Type-C input port on the power bank and plug the other end into a compatible USB power

source (e.g., computer, wall adapter). The indicator light will show the charging status:

- **Red Light:** 0-30% charged
- **Blue Light:** 30-60% charged
- **Green Light:** 60-100% charged



Easy Charging

Plug the type-c cable into your computer or USB device to start charging the portable wireless charger

Figure 3.1: Plug the Type-C cable into your computer or USB device to charge the power bank.

3.2 Attaching the Metal Keychain

The included metal keychain can be attached to the leather tab on the power bank for easy carrying. Simply open the keychain ring and slide the leather tab through it, then secure the ring.

PRODUCT CONSTRUCT

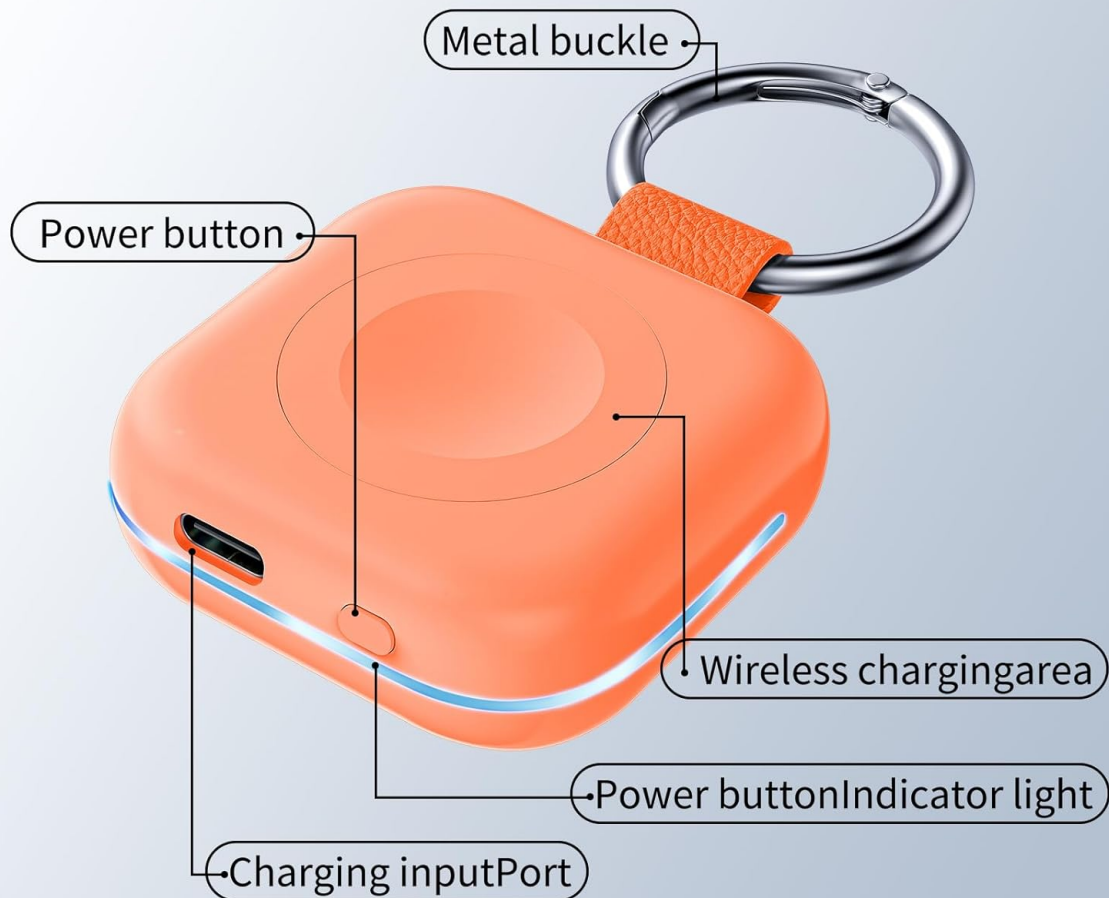

Figure 3.2: Diagram showing the power button, charging input port, wireless charging area, and metal buckle attachment point.

4. OPERATING INSTRUCTIONS

4.1 Charging Your Apple Watch

1. Ensure the power bank is sufficiently charged (check indicator light).
2. Press the power button once to turn on the power bank. The indicator light will illuminate.
3. Place your Apple Watch onto the magnetic wireless charging area of the power bank. The magnetic design will help align your watch correctly.
4. Your Apple Watch should begin charging automatically. A charging icon will appear on your watch screen.
5. To turn off the power bank, double-click the power button.

iWatch magnetic charging

Magnetic adsorption, intelligent charging



Figure 4.1: Magnetic adsorption ensures intelligent and instant charging when the iWatch is placed on the power bank.

4.2 Understanding Indicator Lights

The LED indicator light on the side of the power bank provides real-time battery status:

- **Red Light:** Battery level is between 0% and 30%. Recharge the power bank soon.
- **Blue Light:** Battery level is between 30% and 60%.
- **Green Light:** Battery level is between 60% and 100%.

1200mAh

Offering 1~1.5 times for your Appl watch

0%~32%



33%~65%



66%~100%



Figure 4.2: Visual representation of battery level indicators (Red, Blue, Green).

5. MAINTENANCE

- **Cleaning:** Use a soft, dry cloth to clean the surface of the power bank. Avoid using harsh chemicals or abrasive materials.
- **Storage:** Store the power bank in a cool, dry place away from direct sunlight and extreme temperatures.
- **Battery Care:** To prolong battery lifespan, avoid fully discharging the power bank frequently. Recharge it when the indicator light turns red.
- **Avoid Drops:** While durable, avoid dropping the device to prevent internal damage.

6. TROUBLESHOOTING

6.1 Power Bank Not Turning On

- Ensure the power bank is charged. Connect it to a power source using the USB-C cable and check the indicator light.
- Press the power button once firmly.

6.2 Apple Watch Not Charging

- Verify the power bank is turned on (green indicator light).
- Ensure your Apple Watch is correctly placed on the magnetic charging area. Adjust its position if necessary.
- Check if the Apple Watch is compatible with the charger (Series 1-10, SE, Ultra, Ultra 2).
- If the power bank's battery is low (red light), recharge the power bank.

6.3 Slow Charging

- Ensure the power bank itself is fully charged.
- The charging speed may vary depending on the Apple Watch model and its current battery level.

7. SPECIFICATIONS

Feature	Detail
Model Number	D11
Battery Capacity	1200mAh
Input	DC 5V/1A (USB Type C)
Output	2.5W
Product Dimensions	2 x 0.5 x 1 inches
Item Weight	2.89 ounces
Connectivity Technology	USB
Special Features	Lightweight Design, Tangle Free, Magnetic, Fast Charging
Compatible Devices	Apple Watch Series 10, 9/8/7/6/SE/5/4/3/2/1/Ultra/Ultra 2
Manufacturer	ShenZhen SuJue Electronic Technology Co., Ltd
Country of Origin	Hong Kong

8. SAFETY INFORMATION

The HUOTO Portable Power Bank is designed with multiple safety features to ensure a secure charging environment:

- **Over-Current Protection:** Prevents damage from excessive current flow.
- **Over-Voltage Protection:** Safeguards against voltage spikes.
- **Short-Circuit Protection:** Automatically shuts off in case of a short circuit.
- **Over-Heat Protection:** Monitors temperature to prevent overheating during charging.

Always use the provided USB-C cable for charging the power bank. Do not attempt to disassemble or modify the device.



9. WARRANTY AND SUPPORT

Your HUOTO Portable Power Bank comes with a commitment to quality and customer satisfaction. If you encounter any problems or have questions regarding your product, please contact our after-sales team immediately. We are dedicated to providing prompt assistance and resolving any issues you may experience.

For support, please refer to the contact information provided on the product packaging or the official HUOTO website.

© 2025 HUOTO. All rights reserved.

Related Documents - D11

	<p>HUOTO D11 Portable Wireless Charger for Apple Watch - User Guide</p> <p>Detailed user guide for the HUOTO D11 Portable Wireless Charger for Apple Watch. Learn about its features, charging instructions for both the device and Apple Watch, specifications, package contents, and important safety warnings. Includes product diagram descriptions and compliance information.</p>
<div><p>仅限APP使用</p><p>App only APP Download</p><p><small>Not waterproof and cannot come into contact with water; If it comes into contact with water, it needs to be treated immediately.</small></p></div>	<p>D11 Smartwatch User Manual and Connection Guide</p> <p>Comprehensive guide for the D11 smartwatch, covering initial setup, app connection, Bluetooth pairing, earphone usage, NFC functionality, troubleshooting, and specifications. Learn how to connect and use your D11 smartwatch effectively.</p>
	<p>xbuyna D11 BSP-D11 Wireless Game Controller User Manual</p> <p>User manual for the xbuyna D11 BSP-D11 wireless game controller, detailing setup, features, and operation for Nintendo Switch, Android, iOS, PS3, PS4, and XBOX platforms.</p>

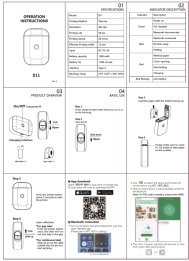

[PikDik D11 Mini Label Maker: Operation Manual and Guide](#)

Comprehensive guide for the PikDik D11 mini label maker, covering specifications, basic operation, troubleshooting, warnings, and support. Learn how to print labels efficiently with this portable device.