

[Manuals.plus](#) /

› [GEMINI APPLIANCES](#) /

› Ice Perfect Countertop Nugget Ice Maker User Manual

GEMINI APPLIANCES Nugget Ice Maker

Ice Perfect Countertop Nugget Ice Maker User Manual

Model: Nugget Ice Maker | Brand: GEMINI APPLIANCES

INTRODUCTION

Thank you for choosing the GEMINI APPLIANCES Ice Perfect Countertop Nugget Ice Maker. This manual provides essential information for the safe and efficient operation, maintenance, and troubleshooting of your new ice machine. Please read this manual thoroughly before first use and retain it for future reference.

PRODUCT OVERVIEW

The Ice Perfect Countertop Nugget Ice Maker is designed to produce soft, chewable pebble ice, ideal for various beverages and chilling food. Key features include:

- Produces up to 38 lbs of nugget ice per day.
- First batch of ice ready in 15 minutes or less.
- Equipped with a 1-gallon side water tank for extended operation without constant refilling.
- Features a self-cleaning function for easy maintenance.
- 5.5 lb ice basket capacity.
- Innovative design recirculates melted ice to the water reservoir, preventing clumping and leaks.



Image: The Ice Perfect Countertop Nugget Ice Maker in white, showing the ice basket filled with nugget ice and a glass with ice and lemons next to it.



Image: A hand holding a single piece of chewable nugget ice, highlighting its unique texture.

IMPORTANT SAFETY INSTRUCTIONS

To reduce the risk of fire, electric shock, or injury when using your ice maker, follow these basic precautions:

- Read all instructions before use.
- Do not touch the evaporator or ice basket directly during operation to avoid frostbite.
- Do not immerse the appliance, power cord, or plug in water or other liquids.
- Supervise children closely when the appliance is in use.
- Unplug the ice maker from the outlet when not in use or before cleaning.
- Do not operate any appliance with a damaged cord or plug, or after the appliance malfunctions or has been damaged in any manner.
- Use only potable water for ice production.
- Ensure proper ventilation around the appliance.

SETUP

Unboxing and Placement

1. Carefully remove the ice maker from its packaging.
2. Place the unit on a flat, stable surface away from direct sunlight and heat sources. Ensure there is adequate space around the unit for proper ventilation.
3. Allow the unit to stand upright for at least 1 hour before plugging it in, especially if it was transported horizontally.

Filling the Water Tank

The ice maker features a convenient 1-gallon side water tank. To fill:

1. Detach the side water tank from the main unit.
2. Fill the tank with clean, potable water. Do not exceed the maximum fill line.
3. Securely reattach the water tank to the ice maker.



Image: The ice maker on a countertop, illustrating the 1-gallon side water tank and the ice basket, with text indicating "Fresh Ice in 10 Mins" and "1 Gallon Side Tank Included".

Initial Cleaning

Before first use, it is recommended to clean the unit. Refer to the "Maintenance" section for detailed cleaning instructions, specifically the self-cleaning function.

OPERATING INSTRUCTIONS

Control Panel Overview

The ice maker features an easy-to-use touch screen control panel with indicator lights:

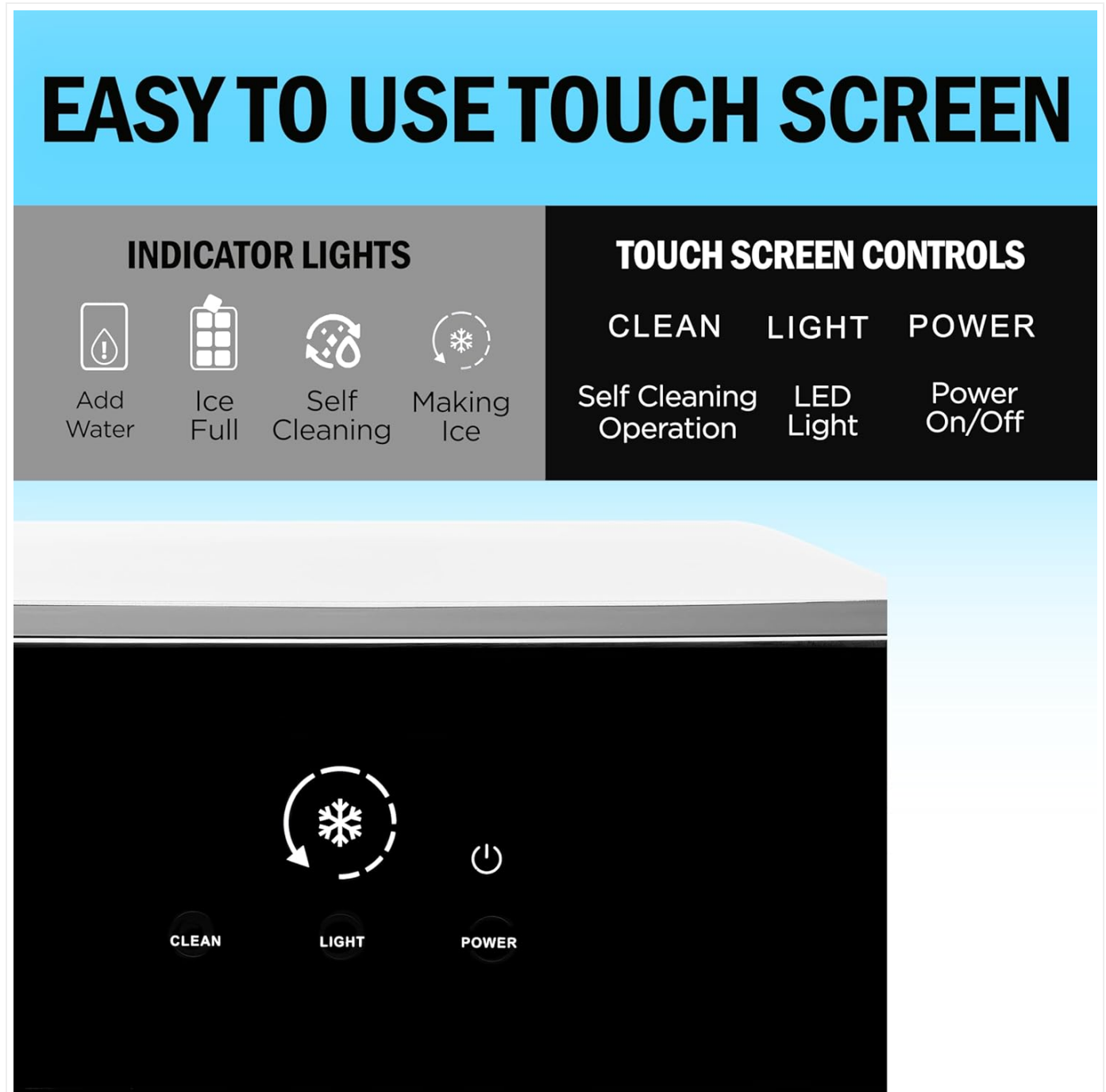

Image: A detailed view of the ice maker's touch screen, showing "CLEAN", "LIGHT", and "POWER" controls, along with indicator icons for "Add Water", "Ice Full", "Self Cleaning", and "Making Ice".

- **CLEAN:** Initiates the self-cleaning operation.
- **LIGHT:** Controls the LED light inside the ice basket.
- **POWER:** Turns the unit On/Off.
- **Indicator Lights:**

- **Add Water:** Illuminates when the water reservoir needs refilling.
- **Ice Full:** Illuminates when the ice basket is full.
- **Self Cleaning:** Indicates the self-cleaning cycle is active.
- **Making Ice:** Indicates the unit is actively producing ice.

Making Ice

1. Ensure the water tank is filled with potable water.
2. Plug the ice maker into a grounded electrical outlet.
3. Press the **POWER** button to turn on the unit. The "Making Ice" indicator will illuminate.
4. The ice maker will begin producing ice. The first batch may take slightly longer.
5. When the "Ice Full" indicator illuminates, the unit will pause ice production.
6. Use the provided ice scoop to retrieve ice from the basket.



**5.5Lb Ice
Storage Bucket**



**Ice Scoop
Included**



**38Lbs
Daily Production**

Image: A person using the provided scoop to retrieve nugget ice from the ice maker's basket, with a glass and lemons on the counter.

Self-Cleaning Function

The self-cleaning function helps sanitize and descale the internal components, ensuring fresh-tasting ice and optimal machine performance.

1. Ensure the water tank is filled.
2. Press the **CLEAN** button on the control panel. The "Self Cleaning" indicator will illuminate.
3. The unit will run a cleaning cycle. Once complete, drain any remaining water and wipe down the interior.



Self Cleaning Function

Removes Limescale and Mineral Build up

Keeps Ice Tasting Fresh

Ensures Best Machine Performance

Descaler required for limescale removal

Image: A finger pressing the "CLEAN" button on the ice maker's control panel, with text highlighting the benefits of the self-cleaning function, including limescale removal and fresh ice.

Descaling for Hard Water

Hard water can lead to mineral buildup (limescale) which can affect ice quality and machine performance. Descaling is crucial, especially in hard water areas.

- **Moderately Hard Water Areas:** Descale monthly.
- **Hard to Very Hard Water Areas:** Descale every two to three weeks.

A descaler is required for effective limescale removal. Follow the descaler product's instructions for use with ice makers. Always rinse the unit thoroughly after descaling.

HARD WATER CAN IMPACT YOUR ICE MACHINE

Descale monthly or more frequently in if you live in an area with hard water



Descale monthly in moderately hard water areas



Descale every two-three weeks in hard to very hard water areas



1-60mg/L
Slightly Hard



61-120mg/L
Moderately Hard



121-180mg/L
Hard



181-250mg/L
Very Hard

Image: A map of the United States indicating regions with varying levels of water hardness, from slightly hard to very hard, with corresponding descaling frequency recommendations.

General Cleaning

- Wipe the exterior with a soft, damp cloth.
- Clean the ice basket and water tank regularly with mild soap and water, then rinse thoroughly.
- Ensure all parts are dry before reassembling and operating the unit.

TROUBLESHOOTING

Before contacting customer support, please refer to the following table for common issues and their solutions:

Problem	Possible Cause	Solution
---------	----------------	----------

Problem	Possible Cause	Solution
"Add Water" indicator is on.	Water reservoir is empty or low.	Refill the side water tank with potable water.
"Ice Full" indicator is on.	Ice basket is full.	Remove ice from the basket. The unit will resume ice production automatically.
Ice maker is not producing ice.	No water, power issue, or internal malfunction.	Check water level. Ensure unit is plugged in. If problem persists, contact customer support.
Unusual grinding or loud noise during operation.	Mineral buildup, internal component issue, or unit not level.	Perform a self-cleaning cycle and descale if necessary. Ensure the unit is on a stable, level surface. If noise continues, contact customer support.
Water leakage.	Loose connections, damaged components, or overfilling.	Check all connections, especially the side water tank. Do not overfill the tank. Inspect for visible damage. Contact customer support if leakage persists.

SPECIFICATIONS

Feature	Detail
Model Name	Nugget Ice Maker
Brand	GEMINI APPLIANCES
Product Dimensions (D x W x H)	16.75"D x 10.25"W x 16.75"H
Capacity (Ice Basket)	5.5 Pounds
Voltage	115 Volts
Daily Ice Production	Up to 38 lbs
Side Water Tank Capacity	1 Gallon
ASIN	B0DD5JRLVL



Image: The Ice Perfect Countertop Nugget Ice Maker shown with its key dimensions (width, depth, height) labeled.

WARRANTY AND SUPPORT

For warranty information and customer support, please refer to the documentation included with your product or contact GEMINI APPLIANCES directly through their official website or the retailer where the product was purchased. Keep your proof of purchase for warranty claims.

For additional assistance, you may visit the [GEMINI APPLIANCES Store on Amazon](#).

