



Manuals.plus /

- › SMARTSTANDARD /
- › SmartStandard Sliding Barn Door Instruction Manual

SMARTSTANDARD BDM-36P5-KITF-WT-N

SmartStandard Sliding Barn Door Instruction Manual

Model: BDM-36P5-KITF-WT-N

INTRODUCTION

This manual provides detailed instructions for the assembly, installation, operation, and maintenance of your SmartStandard 36in x 84in Sliding Barn Door. This barn door features a durable MDF construction with a waterproof and scratch-resistant PVC surface, designed for easy assembly and long-lasting performance. Please read all instructions carefully before beginning installation to ensure proper setup and safe operation.



Image: The SmartStandard 36x84 inch Sliding Barn Door, featuring a white 5-panel design and black sliding hardware, installed in a room, showcasing its aesthetic and functional appeal.

SAFETY INFORMATION

- Always wear appropriate safety gear, including gloves and eye protection, during assembly and installation.
- This product is heavy. Two or more people are recommended for lifting and installation to prevent injury.
- Ensure the wall structure is capable of supporting the weight of the door and hardware. A header board is recommended for secure installation, especially if studs do not align with pre-drilled track holes.
- Keep all small parts and packaging materials away from children and pets.
- Do not modify the product or its components. Use only original replacement parts.
- Ensure all screws and fasteners are tightened securely before using the door.

PACKAGE CONTENTS

Verify that all components listed below are present and undamaged before beginning assembly.

Package Included

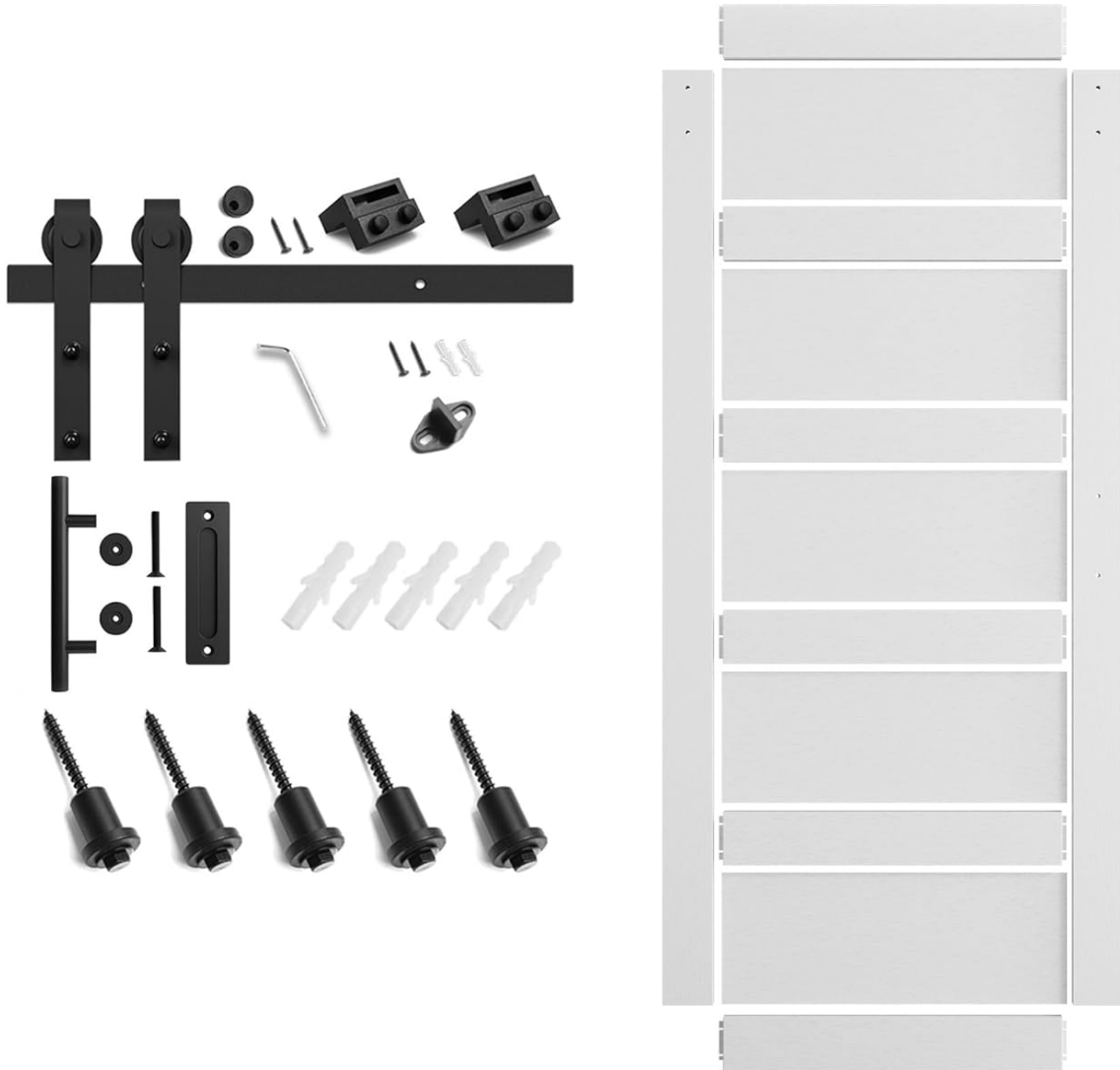

Image: A visual representation of all components included in the SmartStandard Sliding Barn Door kit, including the unassembled door panels, track, hangers, handle, and various fasteners.

Component	Quantity
Barn Door Slats (unassembled)	1 set
Sliding Hardware Track	1
Hangers (with rollers)	2
Double-sided Handle	1
Floor Guide	1
Anti-jump Disks	2
Door Stoppers	2
Installation Tools (Allen wrench, etc.)	1 set
Fasteners & Anchors	1 set
Detailed Instructions	1

SPECIFICATIONS

Attribute	Detail
Brand	SMARTSTANDARD
Model Number	BDM-36P5-KITF-WT-N
Door Dimensions	36 inches (Width) x 84 inches (Height) x 1 3/8 inches (Thickness)
Track Length	6.6 feet
Color	White/Black (Door/Hardware)
Material	MDF with PVC Surface (Door), Steel (Hardware)
Item Weight	83.3 Pounds
Assembly Required	Yes



Image: A detailed diagram showing the dimensions of the barn door, the required 6-inch clearance above the door for the track, and a table outlining various door widths and corresponding track lengths.

SETUP AND ASSEMBLY

The SmartStandard barn door is designed for straightforward assembly and installation. Follow these steps carefully.

Step 1: Assemble the Door

The door comes unassembled for convenient transportation. Follow the included detailed instructions to connect the door slats and form the complete door panel. Pre-drilled holes simplify this process.

Can be installed in as little as 30 minutes

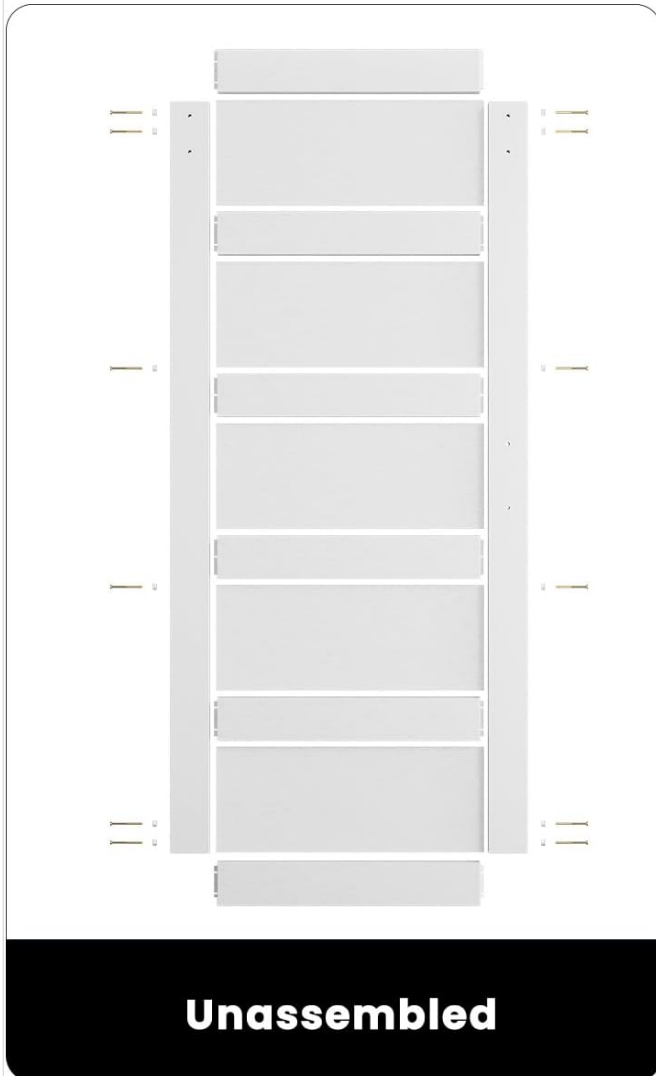

Image: A visual comparison of the unassembled door components versus the fully assembled door, highlighting the ease and speed of assembly.

Step 2: Install the Track

Mount the sliding hardware track to the wall above your door opening. Ensure the track is level and securely fastened to wall studs or a sturdy header board. The track has pre-drilled holes for hangers.

Step 3: Install the Hangers

Attach the hangers to the top edge of the assembled door panel using the provided fasteners. Ensure they are aligned correctly with the pre-drilled holes.

Step 4: Attach Door to Track

Carefully lift the door and hook the hanger rollers onto the installed track. Slide the door along the track to ensure smooth movement.

Step 5: Install Floor Guide

Install the floor guide at the bottom of the door opening. The door has a pre-made groove at its bottom edge that will engage with the floor guide to prevent the door from swinging out.

Step 6: Install the Handle

Attach the double-sided handle to the door using the pre-drilled holes. Ensure it is securely fastened for comfortable operation.

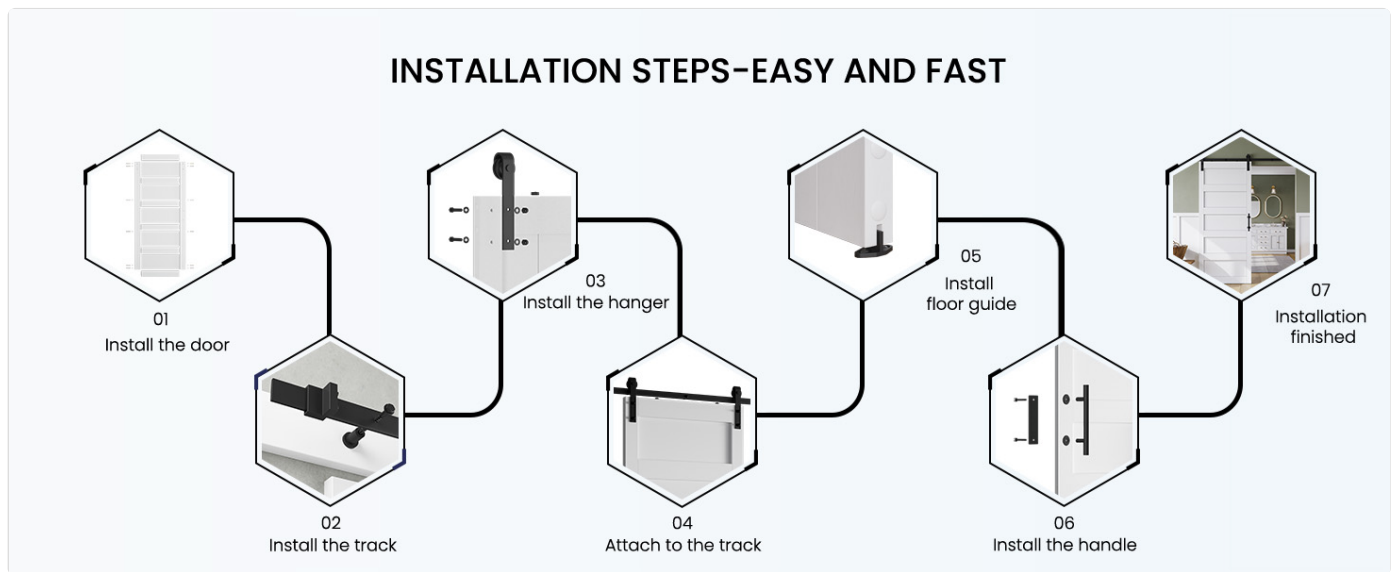

Image: A step-by-step infographic detailing the installation process from assembling the door to final installation, illustrating each stage with a simple icon.

OPERATING INSTRUCTIONS

To operate your SmartStandard Sliding Barn Door:

- Grasp the handle firmly.
- Gently slide the door along the track to open or close it. The rollers are designed for smooth and quiet operation.
- The door stoppers on the track prevent the door from sliding too far. Adjust their position if needed to control the door's travel range.
- The floor guide ensures the door remains stable and aligned during movement.

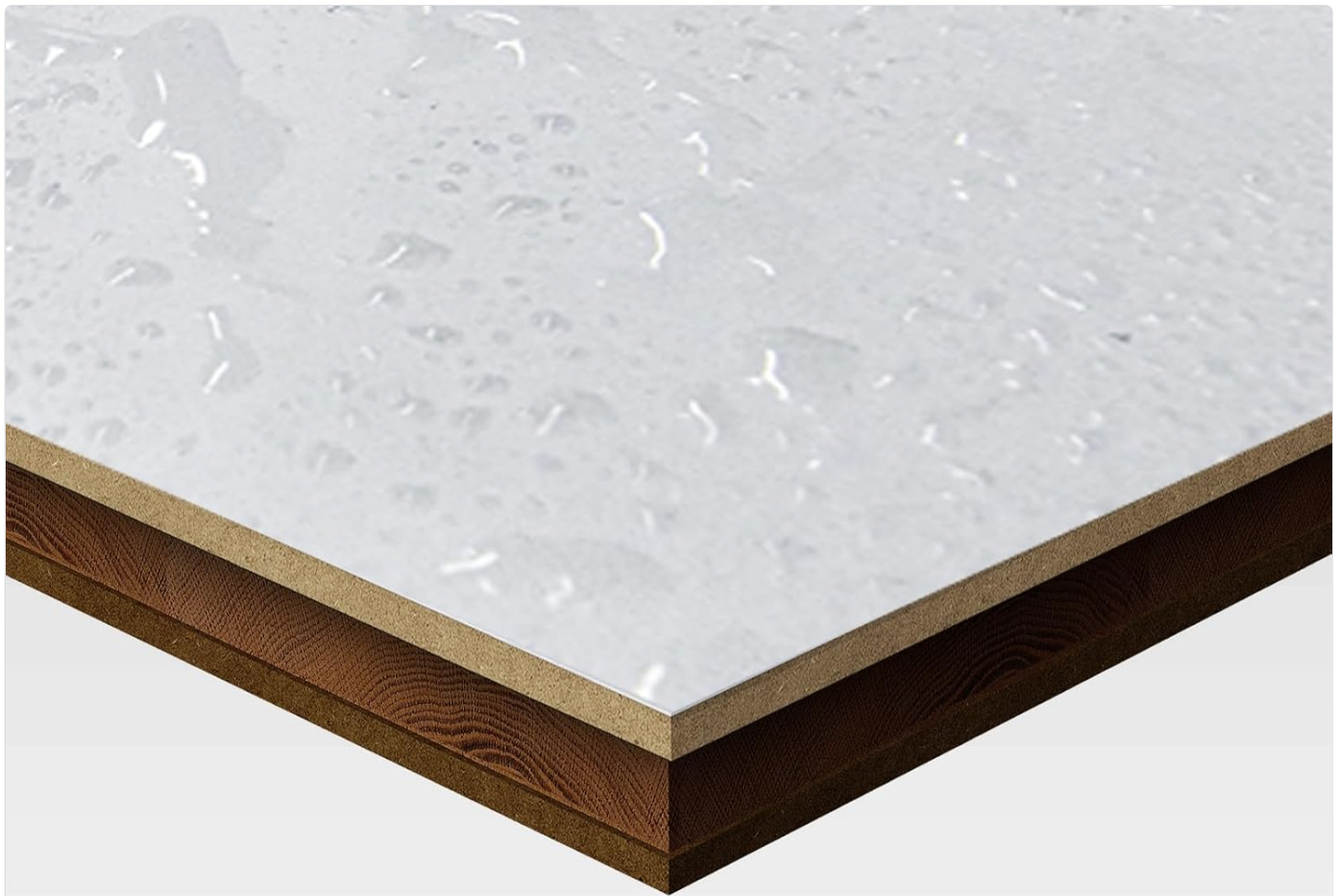

Image: The SmartStandard barn door in a partially open position, illustrating the smooth sliding mechanism and the integration of the black hardware with the white door.

MAINTENANCE

Regular maintenance will ensure the longevity and smooth operation of your barn door.

- **Cleaning the Door Surface:** The PVC surface is waterproof and easy to clean. Use a soft, damp cloth with mild soap and water to wipe down the door. Avoid abrasive cleaners or harsh chemicals that could damage the finish.
- **Hardware Inspection:** Periodically check all screws and fasteners on the track, hangers, and handle to ensure they remain tight. Retighten if necessary.
- **Track and Roller Lubrication:** If the door's movement becomes stiff or noisy, apply a silicone-based lubricant to the track and hanger rollers. Do not use oil-based lubricants as they can attract dust and debris.
- **Floor Guide:** Keep the floor guide free of debris to ensure smooth door movement.



Scratch-Resistant



Water-Proof



High-Quality PVC Covered

Image: A close-up view of the barn door's PVC surface, emphasizing its key features: scratch-resistance, waterproof quality, and high-quality finish.

TROUBLESHOOTING

Problem	Possible Cause	Solution
Door is difficult to slide or makes noise.	Track or rollers are dirty/dry; fasteners are loose.	Clean the track and rollers. Apply silicone lubricant. Check and tighten all fasteners on the track and hangers.
Door rubs against the floor or wall.	Track not level; floor guide misaligned; wall not plumb.	Verify the track is perfectly level. Adjust the floor guide position. If the wall is uneven, shims may be needed behind the track.
Door swings out from the wall.	Floor guide not installed or improperly positioned.	Ensure the floor guide is installed correctly and engages with the groove at the bottom of the door.
Door does not stop at desired position.	Door stoppers are loose or incorrectly positioned.	Adjust the position of the door stoppers on the track and tighten them securely.

WARRANTY AND SUPPORT

SmartStandard is committed to providing high-quality products. For any issues or questions regarding your barn door, please contact our customer support.

- **Warranty:** This product comes with a standard manufacturer's warranty. Please refer to the warranty card included in your package for specific terms and conditions.
- **Customer Support:** If you encounter any problems during assembly, installation, or operation, or if you have missing/damaged parts, please reach out to SmartStandard customer service.
- **Online Resources:** Visit the official SmartStandard store on Amazon for additional resources, FAQs, and product information: SMARTSTANDARD Store