

MINISFORUM DeskMini

MINISFORUM Mini PC AD69 AMD Ryzen 9 6900HX User Manual

Model: DeskMini AD69

1. INTRODUCTION

This manual provides essential information for setting up, operating, and maintaining your MINISFORUM Mini PC AD69. Please read this guide thoroughly before using the device to ensure optimal performance and longevity.



Image 1.1: The MINISFORUM Mini PC AD69, a compact desktop computer.

The MINISFORUM Mini PC AD69 is a high-performance compact desktop computer designed for various applications, including business, education, and gaming. It features an AMD Ryzen 9 6900HX processor, DDR5 memory, and PCIe 4.0 SSD for fast and efficient operation.

2. SETUP

2.1 Package Contents

Verify that all items are present in the package:

- MINISFORUM Mini PC AD69
- Power Adapter
- HDMI Cable
- User Manual (this document)
- Mounting Bracket (optional, for VESA mounting)

2.2 Connecting Peripherals

Before powering on, connect your peripherals to the Mini PC. Refer to the port diagram below for connection points.

Rich Interface

Meet the needs of your different usage scenarios

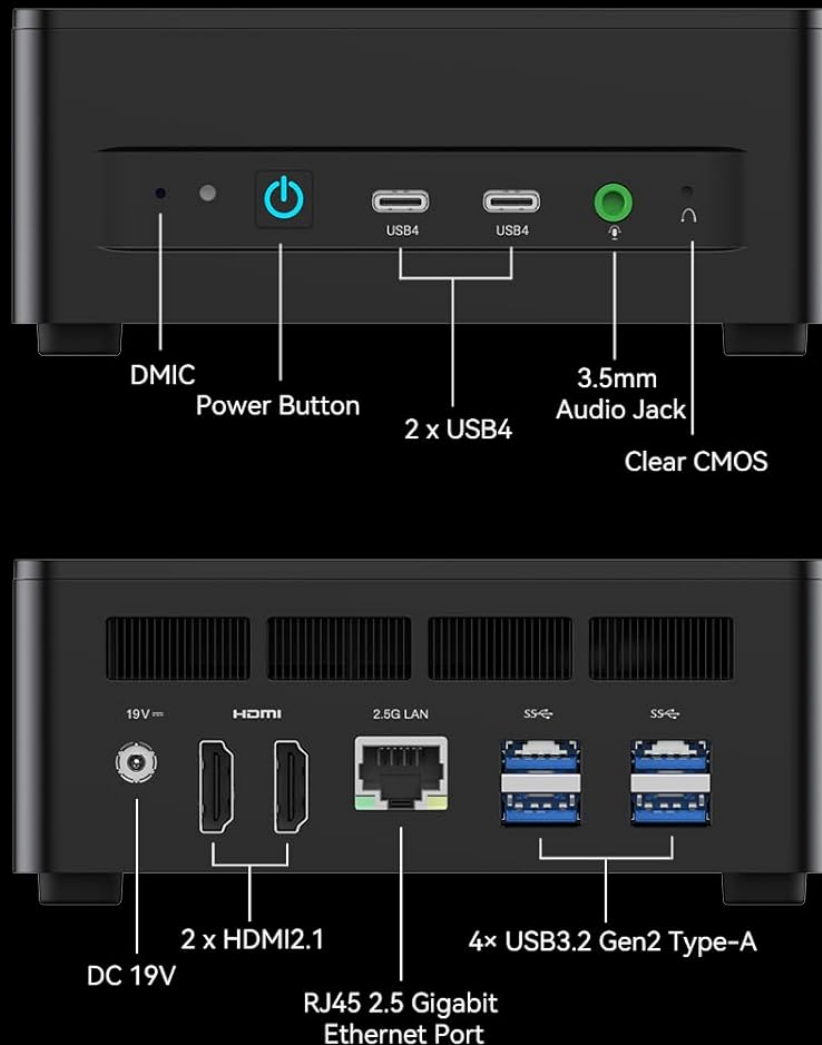

Image 2.1: Front and rear view of the Mini PC AD69, highlighting available ports.

- **Power Input:** Connect the DC 19V power adapter to the power input port.
- **Display:** Connect your monitor(s) using the HDMI 2.1 ports or USB4 ports. The device supports up to four displays simultaneously.
- **USB Devices:** Connect your keyboard, mouse, and other USB devices to the USB 3.2 Gen2 Type-A ports or USB4 ports.
- **Network:** For a wired connection, connect an Ethernet cable to the RJ45 2.5 Gigabit Ethernet Port.
- **Audio:** Connect headphones or speakers to the 3.5mm Audio Jack.

2.3 Powering On

1. Ensure all necessary peripherals are connected.
2. Connect the power adapter to a power outlet.
3. Press the Power Button located on the front of the Mini PC. The power indicator light will illuminate.

2.4 Mounting Options

The Mini PC AD69 can be mounted behind a monitor or TV using the included VESA mounting bracket (if applicable) to save desk space.

Space-saving Design

Mounts behind monitor/TV with mount
Turn it into an All-in-one desktop PC



Image 2.2: The Mini PC AD69 shown mounted on the back of a monitor, demonstrating its space-saving design.

3. OPERATING INSTRUCTIONS

3.1 Initial Boot and Operating System

Upon first boot, the Mini PC will guide you through the operating system setup process. Follow the on-screen instructions to configure your preferences.

3.2 Display Configuration

The Mini PC AD69 supports up to four independent displays. Connect your monitors to the available HDMI 2.1 and USB4 ports. The operating system will automatically detect the connected displays. You can configure display settings (resolution, orientation, extended/duplicated desktop) through the operating system's display settings menu.

Quad Display Support

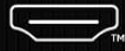

① HDMI2.1 x2



② USB4 x2



Image 3.1: The Mini PC AD69 connected to four monitors, demonstrating its quad display capability.

3.3 Network Connectivity

- **Wired Connection:** Connect an Ethernet cable to the RJ45 2.5 Gigabit Ethernet port for a stable, high-speed wired network connection.
- **Wireless Connection:** The Mini PC supports Wi-Fi 6E. To connect to a wireless network, navigate to the network settings in your operating system, select your desired Wi-Fi network, and enter the password.

3.4 Bluetooth Devices

The Mini PC AD69 includes Bluetooth 5.3 for connecting wireless peripherals such as keyboards, mice, and headphones. To pair a Bluetooth device, go to the Bluetooth settings in your operating system, enable Bluetooth, and follow the pairing instructions for your device.

4. MAINTENANCE

4.1 Cleaning

Regularly clean the exterior of the Mini PC with a soft, dry cloth. Avoid using liquid cleaners or abrasive materials. Ensure the ventilation grilles are free from dust and obstructions to maintain proper airflow.

4.2 Heat Dissipation

The Mini PC AD69 features an efficient heat dissipation system, including a large heatsink, quiet fan, and liquid metal thermal interface material, to ensure stable performance. To prevent overheating:

- Place the Mini PC in a well-ventilated area.
- Do not block the ventilation openings.
- Avoid placing the device on soft surfaces that can obstruct airflow.

Efficient Heat Dissipation

New Air Path Design, Enjoy High Performance



Image 4.1: Diagram illustrating the efficient heat dissipation design of the Mini PC AD69, showing airflow and internal cooling components.

4.3 Storage Expansion

The Mini PC AD69 supports storage expansion with additional M.2 2280 PCIe 4.0 SSDs and RAM upgrades up to 64GB DDR5. Refer to the internal component diagram for slot locations. It is recommended to consult a qualified technician for hardware upgrades to avoid damage.

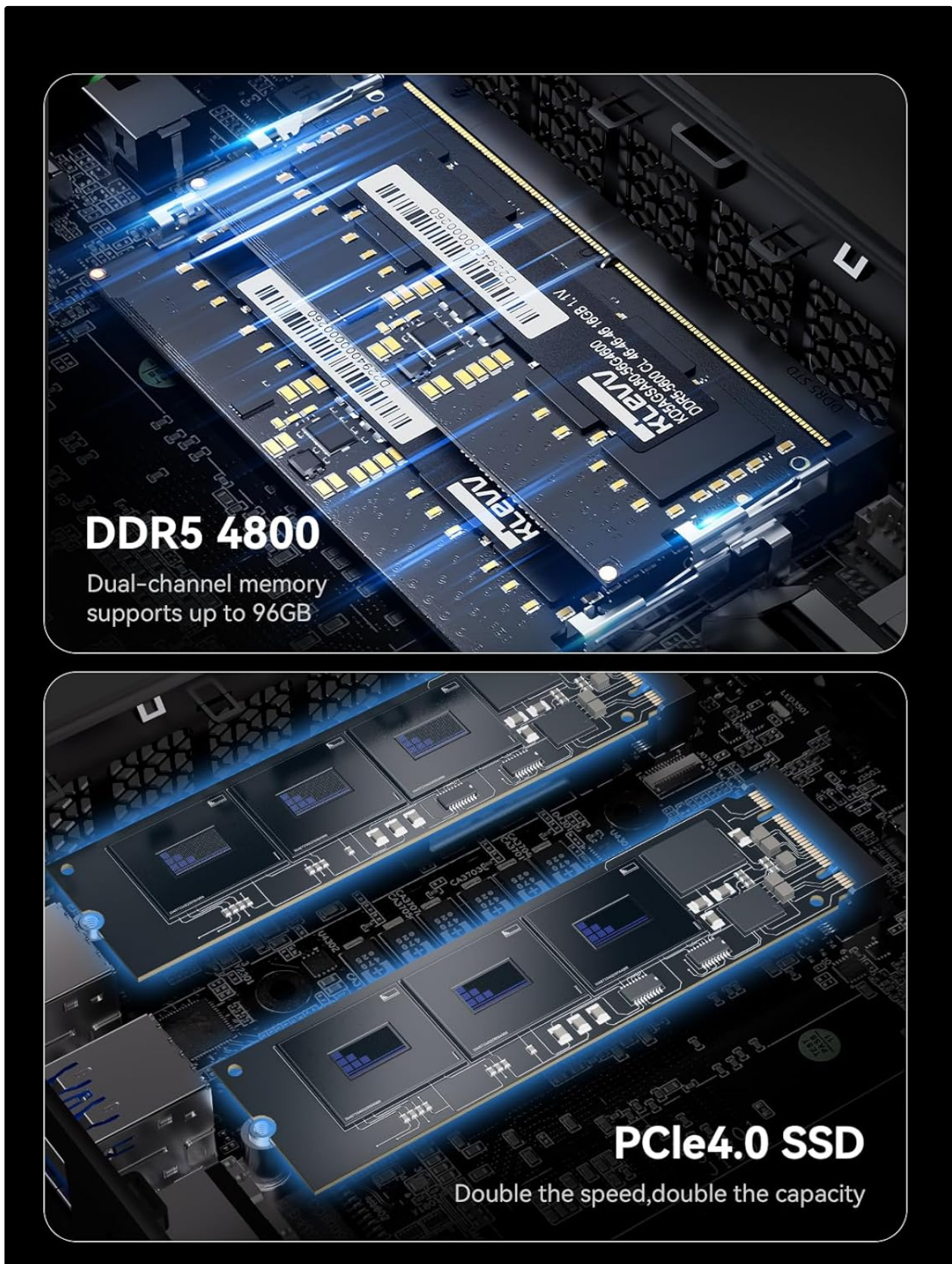

Image 4.2: Internal view of the Mini PC AD69, showing the dual-channel DDR5 memory slots and dual M.2 PCIe 4.0 SSD slots.

5. TROUBLESHOOTING

If you encounter issues with your Mini PC, refer to the following common problems and solutions:

- **No Power:**
 - Ensure the power adapter is securely connected to both the Mini PC and a working power outlet.

- Verify the power outlet is functional by plugging in another device.
- Press the power button firmly.
- **No Display:**
 - Check that the HDMI or USB4 cable is securely connected to both the Mini PC and the monitor.
 - Ensure the monitor is powered on and set to the correct input source.
 - Try a different display cable or monitor if available.
- **No Internet Connection (Wi-Fi):**
 - Verify that Wi-Fi is enabled in the operating system settings.
 - Ensure you are connected to the correct network and have entered the password correctly.
 - Restart your router and the Mini PC.
- **No Internet Connection (Wired):**
 - Check that the Ethernet cable is securely connected to both the Mini PC and the router/modem.
 - Verify that your router/modem is working correctly.
 - Try a different Ethernet cable.
- **Peripheral Not Detected:**
 - Ensure the peripheral is properly connected to a USB port.
 - Try connecting the peripheral to a different USB port.
 - Check if the peripheral requires specific drivers and install them if necessary.

6. SPECIFICATIONS

Feature	Specification
Processor	AMD Ryzen 9 6900HX (8 Cores/16 Threads, up to 4.9 GHz)
Graphics	AMD Radeon 680M (Integrated)
RAM	32GB DDR5 (Dual Channel, 4800MHz, expandable to 64GB)
Storage	512GB PCIe 4.0 SSD (M.2 2280)
Display Output	2x HDMI 2.1 (up to 7680x4320), 2x USB4 (up to 8K@60Hz)
USB Ports	4x USB 3.2 Gen2 Type-A, 2x USB4 (40Gbps)
Network	RJ45 2.5 Gigabit Ethernet, Wi-Fi 6E
Bluetooth	Bluetooth 5.3
Audio	3.5mm Audio Jack
Operating System	OS (Pre-installed)
Dimensions	Approx. 5 x 5 x 2 inches (12.7 x 12.7 x 5.08 cm)
Weight	Approx. 3.21 pounds (1.45 kg)

7. WARRANTY AND SUPPORT

7.1 Warranty Information

MINISFORUM products typically come with a limited warranty. The duration and terms of the warranty may vary by region and product. Please refer to the warranty card included with your product or visit the official MINISFORUM website for detailed warranty information.

Keep your proof of purchase (receipt or invoice) as it will be required for any warranty claims.

7.2 Technical Support



For technical assistance, troubleshooting beyond this manual, or warranty inquiries, please contact MINISFORUM customer support. Support is primarily provided via email.

Contact Information:

- Refer to the official MINISFORUM website for the most current support contact details.
- When contacting support, please provide your product model (AD69), serial number, and a clear description of the issue.

© 2024 MINISFORUM. All rights reserved.

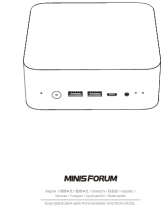
Related Documents - DeskMini

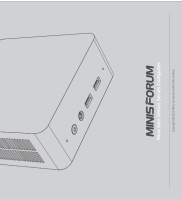
	<p>Minisforum Mini PC User Manual and Installation Guide</p> <p>User manual for Minisforum Mini PCs, detailing setup, port functions (USB4, HDMI, DisplayPort, OCulink), installation of DDR and SSD, and operational guides. Includes FCC compliance information.</p>
	<p>Minisforum UM760 Mini PC User Manual</p> <p>User manual for the Minisforum UM760 Mini PC, detailing package contents, hardware overview, interface specifications, setup guide, DIY installation of RAM and SSD, and mounting instructions.</p>
	<p>MINISFORUM New Gen Venus Series Mini PC User Manual</p> <p>Comprehensive user manual for the MINISFORUM New Gen Venus Series Mini PC. Get detailed information on package contents, system overview, ports, interfaces, and safety guidelines for your MINISFORUM mini computer.</p>



[MINISFORUM MS-A1 New Gen Mini Workstation Series User Manual](#)

User manual and installation guide for the MINISFORUM MS-A1 New Gen Mini Workstation Series. Covers setup, safety, interface, and component installation.



[Minisforum MGP01 Switch Wireless Controller User Manual and Specifications](#)

Comprehensive guide to the Minisforum MGP01 wireless controller, detailing its features, connectivity options for Switch, PC, Android, and iOS, macro programming, Turbo function, vibration settings, and technical specifications.

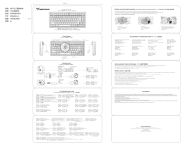

[MINISFORUM MKB i83 Three-Mode Mechanical Keyboard Quick Start Guide](#)

Concise guide for the MINISFORUM MKB i83 mechanical keyboard, covering setup, connectivity (Bluetooth, 2.4G, Wired), function keys, backlighting, and specifications.