

Defender IP10MDCB1

Defender AI Powered Guard Pro 3K Plus Dual Lens PTZ WiFi 6/Bluetooth Security Camera

Model: IP10MDCB1

PRODUCT OVERVIEW

The Defender AI Powered Guard Pro 3K Plus is an advanced security camera designed for comprehensive surveillance of your home or business. Featuring a unique dual-lens system, AI-powered tracking, and robust weather resistance, this camera provides superior monitoring capabilities day and night.

Key features include:

- **Dual Lens 3K Plus Technology:** Offers two distinct views simultaneously with enhanced clarity, maximizing surveillance coverage.
- **Pan, Tilt & Zoom (PTZ):** Remotely control the camera's viewing angle for flexible monitoring.
- **Smart AI Tracking:** Intelligently detects and follows human or vehicle movement, reducing false alarms.
- **WiFi 6 & Bluetooth Connectivity:** Ensures fast, stable, and seamless live viewing and playback.
- **Vibrant Color Night Vision:** Provides clear, full-color footage even in low-light conditions up to 100 feet.
- **Two-Way Audio:** Communicate directly with visitors or deter intruders using the built-in microphone and speaker.
- **IP66 Weather-Rated:** Designed to withstand various outdoor weather conditions.



The Defender AI Powered Guard Pro 3K Plus camera, showcasing its dual lenses and robust design.

WHAT'S INCLUDED

Your Defender AI Powered Guard Pro 3K Plus package includes the following components:

- Defender 3K+ Guard Pro PTZ Dual Lens Camera
- Camera Power Supply (10ft)
- Camera Power Extension Cable (25ft)
- Ethernet Waterproof Cable Shield
- Camera Mounting Hardware (screws, wall anchors)
- Drilling Template
- Window Warning Sticker (5x3in)
- Warranty Registration Insert
- Quick Start Guide

WHAT'S INCLUDED



Defender 3K+ Guard Pro PTZ
Dual Lens Camera



Camera Power Supply (10ft)



Camera Power Extension
Cable (25ft)



Ethernet Waterproof Cable Shield



Camera Mounting Hardware



Drilling Template



Window Warning
Sticker (5x3in)



Warranty Registration
Insert



Quick Start Guide

Free Lifetime Customer Support

All components included in the Defender AI Powered Guard Pro 3K Plus package.

SETUP & INSTALLATION

1. Before You Begin

Ensure you have a stable Wi-Fi 6 (802.11b/g/n/ax) network and a compatible smartphone or tablet for controlling the camera via the Defender Guard app. The camera requires a corded electric power source (12 Volts, 12 Watts).

2. Physical Installation

The camera is designed for wall or ceiling mount installation. Use the provided drilling template and mounting hardware to securely attach the camera. Ensure the installation location allows for optimal viewing and access to a power outlet. The Ethernet waterproof cable shield should be used for outdoor installations to protect the connection.



Properly mounting the camera to ensure stable and secure placement.

3. App Setup & Pairing

Download the Defender Guard app from your device's app store. Follow the in-app instructions for Bluetooth pairing and connecting to your Wi-Fi network. The app will guide you through the process of adding your new camera.

CONNECT IN SECONDS!

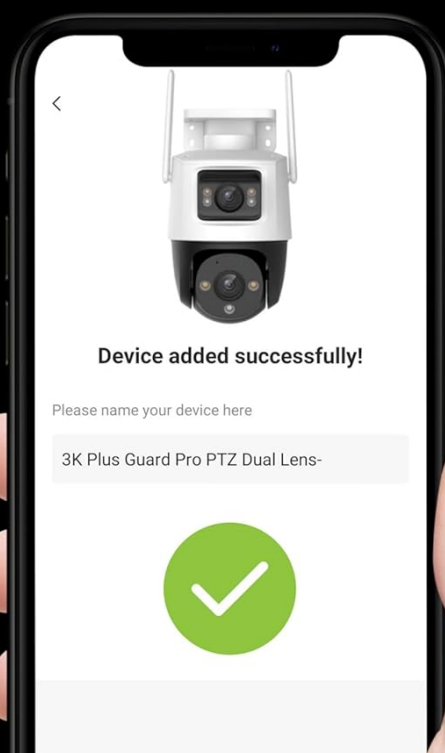

The Defender Guard app facilitates quick and easy pairing via Bluetooth and Wi-Fi 6.

This video demonstrates the quick setup process and key features of the Defender Guard Pro 3K Plus Dual Lens PTZ camera, including AI tracking and dual lens functionality.

OPERATING YOUR CAMERA

1. Live View & Playback

Access your camera's live feed and recorded footage directly through the Defender Guard app. The dual-lens system allows you to view both a fixed wide-angle perspective and a pan-tilt-zoom (PTZ) view simultaneously. Use the app's controls to pan, tilt, and digitally zoom the PTZ lens to focus on specific areas.

DUAL LENS: 1 CAMERA, TWO VIEWS!



The dual-lens feature provides both a fixed and a PTZ view on your mobile device.

2. AI Features: Smart Tracking & Detection

The camera's advanced AI technology enables precise human and vehicle detection. When motion is detected, the PTZ lens can automatically track the subject, ensuring continuous surveillance. You will receive instant motion detection notifications on your mobile device.

SMART AI AUTO TRACKING, 355° PAN & 90° TILT



DETECT & FOLLOW HUMAN



DETECT & FOLLOW VEHICLE



AI-powered auto-tracking intelligently follows detected human and vehicle movement.

This video highlights the AI-powered features of the Defender Guard Pro 3K Plus, including human and vehicle detection, auto-tracking, and the benefits of its dual-lens system.

3. Night Vision Capabilities

Experience clear surveillance even in complete darkness with the camera's vibrant color night vision. Equipped with two spotlights and IR LEDs, the camera illuminates the scene to deliver crisp, detailed visuals up to 100 feet.

SPEAK AND LISTEN WITH FLUID TWO-WAY TALK

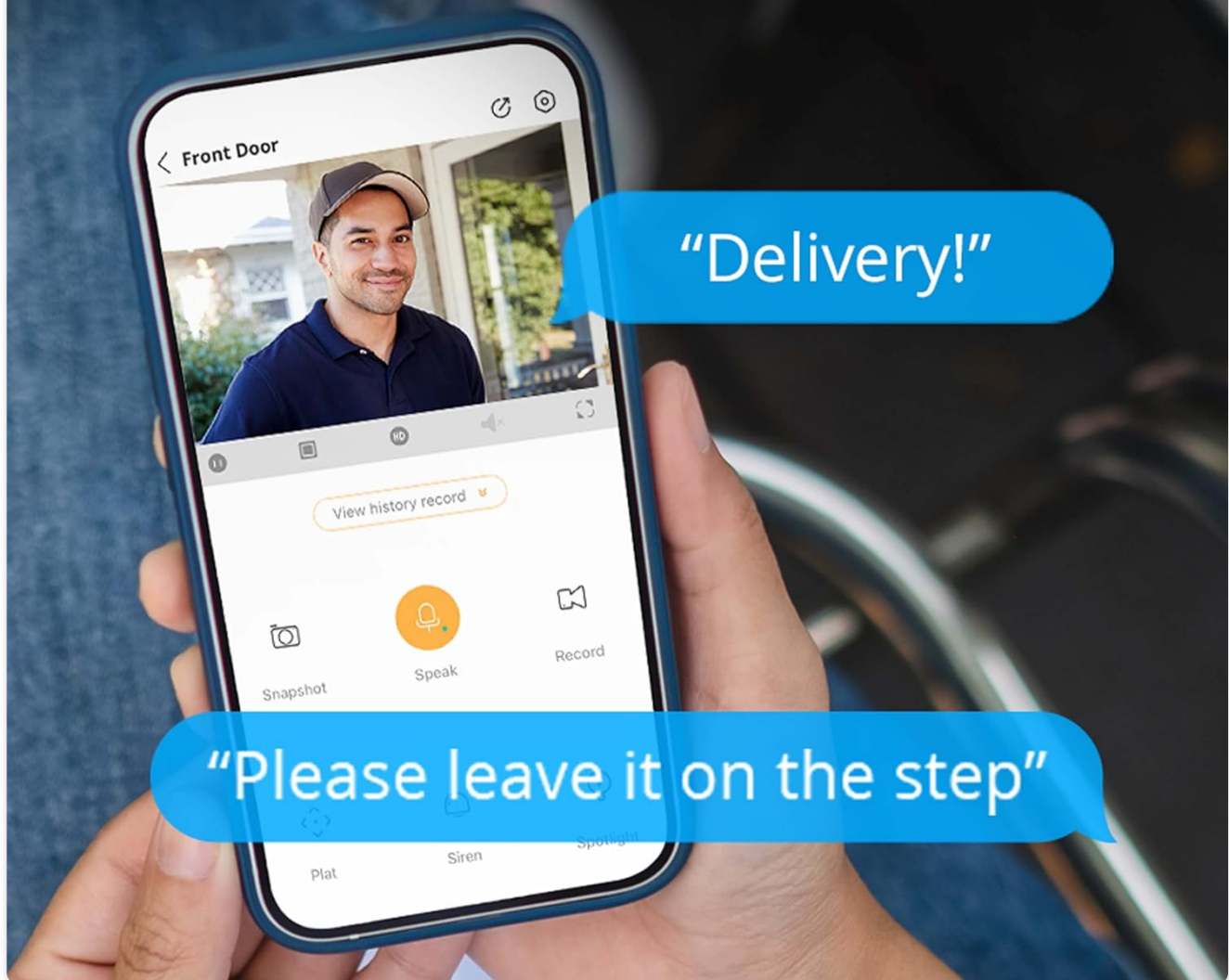

Vibrant Color Night Vision provides clear, illuminated footage in dark conditions.

4. Two-Way Audio & Deterrence

The integrated microphone and speaker allow for two-way communication, enabling you to speak with individuals near the camera. For deterrence, the camera features a built-in strobe light and siren that can be activated manually or automatically upon detection of suspicious activity.

DURABLE IP66 WEATHER-RATED CAMERA



Engage in two-way conversations through the camera using the mobile app.

MAINTENANCE

To ensure optimal performance and longevity of your Defender security camera, regular maintenance is recommended:

- **Cleaning:** Periodically wipe the camera lens and body with a soft, damp cloth to remove dust and debris. Avoid abrasive cleaners.
- **Firmware Updates:** Check the Defender Guard app regularly for available firmware updates. Keeping your camera's firmware up-to-date ensures you have the latest features and security enhancements.
- **Storage Management:** If using a Micro SD card for local storage (up to 256GB supported), periodically review and manage your recordings to ensure sufficient space. You can format the SD card via the app if needed.
- **Weather Protection:** While the camera is IP66 weather-rated, ensuring proper installation and protection from direct, prolonged exposure to extreme weather conditions (e.g., heavy snow accumulation on antennas) can

extend its lifespan.

COLOR NIGHT VISION, ILLUMINATE THE SCENE



100^{UP TO} FT
NIGHT VISION

The IP66 rating ensures the camera's durability against various weather conditions.

TROUBLESHOOTING

If you encounter issues with your Defender AI Powered Guard Pro 3K Plus camera, consider the following common solutions:

- **No Power:** Ensure the power adapter is securely connected to both the camera and a working electrical outlet. Check if the outlet is receiving power.
- **Connectivity Issues:** Verify your Wi-Fi network is active and the camera is within range of your router. Restarting your router and the camera can often resolve connection problems. Ensure your phone and camera are close during initial setup.
- **Poor Image Quality:** Check the camera lens for dirt or obstructions and clean if necessary. Ensure the

camera's resolution setting in the app is set to 3K Plus for optimal clarity.

- **False Alarms:** Adjust the motion detection sensitivity settings within the Defender Guard app. Utilize the AI detection features to filter for human and vehicle movement only.
- **PTZ Control Unresponsive:** Ensure the camera has a stable network connection. If the issue persists, try recalibrating the PTZ function through the app's settings.
- **Audio Problems:** Check the microphone and speaker settings in the app. Ensure volume levels are adequate and there are no physical obstructions to the microphone or speaker.

For more detailed troubleshooting or persistent issues, refer to the comprehensive help section within the Defender Guard app or contact customer support.

SPECIFICATIONS

Model Name	3K Guard Pro Dual Lens PLUS PTZ
Item Model Number	IP10MDCB1
Indoor/Outdoor Usage	Outdoor
Video Capture Resolution	3K (2880 x 1620)
Effective Still Resolution	10 MP
Connectivity Technology	Wireless (WiFi 6, Bluetooth)
Power Source	Corded Electric (12 Volts, 12 Watts)
Night Vision Range	100 Feet
Viewing Angle	360 Degrees (PTZ capability)
Field Of View	94 Degrees (Fixed Lens)
Water Resistance Level	IP66
Flash Memory Type	Micro SD (up to 256 GB supported)
Item Dimensions (L x W x H)	5.22 x 5.07 x 4.33 inches
Item Weight	13.1 ounces





WARRANTY & SUPPORT

Defender offers a warranty for its products. For detailed information regarding your product's warranty, including terms, conditions, and registration, please visit the official Defender website:

defendercameras.com/pages/warranty

Additionally, Defender provides free lifetime customer support to assist you with any questions or issues you may encounter with your AI Powered Guard Pro 3K Plus camera.

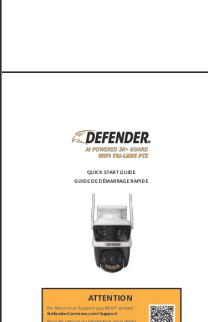
Related Documents - IP10MDCB1

	<p>Defender 3K Plus Guard Pro PTZ Dual Lens Quick Start Guide</p> <p>Quick start guide for the Defender 3K Plus Guard Pro PTZ Dual Lens security camera, covering setup, features, and warranty information.</p>
	<p>Defender AI Powered 3K+ Guard WIFI Tri-Lens PTZ Camera Quick Start Guide</p> <p>Get started quickly with the Defender AI Powered 3K+ Guard WIFI Tri-Lens PTZ Camera. This guide covers setup, features, mounting, and FAQs for your security system.</p>
	<p>DEFENDER 3K Plus Guard Pro PTZ Dual Lens Security Camera Quick Start Guide</p> <p>Quick Start Guide for the DEFENDER 3K Plus Guard Pro PTZ Dual Lens security camera. Learn how to set up, install, connect to Wi-Fi, use the app, and troubleshoot common issues. Includes product details, regulatory information, and warranty details.</p>
	<p>Defender 3K+ Guard Pro WIFI Tri-Lens PTZ Camera Quick Start Guide</p> <p>A comprehensive guide to setting up and using the Defender 3K+ Guard Pro WIFI Tri-Lens PTZ Camera, including installation, app connection, cloud storage, and troubleshooting.</p>
	<p>Defender Guard Pro Quick Start Guide: Setup and Features</p> <p>A comprehensive guide to setting up and using the Defender Guard Pro security camera, covering installation, Wi-Fi connection, app usage, motion detection, recording, and frequently asked questions.</p>

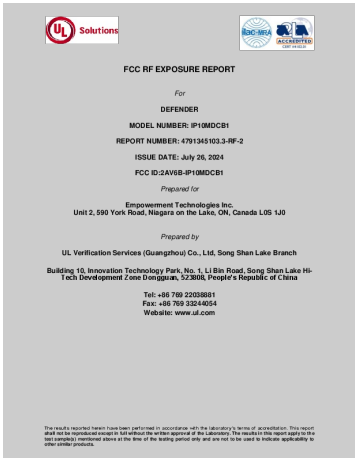

[pdf] SAR Rating

Zhang Kebo MPE Empowerment Technologies Inc IP10MDCB1 DEFENDER 2AV6B 2AV6BIP10MDCB1 ip10mdcb1

FCC RF EXPOSURE REPORT For DEFENDER MODEL NUMBER: **IP10MDCB1**
REPORT NUMBER: 4791345103.3-RF-2 ISSUE DATE: July 26, 2024 FCC
ID:2AV6B-**IP10MDCB1** Prepared for Empowerment Technologies Inc. Unit 2, 590
York Road, Niagara on the Lake, ON, Canada L0S 1J0 Prepared by UL Verification
Services Guangzhou Co....

lang:en score:32 filesize: 322.86 K page_count: 8 document date: 2024-07-30

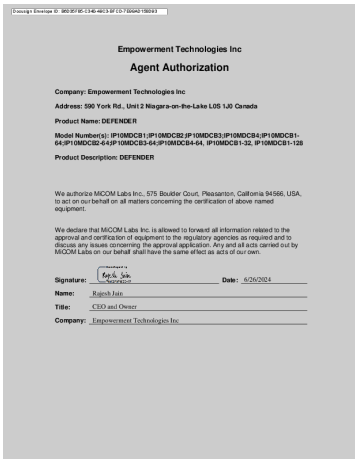

[pdf] Agent Authorization

PLEASE PRINT ON COMPANY LETTERHEAD MiCOM Labs Inc QMS Agent Authorization
Empowerment Technologies IP10MDCB1 DEFENDER 2AV6B 2AV6BIP10MDCB1 ip10mdcb1
DocuSign Envelope ID: B6D35F85-C340-49C3-BFCD-7E99AD158D93
Empowerment Technologies Inc Agent Authorization Company: Empowerment
Technologies Inc Address: 590 York Rd., Unit 2 Niagara-on-the-Lake L0S 1J0
Canada Product Name: DEFENDER Model Number s :
IP10MDCB1;IP10MDCB2;IP10MDCB3;IP10MDCB4;IP10MDCB...

lang:en score:32 filesize: 159.03 K page_count: 1 document date: 2024-07-22

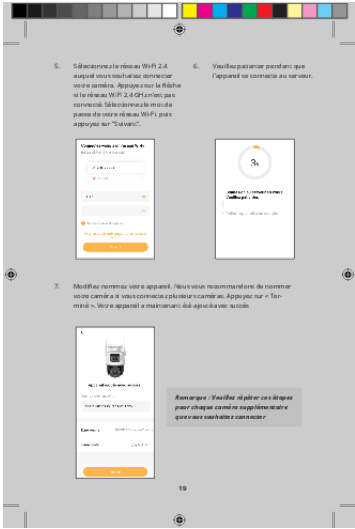

[pdf] User Manual

User Manual Empowerment Technologies Inc IP10MDCB1 DEFENDER 2AV6B 2AV6BIP10MDCB1 ip10mdcb1

5. Slectionnez le rseau Wi-Fi 2.4 6. Veuillez patienter pendant que auquel vous
souhaitez connecter l appareil se connecte au serveur. votre camra. Appuyez sur la
fiche si le rseau WIFI 2,4 GHz n est pas connect. Slectionnez le mot de passe de
votre rseau Wi-Fi, puis appuyez sur Suivant

lang:fr score:28 filesize: 2.32 M page_count: 6 document date: 2024-07-29

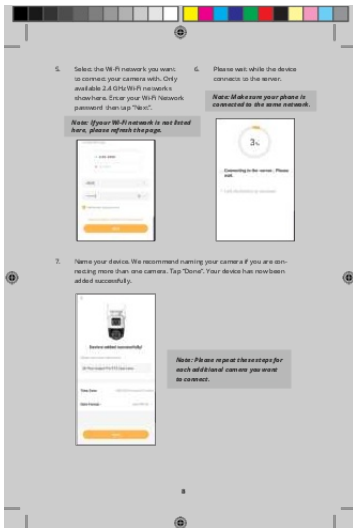

[\[pdf\]](#) User Manual Installation Guide

User Manual Empowerment Technologies Inc IP10MDCB1 DEFENDER 2AV6B 2AV6BIP10MDCB1 ip10mdcb1

5. Select the Wi-Fi network you want 6. to connect your camera with. Only available 2.4 GHz Wi-Fi networks show here. Enter your Wi-Fi Network password then tap Next . Note: If your Wi-Fi network is not listed here, please refresh the page. Please wait while the device connects to the server...

lang:en score:28 filesize: 4.68 M page_count: 11 document date: 2024-07-29

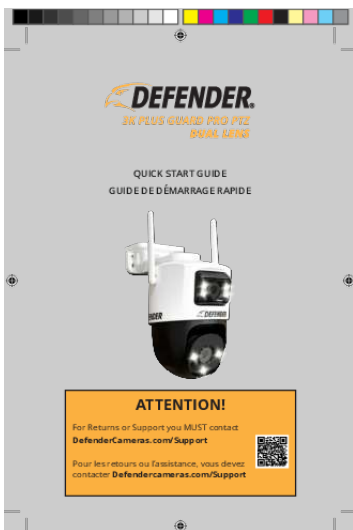

[Defender 3K Plus Guard Pro PTZ Dual Lens Quick Start Guide](#)

Quick start guide for the Defender 3K Plus Guard Pro PTZ Dual Lens security camera, covering setup, features, and warranty information.

lang:en score:27 filesize: 4.22 M page_count: 7 document date: 2024-07-29



[\[pdf\]](#) Test Report

Mike Heckrotte Test report Empowerment Technologies Inc IP10MDCB1 DEFENDER 2AV6B 2AV6BIP10MDCB1 ip10mdcb1

CFR 47 FCC PART 15 SUBPART C ISSED RSS-247 Issue 3 TEST REPORT For DEFENDER MODEL NUMBER: **IP10MDCB1** REPORT NUMBER: 4791345103.3-RF-1 ISSUE DATE: July 26, 2024 FCC ID:2AV6B-**IP10MDCB1**

IC:26035-**IP10MDCB1** Prepared for Empowerment Technologies Inc. Unit 2, 590 York Road, Niagara on the Lake, ON, Canada L0...

lang:en score:26 filesize: 5 M page_count: 105 document date: 2024-07-30

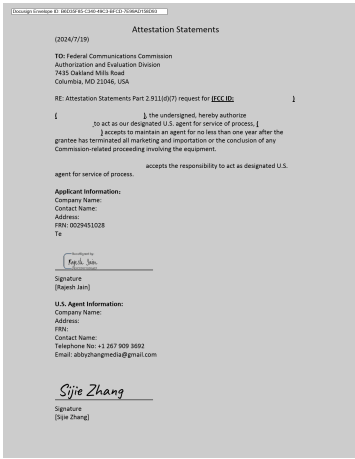

[pdf]

CANADIAN REPRESENTATIVE LETTER OF ATTESTATION Zuo Selina US agent Empowerment Technologies Inc IP10MDCB1 DEFENDER 2AV6B 2AV6BIP10MDCB1 ip10mdcb1

Docusign Envelope ID: B6D35F85-C340-49C3-BFCD-7E99AD158D93 2024/7/19

Attestation Statements TO: Federal Communications Commission Authorization and Evaluation Division 7435 Oakland Mills Road Columbia, MD 21046, USA RE: Attestation Statements Part 2.911 d 7 request for FCC ID: 2AV6B-IP10MDC... lang:en score:25 filesize: 382.64 K page_count: 1 document date: 2024-07-22

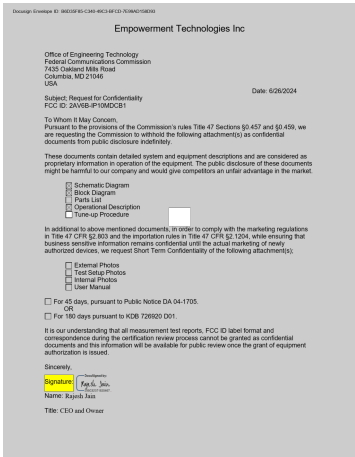

[pdf]

Fiona Ffuellenbach FCC Short Long Term Confidentiality Request Empowerment Technologies Inc IP10MDCB1 DEFENDER 2AV6B 2AV6BIP10MDCB1 ip10mdcb1

Docusign Envelope ID: B6D35F85-C340-49C3-BFCD-7E99AD158D93

Empowerment Technologies Inc Office of Engineering Technology Federal Communications Commission 7435 Oakland Mills Road Columbia, MD 21046 USA Subject; Request for Confidentiality FCC ID: 2AV6B-IP10MDCB1 Date: 6/26/2024 To Whom It May Con... lang:en score:25 filesize: 114.97 K page_count: 1 document date: 2024-08-06



[pdf]

Label Empowerment Technologies Inc IP10MDCB1 DEFENDER 2AV6B 2AV6BIP10MDCB1 ip10mdcb1

Label Location Note: This would be a plastic label with a permanent adhesive. Label Location Note: This would be a plastic label with a permanent adhesive. Label Location Note: This would be a plastic label with a permanent adhesive. Label Location Note: This would be a plastic label with a pe... lang:en score:15 filesize: 859.74 K page_count: 10 document date: 2024-08-06

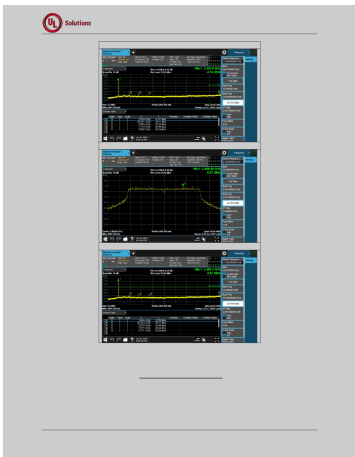

[pdf]

Test Report Mike Heckrotte Test report Empowerment Technologies Inc IP10MDCB1 DEFENDER 2AV6B 2AV6BIP10MDCB1 ip10mdcb1

REPORT NO.: 4791345103.3-RF-1 Page 129 of 129 Tx. Spurious NVNT ax20 2437MHz Ant1 Emission Tx. Spurious NVNT ax20 2462MHz Ant1 Ref Tx. Spurious NVNT ax20 2462MHz Ant1 Emission END OF REPORT UL Verification Services Guangzhou Co., Ltd, Song Shan Lake Branch FORM NO: 10-SL-F0035 This report shal... lang:en score:14 filesize: 286.85 K page_count: 1 document date: 2024-07-30

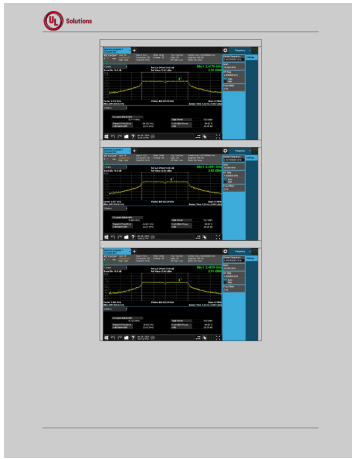

[\[pdf\]](#) Test Report

Mike Heckrotte Test report Empowerment Technologies Inc IP10MDCB1 DEFENDER 2AV6B

2AV6BIP10MDCB1 ip10mdcb1

REPORT NO.: 4791345103.3-RF-1 Page 106 of 129 OBW NVNT g 2412MHz Ant1
OBW NVNT g 2437MHz Ant1 OBW NVNT g 2462MHz Ant1 UL Verification Services
Guangzhou Co., Ltd, Song Shan Lake Branch FORM NO: 10-SL-F0035 This report
shall not be reproduced except in full, without the written approval of UL Ve...

lang:en score:14 filesize: 5 M page_count: 23 document date: 2024-07-30

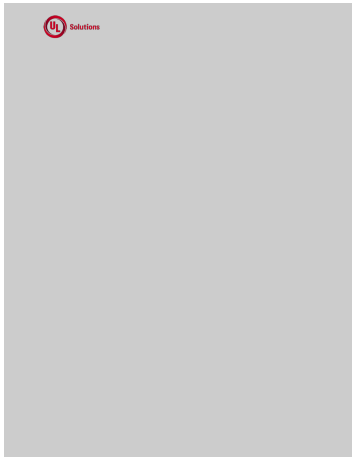

[\[pdf\]](#) Product Photos Teardown

Mike Heckrotte Internal photos Empowerment Technologies Inc IP10MDCB1 DEFENDER 2AV6B

2AV6BIP10MDCB1 ip10mdcb1

Internal Photographs Internal View of EUT-1 Page 2 of 10 Internal View of EUT-2 This
report shall not be reproduced except in full, without the written approval of UL
Verification Services Guangzhou Co., Ltd, Song Shan Lake Branch. Internal View of
EUT-3 Page 3 of 10 Internal View of EUT-...

lang:en score:14 filesize: 1.66 M page_count: 10 document date: 2024-07-30

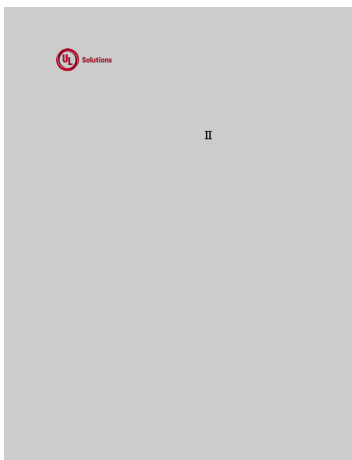

[\[pdf\]](#) Product Photos

Huang Denny Test Setup Photos Empowerment Technologies Inc IP10MDCB1 DEFENDER 2AV6B

2AV6BIP10MDCB1 ip10mdcb1

Appendix Setup Photographs RADIATED RF MEASUREMENT SETUP ABOVE 1
GHz MEASUREMENT POSITION MEASUREMENT POSITION X axis
MEASUREMENT POSITION Y axis MEASUREMENT POSITION Z axis RADIATED
RF MEASUREMENT SETUP 30MHz-1GHz RADIATED RF MEASUREMENT SETUP
Below 30MHz POWERLINE CONDUCTED EM...

lang:en score:14 filesize: 563.46 K page_count: 5 document date: 2024-07-30



[pdf] Product Photos

Mike Heckrotte External Photographs of EUT Empowerment Technologies Inc IP10MDCB1 DEFENDER 2AV6B 2AV6BIP10MDCB1 ip10mdcb1

External Photographs View of EUT-1 Page 2 of 6 View of EUT-2 This report shall not be reproduced except in full, without the written approval of UL Verification Services Guangzhou Co., Ltd, Song Shan Lake Branch. View of EUT-3 Page 3 of 6 View of EUT-4 This report shall not be reproduced...

lang:en score:14 filesize: 843.01 K page_count: 6 document date: 2024-07-30

无线规格书

UANT
好天线·悦生活

SPECIFICATION FOR APPROVAL

产品名称

PRODUCT NAME: 2.4G W95 白色外置天线 1.3 灰色底材 L=245mm+端子

优比电子料号

UB P/N: UB02C245W3Da8a1A REV: B

版本修改记录:

版本	修改人	日期	修改记录
V-A	张清俊	2023 年 06 月 03 日	初稿
V-B	张清俊	2023 年 06 月 16 日	增加气密检测要求

	MANUFACTURER SIGNATURE	CUSTOMER SIGNATURE
CHECKED BY:		
APPROVED BY:		
DATE:		

地址: 东莞市塘厦镇林村社区新太阳工业城 79 栋 (东莞公司)
杭州市滨江区长河街道 300 号乐通科技园 2 栋 106 室 (杭州公司)
深圳市福田区福强二路 27 号顺流工业园 A 栋 106 室 (深圳公司)
电话: 0755-81771125
传真: 0755-81771125
网址: www.uant.com

[pdf] Specifications

SPECIFICATION FOR APPROVAL Antenna Report Empowerment Technologies Inc IP10MDCB1 DEFENDER 2AV6B 2AV6BIP10MDCB1 ip10mdcb1

SPECIFICATION FOR APPROVAL PRODUCT NAME: 2.4G W95 1.3 L=245mm UB P/N: UB02C245W3Da8a1A V-A 2023 06 03 REV: B V-B 2023 06 16 CHECKED BY: APPROVED BY: DATE: MANUFACTURER SIGNATURE 2023/06/16 CUSTOMER SIGNATURE 79 500 3 106 57 A 106 0769-81777126 0769-...

lang:i-klngon score:13 filesize: 976.45 K page_count: 16 document date: 2024-05-27