

## A4tech FBX51C

# A4tech FBX51C Bluetooth & 2.4G Wireless Keyboard User Manual

Model: FBX51C

## INTRODUCTION

This manual provides detailed instructions for the setup, operation, maintenance, and troubleshooting of your A4tech FBX51C Bluetooth & 2.4G Wireless Keyboard. Please read this manual thoroughly before using the product to ensure optimal performance and longevity.

## PACKAGE CONTENTS

Upon opening the package, please verify that all items are present:

- A4tech FBX51C Wireless Keyboard
- USB / USB-C Charging Cable
- USB Extension Cable (may vary by region/package)
- USB / USB-C Mini Quick Connect (may vary by region/package)
- 2.4G USB Nano Receiver (magnetically stored in the keyboard)

## SETUP

### 1. Charging the Keyboard

The FBX51C keyboard features an embedded, rechargeable battery. Before initial use, it is recommended to fully charge the keyboard.

1. Locate the USB-C charging port on the upper top left edge of the keyboard, near the ON/OFF switch.
2. Connect the provided USB-C charging cable to the keyboard and a power source (e.g., computer USB port, USB wall adapter).
3. The power LED indicator will illuminate during charging. It will turn off automatically once the keyboard is fully charged.

### 2. Powering On/Off

Use the ON/OFF switch located on the upper top left edge of the keyboard to power the device on or off.

### 3. Connecting via 2.4G Wireless (USB Nano Receiver)

For devices without Bluetooth or for a dedicated connection:

1. Locate the 2.4G USB Nano Receiver, which is magnetically stored in a compartment on the keyboard.
2. Insert the Nano Receiver into an available USB port on your computer or device.
3. Press the 2.4G connection key on the keyboard (usually indicated by a 2.4G icon or specific key combination). The keyboard should connect automatically.

### 4. Connecting via Bluetooth

The FBX51C supports up to three Bluetooth connections (BT1, BT2, BT3).

1. Ensure the keyboard is powered on.
2. On the keyboard, press and hold one of the Bluetooth keys (e.g., BT1, BT2, or BT3) for approximately 2-3 seconds until its indicator light begins to blink. This indicates pairing mode.
3. On your device (computer, tablet, smartphone), navigate to the Bluetooth settings.
4. Search for available Bluetooth devices and select "A4tech FBX51C" (or similar name) from the list.
5. Follow any on-screen prompts to complete the pairing process. The indicator light on the keyboard will stop blinking once successfully paired.
6. Repeat these steps for additional Bluetooth devices using BT2 and BT3 keys.

## OPERATING INSTRUCTIONS

### 1. Switching Between Devices

The FBX51C allows seamless switching between connected devices.

- To switch to a 2.4G connected device, press the 2.4G connection key.
- To switch to a Bluetooth connected device, press the corresponding Bluetooth key (BT1, BT2, or BT3) once.

### 2. Function Keys (Fn Combinations)

The keyboard features multimedia and system function keys. To activate these functions, press and hold the **Fn** key, then press the desired function key (F1-F12 or other keys with secondary icons).

#### Common Fn Key Functions

Key Combination	Function
Fn + F1	Media Player
Fn + F2	Volume Down
Fn + F3	Volume Up
Fn + F4	Mute
Fn + F5	Previous Track
Fn + F6	Next Track
Fn + F7	Play/Pause
Fn + F8	Stop
Fn + F9	Web Browser
Fn + F10	Email

Key Combination	Function
Fn + F11	My Computer
Fn + F12	Calculator
Fn + PrtSc	Screenshot
Fn + Insert	Copy
Fn + Delete	Paste

### 3. LED Indicators

The keyboard features LED indicators for power, CAPS Lock, and connection status. These are typically located above the F4 key.

- **Power LED:** Illuminates during charging and turns off when fully charged. May also indicate low battery.
- **CAPS Lock LED:** Illuminates when CAPS Lock is active.
- **Connection LEDs (BT1, BT2, BT3, 2.4G):**Blink during pairing mode and remain solid when a connection is established.

## MAINTENANCE

### 1. Cleaning the Keyboard

To maintain the keyboard's appearance and functionality:

- Power off the keyboard before cleaning.
- Use a soft, lint-free cloth slightly dampened with water or a mild cleaning solution.
- Avoid excessive moisture and do not spray cleaners directly onto the keyboard.
- For debris between keys, use compressed air.

### 2. Battery Care

To prolong the life of the rechargeable battery:

- Avoid exposing the keyboard to extreme temperatures.
- Charge the keyboard regularly, especially if it will be stored for an extended period.
- Do not attempt to replace the internal battery yourself.

## TROUBLESHOOTING

### Troubleshooting Guide

Problem	Possible Cause	Solution
Keyboard not connecting via 2.4G	Receiver not properly inserted; keyboard not in 2.4G mode; low battery.	Ensure the Nano Receiver is fully inserted into a working USB port. Press the 2.4G key on the keyboard. Charge the keyboard.
Keyboard not connecting via Bluetooth	Keyboard not in pairing mode; Bluetooth disabled on device; device already connected to maximum Bluetooth devices; low battery.	Press and hold the desired BT key until it blinks. Ensure Bluetooth is enabled on your device. Remove old Bluetooth connections if necessary. Charge the keyboard.

Problem	Possible Cause	Solution
Keys are unresponsive or delayed	Low battery; interference; connection issue.	Charge the keyboard. Move closer to the receiver/device. Re-establish the connection.
Accidental "Computer Lock" key presses	Key placement may be unfamiliar.	Familiarize yourself with the keyboard layout. Some operating systems may allow remapping or disabling specific keys, consult your OS documentation.

SPECIFICATIONS

- **Model Name:** FBX51C
- **Connectivity Technology:** Bluetooth, 2.4G Wireless
- **Keyboard Description:** Scissor Switch
- **Compatible Devices:** PC (Windows, Mac, iOS, Android compatible)
- **Special Feature:** Low-Profile Key, Multi-Device Switching
- **Switch Type:** Scissor Switch
- **Item Weight:** 1.17 pounds
- **Package Dimensions:** 13.5 x 7 x 1.25 inches
- **Manufacturer:** A4tech
- **Date First Available:** August 8, 2024

PRODUCT OVERVIEW IMAGE



This image displays the A4tech FBX51C Wireless Keyboard from a top-down, angled perspective. The keyboard is black with white key legends, featuring a full QWERTY layout, a dedicated numeric keypad on the right, and a row of function keys (F1-F12) at the top. Several keys also show secondary multimedia and system shortcut icons, indicating their dual functionality when used with the 'Fn' key. The

'FSTYLER' brand logo is visible on the left side above the function keys, and 'QUIETKEY' is printed on the spacebar.

## WARRANTY AND SUPPORT

For warranty information, technical support, or service inquiries, please refer to the documentation provided with your purchase or contact the retailer or manufacturer directly. Specific warranty terms may vary by region and point of purchase.



© 2024 A4tech. All rights reserved.

## Related Documents - FBX51C



[A4TECH FBX51C Wireless Keyboard Quick Start Guide](#)

Comprehensive guide to setting up and using the A4TECH FBX51C wireless keyboard, covering 2.4G and Bluetooth connectivity, multi-device pairing, FN key functions, and troubleshooting.

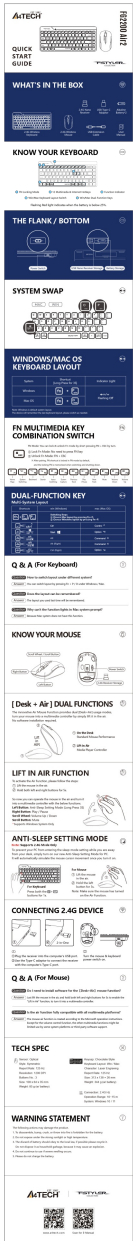

[A4Tech FG2200 Air2 Wireless Keyboard and Mouse Combo User Manual](#)

This document provides a comprehensive guide to the A4Tech FG2200 Air2 wireless keyboard and mouse combo, covering setup, features, troubleshooting, and technical specifications. Learn how to connect your devices, switch between Windows and Mac layouts, utilize multimedia functions, and activate the Air Mouse feature.



### [A4TECH FSTYLER FX50 Low Profile Scissor Switch Keyboard Quick Start Guide](#)

A quick start guide for the A4TECH FSTYLER FX50 Low Profile Scissor Switch Keyboard, detailing its features, specifications, and usage for both Windows and Mac operating systems.

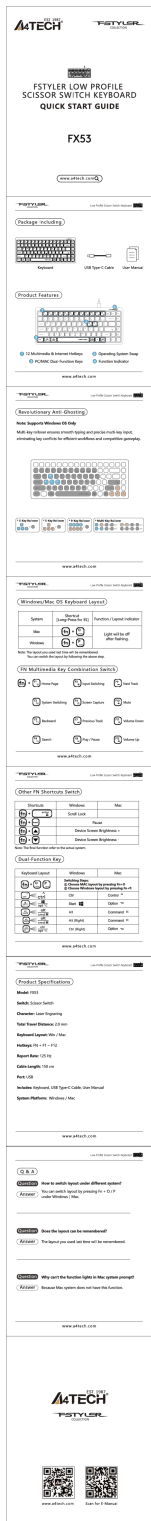

## A4TECH FSTYLER FX53 Low Profile Scissor Switch Keyboard Quick Start Guide

Quick start guide for the A4TECH FSTYLER FX53 keyboard, detailing product features, multimedia hotkeys, operating system switching, dual-function keys, and specifications for Windows and Mac.





## [A4TECH FBK22 AS FStyler Collection Wireless Keyboard Quick Start Guide](#)

A comprehensive guide to setting up and using the A4TECH FBK22 AS FStyler Collection wireless keyboard, covering Bluetooth and 2.4GHz connectivity, multi-device switching, operating system compatibility, and special function keys.

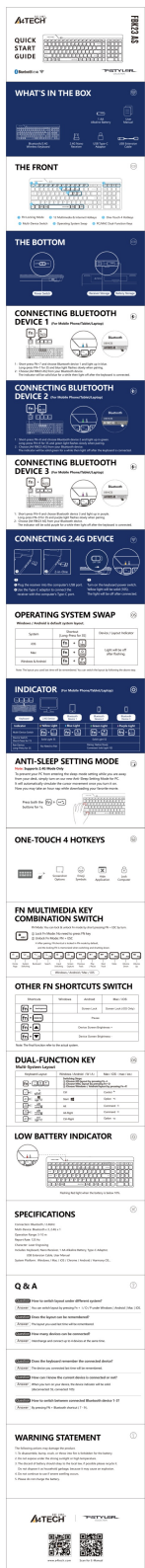

## [A4TECH FBK23 AS FSTYLER Collection Wireless Keyboard Quick Start Guide](#)

Comprehensive quick start guide for the A4TECH FBK23 AS FSTYLER Collection wireless keyboard, covering Bluetooth and 2.4G connectivity, multi-device switching, OS compatibility, hotkeys, and specifications.