



[Manuals.plus](#) /

> [WOGXN](#) /

> WOGXN Glass Oil Film Cleaner & Brush Kit - Windshield Cleaning Tool SQRK65H6MMPUKOTLWP User Manual

WOGXN SQRK65H6MMPUKOTLWP

WOGXN Glass Oil Film Cleaner & Brush Kit User Manual

Model: SQRK65H6MMPUKOTLWP

1. PRODUCT OVERVIEW

The WOGXN Glass Oil Film Cleaner & Brush Kit is designed to effectively remove stubborn oil film, dirt, and water stains from various glass surfaces, including automotive windshields, side windows, and household glass. This kit includes a specialized cleaning brush and a replenisher liquid, formulated to restore glass clarity and improve visibility.

Key Features:

- Efficiently breaks down oil film and restores original glass clarity.
- Forms an invisible protective layer to reduce fogging and rainwater adhesion.
- Integrated liquid brush for easy application and cleaning of hard-to-reach areas.
- Safe for car paintwork and rubber seals; eco-friendly formulation.
- Versatile use for automotive and household glass surfaces.



Image 1.1: The WOGXN Glass Oil Film Cleaner and Brush Kit, showing the cleaner bottle and the integrated brush applicator.

2. PACKAGE CONTENTS

Please verify that all items are present in your package:

- 1 x Car Glass Oil Film Cleaner (120ml)
- 1 x Refill Liquid (60ml)

3. SAFETY INFORMATION

Please read and follow these safety guidelines before using the product:

- Keep out of reach of children and pets.
- Avoid contact with eyes. In case of contact, rinse immediately with plenty of water and seek medical advice if irritation persists.
- Do not ingest. If swallowed, do not induce vomiting; seek medical attention immediately.

- Use in a well-ventilated area.
- Store in a cool, dry place away from direct sunlight and extreme temperatures.

4. SETUP AND PREPARATION

Before applying the cleaner, ensure the glass surface is properly prepared:

1. **Rinse the Glass:** Thoroughly rinse the glass surface with water to remove loose dirt, dust, and debris. This prevents scratching during the cleaning process.



Image 4.1: Illustration of rinsing the glass surface with water as the first step.

5. OPERATING INSTRUCTIONS

Follow these steps for effective cleaning:

1. **Prepare the Applicator:** Open the lid of the integrated brush applicator. The design allows for easy dispensing of the cleaning solution with a single click or press.

Open the lid and apply it with one click
Stubborn oil film can be removed
with one wipe
Labor-saving design



Image 5.1: Demonstrates opening the lid of the applicator for product dispensing.

2. **Apply Evenly:** Gently press the applicator onto the wet glass surface and spread the cleaning solution evenly using the integrated brush. The ergonomic design ensures a comfortable grip and ease of use, allowing you to reach corners effectively.

Ergonomic design Comfortable grip and easy to use



Image 5.2: Shows the ergonomic design of the brush and its comfortable grip during application on a car windshield.

- 3. Clean Thoroughly:** Work the solution into the glass surface with the brush, focusing on areas with heavy oil film or stains. Stubborn oil film can typically be removed with one thorough wipe.
- 4. Rinse Again:** After applying and cleaning, rinse the glass surface thoroughly with clean water until no residue remains. The glass surface should appear clean and traceless.

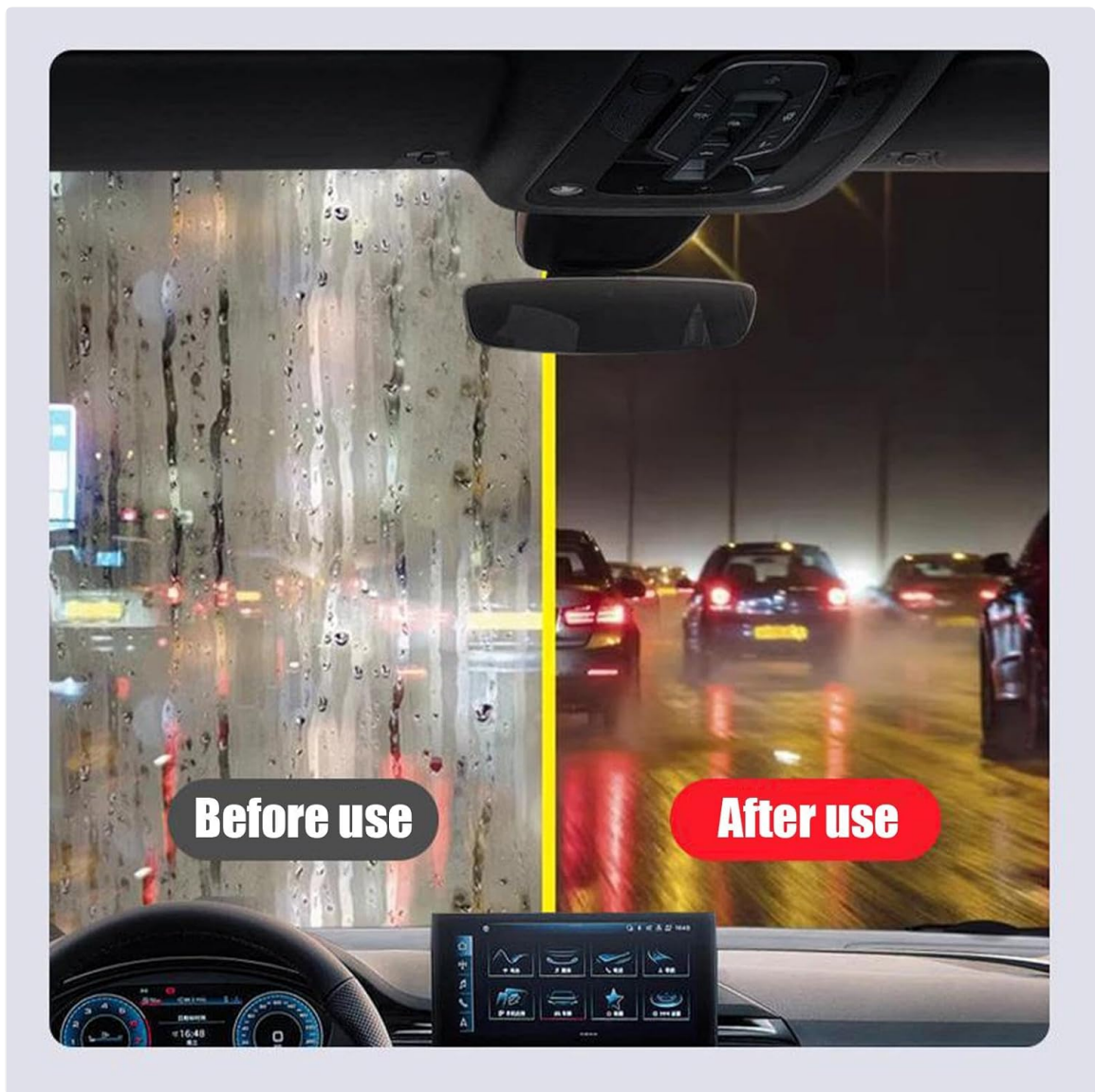

Image 5.3: A visual comparison showing a car windshield before and after using the cleaner, highlighting improved clarity.

6. MAINTENANCE

To ensure the longevity and effectiveness of your cleaning kit:

- After each use, rinse the brush applicator thoroughly with clean water to remove any remaining cleaning solution or debris.
- Allow the brush to air dry completely before closing the lid and storing.
- Store the cleaner and refill liquid in a cool, dry place, away from direct sunlight and freezing temperatures.

7. TROUBLESHOOTING

If you encounter any issues, refer to the following common solutions:

- **Streaks or Residue Remain:** Ensure the glass surface was thoroughly rinsed before application. Re-apply the cleaner and rinse more thoroughly, ensuring all product is washed away.
- **Oil Film Not Fully Removed:** For very stubborn oil film, a second application may be necessary. Ensure sufficient product is applied and worked into the surface.

- **Applicator Not Dispensing:** Check if the lid is fully open and if there is enough liquid in the reservoir. Gently press the applicator to prime it.

8. SPECIFICATIONS



Image 8.1: Dimensions of the cleaning brush applicator, showing approximate measurements of 10.5cm (4.13in) length, 7.5cm (2.95in) width, and 5cm (1.96in) height.

Specification	Detail
Brand	WOGXN
Model Number	SQRK65H6MMPUKOTLWP
Item Weight	5.44 ounces
Cleaner Volume	120ml
Refill Volume	60ml
Material Feature	Eco-Friendly
Date First Available	August 8, 2024

9. WARRANTY AND SUPPORT

Specific warranty information for the WOGXN Glass Oil Film Cleaner & Brush Kit is not provided in this manual. For details regarding warranty coverage, returns, or technical support, please contact the manufacturer or your point of purchase directly. Please have your model number (SQRK65H6MMPUKOTLWP) and purchase date available when contacting support.