

[Manuals.plus](#) /

› [VEVOR](#) /

› VEVOR Claw Machine Model S-01 Instruction Manual

VEVOR S-01

VEVOR Claw Machine Model S-01 Instruction Manual

Model: S-01 | Brand: VEVOR

1. INTRODUCTION

This manual provides essential information for the safe and efficient operation of your VEVOR Claw Machine Model S-01. Please read these instructions thoroughly before initial use and retain for future reference.



Figure 1: VEVOR Claw Machine Model S-01.

1.1 What's in the Box

- Claw Machine x 1
- Keys x 2
- Game Coins x 50
- Screws x 8
- Power Cord x 1
- Instruction Manual x 1
- Console x 1

- Acrylic Panel x 1

2. SETUP

Follow these steps for quick and easy assembly of your VEVOR Claw Machine.

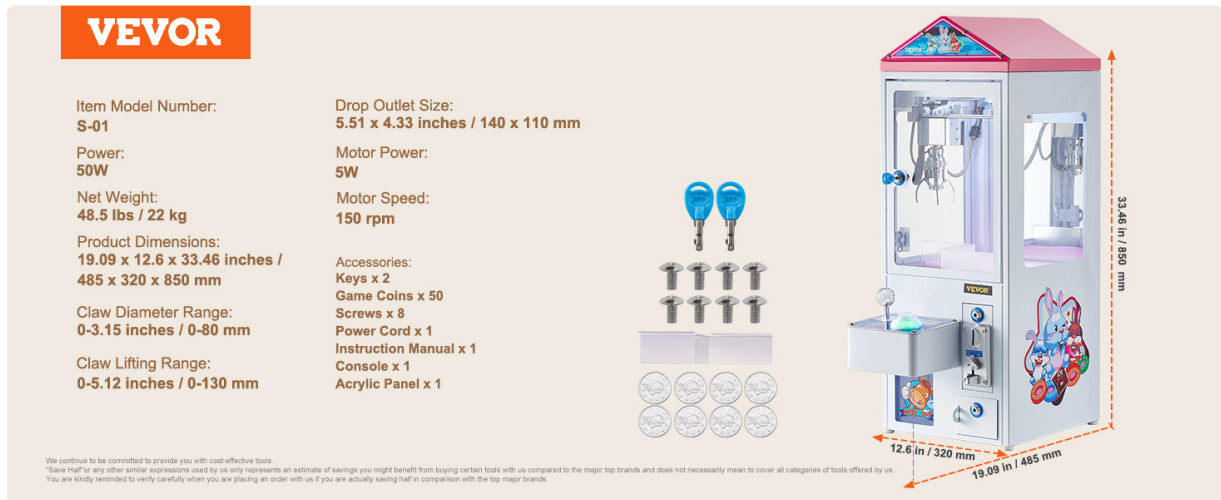

Figure 2: Hassle-Free Installation Steps.

1. **Install the Acrylic Panel:** Secure the acrylic panel into its designated slot.
2. **Connect Terminal Interfaces:** Connect the three terminal interfaces as indicated.
3. **Install the Console:** Place the control console into its position.
4. **Cut Zip Ties:** Ensure all six zip ties are carefully cut to free the internal mechanisms.
5. **Power On:** Start by pressing the power switch.

2.1 Powering the Machine

The VEVOR Claw Machine can be powered via the included power cord. Ensure the machine is connected to a suitable power source before operation.

3. OPERATING INSTRUCTIONS

3.1 Coin Operation

The machine operates using coins. Insert one of the provided game tokens into the coin slot to begin a game. The machine is designed to prevent jams and accepts various coin sizes.

SMOOTH COIN OPERATION NO JAMMING

Prevents Coin Sticking



Durable
Construction



Supports Multiple
Coin Sizes



Figure 3: Inserting a game coin.

3.2 Controls

The intuitive controls feature an acrylic panel, a clear display, and a responsive joystick for easy gameplay.

SINGLE-COMMAND CONSOLE - EASY OPERATION

Simple to Play, Easy to Master



Acrylic Control Panel



High-Definition Display



Crystal Joystick



Colorful Buttons

Figure 4: Control Panel.

- Use the **joystick** to maneuver the claw horizontally and vertically.
- Press the **action button** to lower the claw and attempt to grab a prize.

3.3 Claw Mechanism

The VEVOR Claw Machine features a strong steel claw with an adjustable grip. It can handle dolls of various sizes, with a diameter range of 0-80mm and a lifting range of 0-130mm.

VEVOR
TOUGH TOOLS, HALF PRICE



Claw Diameter Range
0-3.15" / 0-80mm

Claw Lifting Range
0-5.12" / 0-130mm

STAINLESS STEEL CLAWMACHINE - GRAB WITH PRECISION

Effortlessly Retrieve Dolls

Figure 5: Precision Steel Claw.

3.4 Sound and Light Features

Immerse yourself in a captivating gaming experience with dynamic music and dazzling lights. The vibrant display creates an exciting atmosphere.

AMBIENT SOUND AND LIGHT

Immersive Gaming Atmosphere



Warm Lighting



Dynamic Music



Deluxe
Multicolored
Marquee



Figure 6: Ambient Sound and Light.

- The machine features dynamic music and dazzling lights during gameplay.
- Volume control may be available via a switch on the machine's rear or bottom panel.

3.5 Prize Retrieval

Effortlessly open and secure the machine with the column lock and the two included keys. Prizes are dispensed through a widened gift outlet.

COLUMN LOCK MECHANISM

Easy to Insert and Remove

Keys x2

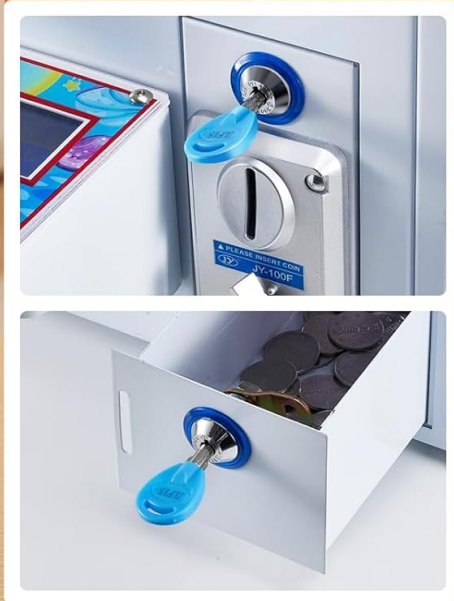

Figure 7: Column Lock Mechanism and Prize Drawer.

- Use the provided keys to unlock the column and access the machine's interior for prize loading or maintenance.
- Collected prizes will exit through the drop outlet, which measures 5.51 x 4.33 inches (140 x 110 mm).

4. MAINTENANCE

To ensure the longevity and optimal performance of your VEVOR Claw Machine, regular maintenance is recommended.

- **Cleaning:** Wipe down exterior surfaces with a soft, damp cloth. Avoid abrasive cleaners.
- **Coin Drawer:** Periodically empty the coin collection drawer to prevent overflow and ensure smooth operation. The drawer is accessible via the column lock mechanism.
- **Claw Mechanism:** Inspect the claw for any obstructions or wear. Ensure it moves freely and grips properly.

5. TROUBLESHOOTING

If you encounter issues with your VEVOR Claw Machine, refer to the following common solutions:

- **Claw is too weak to pick up items:** The claw strength may be adjustable. Refer to the detailed instructions provided with your machine for specific adjustment procedures. Ensure the items inside are within the recommended size and weight limits.
- **Machine not responding:** Check the power connection and ensure the power switch is in the 'ON' position. If using batteries, ensure they are correctly installed and have sufficient charge.
- **Coins not registering:** Ensure coins are inserted correctly and are of an acceptable size. Check the coin mechanism for any obstructions.
- **Defective unit:** If the machine exhibits persistent malfunctions despite troubleshooting, contact VEVOR customer support for assistance.

6. SPECIFICATIONS

Detailed technical specifications for the VEVOR Claw Machine Model S-01.



Figure 8: Product Specifications.

Feature	Specification
---------	---------------

Feature	Specification
Item Model Number	S-01
Power	50W
Net Weight	48.5 lbs / 22 kg
Product Dimensions	37.8 x 17.91 x 16.93 inches (485 x 320 x 850 mm)
Claw Diameter Range	0-3.15 inches / 0-80 mm
Claw Lifting Range	0-5.12 inches / 0-130 mm
Drop Outlet Size	5.51 x 4.33 inches / 140 x 110 mm
Motor Power	5W
Motor Speed	150 rpm
Manufacturer	VEVOR
Release Date	August 8, 2024

7. WARRANTY AND SUPPORT

Your VEVOR Claw Machine is manufactured by VEVOR. For any product-related inquiries or support, please refer to the following information:

- **Warranty:** The product typically comes with a 1-year warranty. Please refer to your purchase documentation for specific terms and conditions.
 - **Returns:** This product is returnable until January 31, 2026.
 - **Customer Support:** For assistance, please contact VEVOR Customer Support.
-