

## Opmind 8059

# Opmind 5-in-1 STEM Robot Building Toy (Model 8059) Instruction Manual

This manual provides detailed instructions for the assembly, operation, and maintenance of your Opmind 5-in-1 STEM Robot Building Toy.

## 1. INTRODUCTION

---

The Opmind 5-in-1 STEM Robot Building Toy offers an engaging and educational experience, allowing users to construct five distinct robot models from 494 high-quality building blocks. Each model features digital eyes with changing expressions, lifelike sounds, and can be controlled via a 2.4GHz remote or a dedicated smartphone application. This toy is designed to foster creativity, engineering skills, and logical thinking.



Figure 1: Overview of the Opmind 5-in-1 STEM Robot Building Toy, showcasing its various forms and control options.

## 2. PACKAGE CONTENTS

Before beginning assembly, please verify that all components are present in your package. The Opmind 5-in-1 STEM Robot Building Toy includes:

- 494 high-quality building blocks
- 1 x Main control unit with digital expression eyes
- 1 x 2.4GHz Remote controller
- 1 x 3.7V 400mAh Lithium-ion battery (pre-installed)
- 1 x USB charging cable
- 2 x Detailed instruction manuals for different robot models
- 1 x Parts organizer tray



Figure 2: The building blocks are provided in an organized manner to facilitate assembly.

### 3. ASSEMBLY INSTRUCTIONS

The Opmind 5-in-1 STEM Robot allows for the construction of five unique models: Magician, Engineer, Snowplow, Tank, and Snail. Each model has its own dedicated instruction manual.

#### 3.1. General Assembly Guidelines

1. **Organize Parts:** Use the included organizer tray to sort the building blocks by type and color. This will



significantly streamline the assembly process.

2. **Follow Manuals:** Refer to the specific instruction manual for the robot model you wish to build. Each step is illustrated and numbered for clarity.
3. **Secure Connections:** Ensure all blocks are firmly snapped together to prevent the model from falling apart during play.
4. **Electronic Components:** Handle the main control unit and wiring with care. Connect them as indicated in the manual.



Figure 3: The five distinct robot designs that can be built from the kit.

## 4. SETUP

---

### 4.1. Battery Installation and Charging

The robot is equipped with a built-in 3.7V 400mAh lithium battery. Before first use, fully charge the battery using the provided USB charging cable.

- Connect the USB charging cable to the robot's charging port.
- Plug the other end of the cable into a standard USB power adapter (not included) or a computer USB port.
- The charging indicator light will illuminate during charging and turn off when fully charged.
- A full charge typically takes approximately 60-90 minutes and provides up to 40 minutes of play time.



# NO NEED TO REPLACE BATTERIES - USB DIRECT CHARGING

( USB Charging Cable Included )



Figure 4: The robot features convenient USB direct charging.

## 4.2. Remote Control Pairing

To pair the 2.4GHz remote controller with your robot:

1. Ensure the robot's power switch is in the 'ON' position.
2. Turn on the remote controller.
3. The remote and robot should automatically pair. If not, refer to the specific remote control instructions in your manual for manual pairing steps.

### 4.3. App Control and Programming

For enhanced control and programming features, download the official Opmind robot application on your smartphone.

1. Scan the QR code provided in the manual or on the product packaging to download the app.
2. Enable Bluetooth on your smartphone and open the Opmind app.
3. Follow the in-app instructions to connect to your robot via Bluetooth.
4. The app offers various control modes, including Driving Mode, Gyro/Gravity Sensor Mode, Path Mode, and Programming Mode for block-based coding.

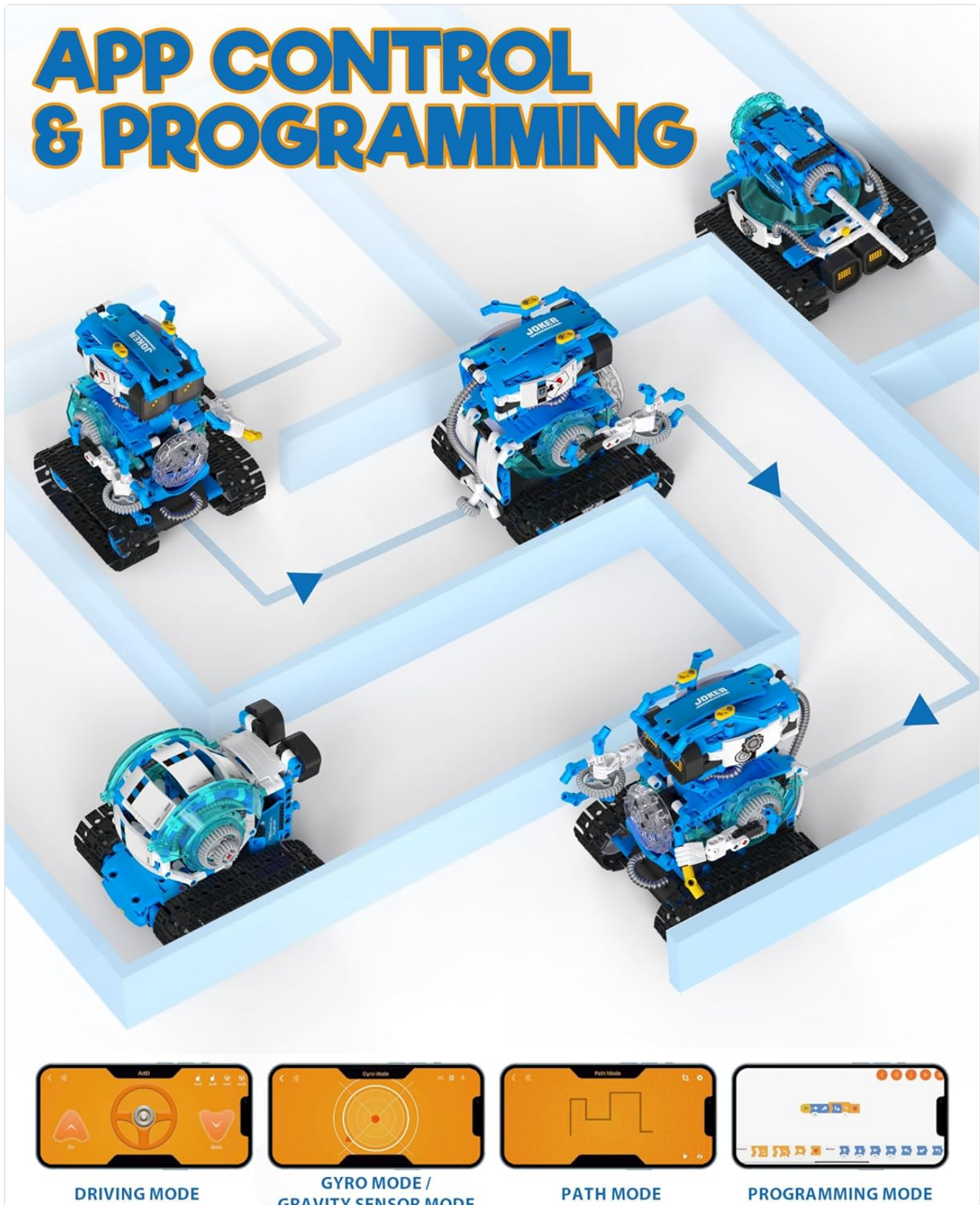

## 5. OPERATING YOUR ROBOT

---

### 5.1. Basic Movement

Use either the remote controller or the smartphone app to maneuver your robot. The controls allow for forward, backward, left, and right movements, as well as turning.

### 5.2. Interactive Features

The robot's digital eyes can display various expressions, and it produces lifelike sounds based on commands. Explore different commands through the app or remote to see the robot's reactions.



# Human-Like Emoji Interaction

Get kids excited about AI technology



Figure 6: The robot's digital eyes and sound features provide human-like interaction.

## 5.3. Switching Robot Modes

To change your robot into one of the other four models, carefully disassemble the current configuration and follow the instructions in the corresponding manual for the new model. Ensure all parts are correctly reassembled for optimal functionality.

Your browser does not support the video tag.

Video 1: Official Opmind product video demonstrating the 5-in-1 robot's various forms and interactive capabilities.

## 6. MAINTENANCE

---

### 6.1. Cleaning

To clean your robot, use a soft, dry cloth. Avoid using water or cleaning solutions, as these can damage the electronic components.

### 6.2. Storage

When not in use, store the robot and its components in a cool, dry place away from direct sunlight. If you plan to store the toy for an extended period, it is recommended to disassemble the robot and store the blocks in the organizer tray to prevent loss or damage.

### 6.3. Battery Care

To prolong battery life:

- Charge the battery fully before first use.
- Do not overcharge the battery. Disconnect the charger once the battery is full.
- If the robot will not be used for a long time, charge it every 3 months to maintain battery health.

## 7. TROUBLESHOOTING

---

If you encounter any issues with your Opmind 5-in-1 STEM Robot, please refer to the following table for common problems and solutions:

Problem	Possible Cause	Solution
Robot does not turn on.	Low battery or power switch is off.	Ensure the power switch is ON. Charge the battery fully.
Remote control not responding.	Remote not paired or low battery in remote.	Re-pair the remote control. Replace remote batteries if applicable.
App connection issues.	Bluetooth is off or app is outdated.	Ensure Bluetooth is enabled. Update the app to the latest version.
Robot moves erratically.	Loose connections or incorrect assembly.	Check all block connections. Review assembly steps in the manual.

## 8. SPECIFICATIONS

---



- **Model Number:** 8059
- **Number of Pieces:** 494
- **Product Dimensions:** 9.4 x 2.7 x 12.9 inches
- **Item Weight:** 2.25 pounds
- **Battery:** 1 x 3.7V 400mAh Lithium Ion (included)
- **Control:** 2.4GHz Remote Control, Smartphone App (Bluetooth)
- **Manufacturer Recommended Age:** 6 years and up

## 9. WARRANTY AND SUPPORT

Opmind offers a 1-year hassle-free warranty for this product. If you have any questions, concerns, or require technical assistance, please contact Opmind customer support through their official website or the contact information provided in your product packaging. Our dedicated team is happy to assist you.

© 2023 Opmind. All rights reserved.

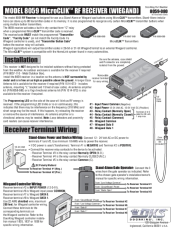
Related Documents - 8059

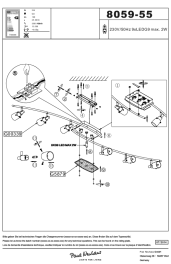
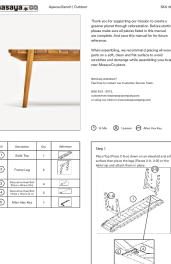
	<p><a href="#">DoorKing 8059 MicroCLIK™ RF Receiver (Wiegand) Installation and Programming Guide</a></p> <p>Detailed guide for the DoorKing 8059 MicroCLIK™ RF Receiver, covering installation, wiring, and programming for stand-alone and Wiegand applications. Includes instructions for transmitter setup, facility code management, and Wiegand output modes.</p>
	<p><a href="#">Toyota 8HBE30 Forklift Specifications and Options</a></p> <p>Detailed specifications and available options for the Toyota 8HBE30 forklift model, including truck and mast configurations.</p>
	<p><a href="#">Blue Sea Systems AC Power Distribution Panels: Installation and Specifications</a></p> <p>Comprehensive guide to Blue Sea Systems AC Power Distribution Panels, covering specifications, installation instructions, wiring diagrams, and safety warnings for marine electrical systems. Includes model numbers 8058, 3058, 8059, 3059, 8265, 3265, 8460, 3460, 8461, 3461, 8480, 3480.</p>
	<p><a href="#">Paul Neuhaus 8059-55 9-Light LED Track Spotlight - Installation and Specifications</a></p> <p>Detailed information and assembly instructions for the Paul Neuhaus 8059-55 9-light LED track spotlight, including technical specifications, energy efficiency, and installation guidance.</p>
	<p><a href="#">MasayaCo Apanas Bench Outdoor Assembly Instructions - SKU 8059</a></p> <p>Step-by-step assembly guide for the MasayaCo Apanas Outdoor Bench (SKU 8059). Includes parts list, contact information, and detailed instructions for easy setup.</p>



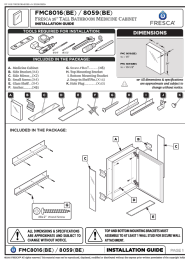

## [FRESCA FMC8016\(BE\) / 8059\(BE\) 36" Tall Bathroom Medicine Cabinet Installation Guide](#)

Step-by-step installation guide for the FRESCA 36" Tall Bathroom Medicine Cabinet (Models FMC8016(BE) and FMC8059(BE)). Covers surface and recess mount options, parts list, dimensions, and door adjustment.