

Unitek SJW-DKM202B

Unitek KVM Switch 2 Monitors 2 Computers 4K@60Hz HDMI+Displayport Dual Monitor KVM Switches

USER MANUAL

Introduction

This user manual provides detailed instructions for the Unitek KVM Switch (Model SJW-DKM202B). This device allows you to connect two computers to a dual monitor setup and share multiple USB 3.0 peripherals, including keyboards, mice, hard drives, and audio devices. Designed for efficiency, it supports high-resolution displays and offers convenient switching methods to streamline your workspace.

Product Overview

Package Contents

Verify that all items are present in your package:

- 1 x Unitek USB HDMI & DP KVM Switch
- 2 x USB A to B cables
- 1 x Desktop controller
- 1 x DC 5V/2A Power Adapter
- 1 x User Manual (this document)

Package List



Image: Contents of the Unitek KVM Switch package.

Device Layout and Ports

The Unitek KVM Switch features clearly labeled ports for easy connection. The front panel provides convenient access to USB 3.0 output ports, headphone, and microphone jacks, along with the power switch and manual switch button. The rear panel houses the input ports for computers (USB-B, HDMI, DisplayPort), output ports for monitors (HDMI, DisplayPort), and the DC 5V power input.

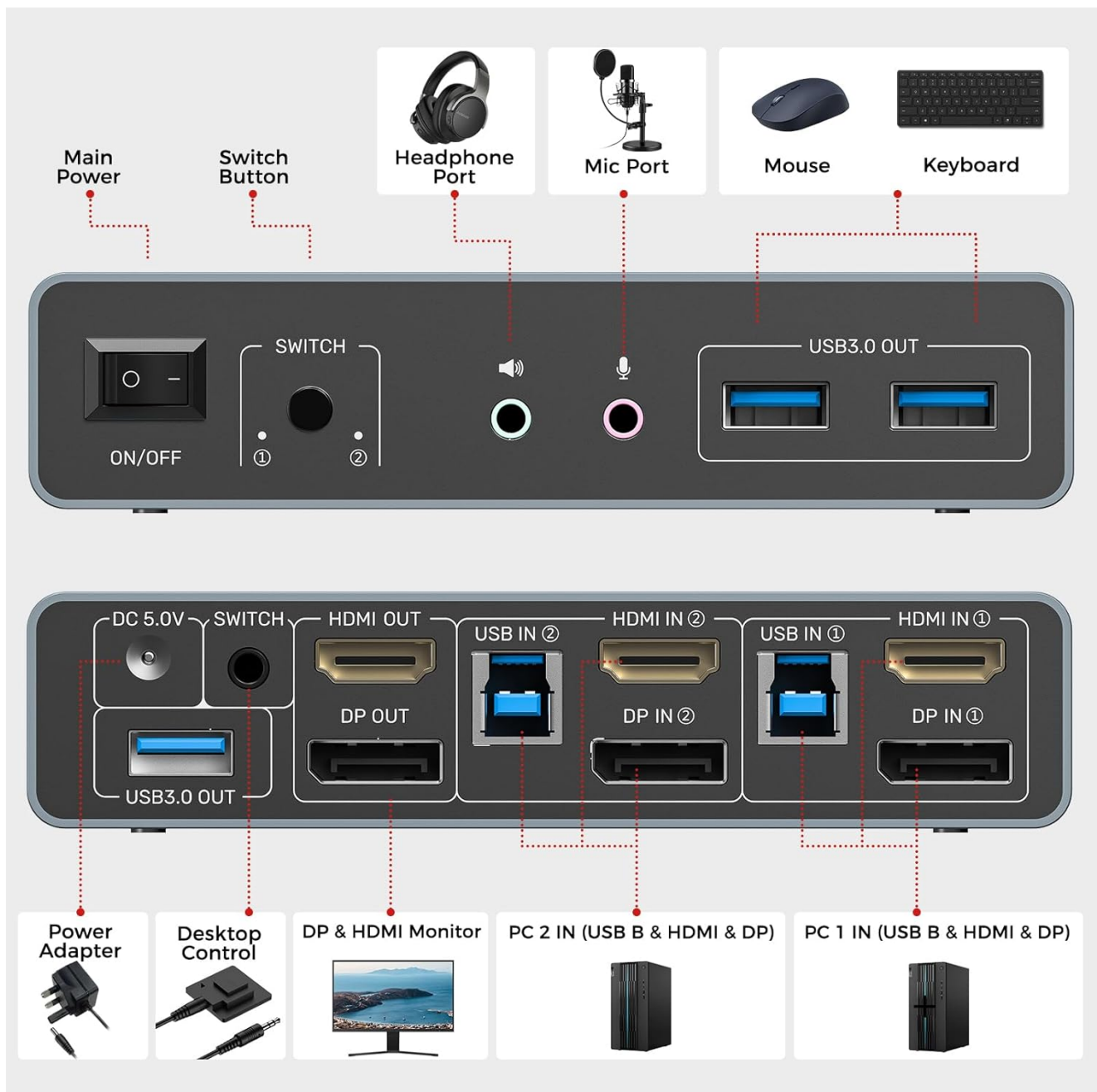

Image: Detailed view of the Unitek KVM Switch's front and rear ports.

Compatibility

This KVM switch is designed for broad compatibility with various operating systems, including Windows 7/8/10/11/Vista/XP, Linux, and Mac OS. It supports a wide range of input devices such as PCs and PS4. Please note that this KVM switch is **NOT COMPATIBLE WITH LAPTOPS**.

Wide Compatibility

Plug and play, no need driver



Image: Operating system compatibility for the Unitek KVM Switch.

Setup Instructions

Follow these steps to set up your Unitek KVM Switch:

- 1. Power Connection:** Connect the included DC 5V/2A power adapter to the KVM switch's DC 5.0V input port. Plug the adapter into a power outlet. This is crucial for stable performance, especially when using multiple USB devices or high-power equipment.
- 2. Monitor Connections:**
 - Connect your primary monitor to the HDMI OUT and DP OUT ports on the KVM switch.
 - Connect the HDMI and DisplayPort cables from the KVM switch's HDMI IN (1) and DP IN (1) ports to your first computer (PC1).
 - Connect the HDMI and DisplayPort cables from the KVM switch's HDMI IN (2) and DP IN (2) ports to your second computer (PC2).
- 3. USB Device Connections:**

- Connect your keyboard, mouse, and other USB 3.0 peripherals (e.g., hard drives, U disks, printers) to the USB3.0 OUT ports on the front panel of the KVM switch.
 - Connect the included USB A to B cables from the USB IN (1) and USB IN (2) ports on the KVM switch to the respective USB ports on your computers (PC1 and PC2).
4. **Audio Connections:** If desired, connect your headphones to the Headphone Port and your microphone to the Mic Port on the front panel.
 5. **Desktop Controller:** Plug the desktop controller into the dedicated SWITCH port on the rear panel.



Image: A fully connected Unitek KVM Switch setup.

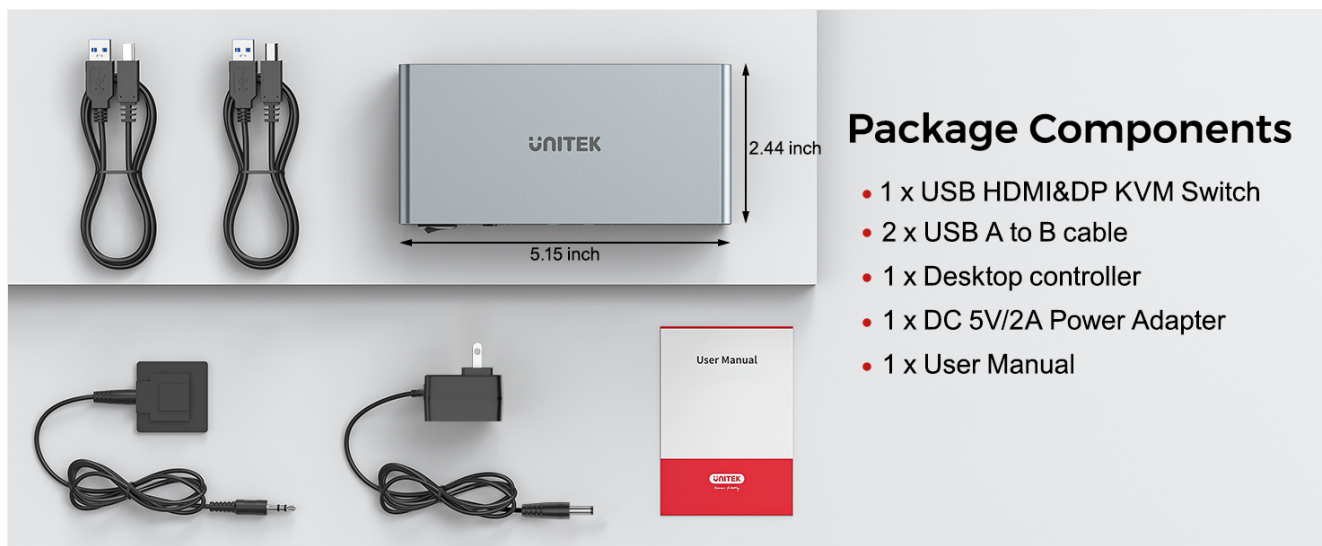

Image: Connection diagram illustrating different setup configurations.

Video Demonstration

Your browser does not support the video tag.

Video: Official Unitek demonstration of the 2-in-2-out DP&HDMI KVM switch, showing setup and functionality.

Operating Instructions

Switching Between Computers

The Unitek KVM Switch offers two convenient methods for switching between connected computers:

- **Desktop Controller:** Use the wired remote switch to easily toggle between PC1 and PC2. This allows you to place the KVM switch in a less visible location, keeping your desk tidy.
- **Button Switch:** Press the 'SWITCH' button located on the front panel of the KVM unit to alternate between the two connected computers.



Image: Two ways to switch between computers.

Display Modes and Resolution

The KVM switch supports both extended and mirror display modes, allowing you to configure your dual monitors as needed. It delivers crystal-clear visuals with support for resolutions up to 4K@60Hz, 2K, 3D, and 1080P. The device is compatible with HDMI 2.0, HDCP 2.2/1.4, USB 2.0, 3D, and HDR standards, ensuring high-quality image output.

2 In 2 Out HDMI&DP KVM Switch

2 PCs share 2 monitors & 3 USB devices & 1 Headset

Extended Mode



Mirror Mode



Image: Extended and Mirror display modes supported by the KVM switch.

Support **4K@60Hz** High Resolution

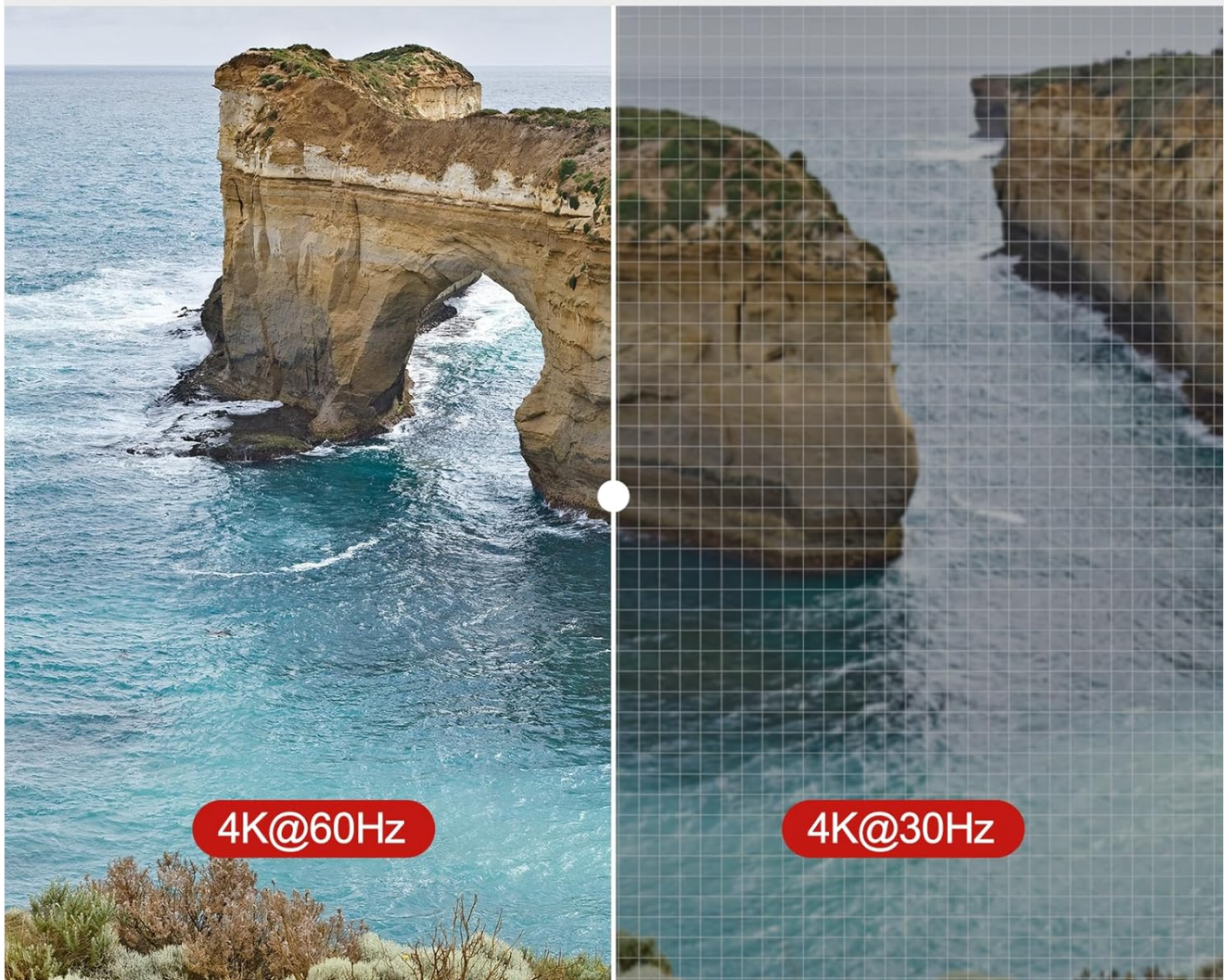

Image: Visual comparison of 4K@30Hz versus 4K@60Hz resolution.

USB 3.0 Data Transfer

The four USB-A ports on the KVM switch support USB 3.0, providing data transfer speeds of up to 5Gbps. This allows for quick and efficient transfer of files and images when using compatible USB 3.0 devices like external hard drives or flash drives.

High Speed Data Transferring



Image: High-speed data transfer capabilities of the USB 3.0 ports.

Maintenance

To ensure the longevity and optimal performance of your Unitek KVM Switch, follow these maintenance guidelines:

- **Cleaning:** Use a soft, dry cloth to clean the exterior of the KVM switch. Avoid using liquid cleaners or abrasive materials, as they may damage the surface or internal components.
- **Storage:** When not in use for extended periods, store the KVM switch in a cool, dry place away from direct sunlight and extreme temperatures.
- **Cable Management:** Ensure all connected cables are not excessively bent or strained to prevent damage to the cables or the KVM ports.

Troubleshooting

If you encounter issues with your Unitek KVM Switch, please refer to the following common problems and solutions:

Problem	Possible Cause	Solution
---------	----------------	----------

Problem	Possible Cause	Solution
No display or flickering screen.	Loose cable connections, incorrect resolution settings, insufficient power.	<ul style="list-style-type: none">◦ Ensure all HDMI and DisplayPort cables are securely connected to both the KVM switch and your monitors/computers.◦ Verify that the DC 5V/2A power adapter is connected and providing power to the KVM switch.◦ Check your computer's display settings to ensure the resolution and refresh rate are supported by your monitors and the KVM switch (up to 4K@60Hz).◦ Try restarting the KVM switch and connected computers.
Keyboard or mouse not responding.	USB cable issues, KVM not switched to correct computer, power issues.	<ul style="list-style-type: none">◦ Ensure the USB A to B cables are securely connected from the KVM switch to both computers.◦ Confirm the KVM switch is set to the correct computer input (PC1 or PC2).◦ Try connecting the keyboard/mouse directly to the computer to verify functionality.◦ Ensure the power adapter is connected, especially if using high-power USB devices.
USB 3.0 devices not detected or slow transfer speeds.	Insufficient power, faulty USB device/cable, incorrect port usage.	<ul style="list-style-type: none">◦ Ensure the DC 5V/2A power adapter is connected to the KVM switch. High-power USB devices require external power.◦ Verify the USB device is functioning correctly by connecting it directly to a computer.◦ Use high-quality USB 3.0 cables for optimal performance.
KVM switch does not work with my laptop.	Incompatibility.	This KVM switch is explicitly NOT COMPATIBLE WITH LAPTOPS . It is designed for desktop PCs.

Specifications

Brand	Unitek
Model Number	SJW-DKM202B
Color	DP+HDMI
Hardware Interface	USB 3.0, HDMI, DisplayPort
Supported Resolution	Up to 4K@60Hz, 2K, 3D, 1080P
Data Transfer Speed	5Gbps (USB 3.0)

Operating System Compatibility	Windows 7/8/10/11/Vista/XP, Linux, Mac OS
Power Adapter	DC 5V/2A (included)
Item Weight	1.1 pounds
Product Dimensions (LxWxH)	3.94 x 1.97 x 0.79 inches

Warranty and Support

For warranty information or technical support, please refer to the contact details provided on the Unitek official website or the product packaging. Keep your purchase receipt for warranty claims.

For further assistance, you may visit the [Unitek Store on Amazon](#).