

Unitek SJW-KM202B

Unitek HDMI KVM Switch (Model SJW-KM202B) User Manual

Connect Two Computers to Dual 4K@60Hz HDMI Monitors and USB 3.0 Peripherals

1. INTRODUCTION

This manual provides detailed instructions for the installation, operation, and maintenance of your Unitek HDMI KVM Switch (Model SJW-KM202B). This device allows you to control two computers using a single set of dual HDMI monitors, a keyboard, a mouse, and other USB 3.0 peripherals. It supports resolutions up to 4K@60Hz, enhancing productivity in both home and office environments.

Important Note: This product is designed for use with desktop hosts only and is not compatible with laptops. Ensure all necessary cables, including the USB A-to-B cables and HDMI cables, are connected for full functionality.

2. PACKAGE CONTENTS

Please verify that all items listed below are included in your package:

- 1 x Unitek HDMI KVM Switch (Model SJW-KM202B)
- 2 x USB A to B Cables
- 1 x Desktop Controller
- 1 x DC 5V/2A Power Adapter
- 1 x User Manual

Package List



Image: The Unitek HDMI KVM Switch and its included accessories, such as USB A to B cables, desktop controller, and power adapter.

The image above displays the Unitek HDMI KVM Switch along with its complete set of accessories, including the main switch unit, two USB A to B cables for connecting to computers, a desktop controller for remote switching, a DC 5V/2A power adapter for stable operation, and the user manual.

3. PRODUCT OVERVIEW

The Unitek HDMI KVM Switch is designed for efficient management of multiple computers. It features a robust metal casing and clearly labeled ports for easy setup.

Front Panel

- **ON/OFF Switch:** Power toggle for the device.
- **Switch Button:** Manually switch between PC1 and PC2.
- **Headphone Port:** 3.5mm audio output for headphones.
- **Mic Port:** 3.5mm audio input for a microphone.
- **USB 3.0 OUT Ports (x3):** Connect USB peripherals such as keyboard, mouse, USB flash drives, printers, and mobile hard drives.

Rear Panel

- **DC 5V Power Input:** Connect the included 5V/2A power adapter.
- **HDMI OUT A & B:** Connect to your dual HDMI monitors.
- **PC1 IN (HDMI A, HDMI B, USB IN):** Connect to the first computer's dual HDMI outputs and USB 3.0 port.
- **PC2 IN (HDMI A, HDMI B, USB IN):** Connect to the second computer's dual HDMI outputs and USB 3.0 port.
- **Desktop Control Port:** Connect the wired desktop controller for remote switching.

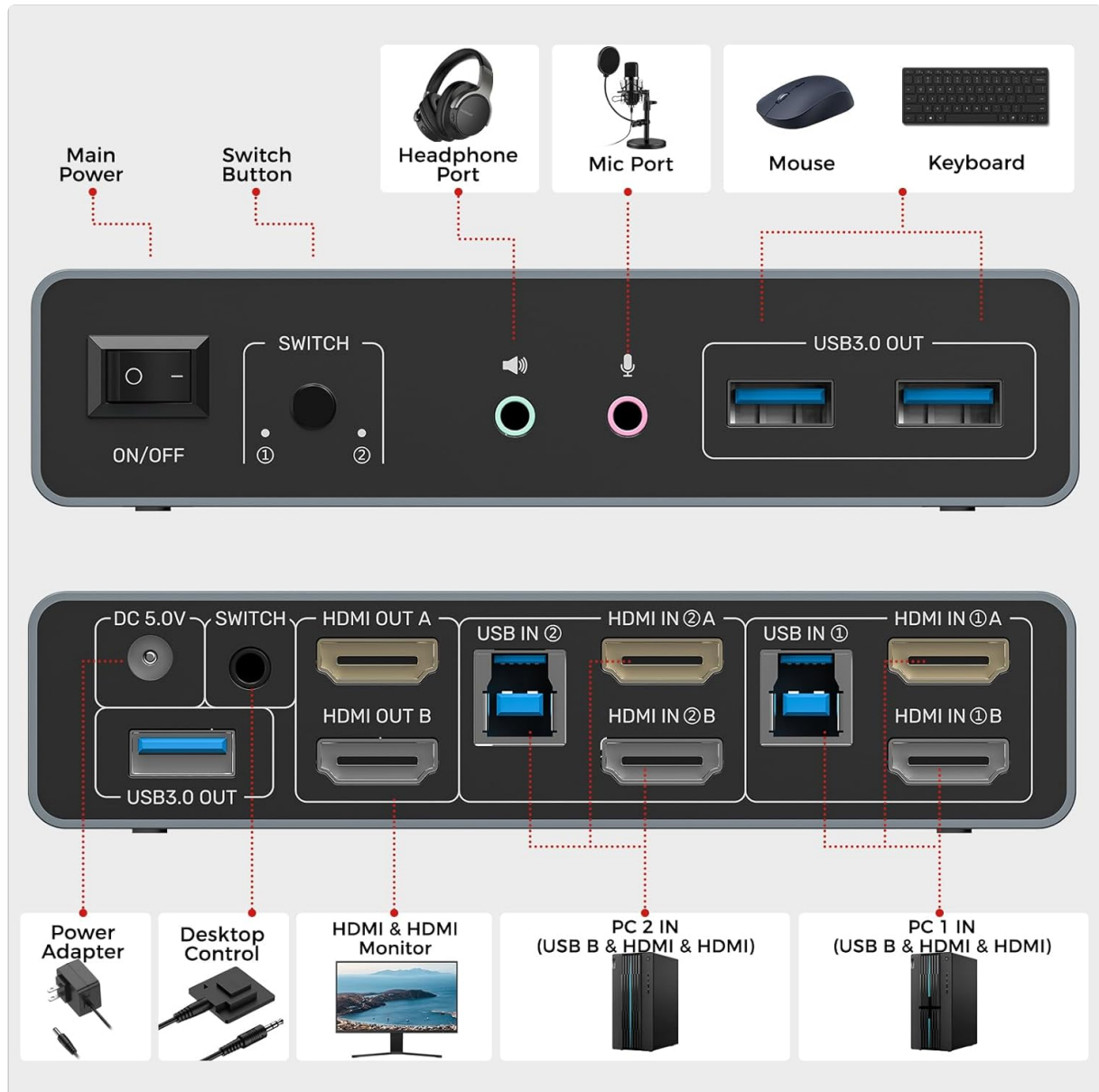

Image: Detailed view of the KVM switch's front panel with USB 3.0 ports, audio jacks, and power switch, and the rear panel showing HDMI inputs/outputs and USB-B ports for computer connections.

The illustration above highlights the various ports on the front and rear panels of the KVM switch. The front provides convenient access for USB peripherals and audio connections, while the rear panel is dedicated to connecting the two computers, dual monitors, and the power supply.

4. SETUP INSTRUCTIONS

Follow these steps to correctly set up your Unitek HDMI KVM Switch:

1. **Power Connection:** Connect the DC 5V/2A power adapter to the KVM switch's DC 5V input port and plug it

into a power outlet. This is crucial for stable operation, especially when using high-power USB devices.

2. Computer 1 Connection:

- Connect two HDMI cables from the HDMI outputs of PC1 to the "HDMI IN A" and "HDMI IN B" ports under "PC1 IN" on the KVM switch.
- Connect one USB A-to-B cable from a USB 3.0 port on PC1 to the "USB IN" port under "PC1 IN" on the KVM switch.

3. Computer 2 Connection:

- Connect two HDMI cables from the HDMI outputs of PC2 to the "HDMI IN A" and "HDMI IN B" ports under "PC2 IN" on the KVM switch.
- Connect one USB A-to-B cable from a USB 3.0 port on PC2 to the "USB IN" port under "PC2 IN" on the KVM switch.

4. **Monitor Connection:** Connect two HDMI cables from your dual monitors to the "HDMI OUT A" and "HDMI OUT B" ports on the KVM switch.

5. **Peripheral Connection:** Connect your keyboard, mouse, and other USB 3.0 peripherals (e.g., USB flash drive, printer, external hard drive) to the "USB 3.0 OUT" ports on the front panel of the KVM switch. If using a microphone or headphones, connect them to the respective 3.5mm audio jacks.

6. **Desktop Controller (Optional):** Connect the wired desktop controller to the "Desktop Control" port on the rear panel for convenient remote switching.

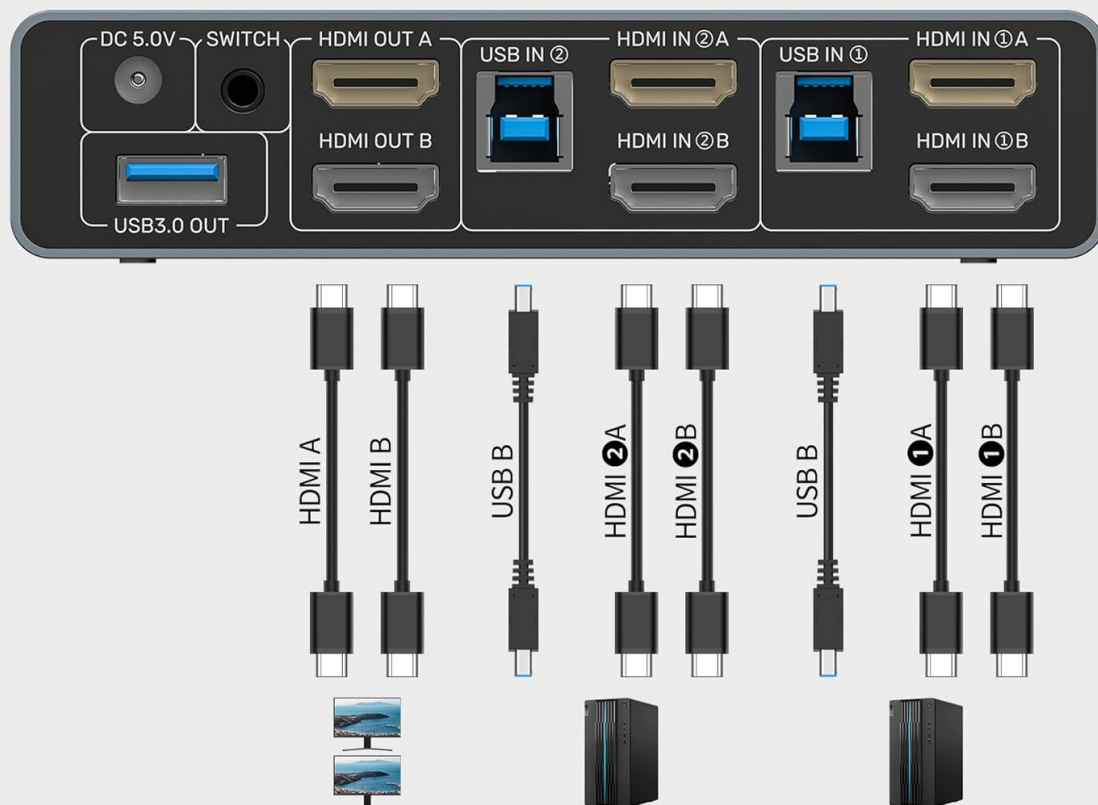

The device exclusively supports dual-desktop configurations.



This is an HDMI KVM switch without DisplayPort (DP) interfaces. Each host system requires connecting 2 HDMI cables + 1 USB-B cable for full functionality



DP
NOT SUPPORT

Image: A visual diagram illustrating the correct connection of two computers, dual monitors, and USB peripherals to the KVM switch.

The diagram above provides a clear visual guide for connecting all components to the KVM switch, ensuring proper setup for dual monitor and peripheral sharing between two computers.

✓ Correct connection



✗ Incorrect connection



Note: For normal operation, each PC requires TWO HDMI cables (for video) and ONE USB-B cable (for data transfer)

Image: Comparison of correct and incorrect cable connections to the KVM switch, emphasizing the need for two HDMI cables and one USB-B cable per PC.

This image demonstrates the critical difference between correct and incorrect wiring. For optimal performance, each PC must have two HDMI cables for video and one USB-B cable for data transfer connected to the KVM switch.

Your browser does not support the video tag.

Video: A short demonstration of the Unitek 2-in-2-out HDMI KVM switch, showcasing its compact design and port layout. This video provides a quick visual overview of the device.

This video from Unitek Official provides a concise overview of the KVM switch, highlighting its physical features and demonstrating its intended use in a dual-computer setup.

Your browser does not support the video tag.

Video: This video demonstrates the setup and functionality of an HDMI KVM switch for connecting two monitors and two computers, illustrating the process of sharing peripherals and displays.

This video from SuidekDirect offers a practical demonstration of setting up an HDMI KVM switch to manage two computers with dual monitors, showing how to connect all necessary cables and peripherals.

5. OPERATING INSTRUCTIONS

Once the KVM switch is set up, you can easily switch between your connected computers and manage your display modes.

Switching Between Computers

There are two convenient methods to switch between PC1 and PC2:

- **Front Panel Button:** Press the "SWITCH" button on the front panel of the KVM switch to toggle between PC1 and PC2.
- **Desktop Controller:** Use the wired desktop controller (if connected) to switch between computers with a simple press of its button. This allows you to place the KVM switch out of sight for a cleaner desk.



Image: Illustration of the two switching methods: the button on the KVM unit and the external desktop controller.

The image above demonstrates both the manual switch button on the KVM unit and the wired desktop controller, providing flexible options for switching between your connected computers.

Display Modes (Mirror or Extend)

The KVM switch supports both Mirror Mode (Duplicate) and Extend Mode for your dual monitors.

- **Windows System:** Press Win + P. From the menu, select:
 - **Duplicate (Mirror Mode):** Both screens will display the same content.
 - **Extend (Extended Mode):** Combines both screens into a larger workspace.
- **macOS System:** After connecting an external display, press Option + F1 (or use the Touch Bar display icon). In the pop-up menu, select "Mirror" or "Extend".



Image: Visual representation of Extended Mode, where two monitors act as a single large desktop, and Mirror Mode, where both monitors display identical content.

This image clearly illustrates the difference between Extended Mode, which expands your desktop across two screens, and Mirror Mode, which duplicates the display on both monitors.

Your browser does not support the video tag.

Video: A user demonstrates how to control two computers from one keyboard, mouse, and HDMI monitor using the KVM switch, highlighting the seamless switching capability.

This video from The Stuff We Use demonstrates the practical application of the KVM switch, showing how a single

keyboard, mouse, and HDMI monitor can be used to control two separate computers, illustrating the efficiency of the device.

6. MAINTENANCE

To ensure the longevity and optimal performance of your Unitek HDMI KVM Switch, please follow these maintenance guidelines:

- **Cleaning:** Use a soft, dry cloth to clean the exterior of the device. Avoid using liquid cleaners or aerosols, which may damage the unit.
- **Ventilation:** Ensure the KVM switch is placed in a well-ventilated area to prevent overheating. Do not block any ventilation openings.
- **Cable Management:** Keep cables organized and free from kinks or excessive tension to prevent damage to the cables and ports.
- **Power Supply:** Always use the original DC 5V/2A power adapter provided with the device. Using an incorrect power adapter may cause damage or malfunction.
- **Storage:** If storing the device for an extended period, disconnect all cables and store it in a cool, dry place away from direct sunlight and extreme temperatures.

7. TROUBLESHOOTING

If you encounter issues with your KVM switch, please refer to the following common troubleshooting steps:

- **No Display on Monitors:**
 - Ensure the KVM switch is powered on and the power adapter is securely connected.
 - Verify that all HDMI cables are correctly and securely connected from the computers to the KVM switch, and from the KVM switch to the monitors.
 - Check the display settings on your computers to ensure the correct output resolution and refresh rate are selected (up to 4K@60Hz).
 - Try restarting the computers and the KVM switch.
- **Keyboard/Mouse Not Responding:**
 - Ensure the USB A-to-B cables are securely connected from both computers to the KVM switch.
 - Try connecting the keyboard and mouse to different USB 3.0 OUT ports on the KVM switch.
 - Some specialized gaming keyboards/mice may require direct connection to the computer or specific drivers. Try a standard keyboard/mouse to isolate the issue.
 - Restart the KVM switch and computers.
- **Switching Issues:**
 - Ensure the desktop controller (if used) is properly connected to its dedicated port.
 - Verify that the KVM switch is receiving adequate power.
- **Audio Issues:**
 - Check that headphones/microphone are correctly plugged into the KVM switch's audio jacks.
 - Verify audio output settings on your computers are configured to use the KVM switch's audio device.
- **"NOTE: DO NOT COMPATIBLE WITH LAPTOPS!"** This KVM switch is specifically designed for desktop computers. Laptops may have different power delivery or video output configurations that are not supported.

8. SPECIFICATIONS

Product Dimensions	3.94 x 1.97 x 0.79 inches; 1.15 Pounds
Item Model Number	SJW-KM202B
Brand	Unitek
Hardware Interface	USB 3.0, HDMI 2.0
Video Resolution	Up to 4K@60Hz, 2K, 3D, 1080P
HDCP Support	HDCP 2.2/1.4
USB Data Transfer Speed	Up to 5Gbps (USB 3.0)
Power Adapter	DC 5V/2A
Special Feature	Plug and Play, Two-way Switching (Button/Desktop Controller)
Compatible Devices	Keyboards, Mice, USB Flash Drives, Printers, Mobile Hard Drives, PCs (Desktop Hosts Only)

9. WARRANTY AND SUPPORT

For warranty information, technical support, or any inquiries regarding your Unitek HDMI KVM Switch, please refer to the official Unitek website or contact their customer service directly. Keep your purchase receipt for warranty claims.