

[Manuals.plus](#) /

> [AAWireless](#) /

> AAWireless Two - Android Auto Wireless Adapter - Convert Factory Wired Android Auto to Wireless - Multifunctional Button - Easy Plug and Play Setup - Seamlessly Connect Via Bluetooth - Made in Europe

AAWireless AAW2

AAWireless Two - Android Auto Wireless Adapter

Model: AAW2 | Brand: AAWireless

INTRODUCTION

The AAWireless TWO is an innovative adapter designed to convert your car's factory wired Android Auto system into a wireless experience. This device offers seamless connectivity, allowing you to enjoy Android Auto features on your car's display without the need for a physical cable connection to your smartphone. Key features include a multifunctional button for easy phone switching and pairing, a compact design for discreet installation, and compatibility with Android 11 or higher smartphones and cars supporting wired Android Auto. The device is designed and manufactured in Europe by a dedicated team of developers.

SETUP

Setting up your AAWireless TWO adapter is a straightforward plug-and-play process:

- Connect the Adapter:** Plug the AAWireless TWO adapter into your car's Android Auto-enabled USB Type A port using the included USB Type C (device) to USB Type A (car) cable.
- Initial Pairing:** Once connected, the adapter will power on. Follow the on-screen prompts on your car's infotainment system to pair your Android smartphone via Bluetooth. Ensure your phone has Android 11 or higher.
- Download the Companion App:** For full functionality, firmware updates, and advanced settings, download the official AAWireless companion app from the Google Play Store on your smartphone.
- Complete Setup via App:** Open the app and follow the guided setup process. The app allows you to manage device settings, perform firmware updates, and access troubleshooting tools.



Image: The compact AAWireless Two adapter.



Make **Android Auto™** wireless
with the AAWireless TWO.

Image: The AAWireless Two adapter connected to a car's USB port.

Get more out of Android Auto with the **free app**.

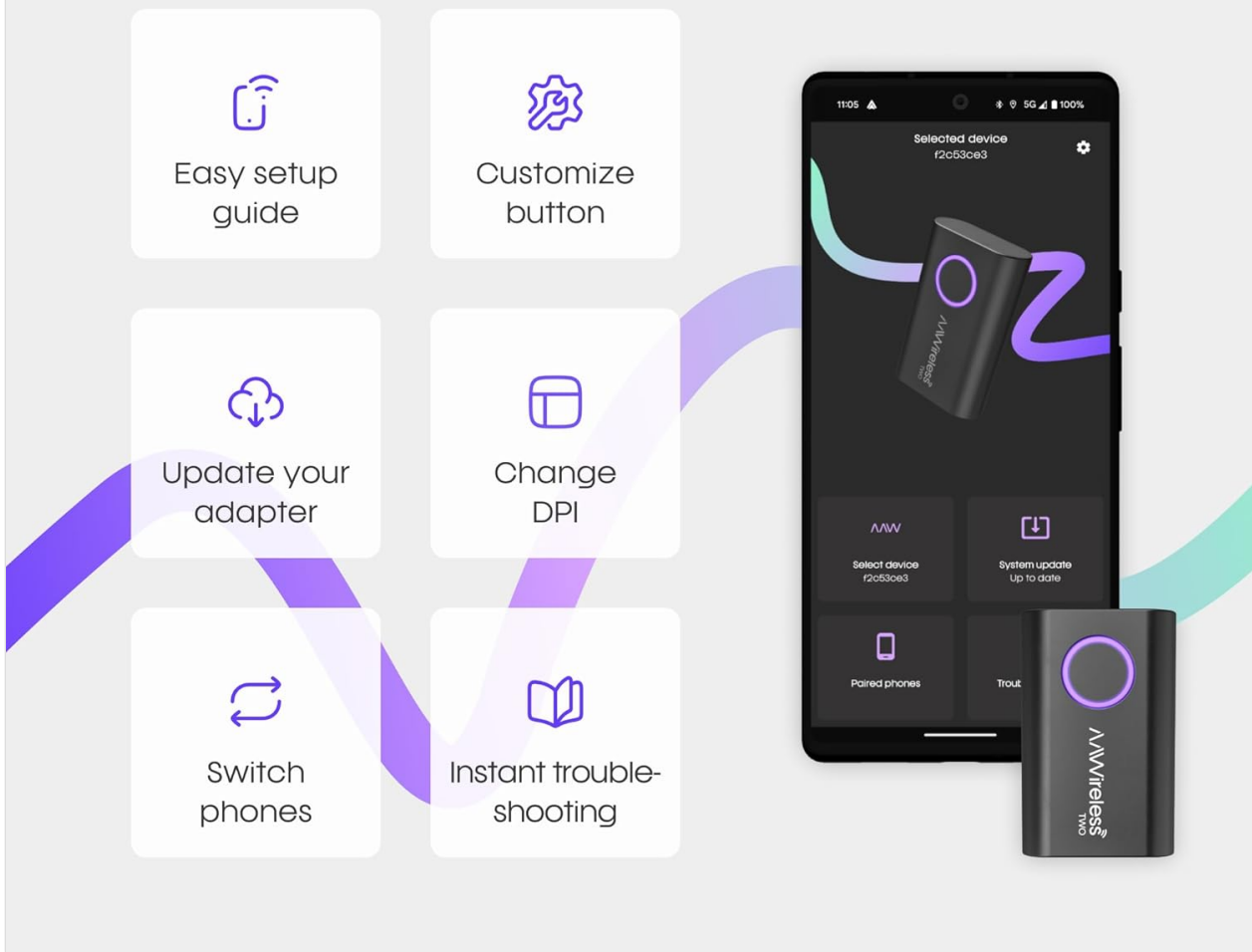

Image: Screenshot of the AAWireless companion app showing various features.

OPERATING

The AAWireless TWO is designed for effortless operation:

- **Automatic Connection:** Once initially paired, the adapter will automatically connect to your smartphone and launch Android Auto wirelessly each time you start your car.
- **Multifunctional Button:** The device features a single button for various functions:
 - **Pairing Mode:** Press and hold the button to enter pairing mode for new devices.
 - **Switch Phones:** If multiple phones are paired, a short press can switch between connected devices.
 - **Standby Mode:** The app allows configuration for auto-standby when the car's hands-free system is not connected to the phone, useful for cars that keep USB power on.
- **Wireless Freedom:** With wireless Android Auto, your phone can remain in your pocket or charging wirelessly, eliminating cable clutter.

Easily **pair** and **switch**
between phones.



Image: Demonstrating the ability to easily pair and switch between multiple phones.

Your favorite apps on your car screen. All **wireless**.



Image: Your favorite Android Auto apps displayed wirelessly on the car screen.

MAINTENANCE

To ensure optimal performance and compatibility, regular maintenance is recommended:

- **Firmware Updates:** Utilize the AAWireless companion app to check for and install the latest firmware updates. These updates often include performance improvements, bug fixes, and enhanced compatibility with new car models and Android versions.
- **Cleaning:** Keep the adapter clean and free from dust and debris. Use a soft, dry cloth for cleaning. Avoid using liquid cleaners or abrasive materials.
- **Cable Care:** Ensure the USB cable is not bent sharply or damaged, as this can affect connectivity.

TROUBLESHOOTING

If you encounter issues with your AAWireless TWO adapter, consider the following steps:

- **Check Connections:** Ensure the adapter is securely plugged into the car's USB port.

- **Restart Device/Car:** Unplug the adapter and plug it back in. Sometimes, restarting your car's infotainment system can resolve minor connectivity issues.
- **Companion App Troubleshooting:** The AAWireless companion app includes a dedicated troubleshooting section. This tool can help diagnose common problems and provide solutions, such as interpreting LED light indicators (e.g., solid blue for connected, solid red for issues).
- **Firmware Update:** Verify that your adapter's firmware is up to date using the companion app. Outdated firmware can sometimes cause compatibility or performance problems.
- **Phone Compatibility:** Confirm your smartphone runs Android 11 or higher and is on Google's official list of Android Auto compatible smartphones.
- **Car Compatibility:** Ensure your car's head unit exclusively supports wired Android Auto.
- **Reset to Factory Settings:** As a last resort, the companion app offers an option to revert the device to default factory settings.

SPECIFICATIONS

Feature	Detail
Product Dimensions	2.17 x 1.38 x 0.59 inches
Item Weight	0.635 ounces
Item Model Number	AAW2
Connectivity Technologies	Bluetooth, Wi-Fi
Special Features	Multifunctional Button, Hands-Free Calls, Wireless Android Auto, Automatic On/Off
Color	Black
Manufacturer	AAWireless
Compatible Devices	Smartphones with Android 11 or higher; cars/head units supporting wired Android Auto.
Connector Type	USB Type C (device), USB Type A (car)

The AAWireless TWO is manufactured, distributed and sold by AAWireless. AAWireless and the stylized AAW logo, are trademarks or registered trademarks of AAWireless. Android, Android Auto and Google Play are trademarks of Google LLC. All other trademarks are the property of their respective owners. © 2024 AAWireless. All rights reserved.

Model: AAW2
Manufacturer: AAWireless
Address: Oosterhamrikkade 119-34,
9713 KC, Groningen, The Netherlands
Made in Europe



Image: Product information and certifications on the back of the box.

WARRANTY AND SUPPORT

For detailed warranty information, please refer to the documentation included with your AAWireless TWO product or visit the official AAWireless website. The companion app serves as a primary resource for support, offering troubleshooting guides and the ability to update your device's firmware.

For further assistance, please contact AAWireless customer support through their official channels.