

## Phomemo M833

# Phomemo M833 Bluetooth Thermal Printer User Manual

Model: M833

## 1. INTRODUCTION

This manual provides comprehensive instructions for the Phomemo M833 Bluetooth Thermal Printer. It covers setup, operation, maintenance, and troubleshooting to ensure optimal performance and longevity of your device. Please read this manual thoroughly before using the printer.

## 2. PRODUCT OVERVIEW

The Phomemo M833 is a portable, inkless thermal printer designed for convenience and high-quality document printing. It supports various thermal paper sizes, including US Letter (8.5" x 11"), A4 (8.27" x 11.69"), and smaller widths (2", 3", 4").



Figure 2.1: Phomemo M833 Thermal Printer with its protective carrying case.

### Key Features:

- **Inkless Thermal Printing:** Eliminates the need for ink cartridges or toner.
- **High Resolution:** 300dpi for clear and sharp prints.
- **Multi-size Paper Support:** Compatible with US Letter, A4, and various roll paper widths.
- **Portable Design:** Lightweight (750g) with a built-in 2600mAh battery for on-the-go printing.
- **Wireless Connectivity:** Bluetooth connection for mobile devices (Phone, iPad).
- **Wired Connectivity:** USB connection for laptops and computers.
- **Versatile Document Support:** Prints PDF, Word, Excel, JPG, Web pages, and TXT files.

# WIDELY USED PORTABLE PRINTER



Figure 2.2: The M833 printer's capabilities, including 300dpi resolution, 2600mAh battery, and supported file formats like Word, Excel, TXT, JPG, and PDF.

## Package Contents:

- Phomemo M833 Thermal Printer
- Protective Carrying Case
- USB-C Charging Cable
- Thermal Paper Roll (sample)
- Quick Start Guide

# Product Specification

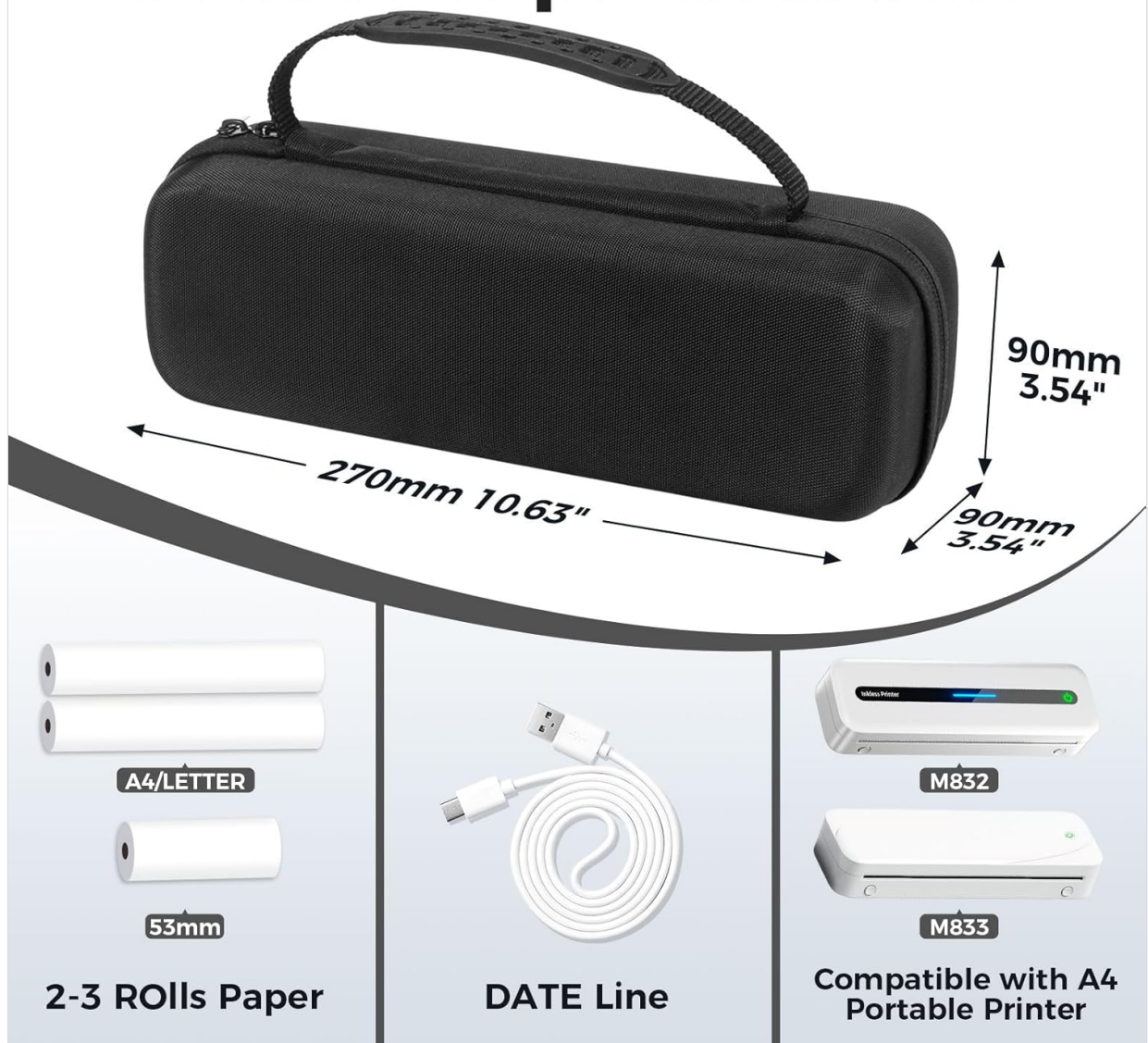

Figure 2.3: Contents of the Phomemo M833 printer package, showing the printer, paper rolls, and charging cable.

## 3. SETUP

### 3.1 Charging the Printer

Before initial use, fully charge the printer. Connect the supplied USB-C cable to the printer's charging port and the other end to a compatible USB power adapter (not included) or a computer's USB port. The indicator light will show charging status.

Your browser does not support the video tag.

Video 3.1: Demonstrates how to charge the Phomemo M833 printer and turn it on. This video also shows how to install roll paper.

### 3.2 Installing Thermal Paper

The M833 printer supports both thermal paper rolls and folded thermal paper sheets. Ensure you use thermal paper as the printer does not use ink.

#### 3.2.1 Installing Roll Paper

1. Press the two release buttons on either side of the printer simultaneously to open the top cover.
2. Remove any existing paper roll or protective paper.
3. Unwrap a new thermal paper roll and ensure the printing side (usually smoother) is facing the print

head.

4. Place the paper roll into the designated slot.
5. Pull a small section of paper out, ensuring it is straight and aligned with the paper exit slot.
6. Close the top cover until it clicks securely into place.



Figure 3.1: The Phomemo M833 printer actively printing a document, illustrating the paper feeding mechanism.

### 3.2.2 Installing Folded Thermal Paper Sheets

1. Ensure the printer is powered on.
2. Locate the paper inlet slot at the back of the printer.
3. Insert a single sheet of folded thermal paper into the inlet, printing side facing up. The printer will automatically feed the paper into position.
4. Ensure the paper is inserted straight to prevent jams or skewed prints.

### 3.3 Connecting to the Phomemo App (Bluetooth)

For mobile printing, download the "Phomemo" app from your device's app store (Google Play for Android, App Store for iOS).

1. Ensure your printer is charged and powered on (green indicator light).

2. Enable Bluetooth on your mobile device.
3. Open the Phomemo app. The app will automatically search for nearby printers.
4. Select "M833" from the list of available devices to connect.
5. Once connected, the app will prompt you to select the paper type (e.g., Large roll paper, Small roll paper, Single sheet paper). Choose the appropriate option.



Figure 3.2: The Phomemo M833 printer connected to a smartphone, displaying the Phomemo app interface with various print options.

### 3.4 Connecting to a Computer (USB)

For printing from a laptop or desktop computer, connect the printer using the supplied USB-C cable.

1. Connect one end of the USB-C cable to the printer's USB port.
2. Connect the other end to an available USB port on your computer.
3. The computer should automatically detect the printer. If not, you may need to install the printer driver, which can typically be found on the Phomemo official website.
4. Once the driver is installed, the printer will appear in your computer's list of printers, ready for use.

## 4. OPERATING INSTRUCTIONS

## 4.1 Printing from Mobile Device (Phomemo App)

1. Ensure the printer is connected to the Phomemo app via Bluetooth.
2. From the app's main interface, select your desired printing function (e.g., "Print Documents," "Print Images," "Print Web").
3. Browse and select the file or image you wish to print.
4. Adjust print settings such as copies, thickness (light, medium, heavy), and paper size within the app's print preview screen.
5. Tap the "Print" button to initiate printing.

Your browser does not support the video tag.

Video 4.1: A short demonstration of the Phomemo M833 printer's compact size and ease of use for business and homeschooling applications.

## 4.2 Printing from Computer

1. Ensure the printer is connected to your computer via USB and the necessary drivers are installed.
2. Open the document or image you wish to print on your computer.
3. Go to "File" > "Print" (or use the shortcut Ctrl+P/Cmd+P).
4. Select "Phomemo M833" as your printer.
5. Adjust print preferences (e.g., paper size, orientation, print quality) in the printer settings dialog.
6. Click "Print" to send the job to the printer.



Figure 4.1: A visual comparison demonstrating the superior print clarity of the M833 at 300DPI compared to a 203DPI printer.

## 5. MAINTENANCE

### 5.1 Cleaning the Print Head

To maintain print quality, regularly clean the print head. Use a soft, lint-free cloth lightly dampened with isopropyl alcohol. Gently wipe the print head surface. Ensure the printer is off and completely dry before use.

### 5.2 Replacing Paper

Follow the instructions in Section 3.2 for installing new thermal paper rolls or sheets when the current supply runs out.

## 6. TROUBLESHOOTING

Problem	Possible Cause	Solution
Printer not turning on	Low battery or power issue.	Charge the printer using the supplied USB-C cable. Ensure the power button is pressed and held for 3 seconds.

Problem	Possible Cause	Solution
Poor print quality (faint/streaky)	Incorrect paper type, dirty print head, or low battery.	Ensure you are using thermal paper. Clean the print head (Section 5.1). Charge the printer. Adjust print density in the app/driver settings.
Paper jam	Improper paper loading or foreign object.	Open the top cover and carefully remove the jammed paper. Reload paper correctly (Section 3.2).
Cannot connect via Bluetooth	Bluetooth off, printer not discoverable, or app issue.	Ensure printer is on and Bluetooth is enabled on your device. Restart the app and try connecting again. Forget the device in Bluetooth settings and re-pair.
Cannot print from computer	Driver not installed, incorrect USB connection.	Ensure USB cable is securely connected. Install the correct printer driver from the Phomemo website. Restart computer and printer.

## 7. SPECIFICATIONS

Feature	Detail
Model	M833
Printing Technology	Thermal
Resolution	300dpi
Connectivity	Bluetooth, USB-C
Battery Capacity	2600mAh
Supported Paper Sizes	US Letter (8.5" x 11"), A4 (8.27" x 11.69"), 2", 3", 4" width thermal paper
Supported Paper Types	Thermal standard paper sheets, roll paper, folded thermal paper
Weight	Approx. 750g
Compatible Devices	Phone (iOS/Android), iPad, Laptop/PC

## 8. WARRANTY AND SUPPORT

Phomemo products are designed for reliability and performance. For warranty information, technical support, or service inquiries, please refer to the official Phomemo website or contact their customer service directly. Keep your purchase receipt for warranty claims.

For further assistance, visit the [Phomemo Store on Amazon](#).

### Related Documents - M833

 <p>portable printer <b>User Guide</b></p> <p><small>Before using this product, please read this manual carefully.</small></p>	
---	--



[illegible]

**Phomemo M832 A4 Portable Thermal Printer User Guide and Tips**

## Information and usage tips for the Phomemo M832 A4 Portable Thermal Printer by Zoolion, including setup instructions and troubleshooting advice.

**Table of Contents:**

- 1. Introduction
- 2. Safety Precautions
- 3. Package Contents
- 4. Quick Start Guide
- 5. Basic Operation
- 6. Advanced Features
- 7. Troubleshooting
- 8. Maintenance
- 9. Warranty Information
- 10. Contact Us

[illegible]

[Phomemo M08F Portable Printer Quick Start Guide](#)

A quick start guide for the Phomemo M08F portable thermal printer, covering setup, operation, app

[illegible]



Download the latest driver from the official website. Download the relevant driver according to the operating system version and follow the instructions to install the driver.



## 2. Instructions

### 2.1 Instructions for consumable usage

1. Plug the top cover. Open the cover at the same time to load the cover.
2. Take out the newly included paper roll and attach it.
3. Install the paper roll into the paper compartment and roll the paper out of the Paper Support Box. Close the cover.
4. Press and hold the power button for 3 seconds to start the printer.

→ How to differentiate the front and back of the printing paper.  
① Take a piece of printing paper and scratch both sides of the paper with your fingernail.  
② The printed or printed side of the paper. Please adjust the position of the paper according to the scratch direction.  
③ The printed or printed side of the paper. Please adjust the position of the paper according to the scratch direction.

### 2.2 Instructions for single sheet paper and folded paper usage

1. You can use the paper type in the corresponding way in the application.  
When using single sheet paper or folded paper, please make sure the paper is flat and the paper is not folded. Please adjust the position of the paper according to the scratch direction.  
When you need to use single sheet paper, please use the paper support box to support the paper. When you need to use folded paper, please use the paper support box to support the paper. Then, adjust the paper.
2. When you need to use single sheet paper, please use the paper support box to support the paper. When you need to use folded paper, please use the paper support box to support the paper. Then, adjust the paper.

→ How to differentiate the front and back of the printing paper.  
① The printed or printed side of the paper. Please adjust the position of the paper according to the scratch direction.  
② The printed or printed side of the paper. Please adjust the position of the paper according to the scratch direction.  
③ The printed or printed side of the paper. Please adjust the position of the paper according to the scratch direction.

### 2.3 Connect the printer to the App

1. Connect the printer to your phone. Search the Phomemo APP from the App Store and the Google Play Store of the Phomemo APP, and download the corresponding application. Please make sure to enable the location and allow the app to access the network.
2. Open the Phomemo APP. Tap the "Printer" button in the bottom right corner of the Phomemo APP. Tap the "Printer" button in the bottom right corner of the Phomemo APP. Tap the "Printer" button in the bottom right corner of the Phomemo APP.

### 2.4 Connect the printer to the computer

1. Connect the printer to your computer. Search the Phomemo APP from the App Store and the Google Play Store of the Phomemo APP, and download the corresponding application. Please make sure to enable the location and allow the app to access the network.
2. Open the Phomemo APP. Tap the "Printer" button in the bottom right corner of the Phomemo APP. Tap the "Printer" button in the bottom right corner of the Phomemo APP. Tap the "Printer" button in the bottom right corner of the Phomemo APP.

### 2.5 Official Printing Paper Type

1. Thermal thermal paper. Please use the official thermal paper.
2. Thermal thermal paper. Please use the official thermal paper.

### 2.6 Warranty Card

<input type="checkbox"/> Name	<input type="checkbox"/> Gender	<input type="checkbox"/> Phone
Name		
Gender		
Phone		
Purchase Date		
Product Serial Number		
Product Batch Number		
Product Description		
Sales and Service		
Sales and Service		
Sales and Service		

### 2.7 FCC Warning

FCC Warning (Federal Communications Commission): This device complies with part 15 of the FCC Rules. Operation is subject to the following two conditions: (1) This device may not cause harmful interference, and (2) this device must accept any interference received, including interference from any unauthorized operation.

This equipment has been tested and found to comply with the limits for a Class B digital device, pursuant to part 15 of the FCC Rules. These limits are designed to provide reasonable protection against harmful interference in a residential environment. This equipment generates, uses, and can radiate radio frequency energy and, if not properly shielded, it may cause interference to other electronic equipment. However, there is no guarantee that interference will not occur in a particular installation. If the equipment does cause harmful interference to other electronic equipment, you may need to take one or more of the following measures: Retain the equipment in a closed container. Use the equipment in a closed container. Use the equipment in a closed container.

Shielded cables should be used throughout the installation. Shielded cables should be used throughout the installation. Shielded cables should be used throughout the installation.

Shielded cables should be used throughout the installation. Shielded cables should be used throughout the installation. Shielded cables should be used throughout the installation.

Shielded cables should be used throughout the installation. Shielded cables should be used throughout the installation. Shielded cables should be used throughout the installation.

Shielded cables should be used throughout the installation. Shielded cables should be used throughout the installation. Shielded cables should be used throughout the installation.

Shielded cables should be used throughout the installation. Shielded cables should be used throughout the installation. Shielded cables should be used throughout the installation.

Shielded cables should be used throughout the installation. Shielded cables should be used throughout the installation. Shielded cables should be used throughout the installation.

Shielded cables should be used throughout the installation. Shielded cables should be used throughout the installation. Shielded cables should be used throughout the installation.

Shielded cables should be used throughout the installation. Shielded cables should be used throughout the installation. Shielded cables should be used throughout the installation.

Shielded cables should be used throughout the installation. Shielded cables should be used throughout the installation. Shielded cables should be used throughout the installation.

Shielded cables should be used throughout the installation. Shielded cables should be used throughout the installation. Shielded cables should be used throughout the installation.

Shielded cables should be used throughout the installation. Shielded cables should be used throughout the installation. Shielded cables should be used throughout the installation.

Shielded cables should be used throughout the installation. Shielded cables should be used throughout the installation. Shielded cables should be used throughout the installation.

Shielded cables should be used throughout the installation. Shielded cables should be used throughout the installation. Shielded cables should be used throughout the installation.

Shielded cables should be used throughout the installation. Shielded cables should be used throughout the installation. Shielded cables should be used throughout the installation.

Shielded cables should be used throughout the installation. Shielded cables should be used throughout the installation. Shielded cables should be used throughout the installation.

Shielded cables should be used throughout the installation. Shielded cables should be used throughout the installation. Shielded cables should be used throughout the installation.

Shielded cables should be used throughout the installation. Shielded cables should be used throughout the installation. Shielded cables should be used throughout the installation.

Shielded cables should be used throughout the installation. Shielded cables should be used throughout the installation. Shielded cables should be used throughout the installation.

Shielded cables should be used throughout the installation. Shielded cables should be used throughout the installation. Shielded cables should be used throughout the installation.

Shielded cables should be used throughout the installation. Shielded cables should be used throughout the installation. Shielded cables should be used throughout the installation.

Shielded cables should be used throughout the installation. Shielded cables should be used throughout the installation. Shielded cables should be used throughout the installation.

Shielded cables should be used throughout the installation. Shielded cables should be used throughout the installation. Shielded cables should be used throughout the installation.

Shielded cables should be used throughout the installation. Shielded cables should be used throughout the installation. Shielded cables should be used throughout the installation.

Shielded cables should be used throughout the installation. Shielded cables should be used throughout the installation. Shielded cables should be used throughout the installation.

Shielded cables should be used throughout the installation. Shielded cables should be used throughout the installation. Shielded cables should be used throughout the installation.

Shielded cables should be used throughout the installation. Shielded cables should be used throughout the installation. Shielded cables should be used throughout the installation.

Shielded cables should be used throughout the installation. Shielded cables should be used throughout the installation. Shielded cables should be used throughout the installation.

Shielded cables should be used throughout the installation. Shielded cables should be used throughout the installation. Shielded cables should be used throughout the installation.

Shielded cables should be used throughout the installation. Shielded cables should be used throughout the installation. Shielded cables should be used throughout the installation.

Shielded cables should be used throughout the installation. Shielded cables should be used throughout the installation. Shielded cables should be used throughout the installation.

Shielded cables should be used throughout the installation. Shielded cables should be used throughout the installation. Shielded cables should be used throughout the installation.

Shielded cables should be used throughout the installation. Shielded cables should be used throughout the installation. Shielded cables should be used throughout the installation.

Shielded cables should be used throughout the installation. Shielded cables should be used throughout the installation. Shielded cables should be used throughout the installation.

Shielded cables should be used throughout the installation. Shielded cables should be used throughout the installation. Shielded cables should be used throughout the installation.

Shielded cables should be used throughout the installation. Shielded cables should be used throughout the installation. Shielded cables should be used throughout the installation.

Shielded cables should be used throughout the installation. Shielded cables should be used throughout the installation. Shielded cables should be used throughout the installation.

Shielded cables should be used throughout the installation. Shielded cables should be used throughout the installation. Shielded cables should be used throughout the installation.

Shielded cables should be used throughout the installation. Shielded cables should be used throughout the installation. Shielded cables should be used throughout the installation.

Shielded cables should be used throughout the installation. Shielded cables should be used throughout the installation. Shielded cables should be used throughout the installation.

Shielded cables should be used throughout the installation. Shielded cables should be used throughout the installation. Shielded cables should be used throughout the installation.

Shielded cables should be used throughout the installation. Shielded cables should be used throughout the installation. Shielded cables should be used throughout the installation.

Shielded cables should be used throughout the installation. Shielded cables should be used throughout the installation. Shielded cables should be used throughout the installation.

Shielded cables should be used throughout the installation. Shielded cables should be used throughout the installation. Shielded cables should be used throughout the installation.

Shielded cables should be used throughout the installation. Shielded cables should be used throughout the installation. Shielded cables should be used throughout the installation.

## Phomemo M832 Portable Thermal Printer User Guide

User guide for the Phomemo M832 portable thermal printer, covering package contents, printer components, precautions, app installation, printing instructions, paper types, warranty, and FCC/IC compliance.



## Quick Start Guide

Before using, please read this manual carefully and keep it properly for future reference.

### 01. Packing list

- |           |              |                       |             |
|-----------|--------------|-----------------------|-------------|
| Printer*1 | Power cord*1 | Printing paper*1 roll | Bluetooth*1 |
|-----------|--------------|-----------------------|-------------|

### 02. Machine description

- |                         |              |              |              |
|-------------------------|--------------|--------------|--------------|
| Power adjustment button | Power button | Power button | Power button |
|-------------------------|--------------|--------------|--------------|

### 03. Precautions

1. Please use the correct way for charging, and it is recommended to use mobile phone power adapter for charging.
2. Please use the correct way for charging, and it is recommended to use mobile phone power adapter for charging.

3. Please use the correct way for charging, and it is recommended to use mobile phone power adapter for charging.
4. Please use the correct way for charging, and it is recommended to use mobile phone power adapter for charging.

5. Please use the correct way for charging, and it is recommended to use mobile phone power adapter for charging.
6. Please use the correct way for charging, and it is recommended to use mobile phone power adapter for charging.

7. Please use the correct way for charging, and it is recommended to use mobile phone power adapter for charging.
8. Please use the correct way for charging, and it is recommended to use mobile phone power adapter for charging.

9. Please use the correct way for charging, and it is recommended to use mobile phone power adapter for charging.
10. Please use the correct way for charging, and it is recommended to use mobile phone power adapter for charging.

11. Please use the correct way for charging, and it is recommended to use mobile phone power adapter for charging.
12. Please use the correct way for charging, and it is recommended to use mobile phone power adapter for charging.

13. Please use the correct way for charging, and it is recommended to use mobile phone power adapter for charging.
14. Please use the correct way for charging, and it is recommended to use mobile phone power adapter for charging.

15. Please use the correct way for charging, and it is recommended to use mobile phone power adapter for charging.
16. Please use the correct way for charging, and it is recommended to use mobile phone power adapter for charging.

17. Please use the correct way for charging, and it is recommended to use mobile phone power adapter for charging.
18. Please use the correct way for charging, and it is recommended to use mobile phone power adapter for charging.

19. Please use the correct way for charging, and it is recommended to use mobile phone power adapter for charging.
20. Please use the correct way for charging, and it is recommended to use mobile phone power adapter for charging.

21. Please use the correct way for charging, and it is recommended to use mobile phone power adapter for charging.
22. Please use the correct way for charging, and it is recommended to use mobile phone power adapter for charging.

23. Please use the correct way for charging, and it is recommended to use mobile phone power adapter for charging.
24. Please use the correct way for charging, and it is recommended to use mobile phone power adapter for charging.



