

## 1Mii SafeFly Dual

# 1Mii SafeFly Dual Bluetooth Transmitter User Manual

Model: SafeFly Dual | Brand: 1Mii

## 1. INTRODUCTION

The 1Mii SafeFly Dual is a compact and versatile Bluetooth 5.3 audio transmitter designed to bring wireless audio capabilities to non-Bluetooth devices. It features an OLED display for easy monitoring of battery, volume, and connected devices, and supports dual headphone connections for shared listening experiences. Its long battery life and low-latency audio codecs make it ideal for travel, gym use, and home entertainment.

### Key Features:

- **OLED Display Screen:** Conveniently view battery capacity, volume level, connected devices, and audio format (SBC/AAC/aptX HD/LL/AD).
- **Wireless Music for Travel:** Compact and portable, perfect for airplanes, gyms, and TVs with 3.5mm audio jacks.
- **Superior High-Fidelity Sound Quality:** Supports aptX Low Latency for clear, distortion-free audio with minimal delay.
- **Bluetooth 5.3 Easy Setup:** Provides a stable wireless connection for non-Bluetooth devices like laptops, TVs, and gaming consoles.
- **Dual Connection:** Connects to two headphones or Bluetooth earphones simultaneously.
- **Long Playback Time:** Built-in 250mAh battery offers up to 25 hours of use on a single 1.5-hour charge.



Figure 1: 1Mii SafeFly Dual Bluetooth Transmitter and accessories.

## 2. SAFETY INFORMATION

- **Battery:** Do not dispose of in fire or water. Keep away from heat, sparks, and open flames.

- **Bluetooth:** May interfere with other wireless devices. Follow instructions for proper use and disposal.
- This device is a Bluetooth Transmitter ONLY. It does not function as a receiver.

### 3. PACKAGE CONTENTS

---

- 1Mii SafeFly Dual Bluetooth Transmitter
- USB-C Charging Cable
- 3.5mm Audio Adapter (for airplane seats with dual jacks)
- User Manual
- Keychain attachment

### 4. SETUP GUIDE

---

#### 4.1 Powering On/Off

To power on the 1Mii SafeFly Dual, slide the ON/OFF switch to the "ON" position. The device will automatically enter pairing mode for first-time use. To power off, slide the switch to the "OFF" position.

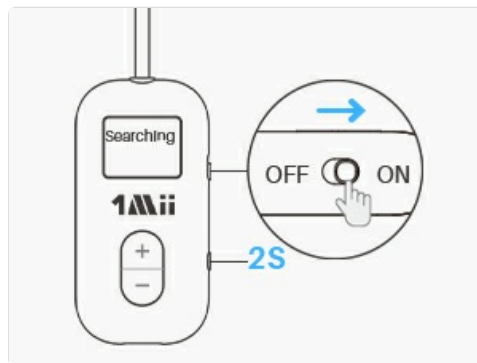

Figure 2: Sliding the ON/OFF switch to power on the device.

#### 4.2 Connecting to an Audio Source

Plug the 3.5mm audio jack of the 1Mii SafeFly Dual into the audio output port of your non-Bluetooth device. This can include laptops, computers, TVs, gym equipment, or in-flight entertainment systems. For dual-jack airplane seats, use the included 3.5mm audio adapter.

# Transmitter Mode



Figure 3: The 1Mii SafeFly Dual in Transmitter Mode, connecting to various devices.

# No More Cords

Enjoy Music Using AirPods or Bluetooth Wireless Headphones in Flight



Figure 4: Enjoying wireless audio on an airplane using the 1Mii SafeFly Dual.

## 4.3 Pairing with Wireless Headphones

Once the SafeFly Dual is powered on and connected to an audio source, it will enter searching mode. Put your wireless headphones (AirPods, earbuds, or over-ear headphones) into their pairing mode. The SafeFly Dual's OLED screen will display available devices. Use the '+' and '-' buttons to navigate and the 'M' button to confirm selection and pair.

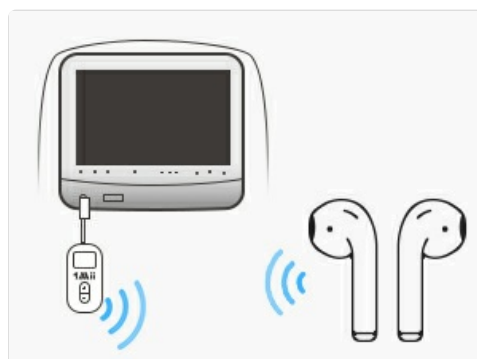

Figure 5: The 1Mii SafeFly Dual in searching mode, ready to pair.

Your browser does not support the video tag.

Video 1: Demonstrates the setup and pairing process of the 1Mii SafeFly Dual with headphones, including turning on, plugging into a device, and pairing. This video highlights the OLED display and dual connection feature.

## 5. OPERATING INSTRUCTIONS

### 5.1 OLED Display Overview

The OLED display provides real-time information about the device's status. You can see:

- Battery capacity
- Volume level
- Connected device names (A and B for dual connection)
- Audio codec in use (SBC/AAC/aptX HD/LL/AD)



Figure 6: The OLED display showing battery, codec, and connected devices.

## 5.2 Dual Connection

The 1Mii SafeFly Dual supports connecting to two Bluetooth headphones simultaneously. After pairing the first headphone, press the 'M' button for 2 seconds to re-enter pairing mode for the second device. Once both are connected, you can switch between them using the '+' and '-' buttons after a long press of the 'M' button.



Figure 7: Dual connection feature allowing two headphones to be paired simultaneously.

## 5.3 Switching Audio Codecs

To switch between supported audio codecs (aptX HD, aptX LL, SBC, AD), double-press the 'M' button. The current codec will be displayed on the OLED screen. Ensure your headphones also support the desired codec for optimal performance.

Your browser does not support the video tag.

Video 2: A comprehensive guide on using the 1Mii SafeFly Dual, including steps to switch audio codecs and pair with two headphones. This video demonstrates the device's versatility and ease of use.

## 5.4 Battery and Charging

The device has a built-in 250mAh battery, providing up to 25 hours of playback time. It takes approximately 1.5 hours to fully charge using the provided USB-C cable. You can continue using the device while it is charging.



Figure 8: The 1Mii SafeFly Dual offers extended battery life for long journeys.

## 6. MAINTENANCE

---

To ensure the longevity of your 1Mii SafeFly Dual:

- Keep the device clean by wiping it with a soft, dry cloth.
- Avoid exposing the device to extreme temperatures, moisture, or direct sunlight.
- Store in a cool, dry place when not in use.
- Use only the provided USB-C cable for charging.

## 7. TROUBLESHOOTING

---

- **Device automatically shuts down:** The transmitter will automatically shut down if it is not connected to a Bluetooth device or if there is no audio stream for 5 minutes to protect battery life. To use it again, turn it on again.
- **Cannot pair with headphones:**
  - Ensure the SafeFly Dual is in pairing mode (searching displayed on OLED).
  - Ensure your headphones are in pairing mode.
  - Move the devices closer to each other.
  - Clear previous pairing records on the SafeFly Dual by long-pressing the 'M' button for 8 seconds.
- **No audio or poor audio quality:**
  - Check if the 3.5mm audio jack is fully inserted into the source device.
  - Verify the volume level on both the SafeFly Dual and your headphones.
  - Ensure the correct audio codec is selected (double-press 'M' button).
  - Test with different headphones or audio sources to isolate the issue.
- **Lag or latency in audio:**
  - Ensure both the SafeFly Dual and your headphones support aptX Low Latency (aptX LL) and that it is the

active codec.

- Reduce the distance between the transmitter and headphones.
- Minimize interference from other wireless devices.



8. SPECIFICATIONS





Feature	Detail
Product Dimensions	2.2 x 1.1 x 0.47 inches
Item Weight	0.635 ounces
Item Model Number	SafeFly Dual
Batteries	1 Lithium Polymer batteries required (included)
Special Feature	Low Latency, Pairs up to two headphones, OLED Display
Brand	1Mii
Connectivity Technology	Bluetooth
Power Source	Battery Powered
Material	Plastic

9. WARRANTY AND SUPPORT

For warranty information and technical support, please refer to the official 1Mii website or contact their customer service directly. Keep your purchase receipt for warranty claims.  
You can visit the 1Mii Store on Amazon for more information:[1Mii Amazon Store](#)

Related Documents - SafeFly Dual

	<p><a href="#">1Mii SafeFly Min Quick Guide: Connecting Bluetooth Headphones</a></p> <p>A quick guide to using the 1Mii SafeFly Min Bluetooth transmitter to connect headphones to airplanes, TVs, PCs, and other devices. Includes instructions for pairing two headphones, resetting the device, and troubleshooting common issues.</p>
	<p><a href="#">1Mii ML300 Bluetooth Transmitter/Receiver User Guide</a></p> <p>This guide provides instructions on how to use the 1Mii ML300 Bluetooth transmitter and receiver, including pairing devices, changing audio codecs, and troubleshooting common issues.</p>

	<p><a href="#">1Mii B03 Bluetooth 5.3 Transmitter Receiver User Manual</a></p> <p>User manual for the 1Mii B03 Bluetooth 5.3 Transmitter Receiver, detailing its features, operation, and troubleshooting for home stereo audio transmission with aptX Low Latency and HD support.</p>
	<p><a href="#">1Mii B03 Bluetooth 5.0 Transmitter Receiver User Guide</a></p> <p>Comprehensive user guide for the 1Mii B03 Long Range Bluetooth 5.0 Transmitter and Receiver. Learn how to connect your TV or home stereo for wireless audio with aptX Low Latency support.</p>
	<p><a href="#">1Mii B06TX Bluetooth Transmitter Setup Guide</a></p> <p>A concise guide to setting up and pairing the 1Mii B06TX Bluetooth 5.0 transmitter for wireless audio connections to TVs, headphones, and speakers.</p>
	<p><a href="#">1Mii ML300 Bluetooth Transmitter and Receiver 2-in-1 User Manual</a></p> <p>Comprehensive user manual for the 1Mii ML300, a 2-in-1 Bluetooth transmitter and receiver. Includes setup instructions for TX and RX modes, pairing guides, and important warnings.</p>