

mophie PSPLUS-2024-5K

Mophie Powerstation Plus Mini 5,000mAh Power Bank User Manual

Model: PSPLUS-2024-5K | Brand: mophie

1. INTRODUCTION AND OVERVIEW

The Mophie Powerstation Plus Mini is a compact and portable power bank designed to provide on-the-go charging for your mobile devices. Featuring an integrated USB-C cable and a 5,000mAh battery capacity, it offers convenient and fast charging solutions for smartphones, tablets, and other USB-C compatible devices.

This manual provides essential information on how to set up, operate, maintain, and troubleshoot your Powerstation Plus Mini to ensure optimal performance and longevity.

2. PRODUCT FEATURES

- **Fast Charging Speed:** The 20W USB-C port delivers up to a 50% charge in approximately 30 minutes, ideal for quick power boosts.
- **High Capacity:** The 5,000mAh battery provides up to one full phone charge, keeping you connected during long days or travel.
- **Multiple Device Charging:** Charge up to two devices simultaneously using the integrated USB-C cable and the additional USB-C port.
- **Pass-Through Charging:** Power is intelligently channeled to your connected device first, then to the Powerstation battery, prioritizing your device's charge.
- **Durable & Stylish Design:** Constructed with an aluminum frame and soft-touch silicone exterior, featuring durable braided cables tested to withstand up to 30,000 bends.



Figure 1: The Mophie Powerstation Plus Mini, showcasing its compact design and integrated USB-C cable.

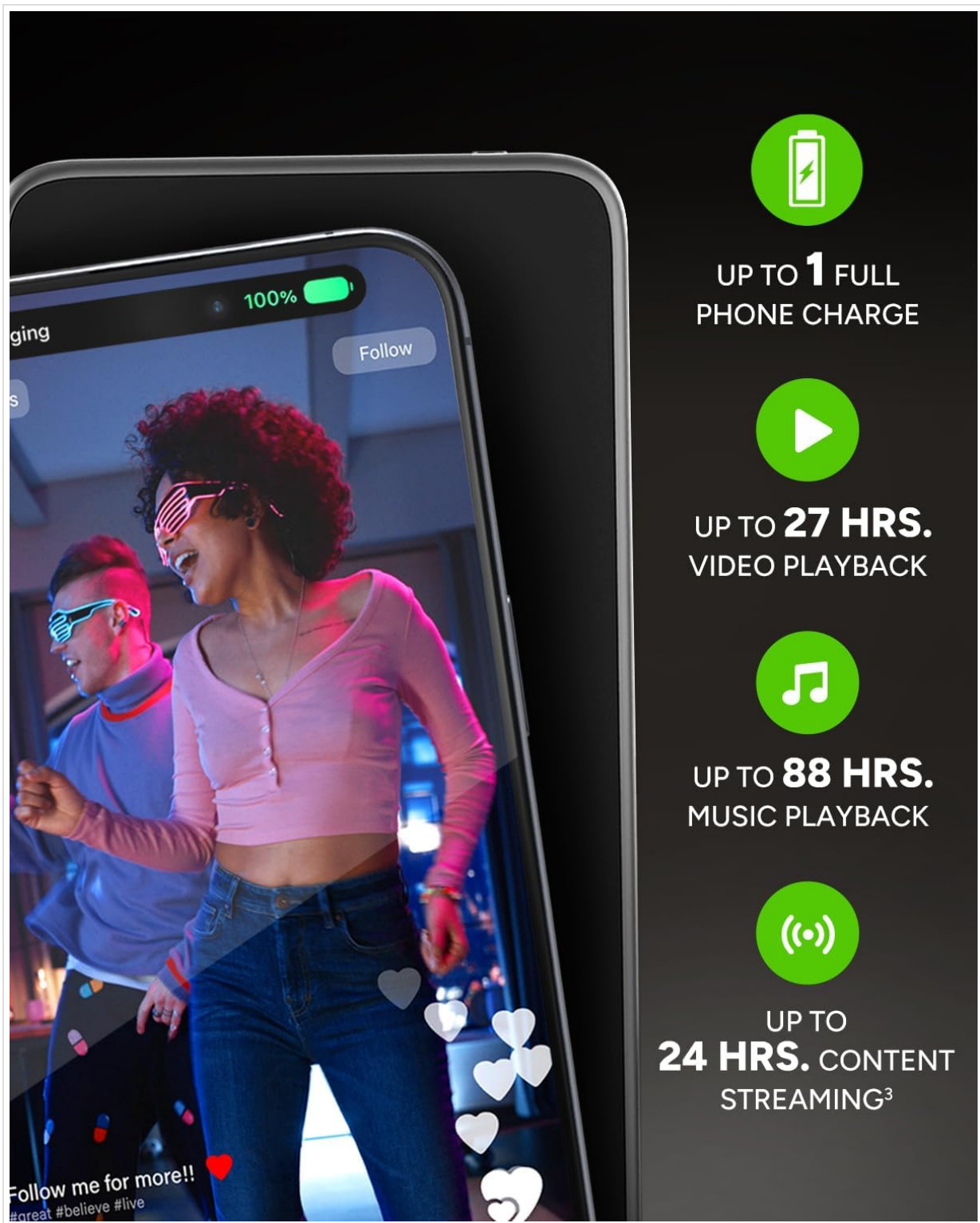

Figure 2: An infographic illustrating the extended usage times provided by the power bank, including up to one full phone charge, 27 hours of video playback, 88 hours of music playback, and 24 hours of content streaming.

Charge Up to Two Devices at Once



Figure 3: The power bank simultaneously charging a smartphone via its integrated USB-C cable and a tablet via its USB-C port, demonstrating its dual-charging capability.

3. SETUP

3.1 Initial Charging of the Power Bank

Before first use, it is recommended to fully charge your Mophie Powerstation Plus Mini. The device comes with a USB-C PD input/output port for recharging.

1. Connect the integrated USB-C cable to a compatible USB-C wall adapter (not included).
2. Alternatively, use a USB-A to USB-C cable (not included) to connect the power bank's USB-C port to a USB-A wall adapter.
3. The LED power indicator lights on the side of the power bank will illuminate to show the charging progress. All four

lights will be solid when fully charged.

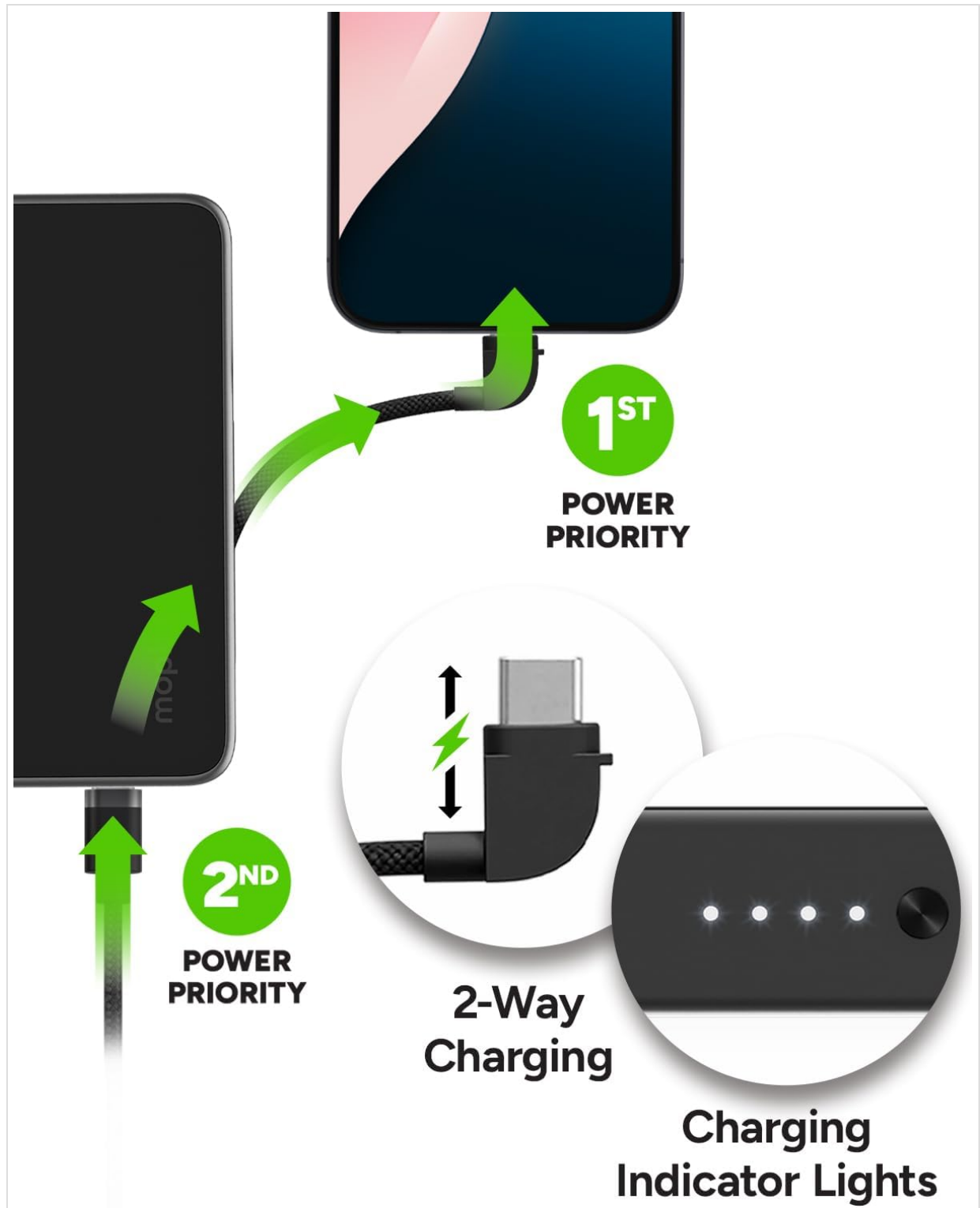

Figure 4: Illustration of the LED power indicator lights, showing the current charge level of the power bank. Four solid lights indicate a full charge.

4. OPERATING INSTRUCTIONS

4.1 Charging Your Devices

The Powerstation Plus Mini can charge a variety of USB-C compatible devices, including smartphones, tablets, and other small electronics.

1. To charge a single device: Pull out the integrated USB-C cable and connect it directly to your device's USB-C port.
2. To charge two devices simultaneously: Use the integrated USB-C cable for one device and connect a second device to the power bank's additional USB-C port using your own cable.

3. The power bank features pass-through charging, meaning it will prioritize charging your connected device first before recharging its internal battery.

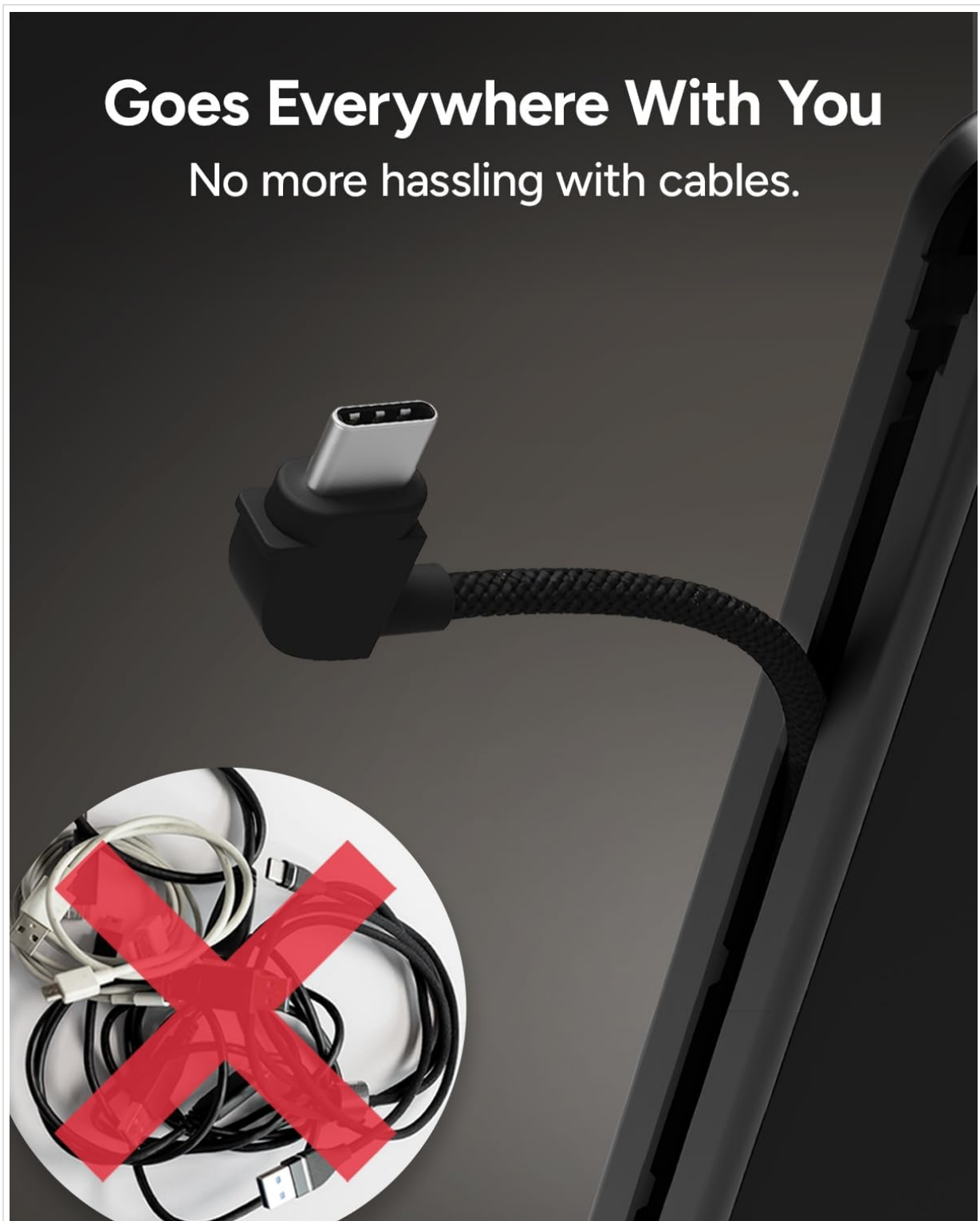

Figure 5: The integrated USB-C cable neatly tucks away when not in use, eliminating the need to carry extra cables.

5. MAINTENANCE

Proper care and maintenance will extend the life of your Powerstation Plus Mini.

- Keep the power bank dry and away from moisture.
- Avoid exposing the device to extreme temperatures (hot or cold).
- Clean the device with a soft, dry cloth. Do not use harsh chemicals or abrasive materials.
- Do not attempt to disassemble, open, crush, or puncture the power bank.
- Dispose of batteries in accordance with local battery recycling laws and regulations. Never dispose of batteries in the

garbage.

6. TROUBLESHOOTING

If you experience issues with your Powerstation Plus Mini, try the following steps:

- **Device not charging:**
 - Ensure the power bank itself is charged (check LED indicators).
 - Verify that the integrated cable or your external USB-C cable is securely connected to both the power bank and your device.
 - Try using a different wall adapter or cable to charge the power bank.
 - Ensure your device is compatible with USB-C charging.
- **Slow charging:**
 - Confirm that your wall adapter supports 20W Power Delivery (PD) for optimal charging speed.
 - Ensure the cable used is rated for fast charging.
 - Charging multiple devices simultaneously may reduce the charging speed for each device.
- **Overheating:**
 - It is normal for the power bank to become slightly warm during charging. If it becomes excessively hot, disconnect it immediately and contact customer support.
 - Ensure the device is used in a well-ventilated area and not covered by bedding or other materials.

7. SPECIFICATIONS

Feature	Detail
Product Dimensions	4.57 x 2.91 x 0.55 inches
Item Weight	8.4 ounces
Item Model Number	PSPLUS-2024-5K
Battery Type	1 Lithium Polymer battery (included)
Battery Capacity	5000 mAh
Connector Type	USB Type C
Voltage	5 Volts
Special Feature	Built-In Cable

8. WARRANTY AND SUPPORT

Mophie products are designed for durability and reliability. For specific warranty information, please refer to the warranty card included with your product packaging or visit the official mophie website.

For customer service, technical support, or warranty claims, please contact mophie directly:

- **Customer Service:** 1-888-8mophie (1-888-866-7443)
- **Website:** www.mophie.com

Please retain your purchase receipt as proof of purchase for warranty purposes.

mophie.

powerstation[®] plus mini

USER MANUAL

[mophie powerstation plus mini User Manual and Safety Guide](#)

Comprehensive user manual and safety guide for the mophie powerstation plus mini portable charger. Learn how to charge, use, and maintain your device safely, including important safety warnings and compliance information.

lang:en score:44 filesize: 1.68 M page_count: 31 document date: 2024-05-17