

Yottamaster YM28P

Yottamaster USB C Hub with M.2 NVMe SSD Enclosure (YM28P) - Instruction Manual

Model: YM28P

1. INTRODUCTION

The Yottamaster USB C Hub with M.2 NVMe SSD Enclosure (Model: YM28P) is a versatile 8-port adapter designed to expand connectivity and storage capabilities for your devices. It integrates multiple essential functions into a single, compact unit, reducing desktop clutter and enhancing productivity.

Key Features:

- **8-Port USB C Hub & M.2 SSD Enclosure:** Combines interface expansion with integrated M.2 NVMe/SATA SSD storage.
- **High-Speed Data Transfer:** Features 10Gbps Type-C and USB-A ports for rapid data transfer, exceeding 1000 MB/s.
- **100W Power Delivery (PD):** Equipped with an independent PD100W fast charging port to quickly power your laptop.
- **4K@60Hz HDMI Output:** Supports high-resolution video output with dynamic HDR for clear and detailed visuals.
- **M.2 NVMe and SATA Compatibility:** Supports 2230/2242/2260/2280 NVMe/SATA SSDs for flexible storage expansion up to 8TB.
- **Efficient Heat Dissipation:** Constructed from aluminum alloy and ABS material for effective thermal management.

2. PACKAGE CONTENTS

Please verify that all items listed below are included in your package:

- USB C Hub with M.2 NVMe SSD Enclosure
- Packaging Box

- Screwdriver
- Heatsink with Copper Heatpipe
- Thermal Silicone
- User Manual
- Plastic Plug



Image: The Yottamaster YM28P USB C Hub and its included accessories, such as a screwdriver, heatsink, thermal silicone, user manual, and plastic plug.

3. SPECIFICATIONS

Feature	Detail
Package Dimensions	7.56 x 4.41 x 1.3 inches
Item Weight	6.3 ounces
Item Model Number	YM28P
Brand	Yottamaster
Color	Black
Hardware Interface	USB Type C
Special Features	Fast Data Transfer, Lightweight, Pass Through Charge, Plug and Play, Portable
Compatible Devices	Laptops, MacBook Air, MacBook Pro, Personal Computer, iMac, iPad

4. SETUP

4.1 M.2 SSD Installation

The YM28P hub features an integrated M.2 SSD enclosure compatible with both NVMe and SATA SSDs (2230/2242/2260/2280 sizes). Follow these steps to install your SSD:

1. **Remove the SSD Cover:** Gently slide or pry open the SSD cover on the hub.
2. **Insert M.2 SSD:** Carefully insert your M.2 SSD into the slot at a 20-30 degree angle.
3. **Secure the SSD:** Push down gently on the SSD and use the included securing pin or screw to lock it firmly into place. Ensure the clip is pointing away from the hub before inserting the SSD.
4. **Apply Thermal Pad:** Remove the plastic film from the thermal pad and attach it to the top of the installed SSD.
5. **Replace the Cover:** Secure the SSD cover back onto the hub.

Video: A step-by-step guide on how to install an M.2 SSD into an enclosure, demonstrating the process of opening the cover, inserting the SSD, securing it, and replacing the cover. This video is provided by Vante Tech.



Image: The M.2 slot within the hub, illustrating compatibility with various SSD sizes (2230, 2242, 2260, 2280) and key types (M Key, B&M Key).

4.2 Connecting the Hub to Your Device

Connect the integrated USB-C cable from the YM28P hub to a compatible USB-C port on your laptop, MacBook, or other host device.

Video: A demonstration of connecting the Yottamaster USB C Hub to a laptop, showcasing its various ports and the integrated M.2 SSD enclosure. This video is provided by Yottamaster Mingdao Direct.

8-IN-1 USB Hub Enclosure



Image: The Yottamaster YM28P USB C Hub connected to a laptop, with various peripherals plugged into its ports, including an M.2 SSD, USB-A devices, SD/TF cards, and an HDMI cable.

5. OPERATING INSTRUCTIONS

5.1 USB Data Ports

The hub features multiple USB ports for connecting peripherals and transferring data:

- **10Gbps Type-C Port:** For high-speed data transfer with compatible USB-C devices.
- **2 x USB 3.2 Gen2 Type-A Ports:** Offers 10Gbps data transfer speeds for USB-A devices.
- **SD/TF 2.0 Card Reader:** Supports SD and TF cards for data access (USB 2.0 speed).

Excellent Heat Conductivity:

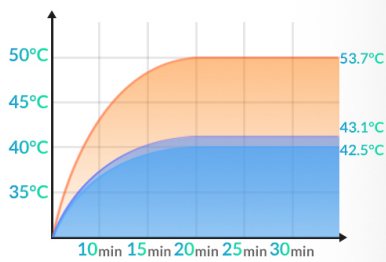

The temperature varies depending on the specific usage scenario.

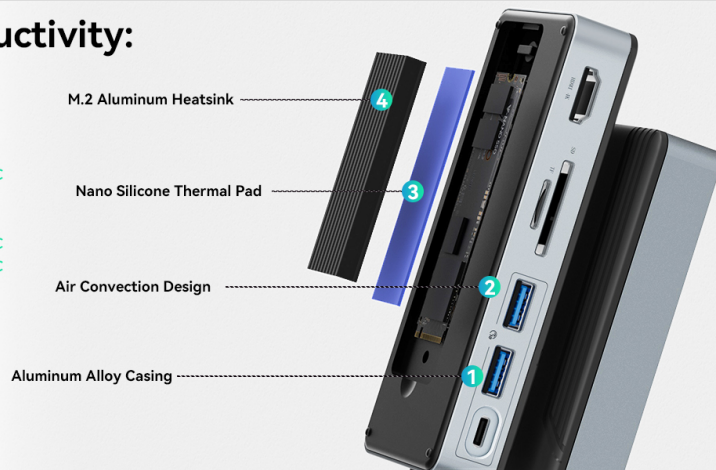

Image: A visual representation of the Yottamaster YM28P hub demonstrating 10Gbps data transfer speeds, showing a laptop connected to the hub with an external SSD and a speed test result of over 1000 MB/s.

5.2 HDMI Video Output

Connect an HDMI cable from the hub to an external monitor or TV for high-definition video output.

- Supports 4K@60Hz HD resolution.
- Features dynamic HDR for enhanced image quality.
- Backward compatible with 4K@30Hz and 2K@144Hz.



Image: A person enjoying a high-quality video on a large screen connected via the Yottamaster YM28P hub, showcasing the 4K@60Hz HDMI output capability.

5.3 Power Delivery (PD) Charging

Utilize the dedicated PD100W Type-C port to charge your laptop or other compatible devices.

- Provides up to 100W power delivery.
- Can fully charge a laptop in approximately 1.5 hours.



Image: The Yottamaster YM28P hub connected to a power adapter and charging a laptop, tablet, and smartphone simultaneously, highlighting its PD100W fast charging capability.

6. COMPATIBILITY

The YM28P hub is broadly compatible with various operating systems and devices:

- **Operating Systems:** Windows, Mac OS, Linux.
- **Devices:** Laptops, MacBook Air, MacBook Pro, Personal Computers, iMac, iPad, Xbox, Nintendo Switch, PS5, Phones.



Image: A visual representation of the Yottamaster YM28P hub's broad compatibility with various operating systems (Mac OS, Windows, Linux) and devices (laptops, TVs, Xbox, Switch, PC, PS5, phones).

7. HEAT DISSIPATION

The YM28P is engineered for optimal thermal performance to ensure stable operation during heavy use:

- **Material:** Made of aluminum alloy and ABS material, known for efficient heat conduction.
- **Design:** Features an M.2 aluminum heatsink, nano silicone thermal pad, and air convection design to dissipate heat effectively.



Image: An exploded view of the Yottamaster YM28P hub highlighting its heat dissipation components: aluminum alloy casing, M.2 aluminum heatsink, nano silicone thermal pad, and air convection design.

8. TROUBLESHOOTING

- **Insufficient Power for Peripherals:** If connecting multiple power-hungry peripherals (hard drives, monitors) or using on a desktop computer, it is recommended to use a power supply of 60W or more to power the docking station through the PD input port.

- **SSD Ejection Issues (Mac Users):** Some users have reported internal SSD ejection when inserting other drives. Ensure adequate power supply is connected to the hub. If issues persist, consult Yottamaster support.
- **Bus Power Instability:** If devices disconnect when unplugging other peripherals, the bus power may be finicky. Ensure a stable power supply is connected to the PD port.
- **SSD with Heatsink Not Fitting:** The enclosure depth may be shallow. If your SSD has a heatsink, it might protrude, preventing the cover from closing. This may require leaving the cover off or using an SSD without a heatsink.