

## Manuals+

[Q & A](#) | [Deep Search](#) | [Upload](#)

[manuals.plus](#) /

› [ANPABO](#) /

› [ANPABO 24V Riding Toy Instruction Manual](#)

## ANPABO 24V Riding Toy

# ANPABO 24V Riding Toy Instruction Manual

Model: 24V Riding Toy

## 1. INTRODUCTION

---

Thank you for choosing the ANPABO 24V Riding Toy. This manual provides essential information for the safe assembly, operation, and maintenance of your new riding toy. Please read it thoroughly before use and retain it for future reference.

## 2. SAFETY INFORMATION

---

**WARNING:** Adult assembly is required. Please keep children away from all small parts during assembly. Always supervise children when they are operating the riding toy. Ensure the child wears appropriate safety gear, including a helmet, at all times. Do not use near stairs, on public roads, or on uneven terrain.

- Maximum weight capacity: 110 lbs.
- Recommended age: 3-12 years.
- Always use on smooth, hard surfaces. Avoid thick carpets, grass, or wet areas.
- Ensure the hand brake is functional before each use.
- Do not modify the product in any way.

## 3. PRODUCT OVERVIEW

---

The ANPABO 24V Riding Toy is designed for an engaging and safe riding experience for children. It features a powerful yet quiet brushless motor, anti-tip wheels for stability, and a hand brake for controlled stops.



Figure 3.1: Overall view of the ANPABO 24V Riding Toy.

### Key Features:

- **180W Brushless Motor:** Provides quiet operation and efficient power.
- **Anti-Tip Wheels:** Two specially designed anti-rollover wheels on both sides enhance stability.
- **Hand Brake:** Allows for safe and controlled stopping.
- **Durable Construction:** Made from high-quality, non-toxic PP material.
- **Multifunctionality:** Includes a music player, shining rainbow lights, and a storage compartment under the seat.
- **DIY Stickers:** Comes with cartoon and luminous stickers for personalization.

# RUBBER TIRE + 4 PU TIRES



✓ More Wear-Resistant

✓ Lower Noise

Figure 3.2: Illustration comparing the 180W quiet brushless motor to traditional motors, highlighting lower noise and higher power output.



Figure 3.3: Overview of additional features including under-seat storage, EVA cushion, DIY stickers, and LED flashing lights.

## 4. ASSEMBLY INSTRUCTIONS

---

The ANPABO 24V Riding Toy features a modular design for quick and easy assembly, typically completed in under 10 minutes with few parts.

1. Unpack all components and verify against the parts list (not provided in this document, refer to packaging).
2. Connect the handlebar assembly to the main body. Ensure all connections are secure.
3. Attach any auxiliary wheels or support components as indicated in the product-specific assembly guide.
4. Ensure all electrical connectors are properly seated.
5. Confirm all screws and fasteners are tightened before first use.



Figure 4.1: Visual guide for the modular assembly process.

## 5. OPERATING INSTRUCTIONS

---

### Starting the Toy:

1. Ensure the toy is fully charged.
2. Sit comfortably on the seat.
3. Press the power button to turn on the toy.
4. Gently press the stepless speed throttle on the handlebar to begin moving.

### Stopping the Toy:

- Release the throttle.
- Engage the hand brake lever on the handlebar for a controlled stop.

# STABLE & ANTI-ROLLOVER

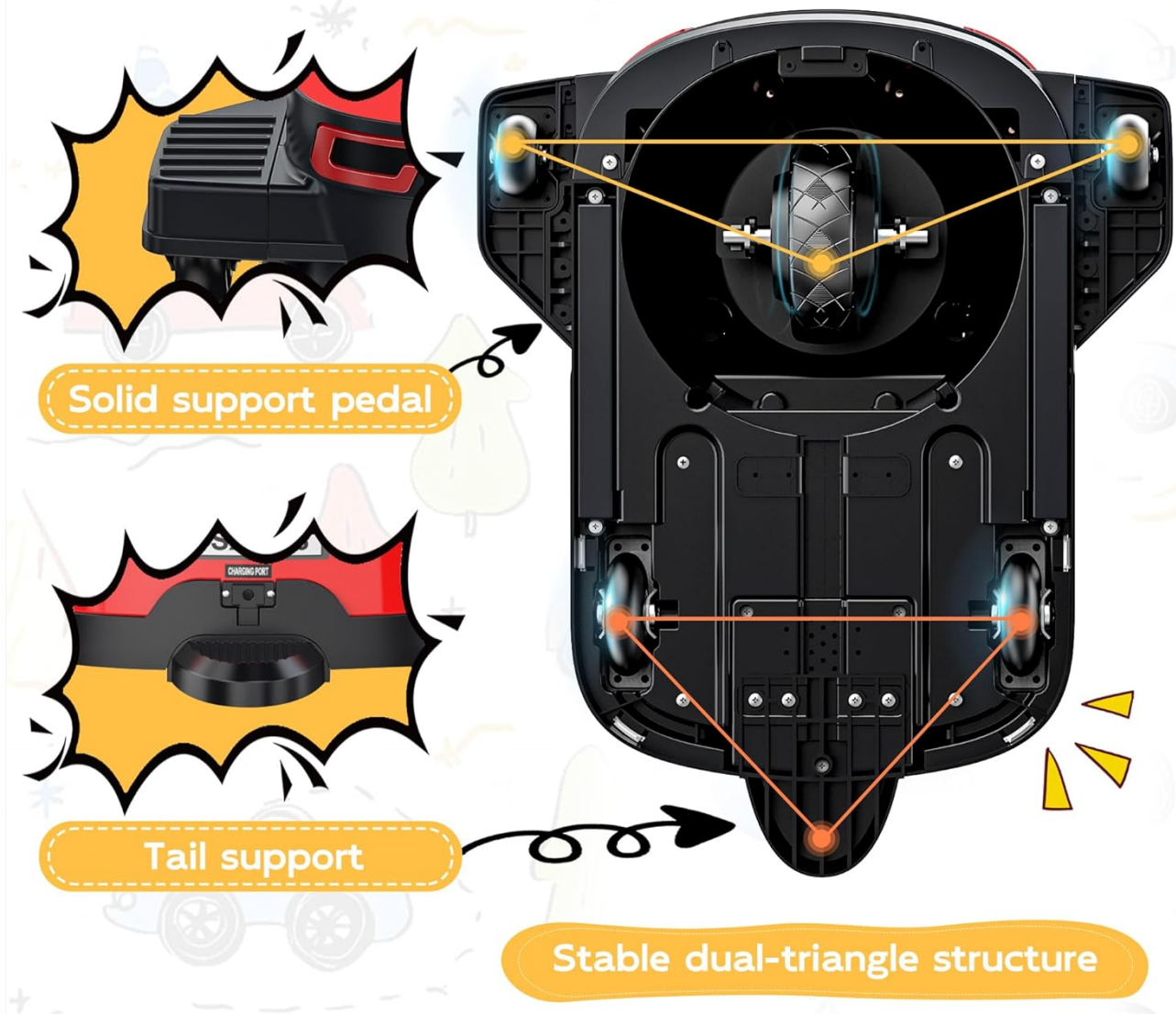

Figure 5.1: Detail of the handlebars, illustrating the stepless speed throttle and hand brake for easy operation.

## Speed Control:

The riding toy features a speed limit switch located under the seat. This allows parents to adjust the maximum speed for younger children.

- **'O' Position:** Disables high-speed driving, limiting the toy to low speed (0-2.5 mph).
- **'I' Position:** Cancels the speed limit, allowing the toy to reach its maximum speed (2.5-5 mph).

# SPEED CONTROL FOR SAFETY



**Low:**  
0-2.5 mph

**High:**  
2.5-5 mph

In the "O" position,  
the car only runs at low  
speed.

Speed limit switch

Figure 5.2: Location of the speed limit switch under the seat for adjusting speed settings.

## 6. CHARGING

To charge the ANPABO 24V Riding Toy, locate the charging port (refer to the product-specific diagram in your packaging). Connect the provided 24V charger to the port and plug it into a standard electrical outlet. The battery typically provides 90-150 minutes of runtime on a full charge. Ensure the toy is turned off during charging.

## 7. MAINTENANCE

### Cleaning:

- Wipe the toy with a damp cloth. Avoid using harsh chemicals or abrasive cleaners.
- Do not immerse the toy in water.

### Storage:

- Store the toy in a dry, cool place away from direct sunlight.
- If storing for an extended period, charge the battery fully before storage and recharge every 3 months to maintain

battery health.

## 8. TROUBLESHOOTING

---

Problem	Possible Cause	Solution
Toy does not turn on	Battery is low or discharged; Power connection loose	Charge the battery; Check all power connections
Toy moves slowly	Battery is low; Speed limit switch is on low speed; Overload	Charge the battery; Check speed limit switch position; Ensure weight is within limits
Unusual noise during operation	Loose component; Obstruction in wheels	Inspect for loose parts and tighten; Check wheels for debris

## 9. SPECIFICATIONS

---

- **Product Dimensions:** 17.5 x 16.5 x 26 inches
- **Item Weight:** 26 pounds
- **Motor:** 180W Brushless
- **Battery:** 24V
- **Max Speed:** 5 mph
- **Runtime:** 90-150 minutes (depending on usage)
- **Load Capacity:** 110 lbs
- **Manufacturer Recommended Age:** 8 - 12 years (Note: Product features suggest suitability for 3-12 years with speed control)

## 10. WARRANTY AND SUPPORT

---

For warranty information or technical support, please refer to the contact details provided with your purchase or visit the official ANPABO website. Please have your product model and purchase date available when contacting support.