

HOROW HR-E19S

HOROW 19 Inch Tall Two-Piece Elongated Toilet (Model HR-E19S) User Manual

Model: HR-E19S

1. PRODUCT OVERVIEW

The HOROW HR-E19S is a 19-inch tall, two-piece elongated toilet designed for enhanced comfort and accessibility. It features a 1.28 GPF (Gallons Per Flush) single flush system with a MAP 1000g flushing performance, ensuring efficient waste removal. The elevated seat height reduces strain on knees and joints, making it suitable for seniors, pregnant individuals, people with disabilities, and taller users.



Image 1.1: Front view of the HOROW HR-E19S toilet highlighting its single flush, MAP 1000g score, 360° Jet Siphon Flushing, quiet-close seat, upgraded toilet seat, and 12-inch rough-in.



19" Extra High Toilets with Comfort Chair Height Seat

The heightened and elongated design reduces pressure on knees and joints, making it more comfortable for seniors, pregnant women, the disabled, and taller users.

Image 1.2: Side view illustrating the ergonomic benefits of the 19-inch extra high toilet seat, reducing pressure on knees and joints for comfortable sitting and standing.

2. SETUP AND INSTALLATION

This toilet is designed for floor mounting and features a standard 12-inch rough-in, ensuring compatibility with most bathroom layouts. It accommodates both 7/8" and 1/2" water lines. If your supply line is 7/8", remove the adapter before connecting. If it is 1/2", direct connection is possible.

2.1 Included Components

- Toilet Bowl
- Tank
- Seat
- Caps
- T-Bolts
- Wax Ring



HOROW®

WHAT'S IN THE BOX



Bowl



Tank



Seat

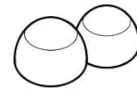

Caps



T-Bolts

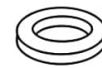

Wax Ring

Image 2.1: A visual representation of all components included in the toilet package, such as the bowl, tank, seat, caps, T-bolts, and wax ring.

2.2 Rough-in Compatibility

The 12-inch rough-in measurement is critical for proper installation. This refers to the distance from the wall behind the toilet to the center of the drainpipe (or the bolts that secure the toilet to the floor).



3. OPERATING INSTRUCTIONS

3.1 Flushing System

The toilet features a powerful 360° Jet Siphon flush system. To activate the flush, press the side-mounted lever. This system is designed for rapid and thorough waste removal, preventing clogs and odors. The 1.28 GPF flush volume contributes to water conservation.



Image 3.1: A cutaway view of the toilet demonstrating the 360° Jet Siphon Powerful Flushing System, highlighting its efficiency and features like low noise and anti-odor properties.

3.2 Soft-Closing Seat

The toilet is equipped with a soft-closing PP (Polypropylene) seat. This feature allows the seat and lid to close slowly and quietly, reducing noise and preventing accidental slamming. The seat is secured with screws to ensure it remains stable and does not loosen over time.

19 Inch Elongated High Toilet

HOROW®



MAP SCORE
1000 Grams



ADA Compliant
19" Seat Height



WaterSense



cUPC

Image 3.2: Illustration of the soft-closing seat mechanism, which ensures quiet and gradual closure, minimizing noise.

4. MAINTENANCE

The HOROW HR-E19S toilet is designed for easy cleaning due to its high-quality ceramic and non-porous surface. The fully skirted drain design and siphon jet further reduce areas where stains can accumulate.

4.1 Cleaning Instructions

- Regularly wipe the exterior and interior surfaces with a soft cloth and mild, non-abrasive cleaner or just water.
- Avoid using harsh chemicals, abrasive pads, or strong acids, as these can damage the ceramic glaze and seat material.
- For stubborn stains in the bowl, use a toilet brush with a gentle toilet bowl cleaner.
- Ensure the area around the base and the skirted trapway is kept clean to maintain hygiene.

5. TROUBLESHOOTING

While the HOROW HR-E19S toilet is engineered for reliable performance, occasional issues may arise. This section provides general guidance for common concerns.

5.1 Common Issues and Solutions

- **Weak Flush:** Ensure the water supply valve behind the toilet is fully open. Check the water level in the tank; it should be at the marked waterline. Inspect the flush valve for any obstructions.
- **Continuous Running Water:** This often indicates an issue with the flapper or fill valve. Check if the flapper is sealing correctly at the bottom of the tank. Adjust or replace the fill valve if water continues to run into the overflow tube.
- **Leaking:** Inspect all connections, including the water supply line, tank-to-bowl connection, and the wax ring at the base. Tighten connections if loose. If the leak is from the base, the wax ring may need replacement.
- **Clogging:** The 360° Jet Siphon system is designed to prevent clogs. If a clog occurs, use a toilet plunger. Avoid flushing non-biodegradable items.

If these steps do not resolve the issue, please contact customer support.

6. SPECIFICATIONS

Model Number	HR-E19S
Color	White
Product Dimensions (D x W x H)	29.13" x 15.75" x 34.65"
Material	Ceramic (Bowl), PP (Seat)
Item Weight	56 Pounds
Installation Method	Floor Mounted
Bowl Shape	Elongated (Oblong)
Seat Height (from floor)	19 inches
Rough-in	12 inches
Flush Type	Single Flush
Flush Volume	1.28 GPF
Flushing Performance	MAP 1000g
Water Line Compatibility	7/8" or 1/2"

HOROW®

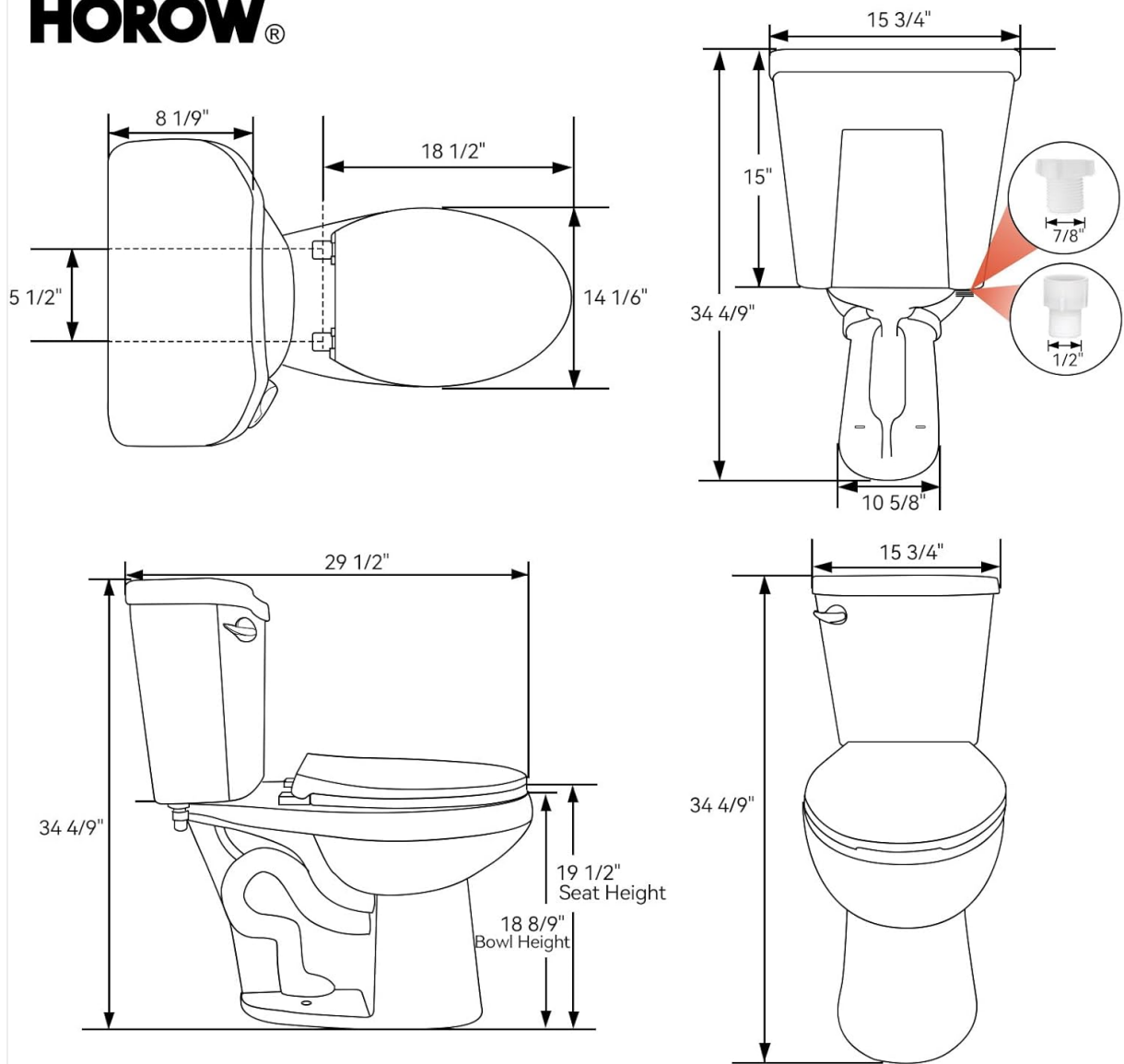

Image 6.1: Technical drawing providing detailed dimensions of the toilet, including height, width, depth, and rough-in measurements.

7. WARRANTY AND SUPPORT

7.1 Warranty Information

HOROW provides a **1-year limited warranty** for this product, covering manufacturing defects and material flaws under normal use and service. This warranty is valid from the date of purchase.

7.2 Customer Support

For any questions, concerns, or assistance with your HOROW HR-E19S toilet, please contact HOROW customer service. We offer lifetime after-sales service, and our customer service center aims to respond to all inquiries within 12 hours.

Please refer to your purchase documentation for specific contact details or visit the official HOROW website for support resources.