

Logitech 910-007408

Logitech POP Mouse User Manual

Model: 910-007408

Brand: Logitech

INTRODUCTION

The Logitech POP Mouse is a compact and portable wireless Bluetooth mouse designed for modern workspaces. It features programmable buttons, quiet clicks, and the ability to easily switch between up to three devices. This manual provides instructions for setting up, operating, maintaining, and troubleshooting your POP Mouse.



Image: The Logitech POP Mouse in Off-White, showcasing its compact and contoured design.

WHAT'S IN THE BOX

- Logitech POP Mouse
- 1 x AA battery (pre-installed)
- User documentation

- Sticker

In the box



**Responsible
Packaging**

Image: The contents of the Logitech POP Mouse packaging, including the mouse and a single AA battery.

SETUP

1. Powering On

The POP Mouse comes with a pre-installed AA battery. To power on the mouse, locate the power switch on the bottom of the mouse and slide it to the ON position.

2. Bluetooth Pairing

1. Ensure the mouse is powered on.
2. Press and hold the Easy-Switch button on the bottom of the mouse for 3 seconds until the LED light starts blinking rapidly. This indicates the mouse is in pairing mode.
3. On your device (laptop, tablet, PC), navigate to the Bluetooth settings.
4. Select "Logitech POP Mouse" from the list of available devices to complete the pairing process.
5. The LED light on the mouse will turn solid for 5 seconds to confirm successful pairing.

The POP Mouse can connect to up to 3 devices simultaneously. Use the Easy-Switch button to toggle between paired devices.

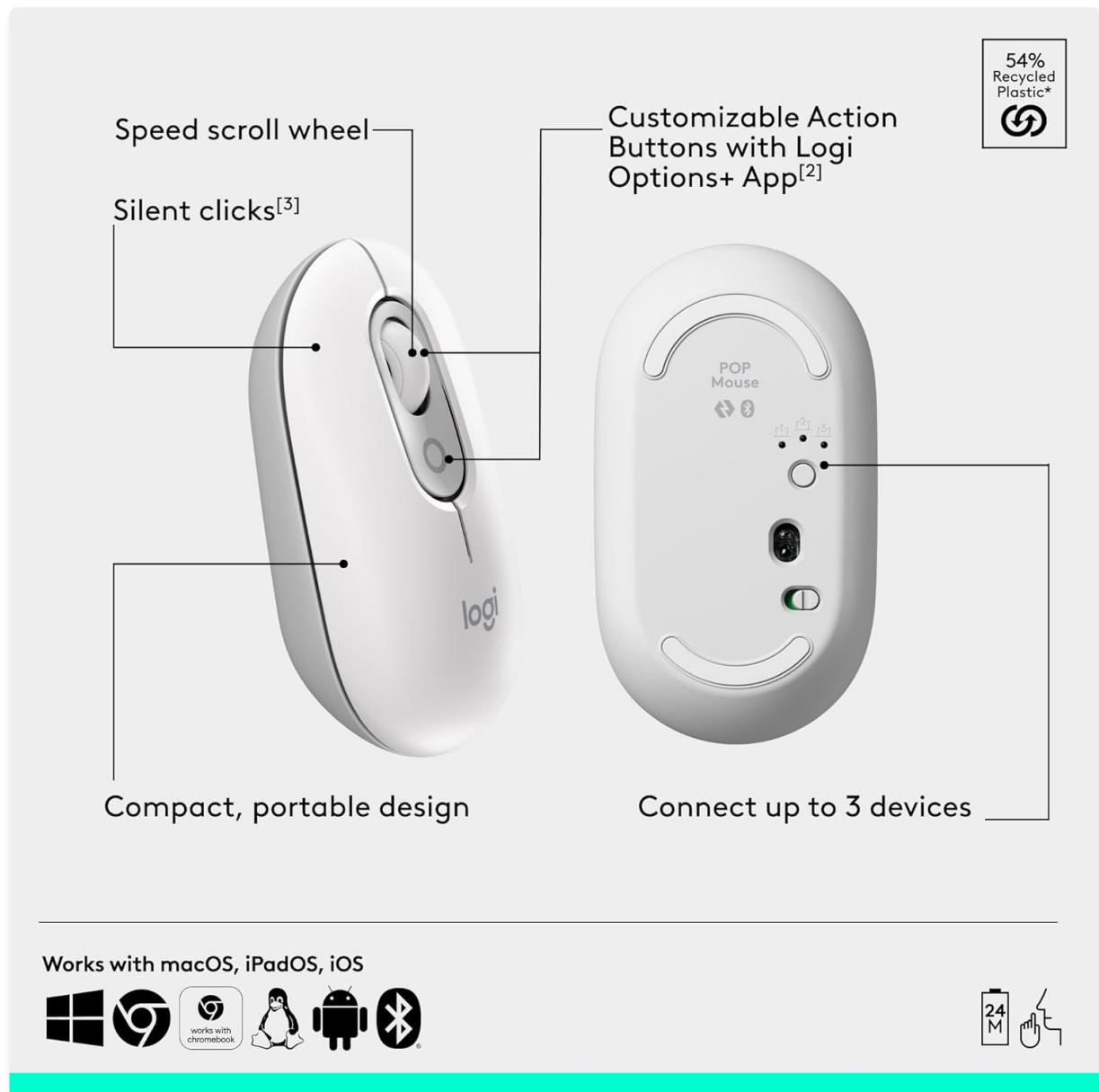

Image: A diagram illustrating the key features of the Logitech POP Mouse, including the speed scroll wheel, customizable action button, silent clicks, compact design, and multi-device connectivity.

OPERATING THE POP MOUSE

Smartwheel Speed Scroll

The Smartwheel allows you to switch between high-precision tracking and speed scrolling with a single flick. This feature enables quick navigation through documents and web pages.

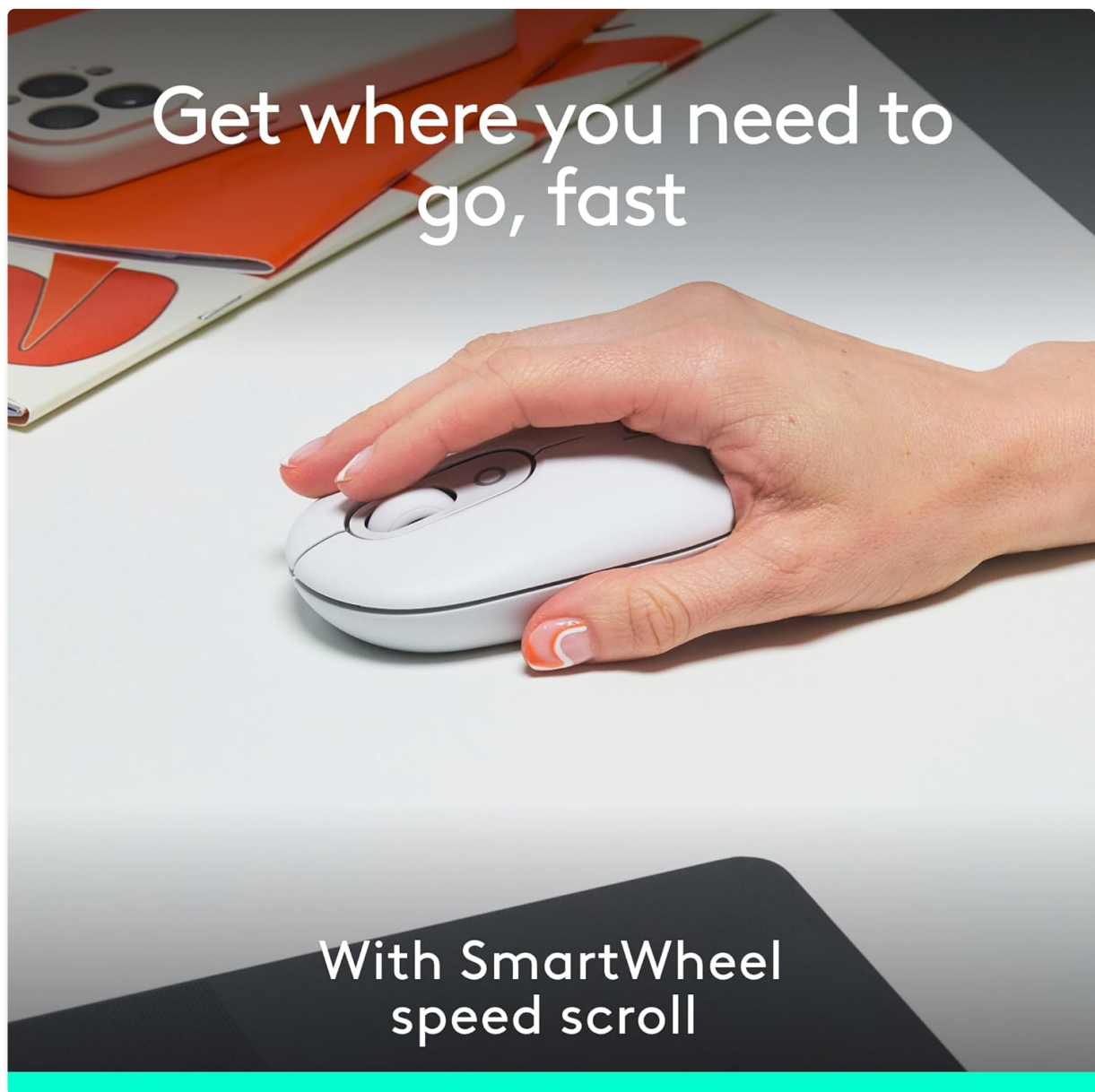

Image: A hand demonstrating the use of the Logitech POP Mouse, highlighting its Smartwheel for fast scrolling.

Customizable Action Buttons with Logi Options+ App

Enhance your productivity by customizing the action buttons on your POP Mouse using the Logi Options+ App. This application allows you to assign shortcuts for various functions, such as switching between work and entertainment modes (e.g., Spotify, Netflix) or accessing AI tools. The Logi Options+ App is available for recent versions of Windows and macOS.

Life is easier with shortcuts

Action Buttons save you time with Logi Options+ App^[2]

Image: A user interacting with a computer, demonstrating how the customizable action buttons on the Logitech POP Mouse can be configured via the Logi Options+ App.

Silent Touch Technology

The POP Mouse incorporates Silent Touch Technology, which reduces click noise by over 90% compared to standard mice. This feature ensures a quiet working environment.

A photograph of a person's hands using a white Logitech POP Mouse on a light-colored wooden desk. The person is wearing a dark green long-sleeved shirt. To the left of the mouse is a white keyboard with orange function keys. In the background, there is an orange mug, an orange notebook with a green pen, and some orange pens. The background is a solid dark orange color.

Make a big impression on the quiet

With Silent Touch Technology

Image: A user operating the Logitech POP Mouse, illustrating the quiet clicking experience provided by Silent Touch Technology.

Multi-Device Connectivity

The Easy-Switch button on the bottom of the mouse allows you to seamlessly switch between up to three paired Bluetooth devices (Windows, macOS, iPadOS, ChromeOS). This is ideal for users who work across multiple platforms.

Add style to your space



Modern, compact, contoured mouse

Image: The Logitech POP Mouse positioned next to a compatible keyboard on a desk, demonstrating its compact design and suitability for various setups.

MAINTENANCE

Cleaning Your Mouse

To maintain optimal performance and hygiene, regularly clean your POP Mouse. Use a soft, lint-free cloth lightly dampened with water or a mild cleaning solution. Avoid using abrasive cleaners or submerging the mouse in liquid.

Battery Replacement

The Logitech POP Mouse is powered by one AA battery, offering up to 2 years of battery life depending on usage. When the battery is low, the LED indicator on the mouse may flash. To replace the battery:

1. Turn off the mouse using the power switch on the bottom.
2. Gently remove the top cover of the mouse. It is magnetically attached.
3. Remove the old AA battery and insert a new one, ensuring correct polarity (+/-).
4. Replace the top cover and turn the mouse back on.

TROUBLESHOOTING

Mouse Not Connecting/Responding

- **Check Battery:** Ensure the battery is not depleted. Replace if necessary.
- **Power Cycle:** Turn the mouse off and then on again.
- **Re-pair Bluetooth:** Go to your device's Bluetooth settings, remove the POP Mouse, and then re-pair it following the "Bluetooth Pairing" steps in the Setup section.
- **Device Compatibility:** Ensure your device's operating system is compatible (Windows, macOS, iPadOS, ChromeOS, Linux).
- **Interference:** Move the mouse closer to your device and away from other wireless devices that might cause interference.

Cursor Movement is Erratic or Jumpy

- **Clean Sensor:** Ensure the optical sensor on the bottom of the mouse is clean and free of debris.
- **Surface:** Use the mouse on a clean, non-reflective, and uniform surface. Mouse pads are recommended.
- **Battery Level:** Low battery can sometimes affect tracking performance. Replace the battery.

Action Button Not Working

- **Logi Options+ App:** Ensure the Logi Options+ App is installed and running on your computer.
- **Configuration:** Verify that the action button is correctly configured within the Logi Options+ App.

SPECIFICATIONS

Feature	Detail
Brand	Logitech
Model Number	910-007408
Connectivity Technology	Bluetooth
Movement Detection Technology	Optical
Color	Off White
Item Weight	4 ounces (approx. 113 grams)
Package Dimensions	4.96 x 3.62 x 1.85 inches
Power Source	Battery Powered
Batteries Required	1 AA battery (included)

Feature	Detail
Average Battery Life	Up to 2 years
Operating System Compatibility	Windows, macOS, Linux, iPadOS, ChromeOS
Special Features	Lightweight, Portable, Soundless (Silent Touch Technology), Wireless, Programmable Buttons (via Logi Options+ App), Easy-Switch (up to 3 devices)
Recycled Plastic Content	Between 37% and 68% (depending on color, excluding PCB and packaging)

WARRANTY AND SUPPORT



Logitech products typically come with a limited hardware warranty. For specific warranty details, please refer to the warranty information provided with your product packaging or visit the official Logitech support website.

For further assistance, technical support, or to download the latest version of the Logi Options+ App, please visit the Logitech support page:

Logitech Support Website

Please note: No official product videos with "Seller" as creator type were found in the provided data to embed in this manual.

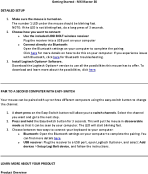
Related Documents - 910-007408

	<p>Logitech MX Master 3S Getting Started Guide</p> <p>A comprehensive guide to setting up and using the Logitech MX Master 3S wireless mouse, covering detailed setup, pairing with multiple computers, button customization, gesture controls, and battery management.</p>
	<p>Logitech MX Anywhere 3 Getting Started Guide</p> <p>A comprehensive guide to setting up and using the Logitech MX Anywhere 3 mouse, including quick setup, detailed setup, connecting via Bluetooth or USB receiver, installing Logitech Options software, customizing buttons, and understanding LED indicators.</p>

