

SwitchBot Lock Pro zilver

SwitchBot Smart Lock Pro User Manual

Model: Lock Pro zilver | Brand: SwitchBot

1. PRODUCT OVERVIEW

The SwitchBot Smart Lock Pro is a keyless entry door lock designed to convert your existing deadbolt into a smart lock without requiring complex DIY modifications. It features an aluminum alloy casing for durability and offers wide compatibility with mainstream North American deadbolts.

When paired with the SwitchBot Hub 2 (sold separately), the Lock Pro supports Matter, enabling integration with Apple Home and Siri. It is also compatible with third-party platforms such as Alexa and Google for voice command unlocking.



Image 1: SwitchBot Smart Lock Pro and its accompanying mobile application interface.

2. SETUP AND INSTALLATION

The Lock Pro is designed for simple and quick installation onto your existing door lock without damaging old parts, making it suitable for tenants and apartment residents. It is a retrofit solution.

2.1 Compatibility Check

Ensure your existing deadbolt is compatible with the Lock Pro. It is compatible with mainstream North American door lock deadbolts. For Jimmy Proof and Mortise locks, additional adhesive accessories may be required. Please consult the customer support team before purchasing if you have these lock types.

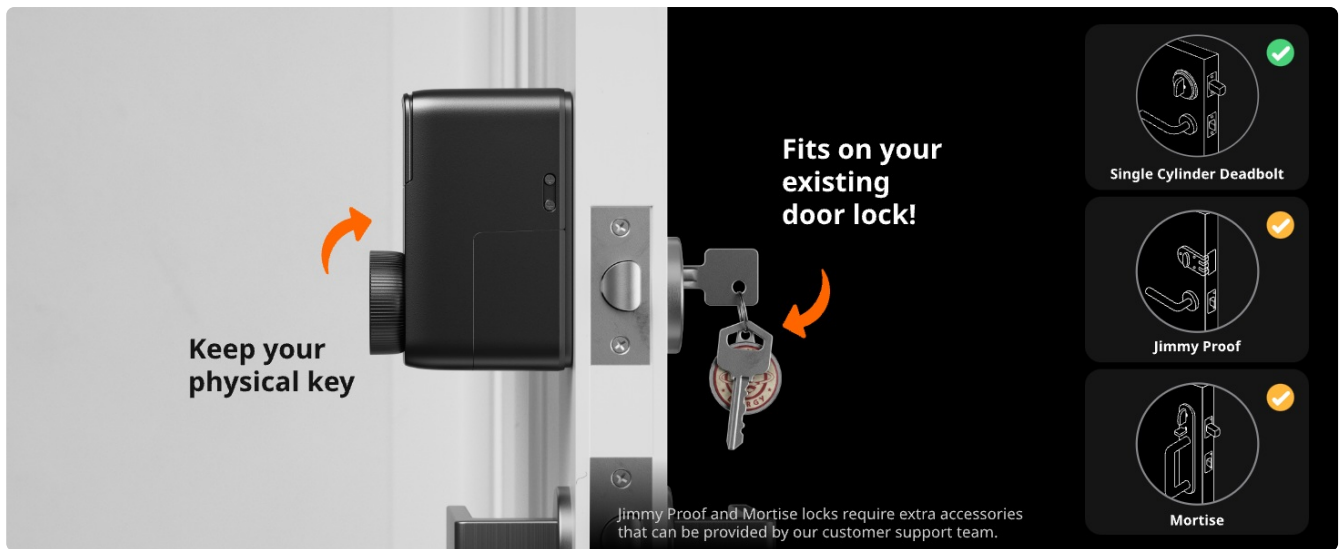

Image 2: Lock compatibility diagram, illustrating supported deadbolt types.

2.2 Physical Installation

The internal side of your existing deadbolt is removed and replaced with the Lock Pro. The package includes necessary screws and a small screwdriver for installation. The main lock unit slides onto a backplate which is secured to the door.

Helps make your existing lock smart.

Now more secure.



Install in minutes

Supports your physical keys

Image 3: Visual guide for installing the Lock Pro onto an existing deadbolt.

2.3 Initial Pairing and App Setup

Download the SwitchBot app to pair your Lock Pro. For Matter support and advanced features like remote unlocking and voice commands, the SwitchBot Hub 2 (sold separately) is required. Follow the in-app instructions for pairing and initial setup.

9 ways to unlock.



Bluetooth



Remote Unlock



Home Sharing



Voice Control



Widget Unlock



Apple Watch



SwitchBot Remote*



Physical Key



NFC Tag*

*SwitchBot Remote/NFC Tag sold separately.

Image 4: Remote unlocking via the SwitchBot app on a smartphone.

3. OPERATING THE LOCK PRO

3.1 Unlocking Methods

The Lock Pro offers multiple ways to unlock your door:

- **Bluetooth:** Unlock directly via the SwitchBot app when within Bluetooth range.
- **Remote Unlock:** Requires SwitchBot Hub. Unlock from anywhere using the app.
- **Home Sharing:** Share access with family and friends through the app.
- **Voice Control:** Compatible with Alexa, Google Assistant, and Siri (with Hub 2).
- **Widget Unlock:** Quick access from your smartphone's home screen.
- **Apple Watch:** Unlock directly from your Apple Watch (with Hub 2).
- **SwitchBot Remote:** (Sold separately) A dedicated remote for quick unlocking.

- **Physical Key:** Your existing physical key remains functional.
- **NFC Tag:** (Sold separately) Tap an NFC tag to unlock.

Compatible locks.

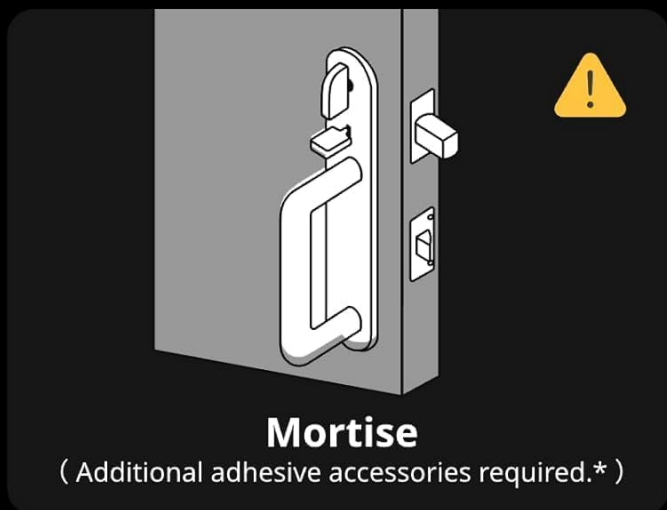
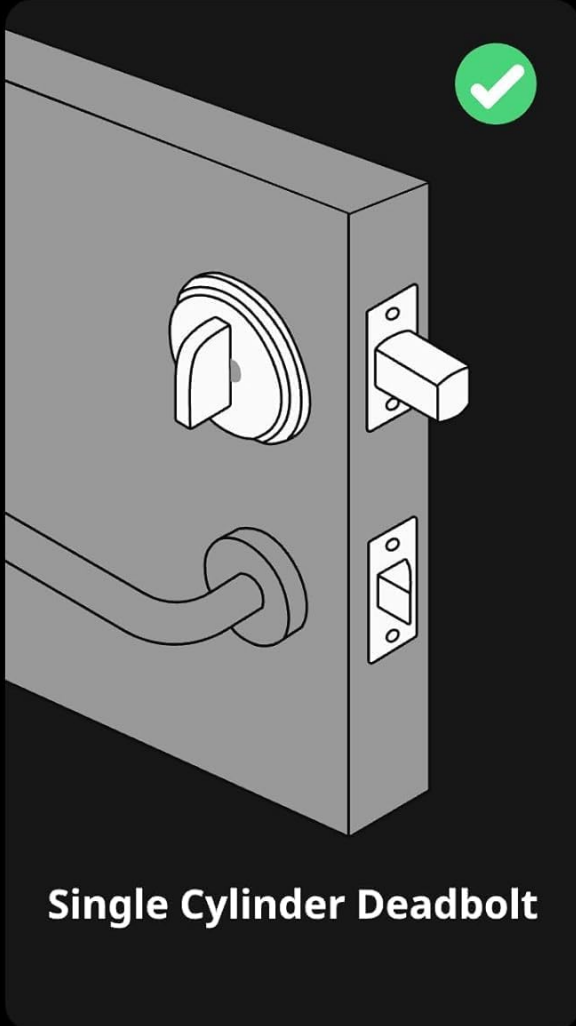

*Jimmy Proof and Mortise locks may experience surface adhesion issues. Please consult our Customer Support Team before purchasing.

Image 5: Overview of the nine different unlocking methods available with the Lock Pro.

3.2 Auto-Lock Feature

The Auto-Lock feature automatically locks your door immediately after closing, ensuring security when you leave or enter your home. This function uses geomagnetism for detection.

Makes leaving home easy, and coming home even easier.

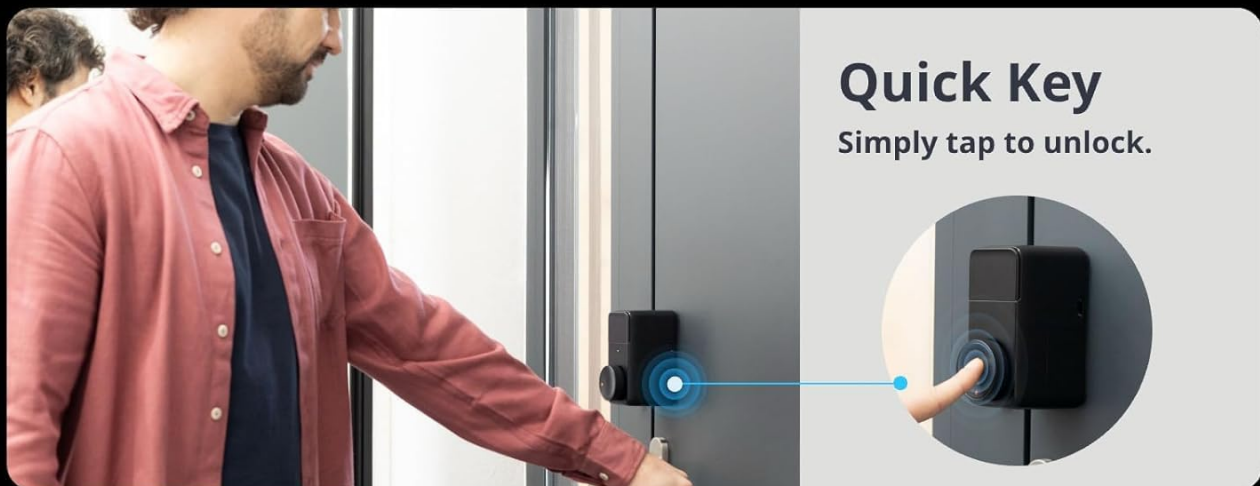
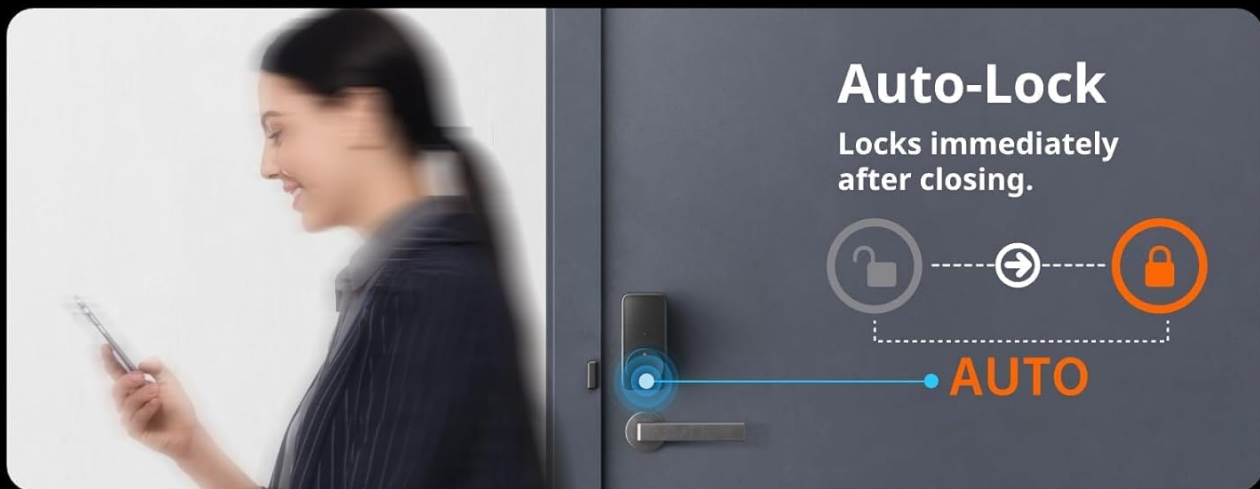

Image 6: Illustration of the automatic locking mechanism upon door closure.

3.3 Real-time Notifications

When connected to a SwitchBot Hub, the Lock Pro can send real-time notifications to your smartphone regarding the door lock status (locked/unlocked) and overall door status (open/closed).



Image 7: Example of real-time notifications received on a smartphone about door status.

4. MAINTENANCE

4.1 Battery Life and Replacement

The Lock Pro is powered by 4 x AA 1.5V batteries (included), providing a battery life of up to 6-9 months depending on usage. Low battery notifications will be sent to your app when replacement is needed.

For extended battery life (9-12 months), the SwitchBot Dual Power Pack (sold separately) can be used. This accessory ensures continuous power by automatically switching between battery sources.

A more Pro kind of battery life.

Power supply method①

4 x AA batteries*

270 Days



*Actual results may vary depending on use.

Power supply method②

Dual Power Pack**

∞



**Dual Power Pack sold separately.

Image 8: Comparison of battery life using standard AA batteries versus the optional Dual Power Pack.

5. TROUBLESHOOTING

5.1 Low Battery Situations

If the battery runs low, the Lock Pro can still be unlocked using passive power supply. However, it is recommended to replace batteries promptly upon receiving low battery notifications to ensure optimal performance.

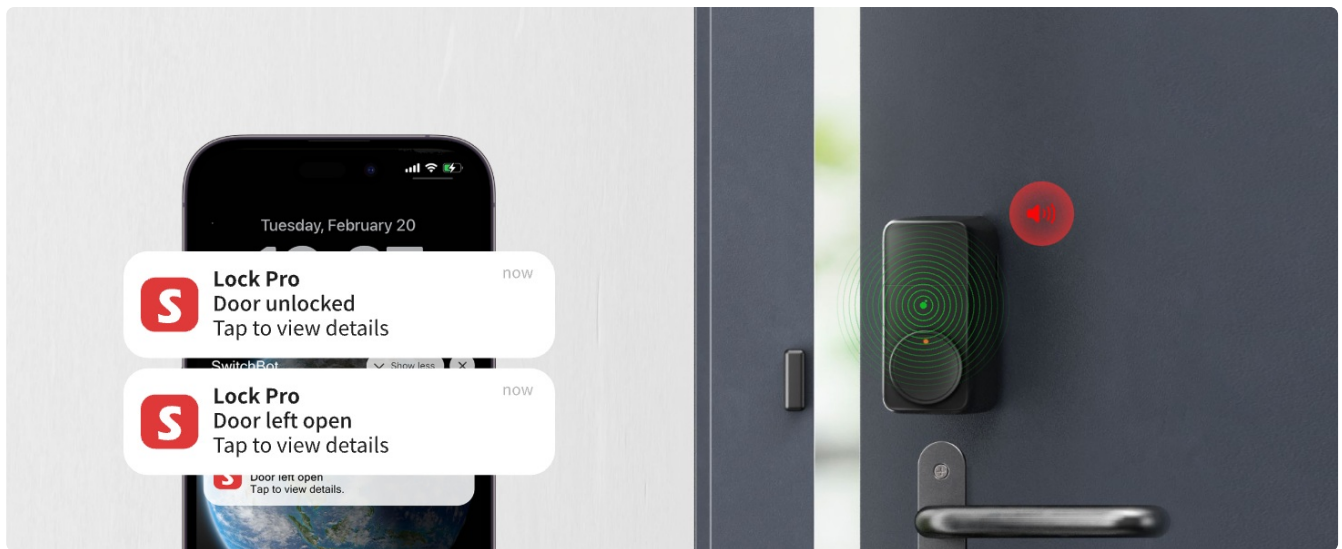

Image 9: Comparison of Lock Pro's ability to unlock during low battery versus other smart locks.

5.2 Connectivity Issues

If you experience issues with connectivity or remote access, ensure your SwitchBot Hub (if used) is properly connected to your Wi-Fi network and within range of the Lock Pro. Check the SwitchBot app for device status and network diagnostics.

5.3 Physical Key Not Working

The Lock Pro is designed to allow continued use of your physical key. If your physical key is not working, ensure the lock mechanism is not obstructed and that the Lock Pro is correctly installed and aligned with your deadbolt.

6. SPECIFICATIONS

Feature	Detail
Brand	SwitchBot
Model Name	SwitchBot Smart Lock Pro
Lock Type	Deadbolt
Material	Aluminum
Color	Lock Pro Silver
Item Dimensions (L x W x H)	2.32 x 3.3 x 4.72 inches
Item Weight	15.9 ounces (450 Grams)
Power Source	4 x AA batteries (included)
Connectivity Protocol	Wi-Fi (with Hub), Bluetooth
Controller Type	IFTTT, Siri, Amazon Alexa (with Hub)
UPC	810150541564

7. WARRANTY AND SUPPORT

For warranty information and technical support, please refer to the official SwitchBot website or contact their customer service directly. You can also find additional resources and FAQs on the SwitchBot support page.

Official User Manual (PDF): [Download PDF](#)

8. OFFICIAL PRODUCT VIDEOS

Below are official product videos from the seller, providing visual guides and demonstrations of the SwitchBot Smart Lock Pro.

No official seller videos found in the provided data that meet the embedding criteria.