

[Manuals.plus](#) /

> [GiGimundo](#) /

> GiGimundo G40 USB4 40Gbps Portable SSD 512GB User Manual

GiGimundo G40-512GB

GiGimundo G40 USB4 40Gbps Portable SSD User Manual

Model: G40-512GB

1. INTRODUCTION

This manual provides essential instructions for the setup, operation, and maintenance of your GiGimundo G40 USB4 40Gbps Portable SSD. Please read this manual thoroughly before using the device to ensure optimal performance and longevity.

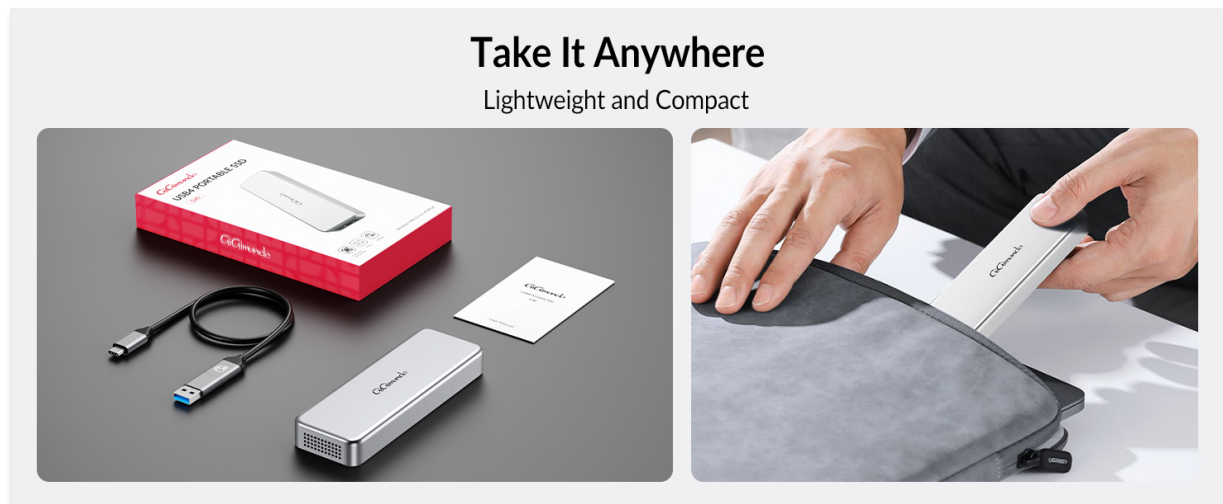

The GiGimundo G40 Portable SSD is designed for high-speed data transfer and portability, making it suitable for professionals and users requiring fast external storage.

2. SETUP

2.1 Package Contents

- GiGimundo G40 USB4 Portable SSD
- 1 x USB Type-C Data Cable (2-in-1, compatible with USB-C and USB-A ports)



The package includes the G40 SSD and a versatile USB Type-C data cable for broad compatibility.

2.2 Connecting the SSD

1. Connect the provided USB Type-C data cable to the USB-C port on the GiGimundo G40 SSD.
2. Connect the other end of the cable to a compatible port on your computer or device. For optimal performance, use a Thunderbolt 3/4 or USB4 enabled port. The cable also supports USB 3.0, USB 3.2 Gen 2, and USB 3.2 Gen 2x2.

2.3 Initial Formatting

The GiGimundo G40 SSD does not require any special software installation. Upon first connection, you may need to format the drive to a file system compatible with your operating system (e.g., APFS for macOS, NTFS for Windows, exFAT for cross-platform compatibility). Refer to your operating system's documentation for instructions on how to format an external drive.

3. OPERATING THE SSD

3.1 Data Transfer

The G40 SSD utilizes USB4 technology to achieve data transfer speeds of up to 40Gbps. This allows for rapid

movement of large files, such as 4K/8K videos, high-resolution photos, and extensive musical works.



Experience ultra-fast data transfer speeds of up to 40Gbps with the G40 SSD.

3.2 Usage for Content Creation

The high-speed capabilities of the G40 SSD make it suitable for direct editing of large files without the need to transfer them to your computer's internal storage. This is particularly beneficial for video editing, 3D rendering, and graphic design workflows.



The G40 SSD supports direct editing of video files, enhancing workflow efficiency for content creators.

3.3 Compatibility

The G40 SSD is compatible with PCs, Macs (including all Silicon M series Mac Mini, MacBook Air, MacBook Pro, Mac Studio), and laptops equipped with Thunderbolt 3/4 or USB4 ports. It also supports USB-C cameras and tablets.

4. MAINTENANCE

4.1 Cooling System

The G40 SSD features a built-in active turbo cooling fan, a metal enclosure, and an air duct design to maintain optimal operating temperatures. This system prevents thermal throttling and ensures consistent performance during intensive tasks.

More Stable Running

Multiple heat dissipation, lower temp,
longer lifespan

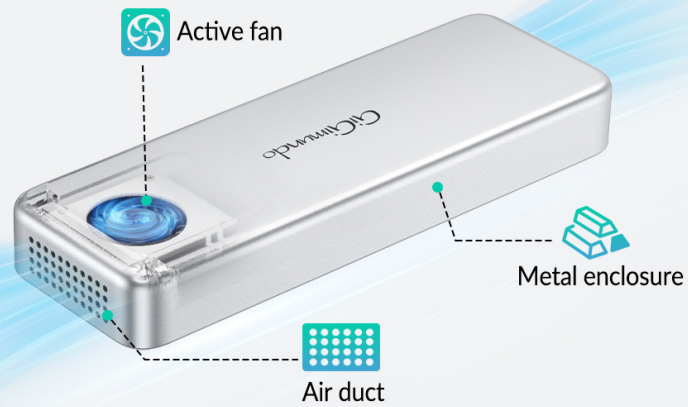

The G40's cooling system, including an active fan and metal enclosure, ensures stable performance.

4.2 Durability and Care

The SSD is constructed with a CNC machined aluminum case, providing a lightweight, rugged, and shock-resistant design. It is designed to withstand drops up to 1 meter and resist wear and tear. To ensure its longevity, avoid exposing the device to extreme temperatures, moisture, or strong impacts.



Good Shock Resistance

Solid aluminum alloy housing

The solid aluminum alloy housing provides good shock resistance for the G40 SSD.

4.3 Data Backup

While the G40 SSD is a high-performance external work drive, it is recommended to regularly back up critical data to other storage solutions. This practice helps improve efficiency and extends the life of the drive, especially when handling large, frequently accessed files.

5. TROUBLESHOOTING

5.1 Device Not Recognized

- **Check Connection:** Ensure the USB cable is securely connected to both the SSD and your computer's port.
- **Try Another Port:** Connect the SSD to a different USB or Thunderbolt port on your computer.
- **Verify Formatting:** Ensure the drive is formatted to a file system compatible with your operating system. Check Disk Management (Windows) or Disk Utility (macOS).
- **Restart Computer:** A simple restart can often resolve connection issues.

5.2 Slow Data Transfer Speeds

- **Use Compatible Port:** Ensure the SSD is connected to a Thunderbolt 3/4 or USB4 port on your computer for maximum speed. Connecting to a slower USB port (e.g., USB 3.0) will limit performance.
- **Check Cable:** Use the provided high-speed USB Type-C cable. Other cables may not support 40Gbps speeds.
- **Monitor Temperature:** While the G40 has an active cooling fan, prolonged heavy use in a hot environment might affect performance. Ensure adequate airflow around the device.
- **System Resources:** Ensure your computer has sufficient CPU, RAM, and other resources available during large data transfers or intensive operations.

5.3 Overheating Concerns

- The G40 is designed with an active cooling fan. If you notice excessive heat, ensure the air vents on the device are not obstructed.
- Avoid placing the SSD in enclosed spaces during operation.

6. SPECIFICATIONS

Brand	GiGimundo
Series	G40
Model Number	G40-512GB
Digital Storage Capacity	512 GB
Hard Drive Interface	Solid State
Connectivity Technology	USB 3.0, USB 3.2 Gen 2, USB 3.2 Gen 2x2, USB4
Hardware Platform	Linux, Mac, PC
Special Features	Backward Compatible, Dust Resistant, Portable, Shock Resistant, TRIM Support, Built-in Active Turbo Fan
Item Dimensions (LxWxH)	5.55 x 1.85 x 71 inches
Item Weight	5.6 ounces

Excellent for USB4/TBT4

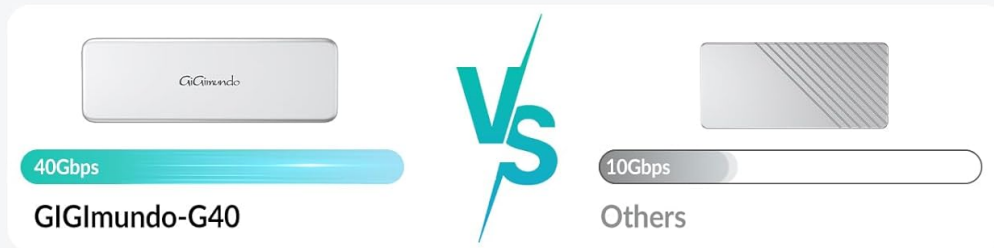

Physical dimensions of the GiGimundo G40 Portable SSD.

7. WARRANTY INFORMATION

For detailed warranty information regarding your GiGimundo G40 USB4 Portable SSD, please refer to the warranty card included with your product or visit the official GiGimundo website. Warranty terms and conditions may vary by region and purchase date.

8. CUSTOMER SUPPORT

If you encounter any issues or have questions not covered in this manual, please contact GiGimundo customer support. Contact information can typically be found on the official GiGimundo website or on the product packaging.