

Edifier W800BT SE

Edifier W800BT SE Wireless Over-Ear Headphones User Manual

Comprehensive guide for your Edifier W800BT SE headphones.

1. INTRODUCTION

Thank you for choosing the Edifier W800BT SE Wireless Over-Ear Headphones. This manual provides detailed instructions on how to set up, operate, and maintain your headphones to ensure optimal performance and longevity.

What's in the Box:

- Headset x 1
- Type-C Cable x 1
- User Manual x 1



Image: The Edifier W800BT SE Wireless Over-Ear Headphones in gray, showcasing their sleek design.

2. SETUP

2.1 Charging the Headphones

Before first use, fully charge your headphones. Connect the supplied Type-C cable to the charging port on the headphones and the other end to a USB power source. The indicator light will show charging status.

- A full charge provides approximately 45 hours of continuous playback.
- A quick 15-minute charge can provide up to 8 hours of use.



Image: A close-up of the headphone's USB-C charging port with the cable connected, indicating charging.



Image: A visual representation of the headphone's impressive battery life and fast charging capabilities.

2.2 Power On/Off

To power on, press and hold the power button until the indicator light illuminates. To power off, press and hold the power button until the indicator light turns off.

2.3 Bluetooth Pairing

1. Ensure the headphones are powered off.
2. Press and hold the power button for approximately 3-5 seconds until the indicator light flashes rapidly, indicating pairing mode.
3. On your device (smartphone, tablet, computer), enable Bluetooth and search for "EDIFIER W800BT SE" in the list of available devices.
4. Select "EDIFIER W800BT SE" to connect. Once connected, the indicator light will stop flashing and remain solid.

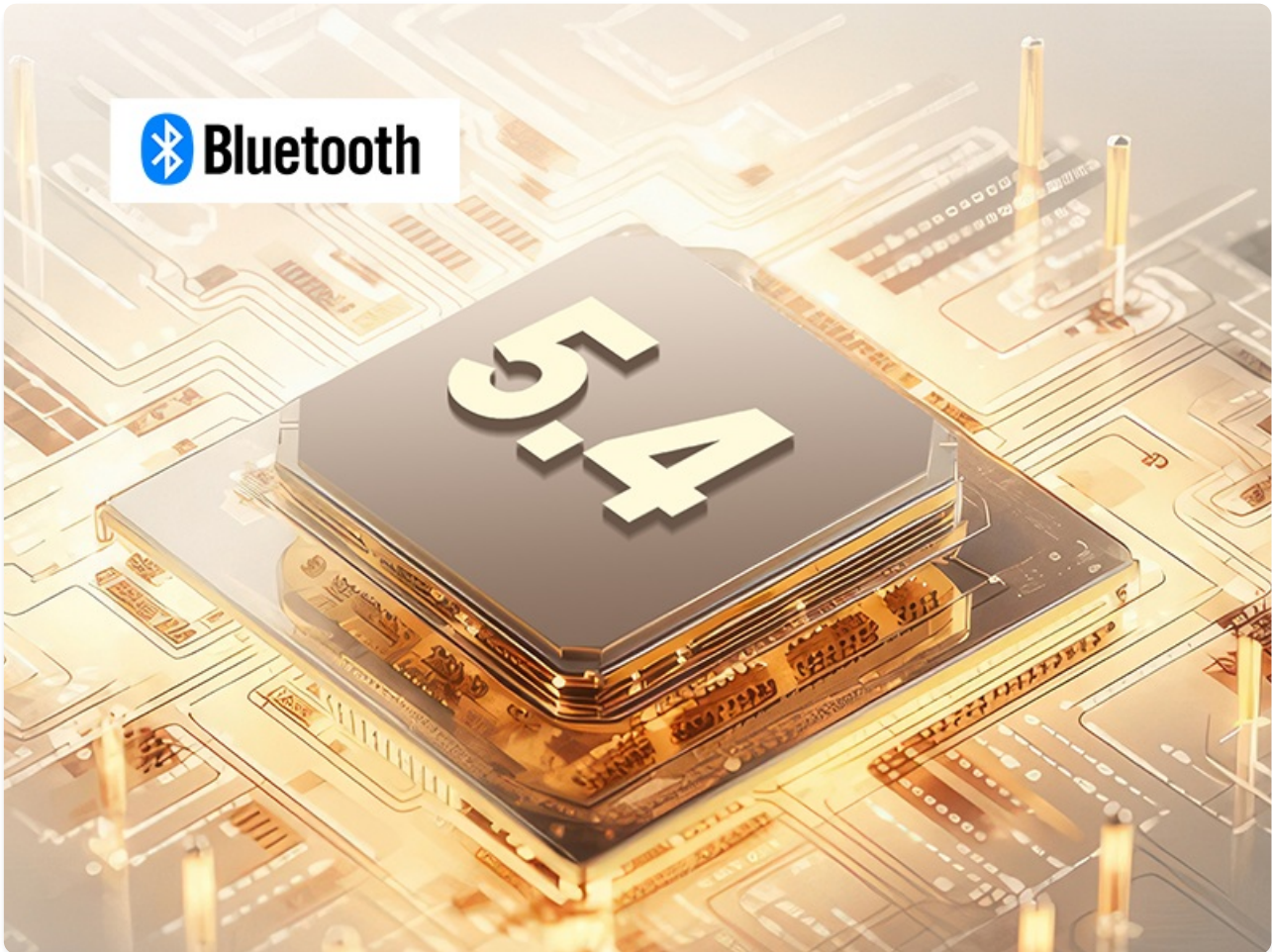

Image: A visual representation of the Bluetooth 5.4 chip, highlighting its role in faster and more stable connectivity.

Your browser does not support the video tag.

Video: An official product video demonstrating the features and pairing process of the Edifier W800BT SE headphones.

2.4 Multipoint Connection

The W800BT SE headphones support multipoint connection, allowing you to connect to two Bluetooth devices simultaneously. This enables seamless switching between devices, for example, from a laptop for music to a phone for calls.



Image: A graphic illustrating the multipoint connection feature, showing the headphones connected to both a smartphone and a laptop.

3. OPERATING THE HEADPHONES

3.1 Controls

The headphones feature intuitive controls located on the earcup. Refer to the diagram below for button functions:

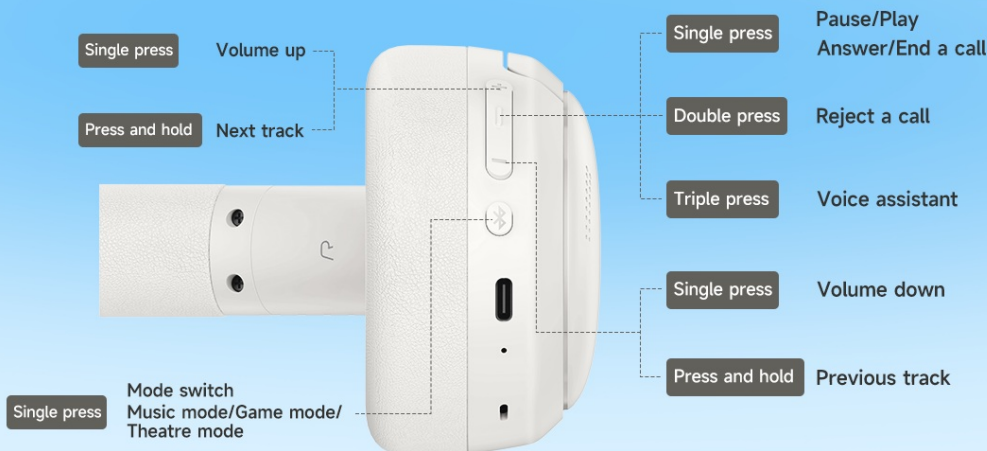

Image: A detailed diagram showing the location and function of each control button on the Edifier W800BT SE headphones.

- **Single Press (Multi-function button):** Play/Pause, Answer/End a call
- **Double Press (Multi-function button):** Reject a call
- **Triple Press (Multi-function button):** Activate Voice Assistant
- **Single Press (+):** Volume up
- **Press and Hold (+):** Next track
- **Single Press (-):** Volume down
- **Press and Hold (-):** Previous track
- **Single Press (Mode switch button):** Switch between Music mode, Game mode, and Theatre mode.

3.2 Sound Quality

The headphones are equipped with 40mm dynamic drivers and titanium-coated composite diaphragms, engineered to

deliver high-fidelity audio with a broad soundstage, powerful bass, and clear mid-high frequencies.



Image: An exploded view diagram highlighting the 40mm dynamic driver with its titanium-coated composite diaphragm, responsible for high-fidelity audio.

3.3 AI Call Noise Reduction

The integrated AI noise reduction algorithm, combined with high-sensitivity microphones, effectively filters out background noise during calls, ensuring crystal-clear voice clarity for hands-free communication.

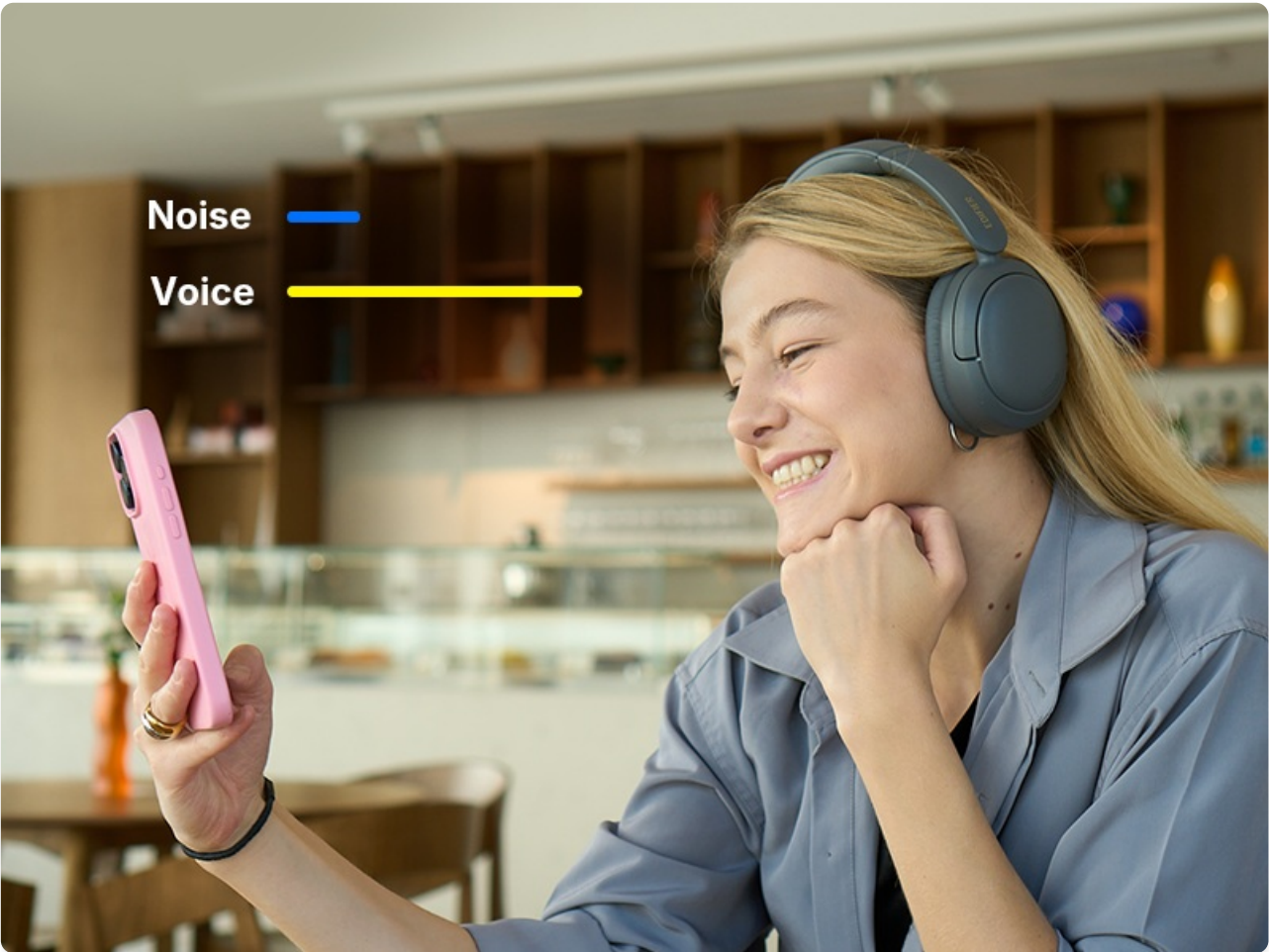

Image: A person wearing the headphones while on a call, with a visual overlay demonstrating the AI call noise reduction feature separating voice from background noise.

3.4 Game Mode

Activate Game Mode for an ultra-low latency experience of just 0.06 seconds. This ensures perfect audio-visual synchronization, enhancing your immersive gaming sessions.



Image: A user enjoying a mobile game with the headphones, illustrating the ultra-low latency of 0.06 seconds for synchronized audio and visuals.

3.5 EDIFIER ConneX App

Enhance your experience by downloading the EDIFIER ConneX app. The app provides additional functions including personalized control settings, preset EQ options, custom EQ adjustments, schedule power off, and a "Find Your Product" feature.

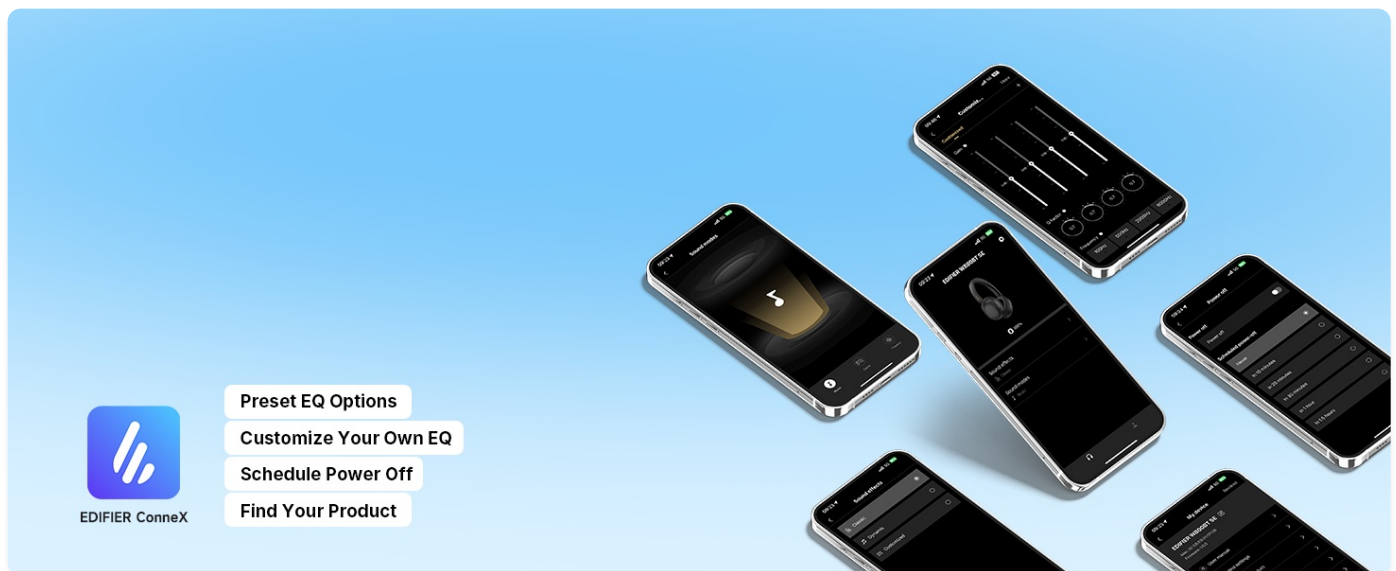

Image: Multiple smartphone screens displaying the EDIFIER ConneX app interface, showcasing its various features like EQ settings and

4. MAINTENANCE

Proper maintenance ensures the longevity and optimal performance of your Edifier W800BT SE headphones.

4.1 Cleaning

- Use a soft, dry cloth to wipe the surfaces of the headphones.
- Do not use abrasive cleaners, alcohol, or chemical solvents, as these may damage the surface.
- Keep the charging port free of dust and debris.

4.2 Storage

When not in use, store the headphones in a cool, dry place away from direct sunlight and extreme temperatures. The foldable design allows for compact storage, ideal for daily use and travel.

COMFORT IN EVERY BEAT

Adaptive
Fit



Around
242g



Image: The Edifier W800BT SE headphones in their folded configuration, demonstrating their portability and ease of storage.

5. TROUBLESHOOTING

If you encounter any issues with your headphones, please refer to the following common problems and solutions:

Problem	Possible Cause	Solution
Headphones do not power on.	Low battery.	Charge the headphones fully.
Cannot pair with device.	Headphones not in pairing mode; Bluetooth disabled on device; device too far.	Ensure headphones are in pairing mode (flashing light); enable Bluetooth on device; move device closer (within 10 meters).

Problem	Possible Cause	Solution
No sound or intermittent sound.	Volume too low; headphones not connected; interference.	Increase volume on headphones and device; re-pair headphones; move away from sources of interference.
Poor call quality.	Microphone obstructed; excessive background noise.	Ensure microphone is clear; utilize AI Call Noise Reduction feature; move to a quieter environment.

6. SPECIFICATIONS

Key technical specifications for the Edifier W800BT SE Wireless Over-Ear Headphones:

Feature	Detail
Model Name	W800BT SE
Connectivity Technology	Wireless (Bluetooth)
Bluetooth Version	5.4
Bluetooth Range	10 Meters
Audio Driver Type	Dynamic Driver (40mm, Titanium-coated diaphragm)
Battery Life	Up to 45 Hours
Charging Time (Fast Charge)	15 minutes for 8 hours playback
Headphones Jack	USB-C (for charging)
Control Method	Buttons, App (EDIFIER ConneX)
Item Weight	300 Grams (approx. 10.6 ounces)
Product Dimensions	3.35 x 3.15 x 3.35 inches
Special Feature	Lightweight, Foldable, AI Call Noise Cancellation, Multipoint Connection, Game Mode

7. WARRANTY AND SUPPORT

Edifier products are designed and manufactured to the highest quality standards. For warranty information, technical support, or service inquiries, please refer to the warranty card included with your product or visit the official Edifier website.

Please retain your proof of purchase for warranty claims.



[Edifier W800BT Pro Wireless ANC Headphones User Manual](#)

Comprehensive user manual for the Edifier W800BT Pro Wireless Over-Ear Headphones with Active Noise Cancellation. Learn about setup, pairing, controls, charging, and compliance information.

[EDIFIER W800BT Pro Wireless Over-Ear Headphones with Active Noise Cancellation - User Manual](#)

User manual for the EDIFIER W800BT Pro wireless over-ear headphones. Learn how to power on/off, pair devices (including dual-device connection), charge, use controls, reset, and switch to wired listening mode. Features active noise cancellation.



Wireless Over-Ear Headphones with Active Noise Cancellation
Model: EDP200149

— Manual —

EN 1. Power ON/OFF 

2. First pairing



3. Pairing for new device



4. Dual-device connection



5. Charging



6. Controls

7. Reset



8. Wired listening





W800BT Pro

Wireless Over-Ear Headphones with Active Noise Cancellation
Model: E8P28048

Manual (BC)

EN 1. Power ON/OFF



Press and hold the power button to power on/off.

2. First pairing



- Once powered on, the headphones will automatically enter Bluetooth pairing mode.
- Select "EDIFIER W800BT Pro" in your device setting to connect.

3. Pairing for new device



- In ON state, press and hold the **⏻** button for about 3 seconds to enter Bluetooth pairing mode.
- Select "EDIFIER W800BT Pro" in your device setting to connect.

4. Dual-device connection



- Pair device A with the headphones automatically.
- Press and hold **⏻** button for 3 seconds to re-enter Bluetooth pairing mode, and then select "EDIFIER W800BT Pro" in device B setting to connect.
- Select "EDIFIER W800BT Pro" again in device A setting to connect, and the dual-device connection is done.

5. Charging



Connect the headphones to a power source via the USB-C cable for charging.
Note: 1. Please do not use USB-C cable to connect the headphones.
2. When charging with USB-C cable, the product is not in active headphones and Bluetooth function is unavailable.

6. Controls

- Call**
 - ⏻** x1 b
 - ⏻** x1 b
 - ⏻** x2 b
 - ⏻** x3 b
- Music**
 - ⏻** x1 b
 - ⏻** b
 - ⏻** x1 b
 - ⏻** x1 b
 - ⏻** b
- Mode**
 - ⏻** x2 b
 - ⏻** x1 b

Note:
1. **⏻** Press **⏻** 2 times to turn on/off. Press and hold **⏻** button for 3 seconds to re-enter Bluetooth pairing mode.
2. When charging with USB-C cable, the product is not in active headphones and Bluetooth function is unavailable.
3. Please do not connect the headphones to a power source via the USB-C cable.

7. Reset



- In ON state, press the **⏻** button 5 times to reset.
- The headphones will automatically enter Bluetooth pairing mode if successful.

8. Wired listening



Connect to the headphones via the USB-C cable. Wired listening will automatically disable Bluetooth mode.

Edifier W800BT Pro Wireless Headphones User Manual

User manual for the Edifier W800BT Pro Wireless Over-Ear Headphones with Active Noise Cancellation, covering power, pairing, dual-device connection, charging, controls, reset, and wired listening.

	<p>Edifier W800BT Pro Wireless Over-Ear Headphones User Manual</p> <p>Comprehensive user manual for the Edifier W800BT Pro wireless over-ear headphones with active noise cancellation. Learn about setup, pairing, controls, charging, wired listening, and compliance information.</p>
	<p>Edifier W800BT Pro Noise Cancelling Headphones User Manual</p> <p>User guide for the Edifier W800BT Pro noise-cancelling Bluetooth headphones, detailing setup, pairing, dual connection, charging, controls, and wired listening.</p>

• For initial use, press and hold the power button for around 3 seconds to power on the headset. The blue and green lights will flash and then slowly and rapidly, once entering Bluetooth pairing mode. Press and hold the power button for around 3 seconds to stop pairing. Once pairing is successful, the blue light will flash twice for subsequent use. The headset will automatically connect to the last paired device.

• Connect to the Bluetooth device: When the headset is powered on, press and hold the multi-function button for around 3 seconds for the device to connect. The blue and green lights will flash alternately and rapidly.

- Restore to factory settings
- When the headset is powered on, press and hold the "V" and "M" buttons simultaneously for around 3 seconds and the blue light button will then apply to the pairing process.

• Multi-function



• Call



• Mode switch/Bluetooth pairing



5. FAQs

Red light instead of blue light flashes

The headset is at low battery level, please recharge the headset.

No sound

- Check if the headset is operating.
- Check if the headset is correctly connected to the mobile phone.
- Check if the headset is operating within a normal working range.

The call quality of the headset is not good

- Check if the headset is in an area with strong signal.
- Please ensure the headset is within effective distance (30m) and no obstacles between the headset and mobile phone.

When playing music, cannot control playback/pause/next track via the headset.

Please ensure the headset device supports HSP/HFP/AVRCP/A2DP/Volume Remote Control/PAFF/PAFF.

6. Maintenance

It is not used for long periods of time, please charge the product with Bluetooth every three months.

Keep the product away from heat, place in cool and dry place, avoid direct sunlight.

Do not put the product in places exposed to rain or with high temperature. High temperature will reduce the life of the product and damage the product.

Do not use the product with liquid or avoid damage to the product.

Do not damage the product. Non-professional personnel may damage the product.

Do not use the headset when the product is not fully charged to avoid damaging the headset.

Do not use the headset when the product is not fully charged to avoid damaging the headset.

Do not use the headset when the product is not fully charged to avoid damaging the headset.

Model: EDV 20046

Edifier International Limited

P.O. Box 4444

General Post Office

Hong Kong

www.edifier.com

©2021 Edifier International Limited. All rights reserved.

Printed in China

NOTICE

For the need of technical improvement and system upgrade, information contained herein may be subject to change from time to time without prior notice.

Products of EDIFIER will be customized for different applications. Pictures and illustrations shown on this manual may be slightly different from actual product. If any difference is found, the actual product prevails.

FR 1. Description du produit et accessoires



Accessoire: Câble d'écouteur et câble de recharge, Manuel d'utilisation et

Remarque

Les images illustrent des différences mineures, et peuvent ne pas être exactes.

Pour profiter de la meilleure qualité, branchez le casque audio à la source audio avec un câble de connexion de type C.

2. Allumer/éteindre

- Allumer: Appuyez le bouton d'alimentation pendant environ 3 secondes. Le voyant bleu s'allume.
- Éteindre: Appuyez le bouton d'alimentation pendant environ 3 secondes. Le voyant rouge s'allume et s'éteint.



3. Charger



- Chargez le casque audio.
- Connectez le casque audio pour le charger avec un câble USB.
- Voyant rouge et vert clignote en mode de charge.
- Voyant rouge et vert clignote en mode de charge.

Indicateur de charge

Attention: Le casque ne doit pas être utilisé pendant la charge. Le casque ne doit pas être utilisé pendant la charge.

4. Instructions d'utilisation

• Connexion Bluetooth



Pour l'utilisation initiale, maintenez le bouton d'alimentation appuyé pendant environ 3 secondes pour allumer le casque audio. Un voyant bleu et clignote en mode de connexion.

Appuyez sur le bouton d'alimentation pour allumer le casque audio.

Assurez-vous que le casque audio est correctement connecté au smartphone.

Assurez-vous que le casque audio est correctement connecté au smartphone.

Assurez-vous que le casque audio est correctement connecté au smartphone.

Assurez-vous que le casque audio est correctement connecté au smartphone.

Assurez-vous que le casque audio est correctement connecté au smartphone.

Assurez-vous que le casque audio est correctement connecté au smartphone.

Subir volumen: pulsación breve

 Subirvolumen: pulsación breve



● 両側からデバイスを持ち、両手はデバイスから離す。

Bluetoothの接続方法



● 両側からデバイスを持ち、両手はデバイスから離す。

5. FAQ

● 充電の仕方について
● 充電の仕方について
● 充電の仕方について

6. 注意

● 充電の仕方について
● 充電の仕方について
● 充電の仕方について

Model TDP20046
Edifier International Limited
P.O. Box 604
General Post Office
Hong Kong
www.edifier.com
©2021 Edifier International Limited. Todos os direitos reservados.
Impresso na China

● 充電の仕方について
● 充電の仕方について
● 充電の仕方について

7. 製品の説明とアクセサリ



● 両側からデバイスを持ち、両手はデバイスから離す。

● 充電の仕方について
● 充電の仕方について
● 充電の仕方について

8. オン/オフ

● オン
● オフ



9. 充電



● 両側からデバイスを持ち、両手はデバイスから離す。

● 充電の仕方について
● 充電の仕方について
● 充電の仕方について

10. ユーザーガイド

Bluetooth接続



● 充電の仕方について
● 充電の仕方について
● 充電の仕方について

充電の仕方



モードスイッチ

 \wedge

音楽を再生するとき、ヘッドセットを介して一時停止(再生)の曲次の曲を制御することはできません。

^

ご注意:
本書に掲載の情報は、技術の改良、システムのアップグレードなどのため、予告なく変更されることがあります。
EYEの他の製品は、さまざまな用途を考慮してカスタマイズされます。
本書の図や写真は実際の製品と異なることがあります。その場合、実際の製品設計が優先します。