

Manuals+

[Q & A](#) | [Deep Search](#) | [Upload](#)

manuals.plus /

- › [MSR](#) /
- › [MSR Guardian Gravity Water Purifier User Manual](#)

MSR Guardian Gravity Purifier

MSR Guardian Gravity Water Purifier User Manual

Model: Guardian Gravity Purifier

Brand: MSR

PRODUCT OVERVIEW

The MSR Guardian Gravity Water Purifier is a state-of-the-art, high-volume gravity-fed system designed for backcountry use, global travel, and emergency preparedness. It utilizes advanced hollow-fiber technology to remove viruses, bacteria, protozoa, sediment, and microplastics from challenging water sources. An integrated activated carbon stage further reduces chemicals, unpleasant tastes, and odors, providing clean and better-tasting water.

This system includes a two-stage purifier, a 10-liter dirty water reservoir, a universal bottle adapter, hoses, and a zippered carry case. It boasts a lifetime capacity of up to 3000 liters and can purify up to 1 liter of water in 2 minutes under optimal conditions.





Image: The MSR Guardian Gravity Water Purifier system, showing the 10-liter dirty water bag, the purification cartridge, and connecting hoses, along with the universal bottle adapter.

SETUP INSTRUCTIONS

1. **Unpack Components:** Carefully remove all components from the zippered carry case: the 10-liter dirty water reservoir, the purification cartridge, hoses, and the universal bottle adapter.
2. **Connect Hoses:** Attach the longer hose to the "dirty water" inlet on the purification cartridge (usually marked with an arrow pointing towards the filter). Attach the shorter hose to the "clean water" outlet (arrow pointing away from the filter). Ensure all connections are secure.
3. **Fill Dirty Water Reservoir:** Open the top of the 10-liter dirty water reservoir and fill it with untreated water from your source. Ensure the top is securely rolled down and clipped to prevent leaks.
4. **Attach Reservoir to Filter:** Connect the dirty water hose from the purification cartridge to the outlet on the bottom of the dirty water reservoir.
5. **Position for Gravity Flow:** Hang the filled dirty water reservoir at least 6 feet (approximately 1.8 meters) above your clean water collection container. This height is crucial for optimal flow rate.

6. **Prepare Clean Water Collection:** Place your clean water bottle, hydration reservoir, or other container below the purification cartridge's clean water outlet. The universal bottle adapter can be used to directly connect to various bottle types.

HIGH FLOW RATE



Image: Individuals setting up and using the MSR Guardian Gravity Water Purifier, demonstrating the hanging of the dirty water bag and collection of purified water into a bottle.

OPERATING INSTRUCTIONS

Once the system is set up, the MSR Guardian Gravity Purifier operates by gravity. No pumping is required.

1. **Initiate Flow:** Ensure the clean water outlet hose is positioned into your collection container. Open any clamps or valves on the clean water hose to allow water to begin flowing through the purification cartridge.
2. **Monitor Flow Rate:** Water will flow from the dirty water reservoir, through the filter, and into your clean container. The system is designed for a fast flow rate, purifying up to 1 liter in 2 minutes under ideal conditions.
3. **Purge Function:** If the flow rate decreases significantly, the system features a dedicated purge hose to restore flow. Locate the purge hose (often a small, separate tube or valve on the filter). Open the purge valve or unclamp the purge

hose to allow a small amount of dirty water to flush out contaminants from the filter. Close the purge valve/clamp once flow is restored. This should be done periodically, especially after filtering heavily turbid water.

4. **Refilling:** When the dirty water reservoir is empty, close the clean water outlet valve, detach the reservoir, and refill it with untreated water as needed.

ULTIMATE VIRAL PROTECTION

Advanced, Hollow Fiber Membrane

These hollow fibers feature pores so small they physically trap contaminants down to the tiniest harmful viruses.

REMOVES
99.99% VIRUSES
99.9% PROTOZOA
99.9999% BACTERIA

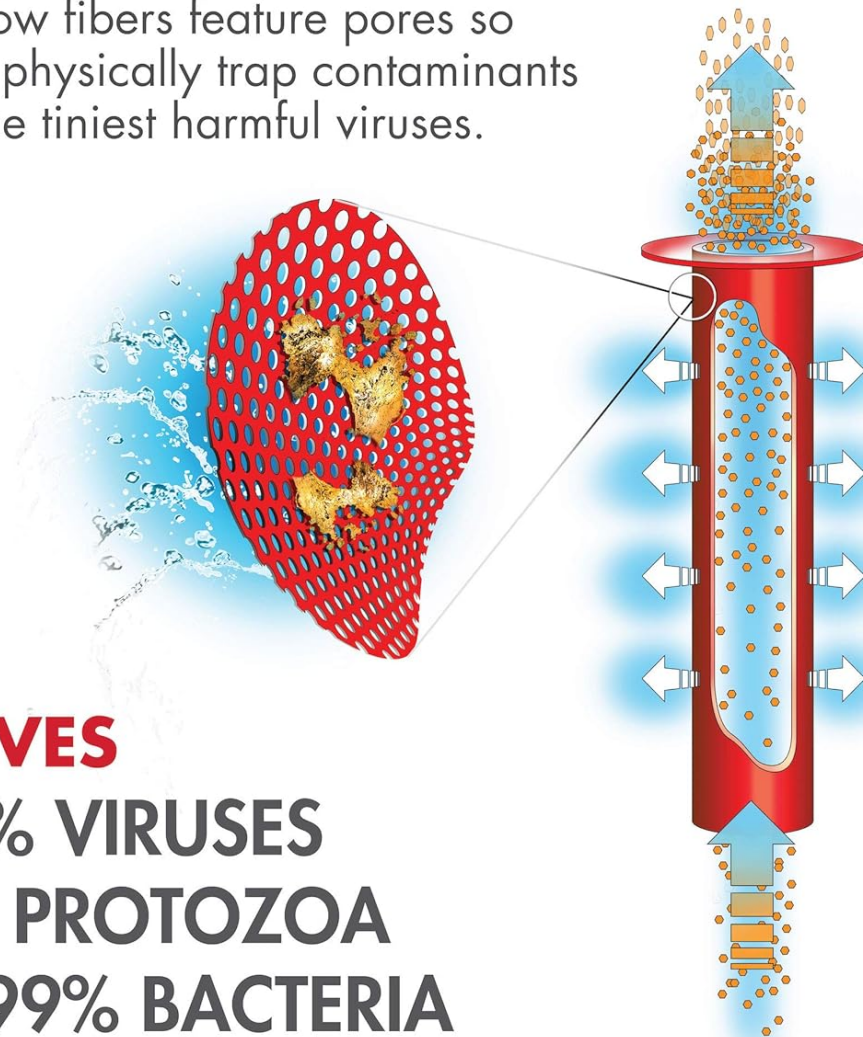

Image: A diagram showing how the advanced hollow fiber membrane physically traps contaminants, including viruses, protozoa, and bacteria, ensuring ultimate viral protection.

BETTER-TASTING WATER

Advanced Hollow Fiber Membrane provides viral protection.

Activated carbon reduces chemicals and unpleasant tastes and odors.



Image: An illustration of the filter's two-stage purification, highlighting the advanced hollow fiber membrane for viral protection and activated carbon for reducing chemicals, unpleasant tastes, and odors.

MAINTENANCE

Proper maintenance ensures the longevity and effectiveness of your MSR Guardian Gravity Purifier.

- **Regular Purging:** Utilize the purge function frequently, especially after filtering heavily contaminated or turbid water, to maintain optimal flow rates and extend filter life.
- **Cleaning the Dirty Water Reservoir:** Periodically clean the 10-liter dirty water reservoir. It can be rinsed with clean water. For thorough cleaning, follow MSR's specific instructions, which may involve a mild bleach solution.
- **Filter Storage:** For long-term storage, the filter must be stored moist. Follow the manufacturer's instructions for proper sterilization and storage procedures to prevent damage and maintain filter integrity. This typically involves flushing with a chlorine solution and storing in a sealed bag to keep it moist.
- **Filter Life:** The purification cartridge has a lifetime capacity of up to 3000 liters. Replace the cartridge when the flow rate becomes consistently slow despite purging, or when the rated capacity is reached.
- **Inspection:** Before and after each use, inspect all components for signs of wear, damage, or leaks. Pay close attention to hoses, connections, and the integrity of the dirty water reservoir.

TROUBLESHOOTING

Problem	Possible Cause	Solution
---------	----------------	----------

Problem	Possible Cause	Solution
Slow or No Water Flow	<ul style="list-style-type: none"> ◦ Clogged filter cartridge ◦ Insufficient hanging height ◦ Airlock in the system ◦ Kinked or blocked hoses 	<ul style="list-style-type: none"> ◦ Perform a filter purge using the dedicated purge hose. ◦ Ensure the dirty water reservoir is hung at least 6 feet above the collection point. ◦ Check all hoses for kinks or blockages. ◦ Ensure the dirty water reservoir is not completely sealed if it's causing an airlock (some users report needing a partial seal).
Water Leaking from Connections	<ul style="list-style-type: none"> ◦ Loose hose connections ◦ Damaged O-rings or seals ◦ Damage to the dirty water reservoir 	<ul style="list-style-type: none"> ◦ Tighten all hose connections securely. ◦ Inspect O-rings and seals for damage; replace if necessary. ◦ Inspect the dirty water reservoir for punctures or tears.
Unpleasant Taste/Odor in Purified Water	<ul style="list-style-type: none"> ◦ Activated carbon is exhausted ◦ Contamination of clean water components 	<ul style="list-style-type: none"> ◦ The activated carbon component has a limited life; consider replacing the filter cartridge if taste/odor persists after extensive use. ◦ Ensure all clean water collection containers and hoses are clean.

SPECIFICATIONS

- **Model Name:** Guardian Gravity Purifier
- **Brand:** MSR
- **Product Dimensions:** 12.5"L x 4"W x 3"H
- **Item Weight:** 1.17 Pounds (approximately 0.53 kg)
- **Power Source:** Gravity Powered
- **Maximum Flow Rate:** 0.5 Liters Per Minute (1 liter in 2 minutes)
- **Lifetime Capacity:** Up to 3000 Liters
- **Filtration Technology:** Advanced Hollow Fiber Membrane, Activated Carbon
- **Removes:** 99.99% Viruses, 99.9999% Bacteria, 99.9% Protozoa, Sediment, Microplastics
- **UPC:** 040818134603
- **Manufacturer:** Cascade Designs Inc
- **Color:** Grey
- **Style:** Original Storage Bag
- **Made In:** USA (of U.S. and imported materials)



Image: The zippered carry case with dimensions of 12.5 inches in length and 4 inches in width, indicating its compact size for transport.

WARRANTY AND SUPPORT

The MSR Guardian Gravity Purifier comes with a **Limited Lifetime Warranty** from Cascade Designs Inc. This warranty covers manufacturing defects in materials and workmanship for the reasonable lifetime of the product.



For warranty claims, technical support, or further inquiries, please contact MSR customer service. Refer to the official MSR website or the original product packaging for the most current contact information and detailed warranty terms.

An official Instructions for Use (IFU) document in PDF format is available for download [MSR Guardian Gravity Purifier IFU \(PDF\)](#).

© 2024 MSR. All rights reserved.

This manual provides general instructions. Always refer to the official manufacturer's documentation for complete and up-to-date information.

Related Documents - Guardian Gravity Purifier

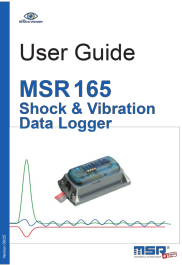
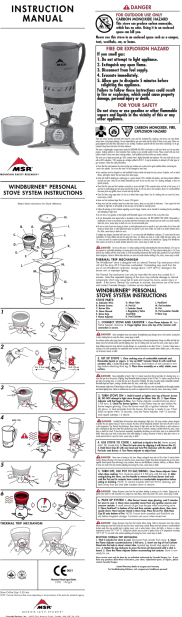
	<p>MSR Guardian Gravity Purifier: Comprehensive Instruction Manual</p> <p>Detailed guide for the MSR Guardian Gravity Purifier, covering setup, purification, storage, disinfection, and integrity testing for safe drinking water in outdoor environments.</p>
	<p>MSR160 Data Logger Quick Start Guide and Software Installation</p> <p>Learn how to quickly set up and use the MSR160 data logger, including MSR PC software installation, connecting to a PC, starting data recording, and transferring data, with optional SD card usage.</p>
	<p>MSR 165 Shock & Vibration Data Logger User Guide</p> <p>Comprehensive user guide for the MSR 165 Shock & Vibration Data Logger, covering setup, data analysis, reporting, and advanced features like FFT and spectral analysis.</p>
	<p>MSR WindBurner Personal Stove System: Instruction Manual & Safety Guide</p> <p>Detailed instruction manual and safety guide for the MSR WindBurner Personal Stove System. Learn how to safely set up, operate, maintain, and troubleshoot your MSR camping stove for outdoor adventures.</p>

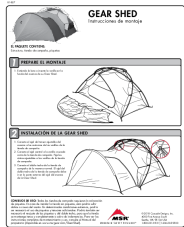

[MSR Gear Shed Assembly Instructions](#)

Step-by-step guide for assembling the MSR Gear Shed tent accessory, including package contents, setup instructions, and usage tips.

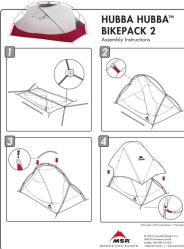

[MSR Hubba Hubba Bikepack 2 Tent Assembly Instructions](#)

Step-by-step assembly guide for the MSR Hubba Hubba Bikepack 2 tent, detailing the setup process for this lightweight and durable bikepacking shelter.