

ONEVAN sku005270

ONEVAN Cordless Paint Sprayer Instruction Manual

Model: sku005270

1. INTRODUCTION

Thank you for choosing the ONEVAN Cordless Paint Sprayer. This manual provides essential information for the safe and efficient operation, maintenance, and troubleshooting of your new paint sprayer. Please read it thoroughly before first use and keep it for future reference.



The ONEVAN Cordless Paint Sprayer, showcasing its main features including 2 batteries, copper motor, cordless design, 3 nozzles, 1000ml capacity, and variable speed.

2. SAFETY INFORMATION

WARNING: Always follow basic safety precautions when using electrical tools to reduce the risk of fire, electric shock, and personal injury.

- Use this product only in well-ventilated areas. Ensure adequate airflow to prevent the accumulation of hazardous fumes.
- Wear appropriate personal protective equipment (PPE), including safety glasses, gloves, and a respirator, to protect against paint particles and fumes.
- Avoid direct contact with eyes and skin. In case of contact, rinse immediately with plenty of water and seek medical

attention if irritation persists.

- Keep the product and all painting materials away from open flames, sparks, and other ignition sources.
- Store the product safely after use, out of reach of children and in a dry, secure location.
- Dispose of paint residues and cleaning solvents according to local environmental regulations.
- Ensure the battery is fully charged before use and disconnected during assembly, disassembly, or cleaning.

3. PACKAGE CONTENTS

Verify that all items are present and in good condition upon unpacking:

- ONEVAN Cordless Paint Sprayer Unit
- 2 x 3000 mAh Lithium-ion Batteries
- Battery Charger
- 3 x Copper Nozzles (1.0mm, 1.8mm, 2.5mm)
- 1000 ml Removable Paint Container
- Viscosity Measuring Cup
- Cleaning Brush and Needle
- User Manual

4. PRODUCT OVERVIEW

The ONEVAN Cordless Paint Sprayer is designed for various painting applications, offering portability and ease of use. It features a powerful copper motor, an anti-backflow system, and adjustable spray settings.



Key components of the ONEVAN Cordless Paint Sprayer: Nut, Jet shape control, Copper nozzle, Flow adjustment, 1000ml container, Quick release switch, Trigger, Power indicator, Soft grip, 3Ah Lithium battery.

Key Features:

- **High Viscosity Compatibility:** Supports paint viscosity up to 80 Din-s, suitable for latex paints, stains, sealants, polyurethanes, varnishes, lacquers, and chalk paints.
- **Adjustable Spray Patterns:** Easily switch between vertical, horizontal, and circular spray patterns by adjusting the air cap.
- **Multiple Nozzle Sizes:** Includes 1.0mm, 1.8mm, and 2.5mm nozzles for different paint types and project requirements.
- **Anti-Backflow System:** Prevents paint leakage and backflow, especially useful for overhead spraying.
- **Powerful Copper Motor:** Ensures efficient and uniform spraying, saving time and effort compared to traditional

methods.

- **Cordless Design:** Powered by two 3000 mAh rechargeable batteries for maximum portability and extended operation.
- **Large Capacity Container:** 1000ml removable container reduces the frequency of refills.

5. SETUP

Follow these steps to prepare your paint sprayer for use:

1. **Charge Batteries:** Ensure both 3000 mAh Lithium-ion batteries are fully charged before use. Insert a charged battery into the sprayer's handle until it clicks into place.
2. **Prepare Paint:** Dilute your paint to the appropriate viscosity using the provided measuring cup. The maximum recommended viscosity is 80 Din-s. Pour the diluted paint into the 1000ml container.



Step 1: Dilute paint and pour into the container. Step 2: Insert the sprayer into the main body and lock it securely.

3. **Assemble Sprayer:** Attach the paint container to the sprayer unit by screwing it on firmly. Ensure it is securely locked to prevent leaks.
4. **Select Nozzle:** Choose the appropriate nozzle size (1.0mm, 1.8mm, or 2.5mm) based on your paint type and desired spray pattern. The 1.0mm nozzle is suitable for thinner materials, while the 2.5mm nozzle is for thicker paints.



Step 3: Choose the appropriate nozzle. Step 4: Change the nozzle to adjust the jet pattern.

5. **Adjust Spray Pattern:** Rotate the air cap to select your desired spray pattern: vertical, horizontal, or circular.
6. **Test Spray:** Before applying paint to your project, perform a test spray on a piece of cardboard or scrap material to ensure the desired pattern and flow are achieved. Adjust the flow regulator as needed.

6. OPERATING INSTRUCTIONS

Once assembled and filled, your ONEVAN Cordless Paint Sprayer is ready for use.

1. **Power On:** Press the trigger to start the sprayer. The power indicator lights will show the battery level.
2. **Adjust Flow Rate:** Use the flow adjustment knob to control the amount of paint being sprayed. Start with a lower setting and increase as needed.
3. **Maintain Distance:** Hold the sprayer approximately 6-12 inches (15-30 cm) from the surface, depending on the desired coverage and paint type.
4. **Even Strokes:** Move the sprayer in smooth, even strokes, overlapping each pass slightly to ensure uniform coverage. Avoid tilting the sprayer excessively to prevent paint starvation or uneven application.
5. **Anti-Backflow Feature:** The anti-backflow design allows for spraying ceilings and other overhead surfaces without paint leaking back into the unit.



The adjustable flow regulator and various spray patterns: Circular (45° for corners/edges), Vertical (180° for vertical spraying), and Horizontal (90° for horizontal spraying).

6. **Applications:** This sprayer is suitable for a wide range of indoor and outdoor projects, including painting fences, doors, furniture, cabinets, walls, and ceilings.

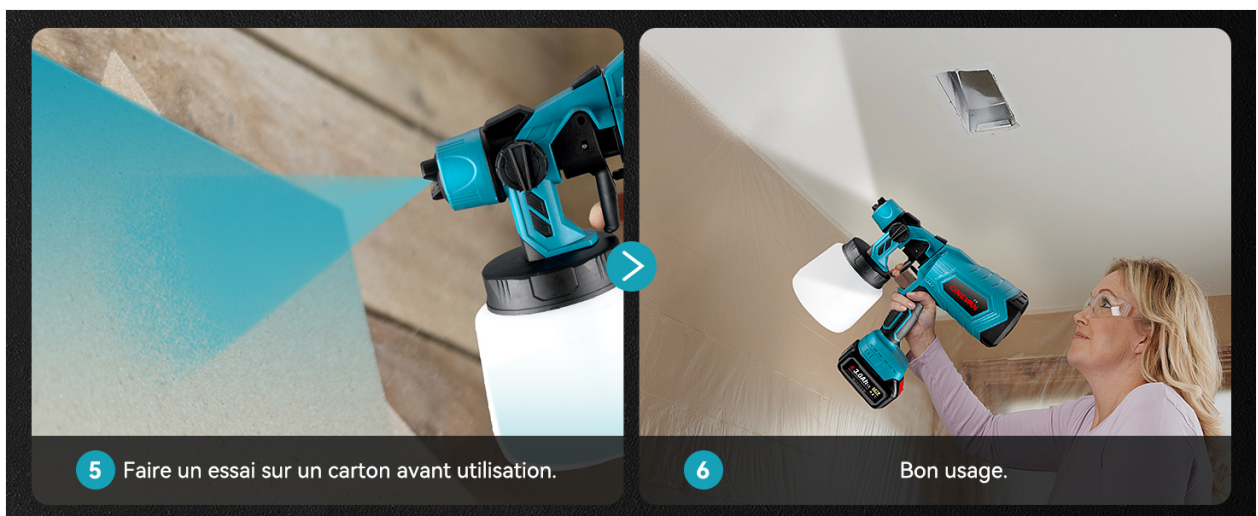

Step 5: Perform a test spray on cardboard before use. Step 6: Example of proper usage, including spraying a ceiling.

7. MAINTENANCE AND CLEANING

Proper cleaning after each use is crucial for maintaining the sprayer's performance and extending its lifespan.

1. **Disconnect Power:** Always remove the battery before cleaning or performing any maintenance.
2. **Empty Container:** Empty any remaining paint from the 1000ml container back into its original can.
3. **Disassemble:** Unscrew the paint container and remove the nozzle assembly. The sprayer's design allows for easy disassembly by rotating and pushing the front section.



Disassembly mechanism: Rotate 90 degrees and push to separate the front section from the main body for cleaning.

4. **Clean Components:** Wash the paint container, nozzles, and other paint-contacting parts thoroughly with warm soapy water or an appropriate cleaning solvent for the type of paint used. Use the provided cleaning brush and needle to clear any blockages in the nozzles.



Cleaning the nozzles and paint container in water to prevent clogging and ensure longevity.

5. **Wipe Down:** Wipe the exterior of the sprayer unit with a damp cloth. Do not immerse the main motor unit in water.
6. **Dry and Store:** Ensure all parts are completely dry before reassembling. Store the sprayer and its components in a clean, dry place.

8. TROUBLESHOOTING

If you encounter issues with your paint sprayer, refer to the following common problems and solutions:

Problem	Possible Cause	Solution
No spray or weak spray	Clogged nozzle; Insufficient paint dilution; Low battery; Air cap not properly aligned.	Clean nozzle with needle; Dilute paint further; Recharge or replace battery; Adjust air cap.

Problem	Possible Cause	Solution
Uneven spray pattern	Incorrect nozzle selection; Air cap misalignment; Inconsistent spraying distance.	Select appropriate nozzle; Adjust air cap; Maintain consistent distance and speed.
Paint leaks from nozzle or container	Loose connections; Damaged seals; Overfilled container.	Tighten all connections; Inspect and replace seals if damaged; Do not overfill container.
Sprayer motor not running	Battery not inserted correctly; Battery discharged; Faulty switch.	Ensure battery is fully inserted; Recharge battery; Contact customer support if switch is faulty.

If the problem persists after attempting these solutions, please contact customer support.

9. SPECIFICATIONS

Feature	Specification
Model Number	sku005270
Dimensions (L x W x H)	22 x 22 x 26.5 cm
Weight	2.6 kg
Power Source	Battery Powered
Battery Type	2 x Lithium-ion (3000 mAh each)
Tank Volume	1000 ml
Nozzle Sizes	1.0 mm, 1.8 mm, 2.5 mm (Copper)
Max Viscosity	80 Din-s
Max Pressure	12 PSI
Material	Plastic, Metal, Copper
Recommended Use	Painting

10. WARRANTY AND SUPPORT

ONEVAN products are manufactured to high-quality standards. For warranty information, please refer to the documentation provided with your purchase or contact your retailer. If you have any questions, require technical assistance, or need to report a problem, please contact ONEVAN customer support through the retailer's platform or the official brand website.