

HUTAKUZE OL061

HUTAKUZE Permanent Outdoor Lights User Manual

Model: OL061

1. INTRODUCTION

Thank you for choosing HUTAKUZE Permanent Outdoor Lights. This product is designed to provide versatile and vibrant outdoor lighting for various occasions and decorative purposes. Featuring smart control options, a wide range of scene modes, and durable construction, these lights enhance the aesthetic appeal of your outdoor spaces. Please read this manual thoroughly before installation and use to ensure proper operation and longevity of your lights.

2. SAFETY INFORMATION

- Ensure the power supply and controller are protected from water, as they are not waterproof. Only the eave lights themselves are IP67 waterproof.
- Do not cut the eave lights. Modifying the light string can damage the product and void the warranty.
- Verify that the installation surface is clean and dry before applying adhesive or mounting clips.
- Operate the lights within the specified temperature range of -4°F to 140°F (-20°C to 60°C).
- Keep the product away from flammable materials.
- For outdoor use only.

3. PACKAGE CONTENTS

Carefully unpack the box and ensure all items listed below are present and in good condition:

- 100FT Eaves Light String (60 LED lights) x 1
- Power Supply x 1
- Mounting Screws x 35
- Spare 3M Glue x 3
- Remote Control x 1
- Control Box x 1

- User Manual x 1
- 10FT Lamp Connection Extension Line x 1

Outdoor Waterproof Eaves Light Product List



- 100FT Eaves Light String X1
- Power Supply X1
- Mounting Screws X35
- Spare 3M Glue X3
- Remote Control X1
- Control Box X1
- User Manual X1
- 10FT Lamp Connection Extension Line X1



Image: Package contents for the HUTAKUZE Permanent Outdoor Lights.

4. PRODUCT FEATURES

- **Dynamic Lighting Effects:** Offers 48 scene modes and 16 million colors, creating a unique triangular lighting effect.
- **Smart Control:** Compatible with the Smart Life app (2.4GHz WiFi required), Alexa, and Google Assistant for voice control and remote management.
- **Durable for Outdoor Use:** IP67 waterproof rating for the lights (power supply and controller are not waterproof), UV-resistant materials, and operational in temperatures from -4°F to 140°F.
- **Long Lifespan:** LED beads designed for up to 50,000 hours of operation.
- **Easy Installation:** Features VHB glue and clips for secure mounting, with a recommended distance of 2-4 inches from the wall.
- **Music Synchronization:** Lights can synchronize with music to enhance atmosphere.

- **Timer Function:** Schedule lights to turn on/off automatically.



Applicable Scenes

Suitable for villa exterior walls, eaves, lawns, camping, bars, parties, and other decorative scenarios



IP67 waterproof



Snow resistant



Sun resistant



Plug and play

Image: Demonstrates the lights' resistance to various weather conditions, including rain, snow, and sun.

Easy to Install

1

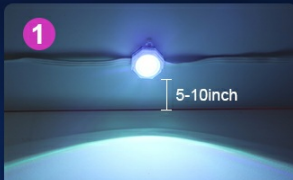

Please install 5-10 cm permanent outdoor light to stay away from the surface of the wall.

2



Before installing the strings, clean the surface with cloth or paper towels.

3



Fall off from the VHB gum on the back of the light.

4



Press the light firmly on the surface for more than 5 seconds.

5



The screws on both sides of each light are locked with screws.

6

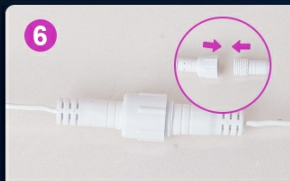

Connect 2 permanent outdoor light through the waterproof connector and screw into the lid

7



Definitely tighten the waterproof connector cover of the last string lamp part

5. INSTALLATION GUIDE

Follow these steps for proper installation of your HUTAKUZE Permanent Outdoor Lights:

1. **Plan Placement:** Determine the desired location for your lights. Ensure each light is installed 2-4 inches (5-10 cm) away from the wall surface to achieve the optimal lighting effect.
2. **Prepare Surface:** Clean the installation surface thoroughly with a cloth or paper towels to remove any dust, dirt, or moisture. A clean surface ensures maximum adhesion.
3. **Apply Adhesive:** Peel off the protective film from the VHB glue on the back of each light.
4. **Attach Lights:** Press each light firmly onto the cleaned surface for more than 5 seconds to ensure strong adhesion.
5. **Secure with Screws:** For enhanced stability, use the provided mounting screws. The screws on both sides of each light are designed to lock the lights securely in place.
6. **Connect Light Strings:** If using multiple light strings, connect them using the waterproof connectors. Ensure the connectors are tightly screwed to prevent water ingress. The maximum length supported by a single controller is 100 feet.
7. **Connect to Power:** Connect the light string to the control box, and then connect the control box to the power supply. Plug the power supply into a suitable outdoor power outlet.



Image: Step-by-step visual instructions for light installation.

Infrared remote control
Better control anytime,
anywhere!

Smooth and simple operation with different scene modes, one-touch adjustment

OFF — ON

Mode +/- — Luminance +/-

Speed +/- — Static Color

Turn off after 1 hour
Turn off after 2 hour
Turn off after 3 hour
Turn off after 4 hour

Music Mode 1 — Warm Light

Dynamic Mode — 7 Color Switches

Pause Key — Music Mode 2

2.4G RF

Image: Illustrates the benefit of dual fixation (adhesive and screws) for secure installation.

6. OPERATION GUIDE

6.1. Smart Life App Control

Download the Smart Life app from your smartphone's app store. Follow the in-app instructions to pair your HUTAKUZE lights. Ensure your Wi-Fi network is 2.4GHz for successful pairing.

- **Scene Modes:** Choose from 48 pre-set scene modes or create custom lighting effects using the DIY mode.
- **Color Selection:** Access 16 million colors to customize your lighting.
- **Music Sync:** Enable music synchronization for dynamic light displays that react to audio.
- **Timer Function:** Set schedules for automatic on/off times.

6.2. Voice Control (Alexa & Google Assistant)

Once paired with the Smart Life app, you can link your lights to Amazon Alexa or Google Assistant for convenient voice control. Refer to the Smart Life app's integration section for detailed instructions on connecting to these voice assistants.

6.3. Remote Control

The included infrared remote control provides quick access to essential functions:

- **Power On/Off:** Turn the lights on or off.
- **Mode Selection:** Cycle through various scene modes.
- **Brightness Adjustment:** Increase or decrease light intensity.
- **Color Selection:** Select static colors (Red, Green, Blue, White, Multicolor).
- **Timer Settings:** Set auto-off timers (1, 2, 3, 4 hours).
- **Music Modes:** Activate music synchronization modes.

Remote Control + Mobile App Control

16 million colors and 48 scene modes for holiday decorations



Image: Demonstrates both mobile app and remote control options for the lights.

TIMER FUNCTION



Auto ON 8:00 PM



Auto OFF 8:00 AM

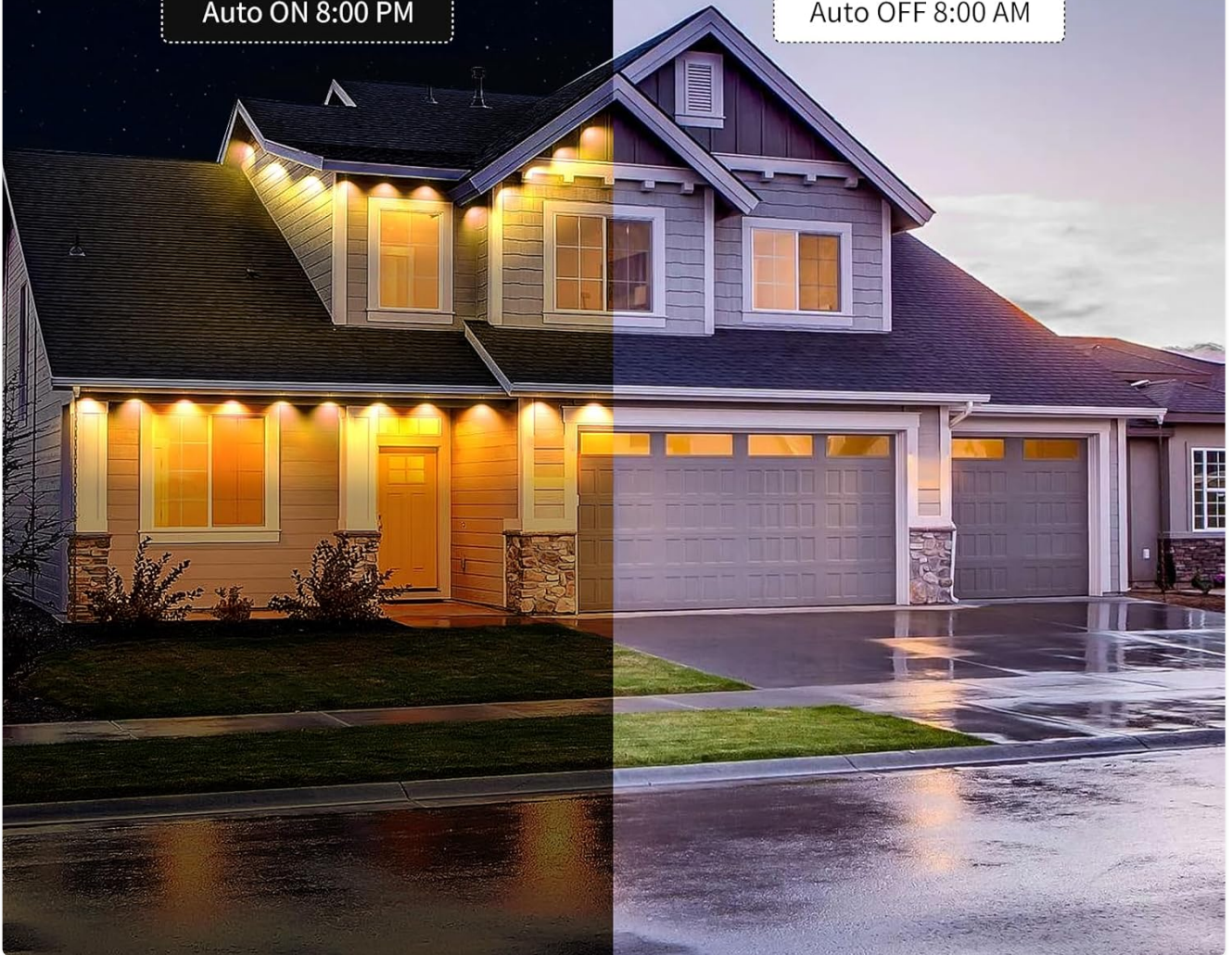

Image: Visual representation of the timer function, showing lights turning on and off automatically.

Synchronize with music, creating a vibrant atmosphere



Image: Illustrates the music synchronization feature, creating a vibrant atmosphere.



Image: Example of lights used for Halloween decoration.



Image: Example of lights used for Christmas decoration.

7. MAINTENANCE

- **Cleaning:** Gently wipe the light surfaces with a soft, damp cloth. Avoid using harsh chemicals or abrasive cleaners.
- **Inspection:** Periodically check the light string, power supply, and connections for any signs of damage or wear. Ensure all waterproof connectors are securely tightened.
- **Storage:** If storing the lights for an extended period, ensure they are clean and dry. Coil the light string neatly to prevent tangling and damage. Store in a cool, dry place.

8. TROUBLESHOOTING

Issue	Possible Cause	Solution
Lights do not turn on.	No power, loose connection, faulty power supply.	Check if the power supply is plugged in correctly. Ensure all connections are secure. Test the outlet with another device.
Cannot connect to Smart Life app.	Incorrect Wi-Fi band, weak signal, incorrect pairing mode.	Ensure your router is broadcasting a 2.4GHz Wi-Fi signal. Move closer to the router. Follow the app's pairing instructions carefully, ensuring the lights are in pairing mode.
Remote control not working.	Battery depleted, obstruction, out of range.	Replace the remote control battery. Ensure there are no obstructions between the remote and the control box. Operate within the specified range (20-30ft).
Lights flicker or display incorrect colors.	Loose connection, power fluctuation, software glitch.	Check all physical connections. Restart the lights by unplugging and replugging the power supply. Update the Smart Life app if an update is available.
Partial light string not working.	Damaged section, loose connector.	Inspect the non-working section for visible damage. Ensure the waterproof connectors between light segments are tightly secured.

9. SPECIFICATIONS

Feature	Specification
Product Name	100ft Permanent Outdoor Light
Model Number	OL061
Product Material	ABS+PC (Polycarbonate)
Output Voltage	DC24V 2A
Input Voltage	AC100-240V
Maximum Power	52W
Working Temperature	-4°F to 140°F (-20°C to 60°C)
Waterproof Grade	IP67 (Lights only; power supply and controller are not waterproof)
Remote Control Distance	20ft-30ft
Wall Washing Depth	Greater than 16 inches
Lifespan	Up to 50,000 hours
Number of Lights	60 LED lights
Controller Type	App Control, Voice Control
Light Source Type	LED
Light Color	Multicolor (RGB)
Special Features	Color Changing, Dimmable, Timer



Image: Detailed product specifications table.

10. WARRANTY AND SUPPORT

HUTAKUZE is committed to providing high-quality products. For warranty information, technical support, or any questions

regarding your Permanent Outdoor Lights, please refer to the contact information provided on the product packaging or visit the official HUTAKUZE website. Please retain your proof of purchase for warranty claims.