

Manuals+

[Q & A](#) | [Deep Search](#) | [Upload](#)

manuals.plus /

- › [Antec](#) /
- › [Antec FLUX Wood PC Case Instruction Manual](#)

Antec FLUX

Antec FLUX Wood PC Case Instruction Manual

Model: FLUX

Brand: Antec

INTRODUCTION

The Antec FLUX Wood PC Case is designed for optimal airflow and component compatibility, featuring a unique combination of metal, glass, and walnut wood. This manual provides essential information for setting up, operating, and maintaining your PC case.



Figure 1: Antec FLUX Wood PC Case, showcasing its elegant design with a tempered glass side panel and a distinctive walnut wood front panel.

Key Features:

- Crafted with a combination of metal, glass and wood to create a high-quality texture with different materials.
- Multi-directional vent design creates a dedicated Antec Flux airflow channel.
- Supports up to 9 fans simultaneously, with pre-installed 3 x P12 PWM at the front & 1 x P12R PWM reverse fan at the power supply chamber & 1 x P14 PWM in the rear.
- Supports simultaneous installation of Front 360mm radiator + Top 360mm radiator or Front 420mm radiator +

Top 280mm radiator.

- Widely supports various back-connect motherboards available on the market.

SETUP AND INSTALLATION

This section guides you through the initial setup and component installation process for your Antec FLUX Wood PC case.

Tool-Free Panel Design

The case features a tool-free panel design for easy access to internal components. The top panel, left glass panel, and right metal panel can be removed without tools.



Figure 2: Exploded view illustrating the tool-free removal of the top, left glass, and right metal panels for convenient access.

Motherboard and Component Installation

The spacious interior accommodates E-ATX (≤ 330 mm), ATX, Micro-ATX, and ITX motherboards. Ensure your CPU cooler height is ≤ 180 mm and GPU length is ≤ 408 mm for compatibility.

EXTENSIVE INTERIOR

- | | |
|-------------------------|--------------------------------------------|
| • Motherboard support | E-ATX(≤ 330 mm), ATX, Micro-ATX, ITX |
| • CPU cooler max height | ≤ 180 mm |
| • GPU max length | ≤ 408 mm |

- | | |
|-------------------------------------------------------------------|-------|
| • Power Supply max length (Include cable) ≤ 235 mm(with HDD) | |
| • 3.5" / 2.5" | 2 / 2 |
| • 2.5" | 1 |

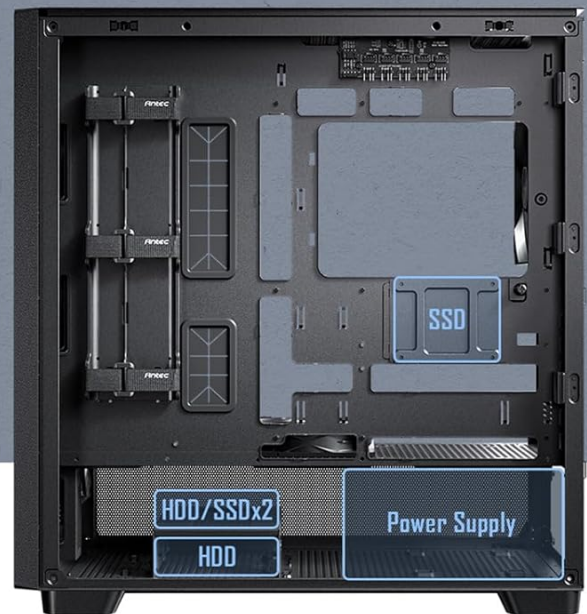
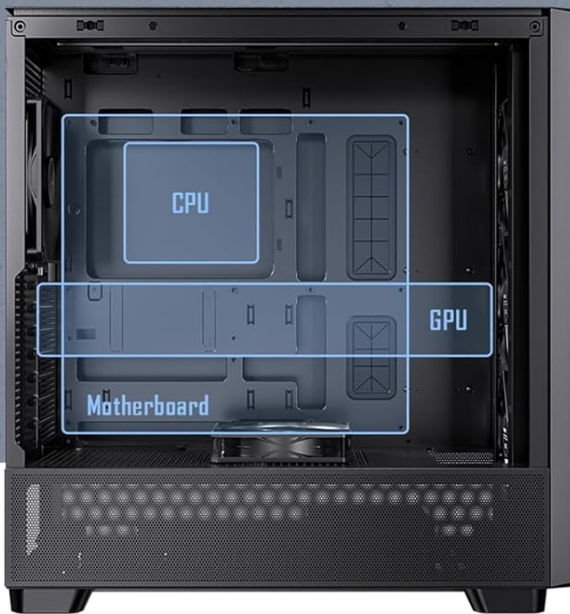

Figure 3: Internal layout highlighting areas for motherboard, CPU, and GPU installation, demonstrating the extensive interior space.

The case supports back-connect motherboards, allowing cables to be plugged in from behind for a cleaner look and smoother airflow. Supported models include ASUS TUF B760M-BTF WIFI D4, ASUS TX GAMING B760-BTF WIFI, and others.

SUPPORT BACK-CONNECT MOTHERBOARDS



Plug in cables from behind to give front a cleaner look and a smoother airflow channel.

**Supported models:*

ASUS TUF B760M-BTF WIFI D4,
ASUS TX GAMING B760-BTF WIFI,
ASUS DIY-APE B760 REVOLUTION,
MSI B760M PROJECT ZERO,
MSI B650M PROJECT ZERO,
Colorful CVN B760M FROZEN WIFI V20,
and more to come.

Figure 4: Illustration of back-connect motherboard support, enabling hidden cable routing for improved aesthetics and airflow.

Cooling System Setup

The FLUX case comes with 5 pre-installed high-performance PWM fans: 3 x P12 PWM at the front, 1 x P12R PWM reverse fan at the power supply chamber, and 1 x P14 PWM in the rear. It supports up to 9 fans simultaneously.

FLUX AIRFLOW

Multi-directional vent design, featuring extensive air intakes at the bottom, power supply chamber and lower sides, along with top vents and large-area mesh at the front, creating a dedicated Antec Flux airflow channel.



1 X P14

140mm PWM
regular fan



1 X P12 Reverse

120mm PWM fan



3 X P12

120mm PWM
regular fans

Figure 5: Visual representation of the FLUX airflow, detailing the placement and type of pre-installed fans for efficient cooling.

For liquid cooling, the case supports simultaneous installation of a Front 360mm radiator + Top 360mm radiator, or a Front 420mm radiator + Top 280mm radiator.



Figure 6: Radiator support configurations, including options for 360mm and 420mm radiators in the front and top positions.

The removable top cooling bracket simplifies radiator and fan installation. Mount fans/radiators onto the bracket first, then install the bracket back into the case.

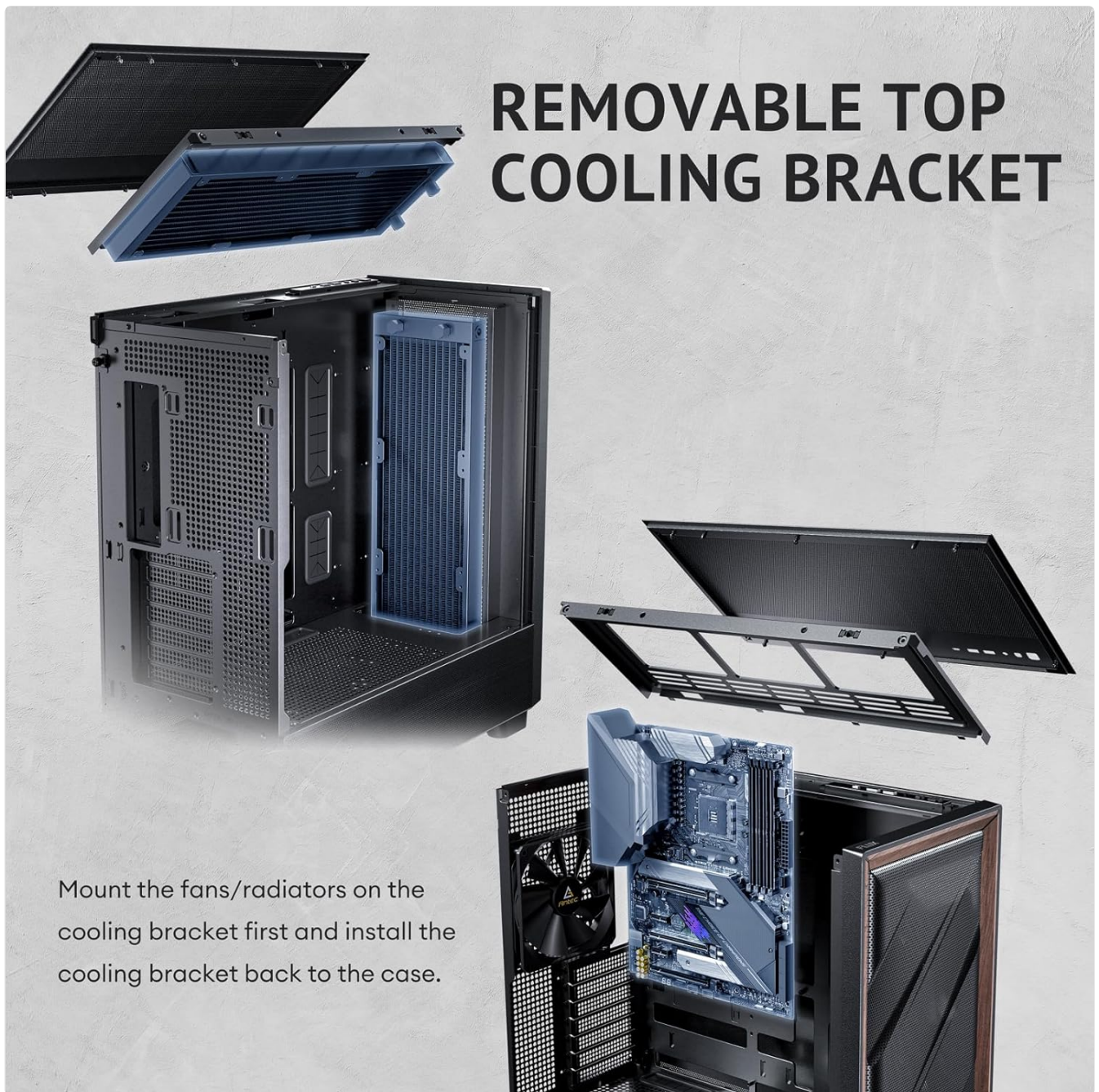

Figure 7: The removable top cooling bracket, designed to streamline the installation of fans and radiators.

OPERATING

The I/O panel is conveniently located on the top of the case and includes a Type-C 10Gbps port, two USB 3.0 ports, a Headphone/Mic Combo Jack, a Reset button, and a Power button. Dust plugs are included to protect unused ports.

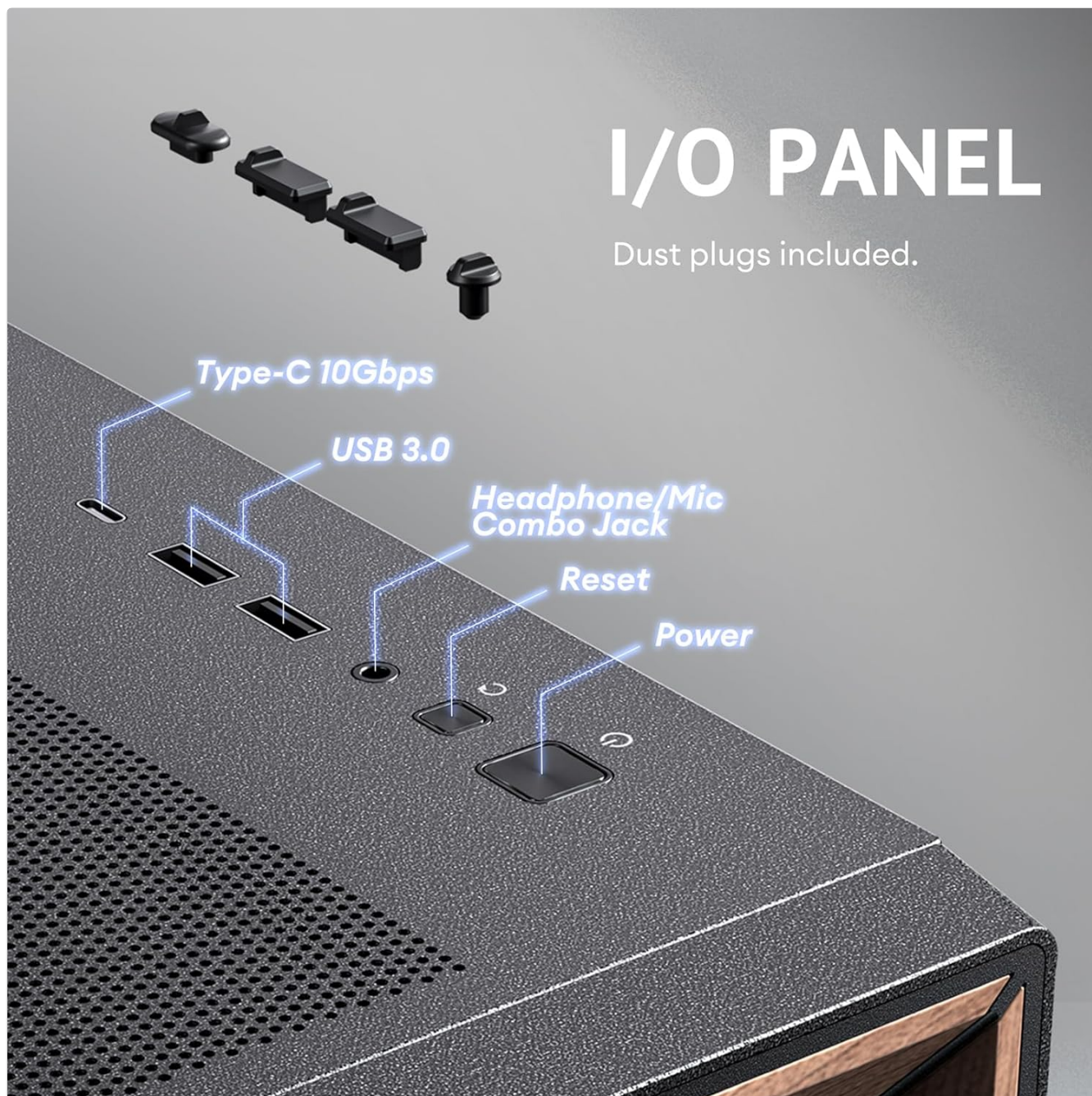

Figure 8: Detailed view of the top I/O panel, showing all available ports and controls for easy access.

The case features a built-in ARGB & PWM fan control hub that syncs with your motherboard, allowing for centralized control of fan speeds and lighting (if compatible ARGB fans are installed).

WITH BUILT-IN ARGB & PWM FAN CONTROL HUB IN SYNC WITH M/B



Figure 9: The integrated ARGB & PWM fan control hub, simplifying fan management and synchronization with the motherboard.

MAINTENANCE

To ensure optimal performance and longevity of your PC components, regular maintenance of the case's dust filters is recommended. The Antec FLUX Wood case includes a bottom full-size pull-out dust filter for easy cleaning and strong dust prevention.



BOTTOM FULL-SIZE PULL-OUT DUST FILTER

For easy cleaning and strong dust prevention.

Figure 10: The convenient bottom full-size pull-out dust filter, designed for easy removal and cleaning to maintain optimal airflow.

Periodically remove and clean the dust filter to prevent dust buildup, which can impede airflow and affect cooling efficiency.

TROUBLESHOOTING

If you encounter issues with your Antec FLUX Wood PC case, consider the following common troubleshooting steps:

- **No Power:** Ensure all power cables are securely connected to the power supply, motherboard, and wall outlet. Check the power button connection to the motherboard.
- **Fans Not Spinning:** Verify that all fan cables are correctly connected to the fan control hub or motherboard headers. Check fan settings in your motherboard's BIOS/UEFI or fan control software.
- **Overheating Components:** Confirm that all fans are oriented correctly for optimal airflow (intake/exhaust). Clean dust filters regularly. Ensure proper thermal paste application on the CPU cooler.
- **I/O Panel Issues:** Check internal cable connections from the I/O panel to the motherboard. Ensure USB and audio headers are correctly seated.
- **Panel Removal Difficulty:** Refer to the "Tool-Free Panel Design" section and ensure no screws or latches are

preventing removal. Apply gentle, even pressure.

For persistent issues, consult the Antec support website or contact their customer service for further assistance.

SPECIFICATIONS

Feature	Detail
Brand	Antec
Model Name	FLUX
Item Model Number	FLUX
Product Dimensions (LxWxH)	19.05 x 19.76 x 9.4 inches
Item Weight	20.4 pounds (9.27 Kilograms)
Motherboard Compatibility	E-ATX (≤330 mm), ATX, Micro-ATX, ITX
Case Type	Mid Tower
Material	Metal
Cooling Method	Air
Pre-installed Fans	3 x P12 PWM (front), 1 x P12R PWM (PSU chamber), 1 x P14 PWM (rear)
Radiator Support	Front: 360mm/420mm; Top: 360mm/280mm
Max CPU Cooler Height	≤180 mm
Max GPU Length	≤408 mm
USB Ports	2 x USB 3.0, 1 x Type-C 10Gbps

WARRANTY AND SUPPORT

Antec provides a limited warranty for its products. Please refer to the official Antec website for detailed warranty terms and conditions specific to your region. For technical support, product inquiries, or warranty claims, please visit the [Antec Store on Amazon](#) or their official support channels.

Keep your proof of purchase for warranty validation.

Related Documents - FLUX

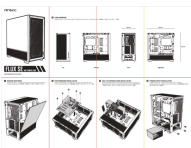

[Antec Flux SE PC Case User Manual and Overview](#)

Comprehensive guide to the Antec Flux SE mid-tower PC case, covering features, specifications, and installation instructions. Learn about its airflow design, cooling support, and build quality for optimal PC performance.

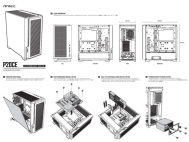
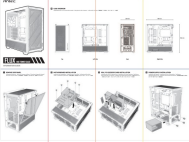
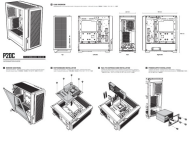
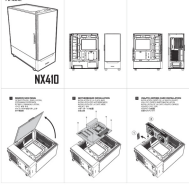
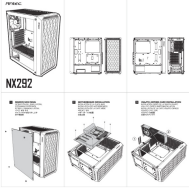
	<p>Antec P20CE PC Case User Manual and Specifications</p> <p>Comprehensive user manual and technical specifications for the Antec P20CE E-ATX gaming PC case. Learn about installation, features, cooling support, and component clearances.</p>
	<p>Antec Flux Mid Tower ATX PC Case User Manual</p> <p>Comprehensive user manual for the Antec Flux Mid Tower ATX PC Case, detailing features, specifications, installation guide, and maintenance tips for building a high-performance PC.</p>
	<p>Antec P20C Mid Tower Gaming PC Case - User Manual and Installation Guide</p> <p>Comprehensive user manual for the Antec P20C mid-tower PC case. Learn about its features, installation steps for motherboards, storage, cooling, GPUs, and front panel I/O. Includes specifications and maintenance tips.</p>
	<p>Antec NX410 ATX Mid-Tower PC Case - Installation Manual and Overview</p> <p>A comprehensive guide to the Antec NX410 ATX mid-tower computer case, covering specifications, features, and detailed installation instructions for PC builders. Learn how to assemble your system with this informational manual.</p>
	<p>Antec NX292 ATX Gaming PC Case - Manual and Overview</p> <p>User manual and overview for the Antec NX292 ATX mid-tower gaming PC case, highlighting its features like fixed RGB fans and tempered glass side panel, along with storage support for HDD and SSD.</p>