

HOLEWOR 5a329f52-7a4c-4814-bb7a-0a423ca5cad9

HOLEWOR Biometric Pistol Safe Instruction Manual

Model: 5a329f52-7a4c-4814-bb7a-0a423ca5cad9

INTRODUCTION

This manual provides comprehensive instructions for the safe and effective use of your HOLEWOR Biometric Pistol Safe. This safe is designed to provide secure storage for firearms while allowing quick access through biometric fingerprint recognition, a digital passcode, or a traditional key. Please read this manual thoroughly before installation and operation to ensure proper functionality and safety.

SAFETY INFORMATION

WARNING: Responsible firearm storage is critical to prevent accidents and unauthorized access, especially by children. Always store firearms unloaded and separate from ammunition if possible. Keep keys and access codes confidential and out of reach of unauthorized individuals.

- Ensure the safe is securely mounted according to the instructions to prevent removal.
- Never store loaded firearms in a manner that could lead to accidental discharge during access.
- Regularly check the battery level to ensure continuous operation.
- Do not share access codes or allow unauthorized individuals to register their fingerprints.

PEACE OF MIND



No Worries About Kids or Guests



Image: The HOLEWOR Biometric Pistol Safe mounted on a shelf, out of reach of a child, emphasizing secure storage.

PACKAGE CONTENTS

Verify that all items are present in the package:

- HOLEWOR Biometric Pistol Safe
- Mounting Hardware (screws, anchors)
- Emergency Override Keys (2)
- AA Batteries (4)
- Instruction Manual (this document)

SPECIFICATIONS

Feature	Detail
Brand	HOLEWOR
Model Number	5a329f52-7a4c-4814-bb7a-0a423ca5cad9
Product Dimensions	10.63"D x 3.23"W x 11"H
Lock Type	Biometric, Keypad, Key
Material	Alloy Steel
Item Weight	11.99 pounds
Power Source	4 AA Batteries (included)
Special Features	Slider Design, LCD Display (Temp & Humidity), LED Light, Silent Mode
Mounting Type	Wall Mount (Vertical)

STORE A PISTOL UP TO 8.5"

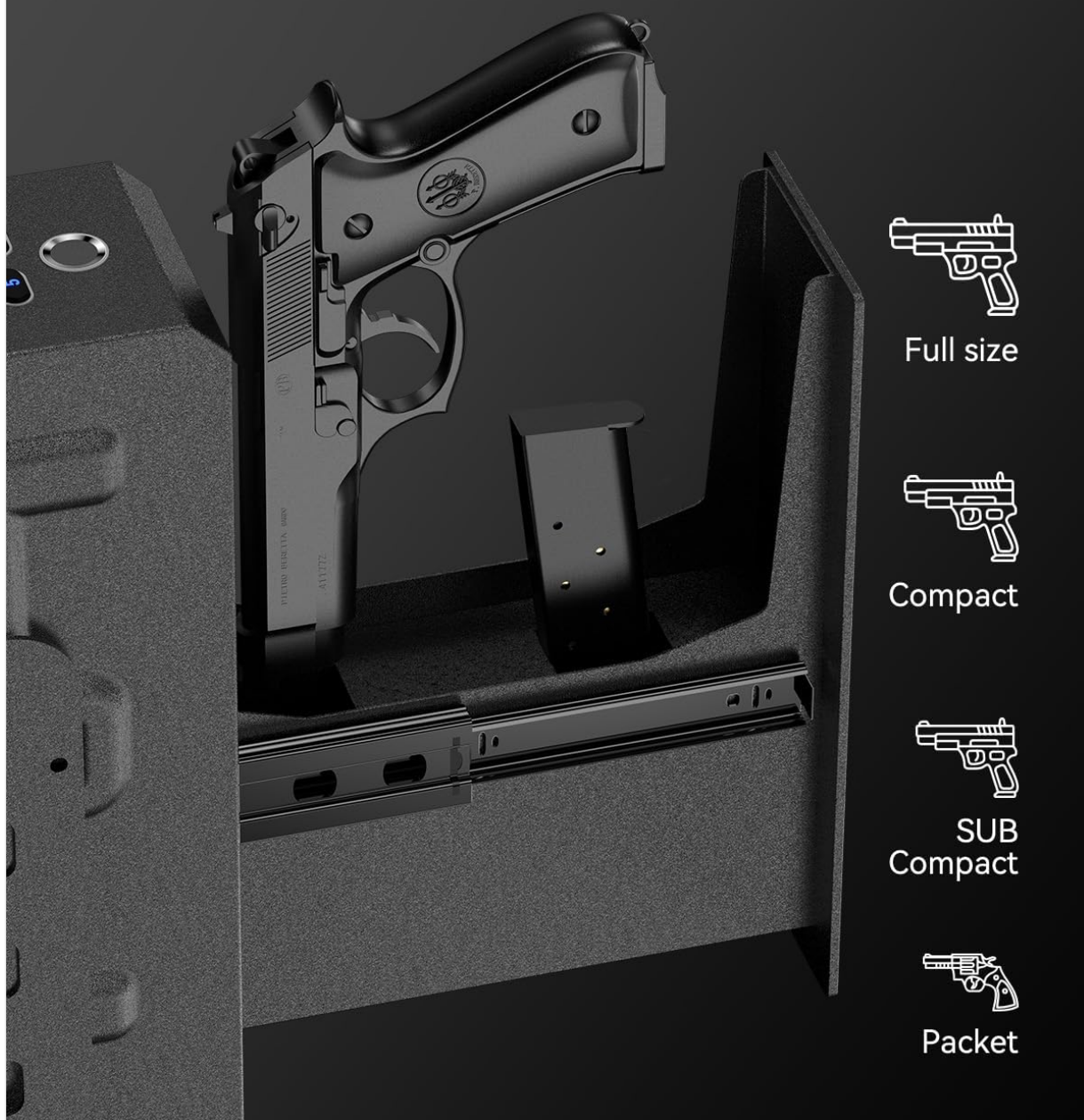

Image: The safe's interior capacity, capable of storing a pistol up to 8.5 inches in length.

SETUP

1. Battery Installation

1. Locate the battery compartment, typically on the back or underside of the safe.
2. Open the compartment cover.
3. Insert 4 AA batteries, ensuring correct polarity (+/-).
4. Close the battery compartment cover securely.
5. The LCD display should activate, indicating successful battery installation.

2. Mounting the Safe

The HOLEWOR Biometric Pistol Safe is designed for vertical mounting. The mounting bracket can be positioned for left or right-side access.

1. Choose a secure location for mounting, such as a nightstand, bed frame, desk, wall, or dresser. Ensure the surface is sturdy enough to support the safe's weight and contents.
2. Position the mounting bracket against the desired surface and mark the screw holes.
3. Drill pilot holes if necessary, then secure the mounting bracket using the provided screws and anchors.
4. Align the safe with the mounted bracket and slide it into place until it locks securely. Ensure there is no wiggling.



Image: Examples of the safe mounted vertically on a shelf, illustrating the ease of installation.



Image: The safe mounted to a nightstand for convenient bedside access.

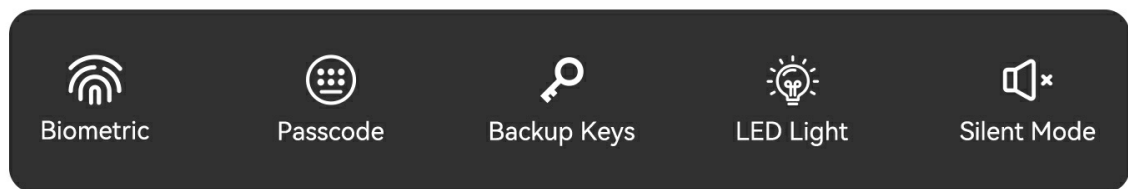

SIT UP FOR EASY GRABBING



Image: The safe mounted to a side wall, demonstrating flexible placement options.

OPERATING INSTRUCTIONS

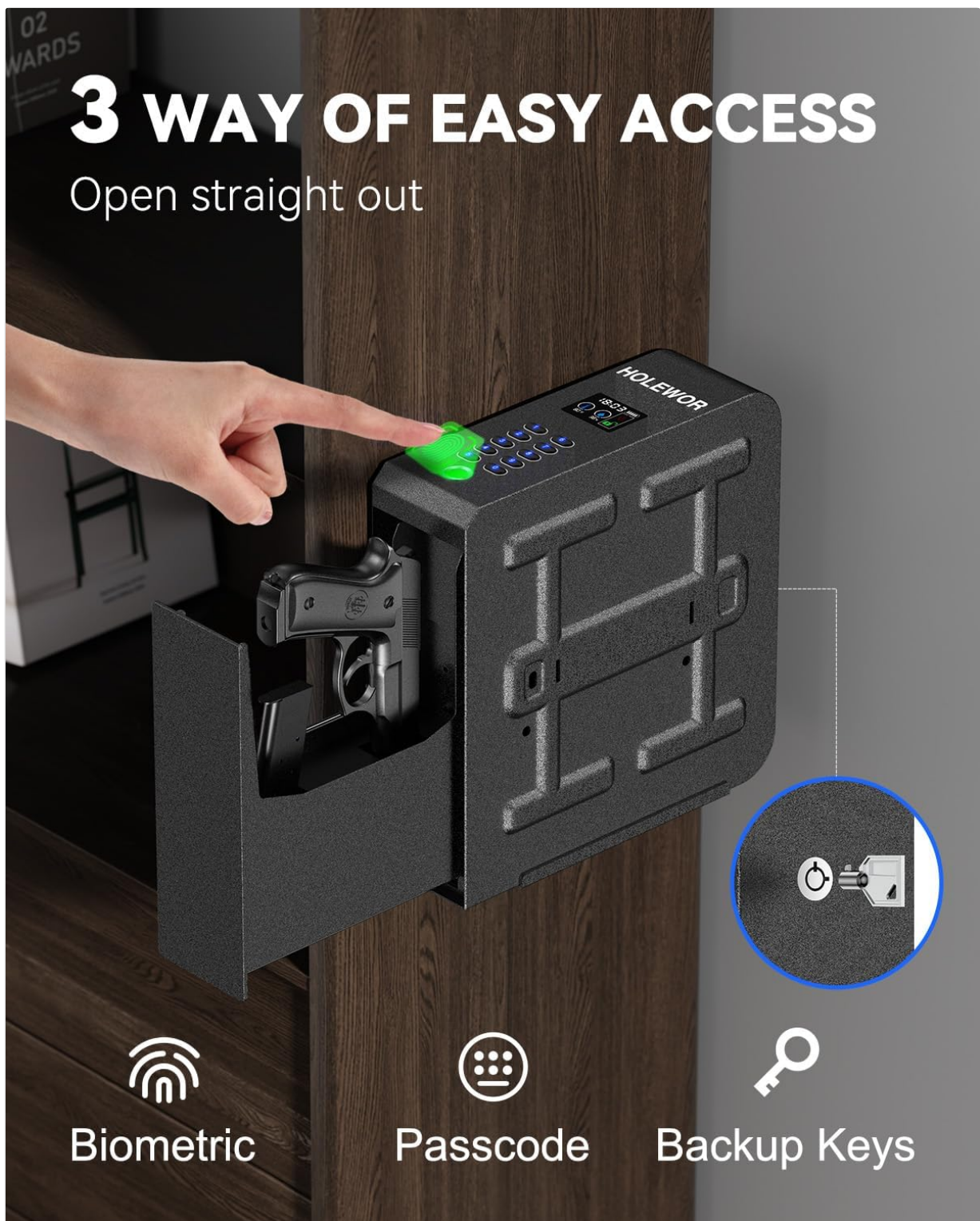

Image: Overview of the three access methods: fingerprint, passcode, and key.

1. Initial Setup (First Fingerprint & Passcode)

Upon first use or after a factory reset, you will need to register your primary fingerprint and set a passcode.

1. **Registering Fingerprint:** Follow the on-screen prompts or refer to the quick start guide for specific steps to register your fingerprint. Typically, this involves pressing the fingerprint sensor multiple times from different angles until registered.
2. **Setting Passcode:** Use the keypad to enter a desired passcode (e.g., 4-8 digits) and confirm it.

2. Biometric Fingerprint Access

1. Place your registered finger firmly on the fingerprint sensor.

2. The safe will verify your fingerprint. A green light and an audible beep (if not in silent mode) will indicate successful recognition.
3. The drawer will slide open, providing access to the firearm.

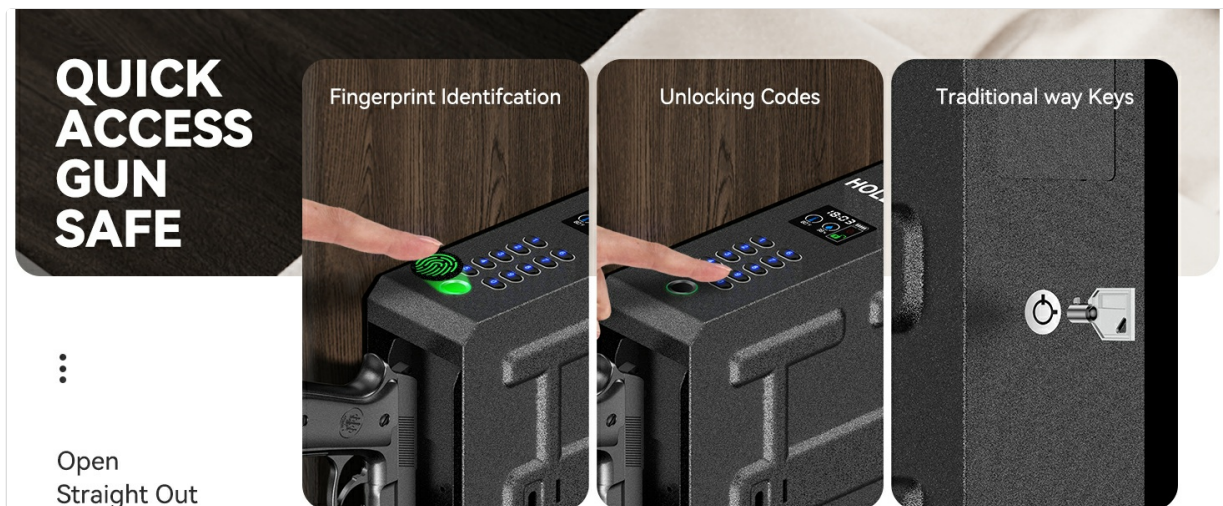

Image: Using biometric fingerprint for quick access.

3. Passcode Access

1. Enter your registered passcode using the keypad.
2. Press the confirmation button (usually '#' or 'Enter').
3. The safe will verify the passcode. A green light and an audible beep will indicate successful entry.
4. The drawer will slide open.



Image: Entering a passcode on the safe's keypad.

4. Key Access (Emergency Backup)

1. Locate the emergency keyhole, typically concealed on the safe.
2. Insert one of the provided backup keys into the keyhole.
3. Turn the key to unlock the safe.
4. The drawer will slide open.



Image: Using the physical key for emergency access.

5. LCD Display Features

The integrated LCD display provides important information:

- **Temperature:** Displays the internal temperature of the safe.
- **Humidity:** Shows the internal humidity level. If humidity is too high, consider adding desiccant packs.
- **Battery Level:** Indicates the current battery status, allowing timely replacement.

LCD OF TEMP & HUMIDITY



Image: The LCD display showing temperature, humidity, and battery status.

6. LED Light & Silent Mode

- **Internal LED Light:** The safe features an internal LED light that automatically illuminates when the drawer opens, providing visibility in low-light conditions. It typically stays on for approximately 10 seconds.
- **Silent Mode:** The safe can be set to silent mode to disable audible beeps during operation. Refer to the quick start guide for instructions on how to activate/deactivate silent mode. This feature is useful in situations where discretion is required.

LED LIGHT & SILENT MODE

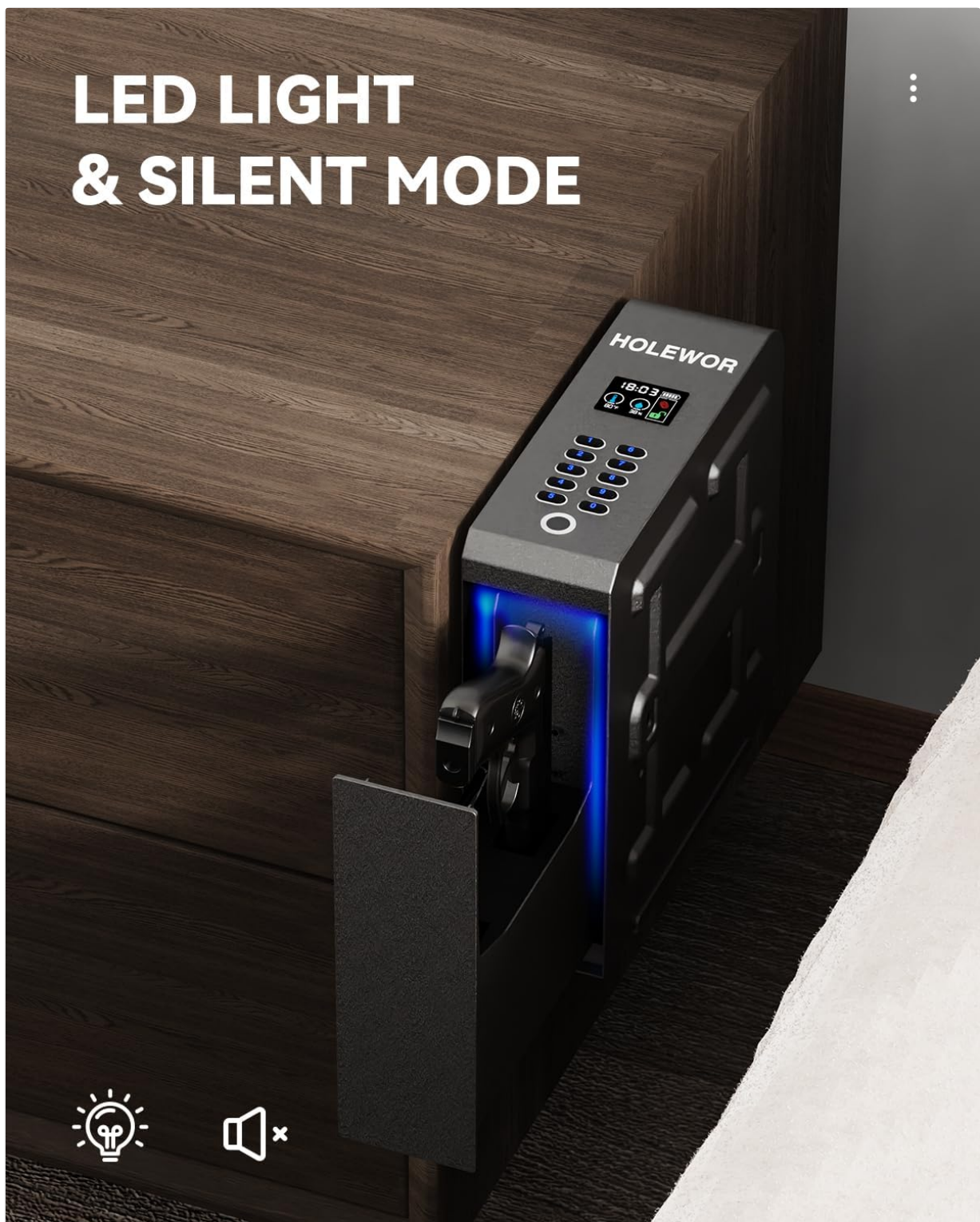

Image: The safe with its internal LED light active and indicators for silent mode.

MAINTENANCE

- **Battery Replacement:** When the LCD display indicates low battery, replace all 4 AA batteries promptly to ensure continuous functionality. Do not mix old and new batteries.
- **Humidity Control:** Monitor the humidity level on the LCD display. If it consistently reads high, consider placing a desiccant pack inside the safe to prevent moisture buildup, which can damage firearms.
- **Cleaning:** Wipe the exterior of the safe with a soft, dry cloth. Avoid abrasive cleaners or solvents. Keep the fingerprint sensor clean and free of debris.
- **Key Storage:** Store emergency keys in a secure location away from the safe, but accessible in case

of electronic failure or battery depletion.



TROUBLESHOOTING

- Safe Does Not Open with Fingerprint/Passcode:**
 - Ensure batteries are not low. Replace if necessary.
 - Ensure your finger is clean and dry, and placed correctly on the sensor.
 - Verify the passcode is entered correctly.
 - Use the emergency key as a backup.
- LCD Display Not Working:**
 - Check battery installation and replace batteries if needed.
- Drawer Does Not Slide Smoothly:**
 - Ensure no obstructions are blocking the drawer mechanism.
 - Check that the safe is mounted level and securely.

WARRANTY AND SUPPORT

For warranty information and customer support, please refer to the documentation provided with your purchase or contact HOLEWOR customer service directly. Specific warranty terms may vary by region and retailer.

Related Documents - 5a329f52-7a4c-4814-bb7a-0a423ca5cad9

<div> <div> HOLEWOR Biometric Pistol Safe User Manual </div> <div>  </div> <div> <small> Thank you for purchasing HOLEWOR Biometric Pistol Safe. Please read the user manual carefully before use and keep this manual for future reference. If you have any questions about the use of this product, please contact us at holerwor@alibaba.com. </small> </div> </div>	<div> HOLEWOR Biometric Pistol Safe User Manual </div> <div> Comprehensive user manual for the HOLEWOR Biometric Pistol Safe, detailing product contents, diagrams, unlock methods, fingerprint and password setup, time setting, low power prompts, external power, steel cable installation, and warranty information. </div>
<div> <div> HOLEWOR Biometric Pistol Safe User Manual </div> <div>  </div> <div> <small> Thank you for purchasing HOLEWOR Biometric Pistol Safe. Please read the user manual carefully before use and keep this manual for future reference. If you have any questions about the use of this product, please contact us at holerwor@alibaba.com. </small> </div> </div>	<div> HOLEWOR Biometric Pistol Safe: User Manual & Operating Guide </div> <div> Comprehensive user manual for the HOLEWOR Biometric Pistol Safe, detailing package contents, product features, setup instructions for passwords and fingerprints, security settings, external power options, steel cable installation, and warranty information. </div>

