

[Manuals.plus](#) /

> [MOZOTER](#) /

> MOZOTER S8 Mini Wireless Earbuds (Model DBK02) Instruction Manual

MOZOTER DBK02

MOZOTER S8 Mini Wireless Earbuds (Model DBK02) Instruction Manual

This manual provides detailed instructions for the setup, operation, and maintenance of your MOZOTER S8 Mini Wireless Earbuds.



Image: The MOZOTER S8 Mini Wireless Earbuds in black, displayed with their compact charging case.

INTRODUCTION

Thank you for choosing MOZOTER S8 Mini Wireless Earbuds. These earbuds are designed to provide a high-quality audio experience with advanced features such as Bluetooth 5.3 connectivity, intelligent touch controls, and a long-lasting battery. Please read this manual carefully to ensure proper use and to maximize the lifespan of your device.



Image: Overview of MOZOTER S8 Mini Wireless Earbuds features, including Bluetooth 5.3, IPX7 waterproofing, wireless charging case, 60-hour playtime, automatic pairing, voice assistant, and smart touch control.

Your browser does not support the video tag.

Video: An official overview of the MOZOTER S8 Mini Wireless Earbuds, showcasing their design and key features.

WHAT'S IN THE BOX

Please verify that all items are present in your package:

- Wireless Earbuds (Left and Right)
- Wireless Charging Case
- Type-C Charging Cable
- Eartips (Multiple Sizes: Small, Medium, Large)
- User Manual

PRODUCT OVERVIEW

The MOZOTER S8 Mini Wireless Earbuds feature a compact and lightweight design for enhanced portability and comfort during extended use. Each earbud weighs approximately 3.7 grams.

Mini Compact Design

Super Light Weight Easy to put into your pocket



Image: The MOZOTER S8 Mini Wireless Earbuds and their charging case, highlighting their small and lightweight form factor.

Super Light-weight Design

Mini Concealed, Smaller Than a Coin,
Hassle-free listening



Image: An exploded view diagram of a single earbud, detailing its internal structure and components.

SETUP

1. Charging the Earbuds and Case

Before initial use, ensure both the earbuds and the charging case are fully charged. Place the earbuds into the charging case. Connect the provided Type-C charging cable to the charging case and a compatible USB power source. The indicator lights on the case will display the charging status. The charging case also supports wireless charging.

Amazing Battery Life

Enjoy up to 60 hours all day music listening.



Image: The earbuds inside the charging case, illustrating battery life: 8 hours for earbuds on a single charge, 1.5 hours for case charging, and up to 60 hours total playtime with the charging case.

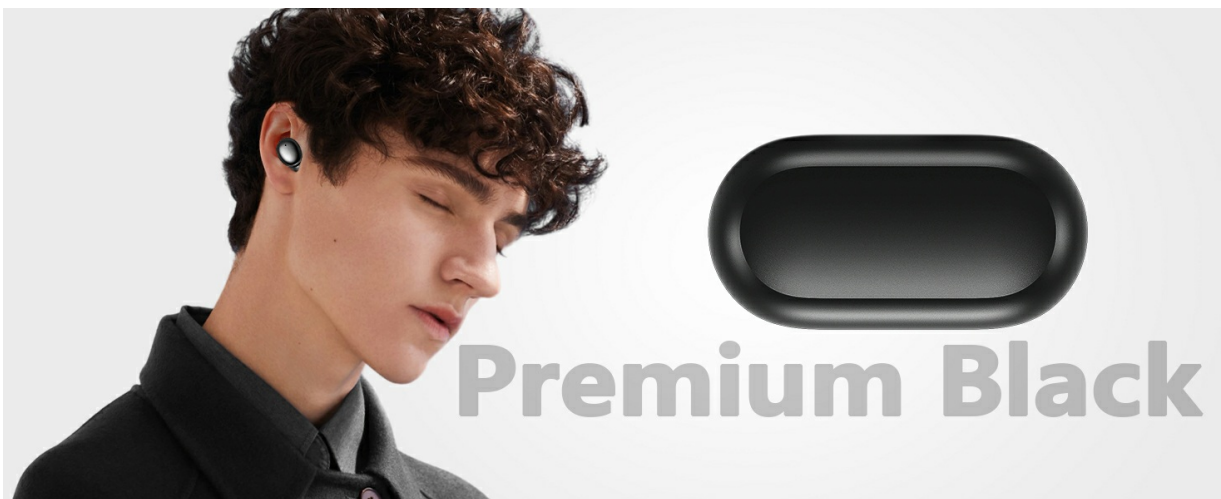

Image: The charging case demonstrating both wired (Type-C) and wireless charging capabilities.

2. Pairing with Your Device

The earbuds utilize Bluetooth 5.3 technology for fast and stable connections.

1. Ensure the earbuds are adequately charged.
2. Open the lid of the charging case. The earbuds will automatically power on and enter pairing mode.
3. On your smartphone, tablet, or computer, navigate to the Bluetooth settings and activate Bluetooth.
4. Locate "S8" in the list of available devices and select it to establish a connection.
5. Upon successful connection, a voice prompt will confirm pairing.

Note: After the initial pairing, the earbuds will automatically connect to the last paired device when the charging case lid is opened.

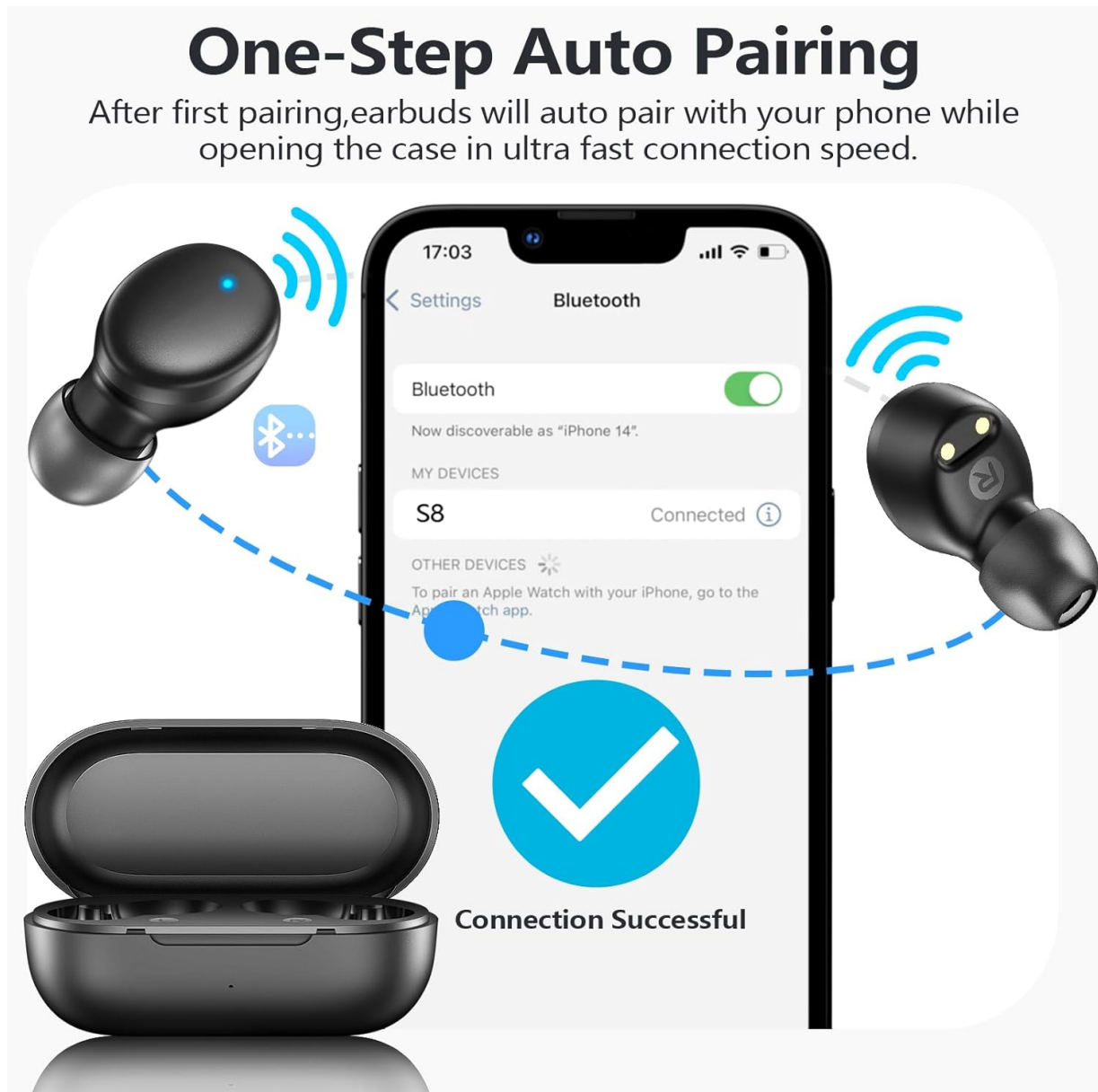

Image: A visual guide demonstrating the one-step auto-pairing process, showing earbuds connecting to a phone's Bluetooth settings.



Image: Illustration of the Bluetooth 5.3 technology, highlighting benefits such as lower latency, stable connection, and wide compatibility with various devices.

3. Fitting the Earbuds

For optimal sound quality and comfort, selecting the correct size eartips is crucial. The package includes three pairs of silicone eartips (Small, Medium, Large). Experiment to find the best fit for your ears.

1. Gently insert the earbud into your ear canal.
2. Rotate the earbud slightly until it feels secure and comfortable.
3. Ensure a snug fit to effectively reduce external noise and enhance bass response.



Comfortable, Feather-Light Fit

This S8 true wireless earbuds are lightweight with an ergonomic shape to fit comfortably in your ears for long listening sessions.

Image: A person comfortably wearing the earbuds, emphasizing their lightweight and ergonomic design for extended use.



Image: An illustration demonstrating the importance of selecting the correct eartip size for a secure and comfortable fit, which also aids in noise reduction.

OPERATING INSTRUCTIONS

1. Touch Controls

The earbuds feature intelligent touch controls for various functions. The touch-sensitive area is located on the outer surface of each earbud.

Function	Action
Play/Pause Music	Single tap on either earbud
Next Song	Double tap on the Right earbud
Previous Song	Double tap on the Left earbud
Volume Up	Triple tap on the Right earbud
Volume Down	Triple tap on the Left earbud
Answer/End Call	Single tap on either earbud
Reject Call	Press and hold either earbud for 2 seconds
Activate Voice Assistant (Siri/Google Assistant)	Press and hold either earbud for 3 seconds

2. Single Earbud Mode

Either earbud can be used independently. Simply take one earbud out of the charging case, and it will automatically connect to your device. The other earbud can remain in the case or be used by another person.

3. Sound Quality

The S8 earbuds feature a 10mm dynamic speaker designed to deliver a wide sound range with powerful deep bass, sweet mids, and crisp treble. Active Noise Cancellation is also integrated for an immersive listening experience.

Immersive HiFi Stereo Sound

13mm speaker presents you with delicate sound quality and deep sound field.



Image: A graphic representation of the earbuds' immersive HiFi stereo sound, emphasizing the 10mm speaker and its capabilities for high-fidelity audio and clear calls.

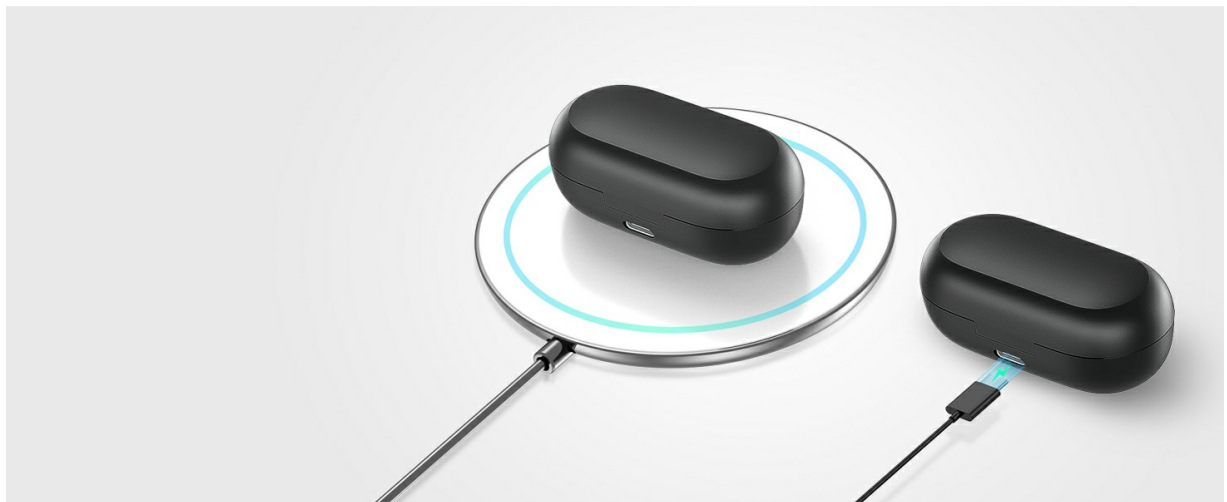

Image: A woman listening to music, accompanied by icons indicating the earbuds' sound profile: deep bass, sweet mids, and crisp treble.

MAINTENANCE

1. Cleaning

- Regularly clean the earbuds and charging case with a soft, dry, lint-free cloth.
- Remove eartips and clean them with mild soap and water if necessary. Ensure they are completely dry before reattaching.
- Do not use abrasive cleaners, alcohol, or solvents, as these may damage the device.

2. Storage

- Always store the earbuds in their charging case when not in use to protect them and maintain their charge.
- Avoid storing the device in areas with extreme temperatures (hot or cold) or high humidity.



Image: A hand placing the compact charging case into a pocket, illustrating its convenient portability for storage and travel.

3. Water Resistance

The earbuds are rated IPX7 water-resistant, meaning they can withstand immersion in water up to 1 meter for 30 minutes. This makes them suitable for workouts, light rain, and accidental splashes. However, they are not designed for swimming, showering, or prolonged water exposure. The charging case is not water-resistant and should be kept dry.



Image: The earbuds partially submerged in water, visually representing their IPX7 water resistance rating.

TROUBLESHOOTING

Problem	Solution
---------	----------

Earbuds not pairing	Ensure earbuds are charged. Place them back in the case, close the lid, then open it again to re-enter pairing mode. Check your device's Bluetooth settings and try reconnecting. If the issue persists, try forgetting the device from your Bluetooth list and re-pairing.
Only one earbud working	Place both earbuds back into the charging case, close the lid, then open it again. Ensure both earbuds are charged. If the issue persists, try resetting the earbuds (refer to the full user manual for specific reset instructions if available).
Low volume or poor sound quality	Adjust the volume on your device and the earbuds. Ensure eartips are clean and provide a snug fit. Try different eartip sizes for a better seal.
Earbuds not charging	Ensure the charging cable is securely connected to both the case and the power source. Check if the charging case itself has power. Clean the charging contacts on both the earbuds and the case with a dry cotton swab.
Bluetooth connection unstable or dropping	Ensure your device is within the 30-meter Bluetooth range and there are no significant obstacles (like thick walls) between the earbuds and your device. Disconnect and reconnect the earbuds from your device's Bluetooth settings. Avoid strong electromagnetic interference.

SPECIFICATIONS

- **Model:** DBK02
- **Bluetooth Version:** 5.3
- **Bluetooth Range:** Up to 30 meters (open space)
- **Earbud Battery Life:** Approximately 8 hours (single charge)
- **Total Playtime (with charging case):** Up to 60 hours
- **Charging Time (case):** Approximately 1.5 hours
- **Speaker Size:** 10mm Dynamic Driver
- **Frequency Range:** 20 Hz - 20,000 Hz
- **Impedance:** 16 Ohms
- **Water Resistance:** IPX7 (earbuds only)
- **Earbud Weight:** Approximately 3.7g per earbud
- **Control Type:** Touch Control
- **Microphone:** Built-in for calls and voice assistant
- **Noise Control:** Active Noise Cancellation
- **Compatible Devices:** iOS and Android smartphones, tablets, laptops, computers.

WARRANTY

The MOZOTER S8 Mini Wireless Earbuds come with a 1-year manufacturer's warranty from the date of purchase. This warranty covers manufacturing defects under normal use. It does not cover damage caused by misuse, accidents, unauthorized modifications, improper storage, or normal wear and tear. Please retain your proof of purchase for all warranty claims.

SUPPORT

For further assistance, technical support, or warranty inquiries, please contact MOZOTER customer service through the retailer where you purchased the product or visit the official MOZOTER website for contact information.