

[Manuals.plus](#) /

› [XYOP](#) /

› XYOP RGB Battery Operated LED Strip Lights User Manual (Model: XP-LED12-3J2P)

## XYOP XP-LED12-3J2P

# XYOP RGB Battery Operated LED Strip Lights User Manual

MODEL: XP-LED12-3J2P

## 1. Product Overview

---

The XYOP RGB Battery Operated LED Strip Lights provide versatile and portable lighting solutions. These flexible LED strips feature color-changing capabilities, multiple dynamic modes, and adjustable brightness, powered by AA batteries for convenient use in various indoor and outdoor settings. The product includes two 6.56FT (2M) LED strips, totaling 13.2FT (4M), each with its own battery box and 3-key controller.



Image: Overview of the XYOP RGB LED Strip Lights package contents, including two rolls of LED strips, two battery boxes with controllers, and a visual representation of available colors.

## 2. Package Contents

Verify that all items are present in the package:

- 2 x RGB LED Strip Lights (6.56FT / 2M each)
- 2 x Battery Boxes with Integrated 3-Key Controllers

**Note: 3 AA batteries are required for each battery box and are not included.**

## 3. Safety Information

- **Power Source:** Use only 3 AA batteries per battery box. Do not attempt to power the strips with higher voltage sources.
- **Water Resistance:** The LED strips are IP65 waterproof, suitable for outdoor use. However, the battery box is not fully waterproof and should be protected from direct water exposure.
- **Cutting:** Only cut the LED strip along the designated cutting marks (every 3 LEDs). Cutting elsewhere will damage the strip and may render sections inoperable.
- **Heat:** The LED strips operate at a low 5V voltage, producing minimal heat. Avoid covering the strips with

materials that could trap heat excessively.

- **Adhesive:** Ensure the installation surface is clean, dry, and flat before applying the adhesive to ensure proper adhesion and prevent the strip from falling.

## 4. Setup and Installation

1. **Insert Batteries:** Open the battery compartment on each battery box. Insert 3 AA batteries (not included) into each box, ensuring correct polarity. Close the compartment securely.
2. **Connect Strip to Battery Box:** Ensure the LED strip connector is securely plugged into the corresponding port on the battery box.

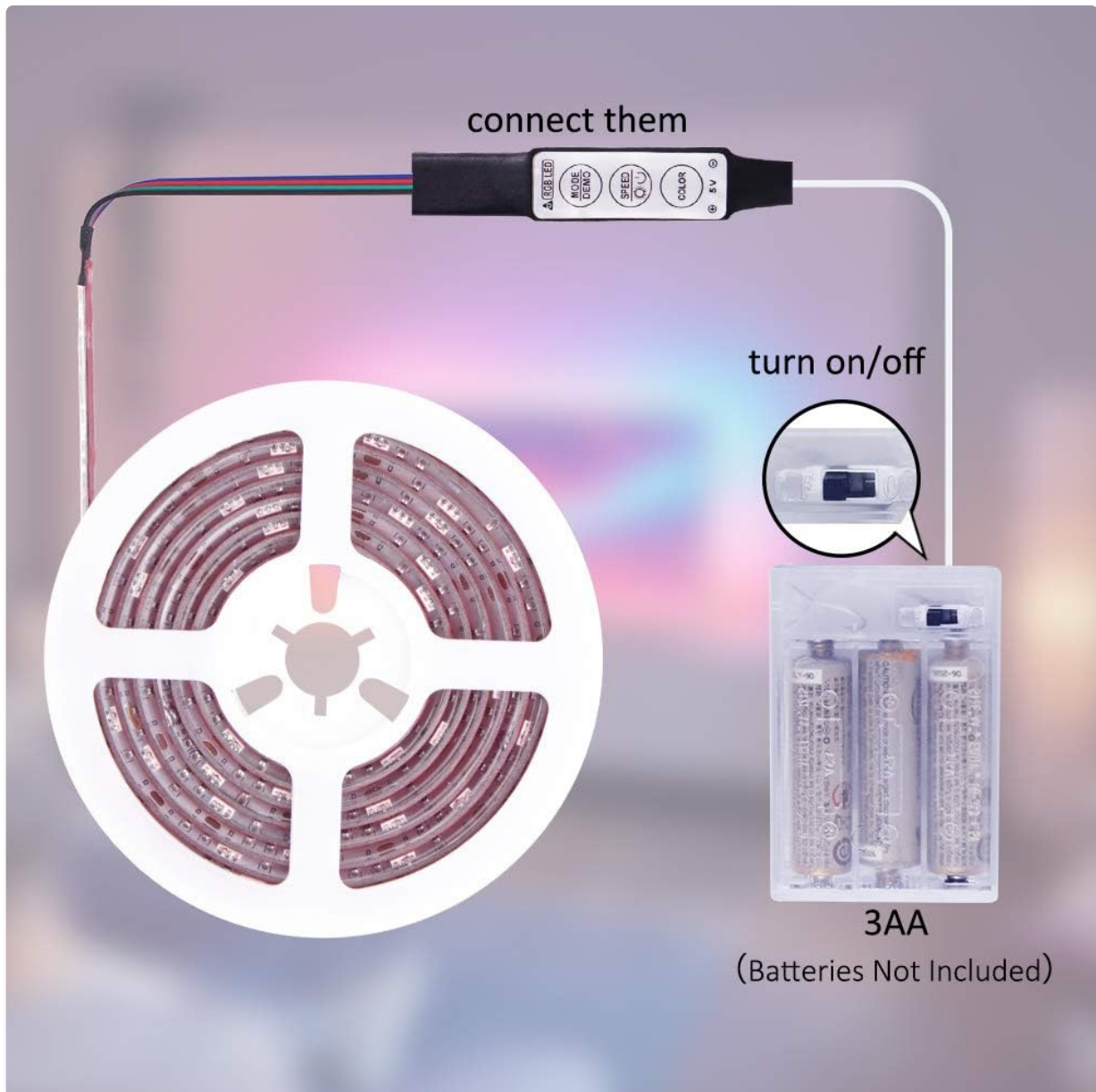

Image: Illustration of how to connect the LED strip to its battery box and activate the power switch.

3. **Prepare Surface:** Clean the desired installation surface thoroughly. Ensure it is dry, smooth, and free of dust or grease for optimal adhesive performance.
4. **Apply LED Strip:** Carefully peel off the protective backing from the adhesive tape on the back of the LED strip. Press the strip firmly onto the prepared surface. Avoid repositioning the strip multiple times, as this can weaken the adhesive.

Easy install with  
Super sticky



Can be cut every 3leds  
along the cutting



Install to any clean,  
dry or flat



2 Pack RGB led strip lights

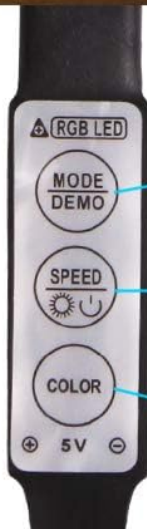

Image: Visual guide demonstrating the easy installation process, including peeling the adhesive, preparing the surface, and the ability to cut the strip.

- Cutting the Strip (Optional):** If a shorter length is desired, locate the copper cutting marks on the LED strip. Use scissors to cut only along these designated lines. Cutting elsewhere will damage the circuit.

## 5. Operating Instructions

Each battery box features an integrated 3-key controller to manage the LED strip's functions:



20 Dynamic Mode

Speed of Dynamic Mode-8 Level Brightness  
of Static Mode-8Level Long Press-OFF

20 Static Mode

Image: Detailed view of the 3-key controller, highlighting the functions of each button for mode, speed/brightness, and color selection.

- **Power On/Off:** Use the switch located on the side of the battery box to turn the LED strip on or off.
- **MODE Button:**
  - Press to cycle through 20 dynamic lighting modes (e.g., flash, fade, jump).
  - Long press to turn off the lights.
- **SPEED Button:**
  - When in a dynamic mode, press to adjust the speed of the effect (8 levels).
  - When in a static color mode, press to adjust the brightness (7 levels).
- **COLOR Button:**
  - Press to cycle through 20 static color options.



# 20 COLORS

20 Dynamic modes and 20 Static colors  
Take different experience for you



Image: Example of the LED strip lights displaying a static purple color, used for room ambiance.

## 6. Maintenance

- **Cleaning:** Gently wipe the LED strips with a soft, dry cloth to remove dust. Avoid using harsh chemicals or abrasive cleaners.
- **Battery Replacement:** When the lights dim significantly or stop working, replace all 3 AA batteries in the battery box with new ones. Ensure correct polarity.
- **Storage:** If storing the LED strips for an extended period, remove the batteries from the battery boxes to prevent leakage. Store in a cool, dry place.

## 7. Troubleshooting

| Issue | Possible Cause | Solution |
|-------|----------------|----------|
|-------|----------------|----------|

| Issue                                      | Possible Cause  | Solution  |
|--|---|---|
| Lights do not turn on.                     | Batteries are dead or incorrectly inserted. Connection between strip and battery box is loose. Power switch is off. | Replace batteries, ensuring correct polarity. Securely connect the LED strip to the battery box. Ensure the power switch on the battery box is in the 'ON' position.    |
| Lights are dim or flicker.                 | Low battery power.  | Replace batteries with new ones.  |
| A section of the strip is not lighting up. | The strip was cut incorrectly or damaged.   | Inspect the strip for physical damage or incorrect cuts. If damaged, the affected section may not be repairable. Ensure cuts are only made at designated marks.         |
| Adhesive is not sticking.                  | Surface was not clean, dry, or flat. Adhesive backing was not fully removed.  | Ensure the surface is thoroughly cleaned and dried before application. For best results, apply to a smooth, flat surface. Consider using additional adhesive if needed. |

## 8. Specifications

- **Model:** XP-LED12-3J2P
- **Light Type:** RGB LED Strip
- **Length:** 2 x 6.56FT (2M) strips, total 13.2FT (4M)
- **Power Source:** 3 x AA Batteries (per strip, not included)
- **Voltage:** 5V
- **Wattage:** 3.00W
- **Controller:** Integrated 3-Key Controller (MODE, SPEED, COLOR)
- **Dynamic Modes:** 20
- **Static Colors:** 20
- **Speed Levels:** 8 (for dynamic modes)
- **Brightness Levels:** 7 (for static colors)
- **Water Resistance:** IP65 (LED strip only, battery box is not fully waterproof)
- **Cuttable:** Yes, every 3 LEDs at designated marks
- **Material:** Metal, Vinyl
- **Item Weight:** 7.9 ounces (total for 2 strips)
- **Product Dimensions:** 8.66 x 6.69 x 1.97 inches (packaging)

## 9. Warranty and Support

For product support, troubleshooting assistance, or warranty inquiries, please contact the seller or manufacturer directly through your purchase platform. Please retain your proof of purchase for any warranty claims.

