



[Manuals.plus](#) /

› [NAIERDI](#) /

› NAIERDI Fingerprint Cabinet Lock KAK-JCDS User Manual

NAIERDI KAK-JCDS

NAIERDI Fingerprint Cabinet Lock KAK-JCDS User Manual

Model: KAK-JCDS

1. INTRODUCTION

Welcome to the user manual for your NAIERDI Fingerprint Cabinet Lock. This smart biometric lock provides keyless access and enhanced security for your cabinets and drawers. Designed for ease of use and reliable performance, it offers a convenient solution for protecting your belongings or ensuring child safety. Please read this manual thoroughly before installation and operation to ensure proper use and longevity of your device.



Image 1.1: The NAIERDI Fingerprint Cabinet Lock in operation, highlighting its biometric capabilities and quick response time.

2. IMPORTANT SAFETY INFORMATION

- This product is designed for indoor use only. Avoid exposure to water, moisture, or extreme temperatures.
- Do not attempt to disassemble, repair, or modify the lock. This may void the warranty and cause damage.
- Keep the lock away from strong magnetic fields.
- Ensure the battery is installed correctly according to polarity markings.
- Dispose of batteries responsibly according to local regulations.
- Use only the specified charging cable (Type-C) for emergency power.

3. PACKAGE CONTENTS

Please check the package for the following items:

- Fingerprint Lock Unit (Main Sensor)
- Lock Body (Battery Compartment and Latch Mechanism)
- Mounting Screws

- USB Type-C Charging Cable
- User Manual

4. PRODUCT OVERVIEW

Familiarize yourself with the components of your NAIERDI Fingerprint Cabinet Lock:

- **Fingerprint Sensor:** Located on the front of the lock unit, used for biometric authentication.
- **LED Indicator:** Provides visual feedback on lock status (e.g., unlocked, low battery, fingerprint registration).
- **USB Type-C Interface:** For emergency power supply.
- **Battery Compartment:** Houses the power source for the lock.
- **Latch Mechanism:** Secures the cabinet or drawer when locked.

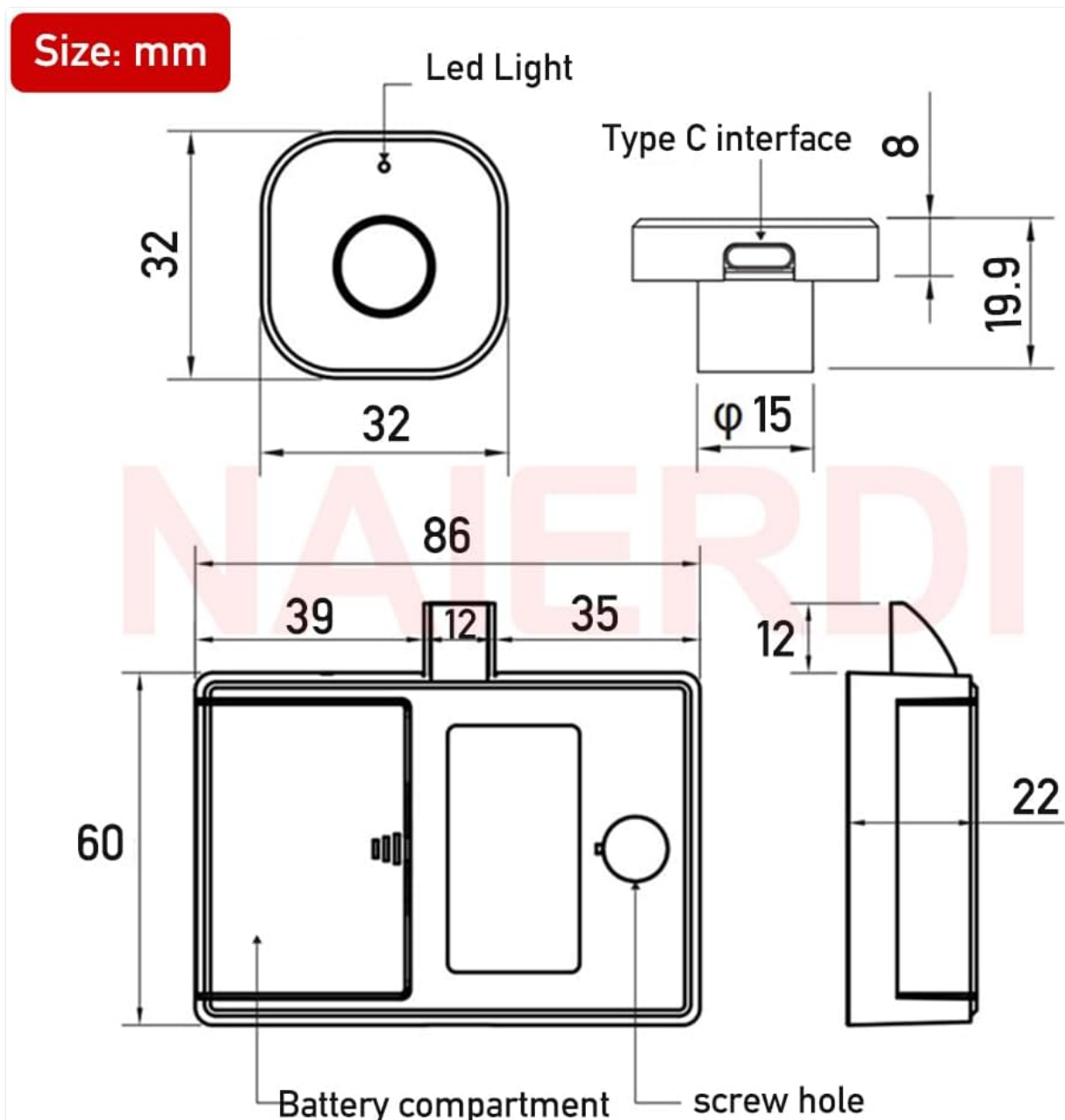

Image 4.1: Detailed diagram of the lock components and dimensions.

5. SPECIFICATIONS

Feature	Specification
Brand	NAIERDI
Model Number	KAK-JCDS
Lock Type	Biometric Fingerprint
Material	Zinc Alloy, ABS
Dimensions (L x W x H)	32 x 32 x 8 mm (Fingerprint Sensor)
Battery Compartment Size	86 x 60 mm (inside cabinet)
Fingerprint Capacity	Up to 20 fingerprints
Response Time	0.5 seconds
Special Features	Auto-Lock, Battery Indicator, Rechargeable, Emergency Power
Recommended Use	Indoor cabinet and drawer security

6. SETUP AND INSTALLATION

Follow these steps to install your NAIERDI Fingerprint Cabinet Lock:

- 1. Prepare the Installation Area:** Choose a suitable location on your cabinet or drawer. Ensure there is enough space inside for the lock body (battery compartment) and the latch mechanism.
- 2. Mark Drilling Points:** Use the provided template or measure carefully to mark the drilling points for the fingerprint sensor unit on the outside of the cabinet/drawer and for the lock body on the inside. Refer to Image 4.1 for dimensions.
- 3. Drill Holes:** Carefully drill the necessary holes for mounting the fingerprint sensor and the lock body. Ensure the holes are clean and free of debris.
- 4. Install Fingerprint Sensor:** Insert the fingerprint sensor unit into the outer hole. Secure it from the inside using the provided screws.
- 5. Install Lock Body:** Attach the lock body (which contains the battery compartment and latch) to the inside of the cabinet/drawer, aligning it with the fingerprint sensor unit. Secure it with screws.
- 6. Connect Cables:** Connect the cable from the fingerprint sensor to the lock body.
- 7. Install Batteries:** Open the battery compartment and insert the required batteries, observing correct polarity.
- 8. Test Installation:** Close the cabinet/drawer and perform a preliminary test to ensure the lock mechanism engages and disengages smoothly.



Image 6.1: The fingerprint lock installed on a cabinet drawer.



Image 6.2: The fingerprint lock installed on a nightstand drawer.

7. OPERATING INSTRUCTIONS

7.1 Initial Setup (Administrator Fingerprint Registration)

The first fingerprint registered will automatically be set as the administrator fingerprint. This fingerprint is required to add or delete other user fingerprints.

1. With the lock in an unlocked state, press and hold the fingerprint sensor until the LED indicator flashes blue.
2. Place your finger on the sensor. Lift and place your finger repeatedly (approximately 5-10 times) from different angles until the LED indicator turns green, indicating successful registration.
3. The first registered fingerprint is now the administrator.

7.2 Adding User Fingerprints

You can register up to 20 fingerprints in total (1 administrator + 19 users).

1. Place the administrator's finger on the sensor and hold until the LED indicator flashes blue.
2. Once the blue light is stable, the lock is ready to register a new user.
3. Have the new user place their finger on the sensor. Lift and place their finger repeatedly (approximately 5-10

times) from different angles until the LED indicator turns green.

4. Repeat for additional users. If the LED flashes red, registration failed; try again.

7.3 Deleting Fingerprints

To delete all registered fingerprints (including the administrator):

1. Place the administrator's finger on the sensor and hold until the LED indicator flashes blue.
2. While the blue light is flashing, continue to hold the administrator's finger on the sensor for an additional 5 seconds until the LED indicator flashes red, then turns green. This indicates all fingerprints have been deleted.
3. You will need to register a new administrator fingerprint after this process.

7.4 Unlocking

To unlock the cabinet or drawer:

- Place a registered finger on the fingerprint sensor.
- If the fingerprint is recognized, the LED indicator will flash green, and the lock will disengage. You can then open the cabinet/drawer.
- If the fingerprint is not recognized, the LED indicator will flash red. Try again with a registered finger.

7.5 Locking

The lock features an auto-lock function. After unlocking, the lock will automatically re-engage after a few seconds (typically 3-5 seconds) or when the cabinet/drawer is closed, securing it without further action.

7.6 Child Safety Feature

The NAIERDI Fingerprint Cabinet Lock is an effective tool for child safety, preventing access to potentially hazardous items such as medicines, sharp objects, or cleaning supplies. By securing cabinets and drawers, you can create a safer environment for children.



Image 7.1: The lock's application for child safety, securing hazardous items.

8. BATTERY MANAGEMENT

The NAIERDI Fingerprint Cabinet Lock is designed for long standby time, but regular monitoring of battery status is recommended.

8.1 Low Battery Alert

When the battery level is low, the LED indicator will flash red three times after unlocking. This indicates that the battery needs to be replaced or recharged soon.

Low battery alert when unlocked

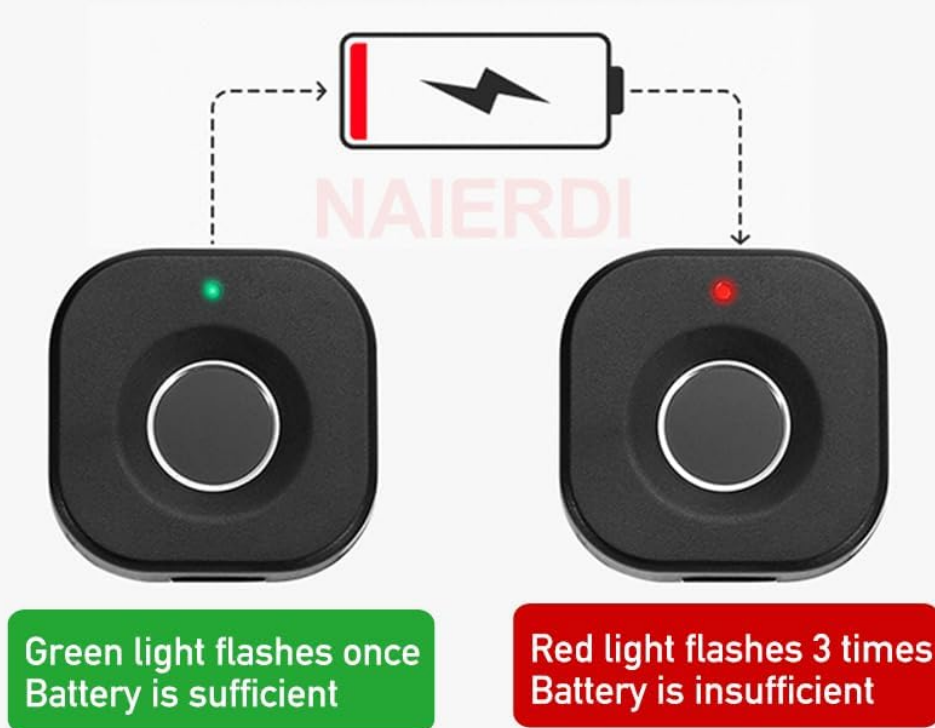

If lock's battery is low,
After unlocking, the red indicator will flash quickly 3 times,
and the battery needs to be replaced as soon as possible.

Image 8.1: Visual representation of the low battery alert system.

8.2 Emergency Charging

If the battery completely drains and the lock cannot be opened, you can use an external power supply for emergency charging via the USB Type-C interface.

1. Locate the USB Type-C port on the fingerprint sensor unit.
2. Connect a USB Type-C cable to the port and connect the other end to a power bank or a USB power adapter.
3. Once emergency power is supplied, the lock will temporarily activate, allowing you to unlock it with a registered fingerprint.
4. After unlocking, replace or recharge the internal batteries as soon as possible.

External Power Supply Emergency Charging

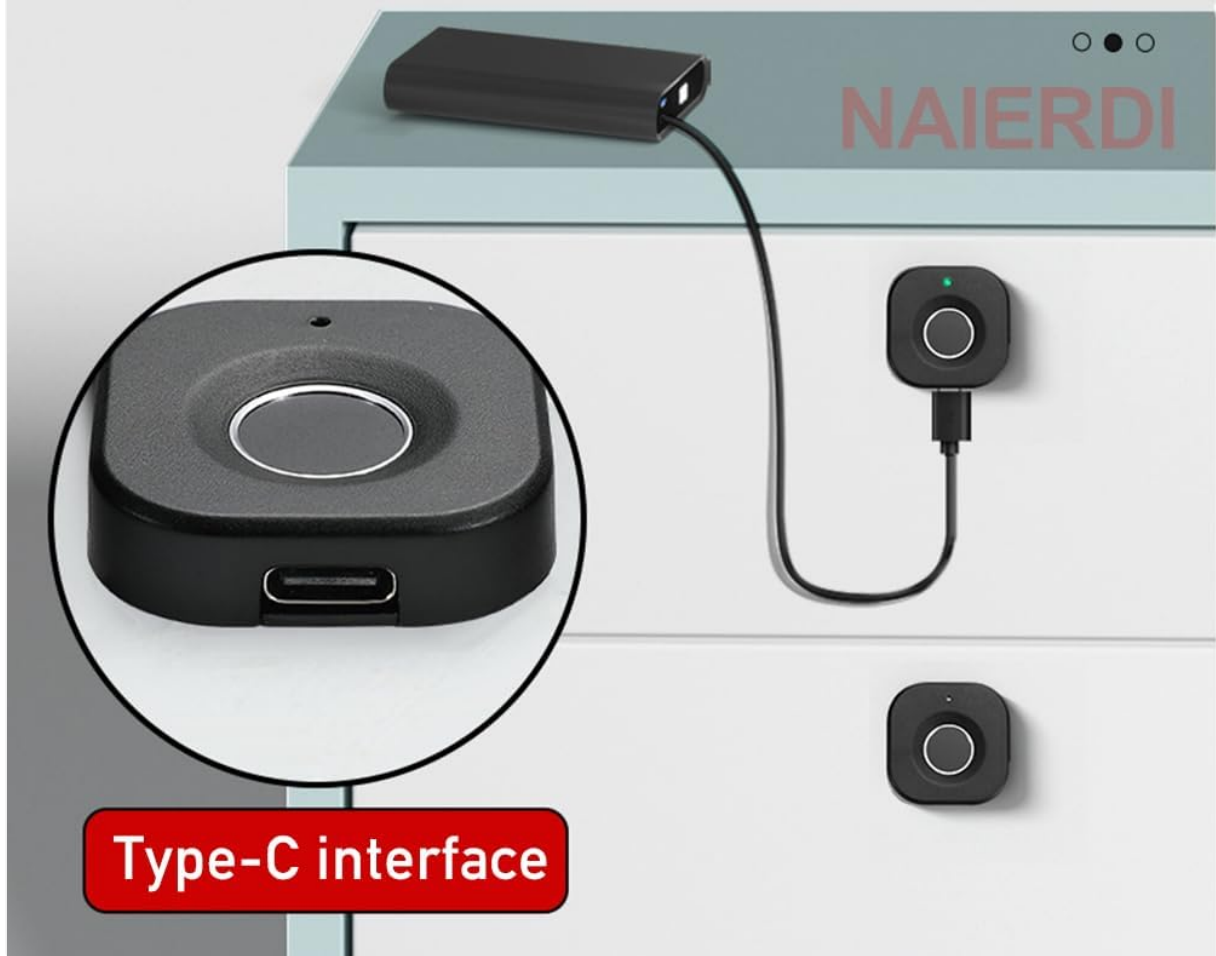

Image 8.2: Emergency charging via the Type-C interface.

NAIERDI

USB Backup Key Respond to Emergencies



Image 8.3: Using an external USB power source for emergency access.

9. MAINTENANCE

To ensure optimal performance and longevity of your NAIERDI Fingerprint Cabinet Lock, follow these maintenance guidelines:

- **Cleaning:** Wipe the fingerprint sensor and the lock body with a soft, dry cloth. Avoid using abrasive cleaners, solvents, or harsh chemicals, as these can damage the surface or electronic components.
- **Battery Replacement:** Replace batteries promptly when the low battery alert is indicated. Use high-quality batteries to prevent leakage and ensure reliable operation.
- **Environmental Conditions:** Ensure the lock is used within recommended indoor environmental conditions. Avoid areas with high humidity or extreme temperature fluctuations.
- **Regular Checks:** Periodically check the mounting screws to ensure they are tight and the lock is securely attached to the cabinet or drawer.

10. TROUBLESHOOTING

If you encounter issues with your NAIERDI Fingerprint Cabinet Lock, refer to the following troubleshooting guide:

- **Lock not responding:**

- Check if the batteries are installed correctly and have sufficient charge.
- Try emergency charging via the USB Type-C port.

- **Fingerprint not recognized:**

- Ensure your finger is clean and dry.
- Place your entire finger pad firmly on the sensor.
- Try different angles or another registered finger.
- If the issue persists, try re-registering your fingerprint.

- **Low battery alert (red light flashes 3 times):**

- Replace the batteries immediately.
- If using rechargeable batteries, recharge them fully.

- **Cannot register new fingerprints:**

- Ensure you are using the administrator fingerprint to initiate the registration process.
- Check if the maximum capacity of 20 fingerprints has been reached. If so, you may need to delete existing fingerprints.

- **Lock mechanism is stuck or not engaging:**

- Check for any obstructions in the path of the latch mechanism.
- Ensure the lock body is securely mounted and aligned correctly.

11. WARRANTY AND SUPPORT

NAIERDI products are manufactured to high-quality standards. For warranty information, technical support, or service inquiries, please refer to the contact information provided at the point of purchase or visit the official NAIERDI website. Please retain your proof of purchase for warranty claims.