

Manuals+

[Q & A](#) | [Deep Search](#) | [Upload](#)

manuals.plus /

- › [iDPRT](#) /
- › [iDPRT SP310 Thermal Label Printer User Manual](#)

iDPRT SP310

iDPRT SP310 Thermal Label Printer User Manual

Model: SP310

1. PRODUCT OVERVIEW

The iDPRT SP310 is a thermal label printer designed for various labeling needs in home, office, and small business environments. It features automatic label detection, supports a print width from 1 inch (25mm) to 3.15 inches (80mm), and offers high-speed, clear printing without the need for ink.



Image: The iDPRT SP310 Thermal Label Printer, a compact black device with a label emerging from its front slot.

Key Features:

- **Automatic Label Detection:** Intelligently recognizes label sizes for precise printing, preventing misprints.
- **Wide Label Support:** Accommodates labels from 1 inch (25mm) to 3.15 inches (80mm) in width.*Note: This printer does not support 4x6 inch shipping labels.*
- **High-Resolution Printing:** Delivers clear output with 203 DPI resolution.
- **Fast Printing Speed:** Capable of printing up to 100 2x3 inch labels per minute (102mm/s).
- **Cross-Platform Compatibility:** Works with Windows, Mac, and Linux operating systems.
- **"Label Designer" Software:** Free software for Windows (web version for Mac) to create and edit custom labels.
- **Ink-Free Thermal Printing:** Eliminates the need for ink cartridges, reducing ongoing costs.

2. PACKAGE CONTENTS

Before proceeding with the setup, please verify that all items listed below are included in your package:

- 1 x iDPRT SP310 Printer
- 1 x Power Cord
- 1 x Power Adapter
- 1 x USB Cable
- 1 x USB Flash Drive
- 1 x Cables Fastener
- 1 x USB to Type-C Converter (for Mac users)
- 1 x User Guide
- 1 x Paper Roll (starter roll)

3. SETUP INSTRUCTIONS

3.1 Connecting the Printer

1. Connect the AC adapter to the cable connector on the printer.
2. Connect the AC power cord to the inlet on the AC adapter.
3. Plug the other end of the AC power cord into a wall socket outlet.
4. Connect the USB cable to the printer and then to your computer (Windows, Mac, or Linux).

PRINTER CONNECTION



1 Connect the AC adapter to the cable connector



2 Connect the AC power cord to the inlet



3 Connect the other end of the AC power cord into the socket outlet



4 Connect the USB cable to the printer and PC

Image: Visual guide demonstrating the four steps to connect the printer's power and USB cables.

3.2 Driver and Software Installation

To ensure proper functionality, you must install the printer driver and the "Label Designer" software.

- **Driver:** Download the latest driver from the official iDPRT website. Follow the on-screen instructions for installation.
- **"Label Designer" Software:**
 - For **Windows:** Download and install the "Label Designer" software from the iDPRT official website.
 - For **Mac:** Use the web version of the "Label Designer" software.

Refer to the included USB Flash Drive or the official iDPRT website for detailed instructions and download links. If you encounter difficulties, contact customer support.

LABEL DESIGNER SOFTWARE

CREATE LABEL YOU WANT



Image: A computer screen displaying the "Label Designer" software interface, used for creating and editing labels.

3.3 Loading Labels

The iDPR1 SP310 supports various label roll sizes. Ensure the labels are loaded correctly for optimal printing.

1. Open the printer cover.
2. Place the label roll onto the spindle, ensuring the labels feed from the bottom.
3. Feed the leading edge of the label through the printer's slot until it is slightly past the print head.
4. Adjust the label guides to fit the width of your labels snugly, without creasing them.
5. Close the printer cover. The printer will automatically detect the label size.



Image: An open view of the iDPRT SP310 printer, showing the internal mechanism for loading label rolls of various core sizes (0.5, 1.0, 1.5 inches).

4. OPERATING INSTRUCTIONS

4.1 Automatic Label Detection

The SP310 printer features an intelligent label recognition module that automatically detects the size and type of labels loaded. This ensures accurate printing without manual calibration of the starting position.



Image: A visual comparison showing a label before and after automatic detection, demonstrating how the printer precisely adjusts the label angle within 1 second.

4.2 Printing Labels

1. Ensure the printer is connected to your computer and powered on.
2. Load the desired thermal labels into the printer.
3. Open the "Label Designer" software (or your preferred label design application).

4. Design your label or select an existing template. The software allows for editing imported labels and creating new designs.
5. Verify print settings, including label size, orientation, and quantity.
6. Initiate the print command from your software.



Image: A user interacting with the "Label Designer" software on a laptop, with the iDPRT SP310 printer nearby, illustrating the label creation process.

4.3 Supported Label Applications

The iDPRT SP310 is versatile and can be used for various label types, including:

- Barcode labels
- Address labels
- Office labels (e.g., for filing, organizing)
- Food labels
- Retail commodity labels
- DIY labels for crafts and gifts

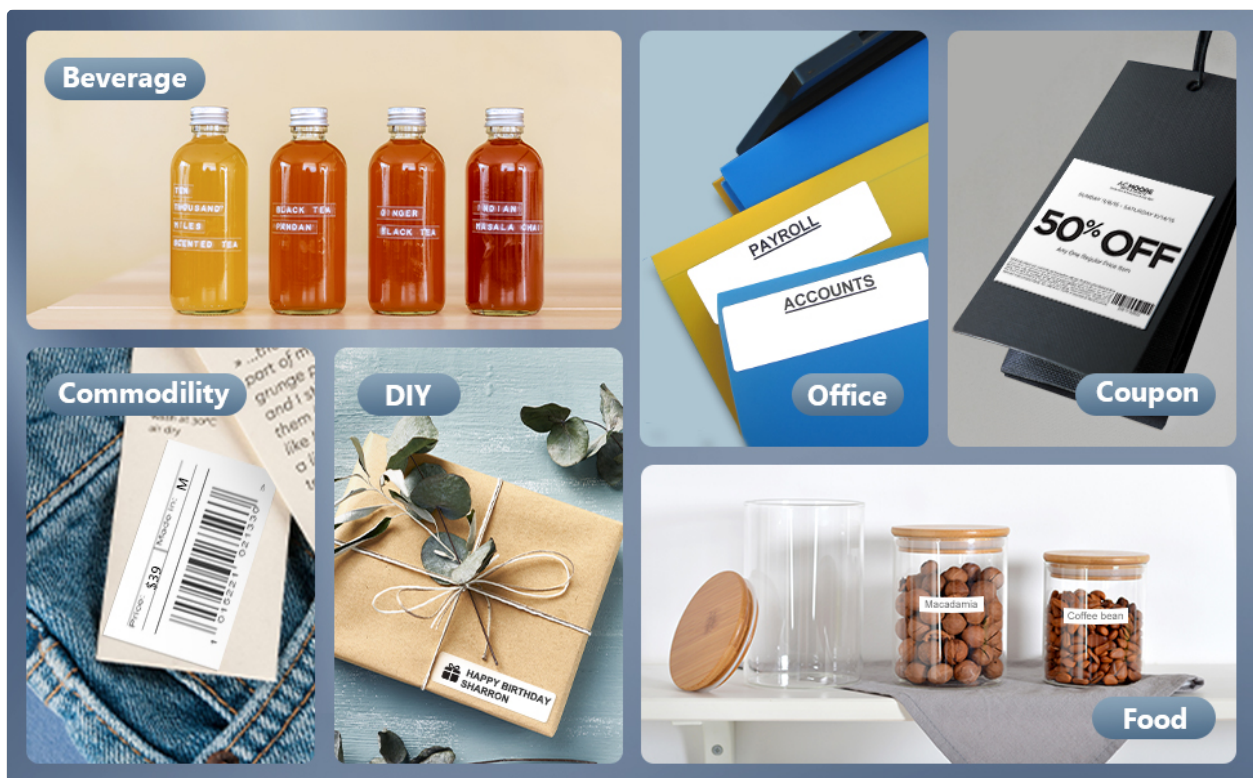

Image: A collage showing different applications of labels printed by the iDPRT SP310, including office files, food jars, coupons, beverages, commodities, and DIY gifts.

5. MAINTENANCE

5.1 Cleaning the Printer

Regular cleaning helps maintain print quality and extends the life of your printer. Use a soft, lint-free cloth lightly dampened with isopropyl alcohol to clean the print head and platen roller. Ensure the printer is powered off and disconnected before cleaning.

5.2 Printer Head Replacement

The SP310 features a quick replacement design for the thermal print head (TPH). If replacement is necessary, simply hold and press down on the designated area to swap the print head. This process can be completed in under one minute.

6. TROUBLESHOOTING

If you encounter issues with your iDPRT SP310 printer, refer to the following common problems and solutions:

- **Printer Not Responding:**

- Check all cable connections (power and USB).
- Ensure the printer is powered on.
- Verify that the correct printer driver is installed and updated.

- **Poor Print Quality:**

- Clean the print head.
- Ensure you are using high-quality thermal labels.

- Check print density settings in your software.

- **Labels Not Feeding Correctly:**

- Ensure labels are loaded correctly and the label guides are adjusted properly.
- Perform an automatic label detection cycle.

- **Cannot Print 4x6 Inch Labels:**

- The iDPRT SP310 is designed for labels with a maximum width of 3.15 inches and does not support 4x6 inch shipping labels.

- **Software or Driver Issues:**

- Re-download and reinstall the latest driver and "Label Designer" software from the official iDPRT website.
- Consult the detailed manual provided on the USB flash drive or online.

For further assistance, please contact iDPRT customer service via Amazon or their official support channels.

7. SPECIFICATIONS

Feature	Specification
Brand	iDPRT
Model Name	SP310
Printing Technology	Thermal
Connectivity Technology	USB
Printer Output	Monochrome
Maximum Print Speed (Monochrome)	102 mm/s
Maximum Print Resolution	203 dpi
Supported Label Width	1" (25mm) to 3.15" (80mm)
Maximum Media Size	3 x 5 inch (referring to general media size, actual print width is 3.15")
Max Input Sheet Capacity	1000 (labels)
Hardware Interface	USB
Product Dimensions	7.4 x 5.28 x 5.91 inches
Item Weight	3.25 pounds
Operating System Compatibility	Windows, Mac, Linux
Ink Type	No Ink Required

8. WARRANTY AND SUPPORT

8.1 Warranty Information





The iDPRT SP310 Thermal Label Printer comes with a**Limited Warranty or Full Warranty**. Please refer to the warranty card included in your package or visit the official iDPRT website for specific terms and conditions regarding your product's warranty coverage.



8.2 Customer Support

For any questions, technical assistance, or support needs regarding your iDPRT SP310 printer, please contact the iDPRT customer service team. You can reach them via Amazon's messaging system or through the contact information provided on the official iDPRT website. They are available to assist with pre-sales and after-sales inquiries.

© 2024 iDPRT. All rights reserved.

Related Documents - SP310

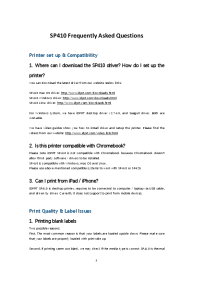
	<p>iDPRT SP310 Thermal Label Printer Quick Start Guide</p> <p>A quick start guide for the iDPRT SP310 Thermal Label Printer, covering installation, connection, and basic label creation.</p>
	<p>iDPRT SP410 Label Printer Installation and User Guide</p> <p>A comprehensive guide to installing and using the iDPRT SP410 thermal label printer, covering connection, driver installation, label loading, settings, and troubleshooting for Windows and Mac operating systems.</p>
	<p>iDPRT SP310 Thermal Label & Receipt Printer User Guide</p> <p>Comprehensive user guide for the iDPRT SP310 Thermal Label & Receipt Printer. Includes setup instructions, packing list, appearance details, connection guides, paper loading, operation panel functions, driver installation for Windows and macOS, printing preferences, troubleshooting common print and communication problems, and FCC warnings.</p>
	<p>iDPRT SP310 Thermal Label & Receipt Printer User Guide</p> <p>Comprehensive user guide for the iDPRT SP310 thermal label and receipt printer, covering setup, operation, driver installation for Windows and macOS, printing preferences, and troubleshooting.</p>

	<p>iDPRT SP410 Thermal Label Printer: Frequently Asked Questions and Troubleshooting Guide</p> <p>Find answers to common questions about the iDPRT SP410 thermal label printer, including setup, compatibility, print quality issues, and troubleshooting tips for Windows, macOS, and Linux.</p>
	<p>iDPRT SP410BT Bluetooth Thermal Label Printer User Guide</p> <p>Comprehensive user guide for the iDPRT SP410BT Bluetooth Thermal Label Printer, covering package contents, setup, driver installation for Windows and macOS, label loading, printing preferences, status indicators, and troubleshooting tips.</p>

Documents - iDPRT – SP310



[iDPRT SP310 Thermal Label & Receipt Printer User Guide](#)

Comprehensive user guide for the iDPRT SP310 thermal label and receipt printer, covering setup, operation, driver installation for Windows and macOS, printing preferences, and troubleshooting.

lang:en score:53 filesize: 1.57 M page_count: 20 document date: 2022-03-30

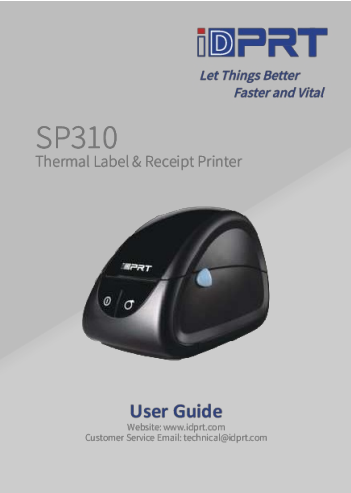

[iDPRT SP310 Thermal Label & Receipt Printer User Guide](#)

Comprehensive user guide for the iDPRT SP310 Thermal Label & Receipt Printer. Includes setup instructions, packing list, appearance details, connection guides, paper loading, operation panel functions, driver installation for Windows and macOS, printing preferences, troubleshooting common print and communication problems, and FCC warnings.

lang:en score:45 filesize: 1.38 M page_count: 20 document date: 2021-12-21

SP310



User Manual

Website: www.idprt.com
Call Center: 18554983499
After Service: <https://idprt afterservice.vip>
Customer Service Email: support@idprt.com

[\[pdf\]](#) User Manual Instructions Specifications

iDPRT SP310 User Manual Rev 1 0 YXH 417 QR code 5 Caution Violating following instructions can cause a slight wound or damage to the appliance If you observe strange smoke odour noise from printer unplug it before taking 17 oct 2021 — Do not plug several products in one multi outlet This provoke over heating and fire is wet dirty dry wipe usage idprt prt v2 files down file id 170 fid 490 html |||

SP310 User Manual Website: www.idprt.com Call Center: 18554983499 After Service: <https://idprt.afterservice.vip> Customer Service Email: support@idprt.com Contents Important Safety

Instructions.....4 Chapter...
lang:en score:44 filesize: 3.59 M page_count: 79 document date: 2021-05-21

SP310



User Manual

Manufacturer: Xiamen Hanin Electronic Technology Co.,Ltd.
Address: No.96, Rongyuan Road, Tong an District, Xiamen, China 361100
Website: www.idprt.com
Customer Service Email: technical@idprt.com

[\[pdf\]](#) User Manual Instructions Specifications

iDPRT SP310 User Manual Rev 1 0 YXH Microsoft IDPRT 9 avr 2022 — Chapter 10 BarTender Ultralite Installation 2 3 Dimension Driver Windows 2000 XP Vista 7 8 Linux macOS idprt prt v2 files down file id 212 fid 510 html |||

SP310 User Manual Manufacturer: Xiamen Hanin Electronic Technology Co.,Ltd. Address: No.96, Rongyuan Road, Tong an District, Xiamen, China 361100 Website: www.idprt.com Customer Service Email: technical@idprt.com Contents Important Safety Instructions.....

lang:en score:42 filesize: 2.25 M page_count: 79 document date: 2022-04-02



[\[pdf\]](#) Specifications Accessories Catalog Label

SP310 EN 3 Direct Thermal Label Printer Fashionable design Unique media supply spindle supports three types of label roll inner core diameter iDPRT Catalogue idprt prt v2 files down file id 119 fid 458 html |||

SP310 3 Direct Thermal Label Printer Fashionable design Unique media supply spindle design, supports three types of label roll inner core diameter Printer head quick replacement design, convenient for service Fully-closed gear box design, no dust going in, high reliability Easy loading design, quic...

lang:en score:31 filesize: 344.79 K page_count: 2 document date: 2021-06-08



[iDPRT SP310 Thermal Label Printer Quick Start Guide](#)

A quick start guide for the iDPRT SP310 Thermal Label Printer, covering installation, connection, and basic label creation.

lang:en score:19 filesize: 6.09 M page_count: 4 document date: 2022-06-07

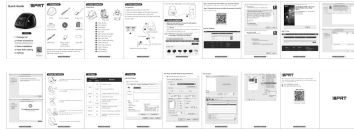

[\[pdf\] Installation Guide Label](#)

iDPRT TSPL Label Printer Windows Driver v2 7 4 ALL PRODUCTS SP310→ TYPE → SYSTEM Step 3

Download the driver and follow prompts to install it Scan for Installation Video D1wXH8AaiPL m media

amazon images | |||

...

lang:en score:11 filesize: 8.83 M page_count: 1 document date: 2023-04-06