

Brio FSWH300KDF

Brio 3-Stage Whole House Filtration System User Manual

Model: FSWH300KDF

1. INTRODUCTION

Thank you for choosing the Brio 3-Stage Whole House Filtration System. This manual provides essential information for the proper installation, operation, and maintenance of your new water filtration system. Please read this manual thoroughly before installation and keep it for future reference. This system is designed to provide clean, filtered water throughout your entire home, reducing heavy metals and other contaminants.

2. PRODUCT OVERVIEW

The Brio 3-Stage Whole House Filtration System is engineered to deliver high-quality filtered water to every faucet and appliance in your home. It features a robust design and a powerful three-stage filtration process to address a wide range of water impurities.

Key Features:

- **Advanced 3-Stage Filtration:** Includes a 5-micron PP sediment filter, a GAC + KDF filter, and a CTO carbon block filter for comprehensive water purification.
- **Heavy Metal Reduction:** Specifically designed to intercept and reduce heavy metals such as lead and mercury, which can be consumed or absorbed through the skin.
- **High Flow Rate:** Delivers an impressive 900 gallons per hour (GPH) of filtered water, ensuring ample supply for sinks, appliances, showers, and more without significant pressure loss.
- **Durable Construction:** Features a rugged stainless steel frame that can be floor-mounted or wall-mounted, along with leak-proof O-ring sealed housings for long-lasting reliability.
- **Easy Installation & Maintenance:** Comes installation-ready with standard 1-inch connections, a reversible bracket for flexible placement, and accommodates universal-fit filters for simple replacement.
- **Extended Filter Lifespan:** Depending on source water quality, filters can last up to 100,000 gallons or 12 months, providing long-term value.

Brio 3-Stage Whole House Filtration System



Heavy Metal Reduction

- 3-Stage filtration designed to target a wide range of contaminants, including chlorine and VOCs, and offers the ultimate protection against heavy metals like lead and mercury
- Produces up to 900 GPH of filtered water, ensuring fresh, clean water for every need, with no loss in pressure
- Durable system with user-friendly set up, minimal maintenance, and easy filter changes

Image: The Brio 3-Stage Whole House Filtration System, highlighting its heavy metal reduction capability.

Provides Clean Water to Every Room in Your House

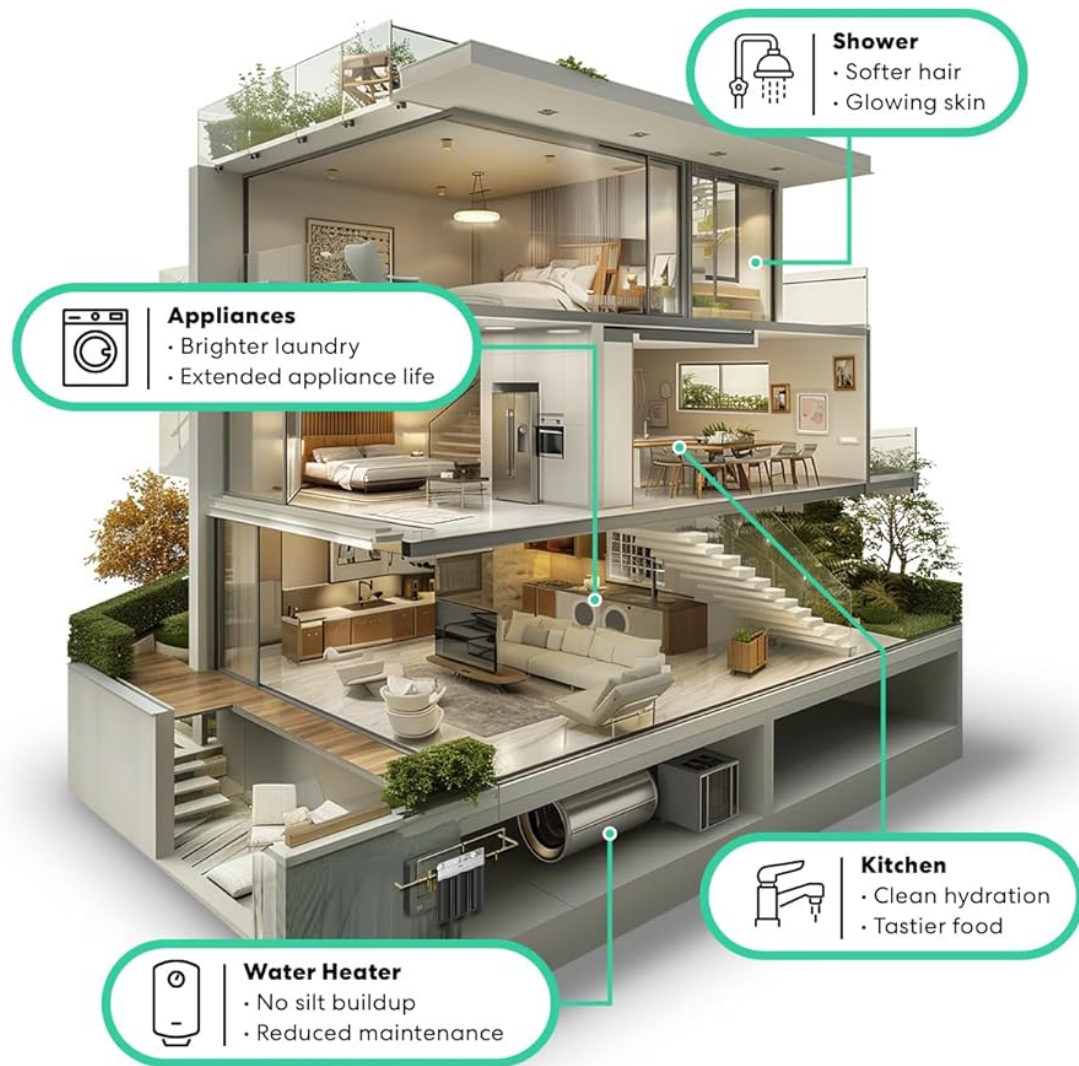

No Wastewater



No Pressure Loss



Cleaner Plumbing

Image: Illustration demonstrating how the Brio system provides clean water to various points in a home, including kitchen, shower, and appliances.

3. COMPONENTS

Your Brio 3-Stage Whole House Filtration System package includes the following components:

- Main Filtration System Unit (with stainless steel frame and three filter housings)
- 5-Micron PP Sediment Filter (Stage 1)
- GAC + KDF Filter (Stage 2)
- CTO Carbon Block Filter (Stage 3)
- Filter Housing Wrench
- User Manual

Filter Stages Explained:

1. Stage 1: PP Sediment Filter (5-Micron Polypropylene)

This initial stage removes larger particles from your water, such as dirt, rust, sand, and other suspended solids. It protects the subsequent filters from premature clogging, extending their lifespan and maintaining system efficiency.

2. Stage 2: GAC + KDF Filter (Granular Activated Carbon + Kinetic Degradation Fluxion)

The second stage utilizes a powerful combination of Granular Activated Carbon (GAC) and KDF media. This stage is crucial for reducing heavy metals like lead and mercury, as well as herbicides and pesticides, improving water quality and safety.

3. Stage 3: CTO Carbon Block Filter (Chlorine, Taste & Odor)

The final stage employs a Carbon Block filter to effectively remove chlorine, unpleasant tastes, and odors from your water. This results in cleaner, clearer, and better-tasting water throughout your home.



Image: All components of the Brio 3-Stage Whole House Filtration System, including the main unit, three filters (Sediment, GAC+KDF, CTO), and the filter wrench.

Targeted 3-Stage Filtration

Featuring 3 individual stages that handle different contaminants, this curated filtration system includes a stage that neutralizes harmful heavy metals, like lead and mercury.

STAGE
01



Sediment

(5-Micron Polypropylene)

Reduces dirt, rust,
cloudiness & colors

STAGE
02



GAC + KDF

(Granular Activated Carbon
+ Kinetic Degradation Fluxion)

Reduces heavy
metals, herbicides
& pesticides

STAGE
03



CTO

(Chlorine, Taste & Odor)

Reduces chlorine
& hexavalent
chromium



Image: Detailed view of the three filtration stages, explaining what each filter targets.

4. SETUP AND INSTALLATION

Proper installation is crucial for the optimal performance and longevity of your Brio Whole House Filtration System. While

the system is designed for easy installation, it is highly recommended to have a qualified plumber perform the installation to ensure compliance with local plumbing codes and proper functionality.

Pre-Installation Checklist:

- Ensure you have all components listed in Section 3.
- Select a suitable location for the system, preferably near the main water inlet to your home, where it is protected from freezing temperatures and direct sunlight.
- Ensure there is adequate space for filter replacement and maintenance.
- Confirm your plumbing uses 1-inch standard connections, or acquire appropriate adapters if necessary.
- Turn off the main water supply to your home before beginning installation.
- Drain water from pipes by opening faucets throughout the house.

Installation Steps (General Guide):

1. **Mounting:** The system can be wall-mounted or placed on the floor. Use appropriate hardware (not included) to securely mount the system if wall-mounting. The reversible bracket allows for flexible configuration to fit your space.
2. **Plumbing Connections:** Connect the main water line to the inlet port of the filtration system and the filtered water line to the outlet port. Ensure all connections are tight and leak-free. The system is designed to be configured to flow in either direction.
3. **Filter Installation:** Ensure the filters are correctly seated in their respective housings (Stage 1 Sediment, Stage 2 GAC+KDF, Stage 3 CTO). Hand-tighten the housings, then use the provided filter wrench for a final snug turn. Do not overtighten.
4. **System Flush:** Slowly turn on the main water supply. Allow water to flow through the system and out of a nearby faucet for several minutes (e.g., 10-15 minutes) to flush out any carbon fines and air from the system. The water may appear cloudy initially; this is normal and will clear.
5. **Leak Check:** Carefully inspect all connections for any leaks. Tighten as necessary.

Easy to Use & Maintain

Installation-ready system with standard 1" connections.

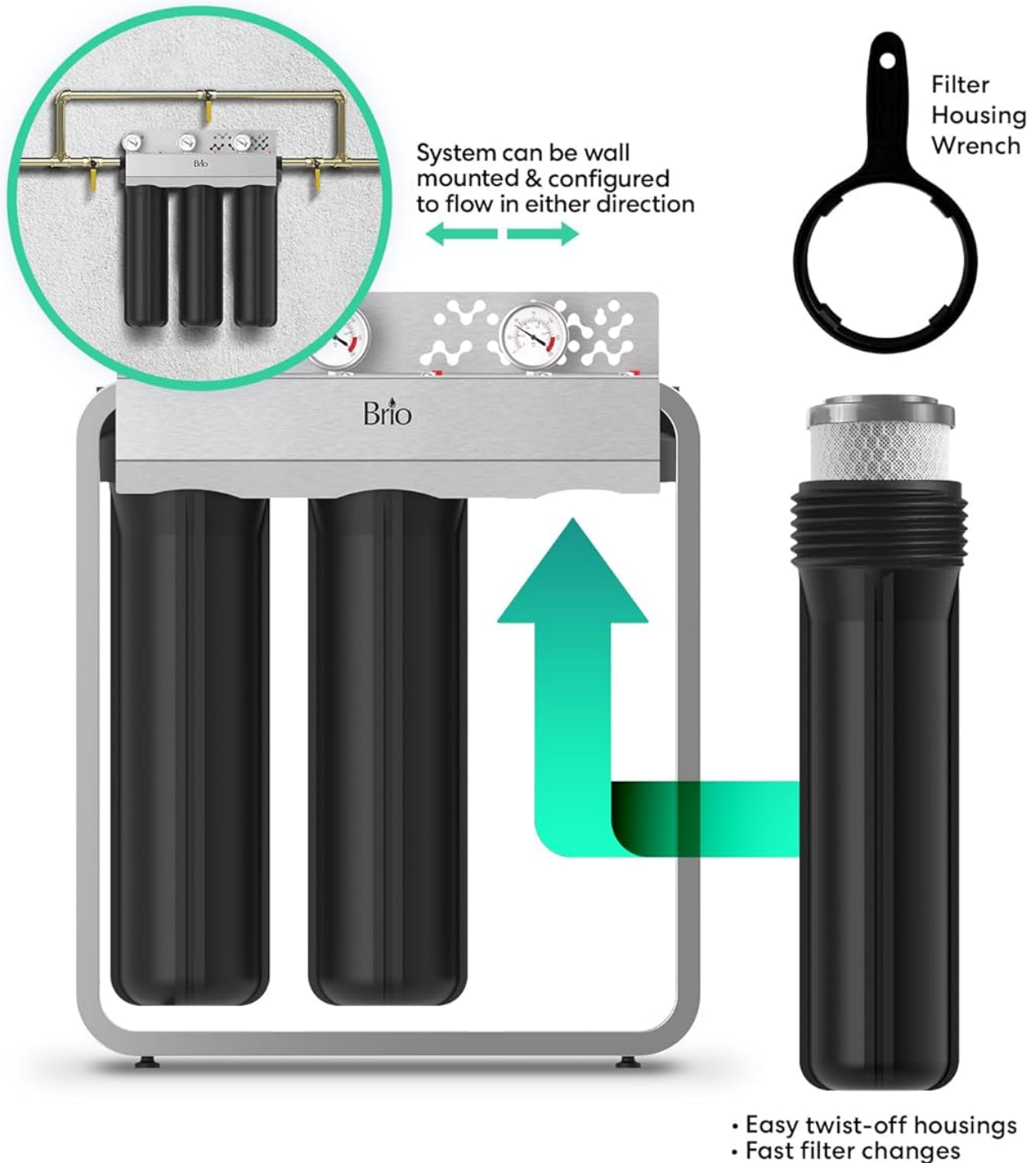

Image: Visual guide illustrating the system's wall-mount capability, flow configuration, and the easy twist-off housing for filter changes.

5. OPERATING INSTRUCTIONS

Once properly installed and flushed, your Brio 3-Stage Whole House Filtration System operates automatically, providing

filtered water to your entire home. There are no specific operational controls required after initial setup.

- **Continuous Filtration:** The system continuously filters your incoming water supply as it flows through the three stages.
- **Flow Rate:** The system is designed to maintain a high flow rate of up to 900 gallons per hour (GPH), ensuring minimal impact on your home's water pressure.
- **Pressure Gauges:** The system is equipped with pressure gauges to monitor the water pressure before and after each filter stage. A significant drop in pressure across a filter stage indicates that the filter may be nearing the end of its lifespan and requires replacement.

6. MAINTENANCE

Regular maintenance, primarily filter replacement, is essential to ensure your Brio Whole House Filtration System continues to perform effectively and provide clean water.

Filter Replacement:

The lifespan of the filters depends on your source water quality and usage. For optimal performance, it is recommended to replace the filters every 100,000 gallons or 12 months, whichever comes first. You may need to replace them more frequently if you notice a significant drop in water pressure or a return of undesirable tastes/odors.

Steps for Filter Replacement:

1. **Turn Off Water Supply:** Locate and turn off the main water supply to your home.
2. **Depressurize System:** Open a nearby faucet to relieve pressure in the system. Locate the simple pressure-release button on top of the system and press it to release any remaining pressure from the filter housings.
3. **Unscrew Housings:** Place a bucket or towel underneath the filter housings to catch any residual water. Use the provided filter housing wrench to unscrew each housing counter-clockwise. The housings are designed for easy twist-off removal.
4. **Remove Old Filters:** Carefully remove the old filters and dispose of them properly.
5. **Clean Housings:** Rinse the inside of the filter housings with clean water. Inspect the O-rings for any damage or wear. If an O-ring is damaged, replace it to ensure a leak-proof seal. Lubricate O-rings with food-grade silicone grease if necessary.
6. **Install New Filters:** Insert the new filters into their respective housings, ensuring they are properly centered.
7. **Reattach Housings:** Screw the filter housings back onto the system clockwise. Hand-tighten first, then use the filter wrench for a final snug turn. Do not overtighten.
8. **Restore Water Supply & Flush:** Slowly turn on the main water supply. Allow water to flow through the system and out of a nearby faucet for several minutes to flush out air and any carbon fines from the new filters. Check for leaks.

Easy to Use & Maintain

Installation-ready system with standard 1" connections.

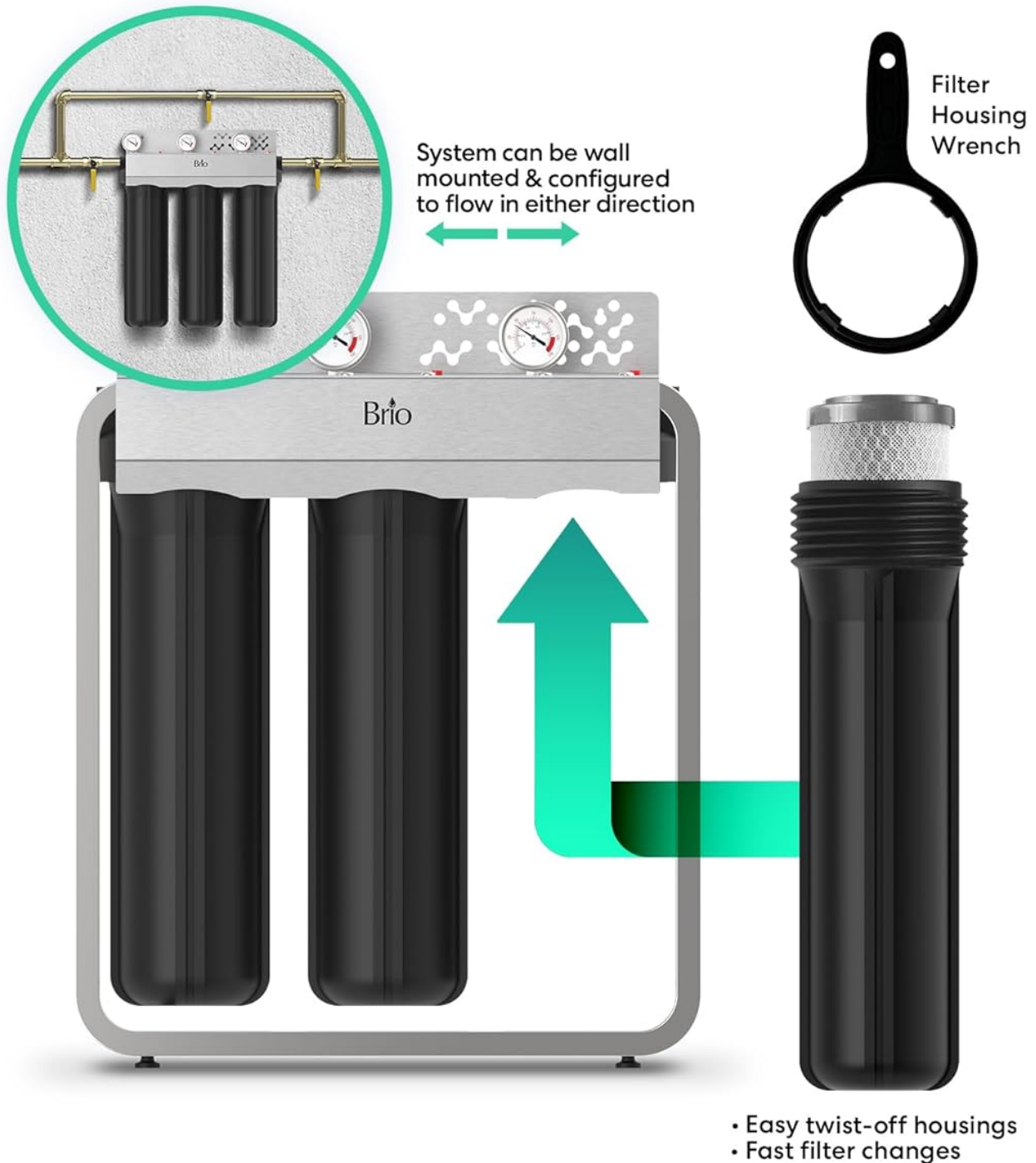

Image: Illustration of the filter replacement process, showing the use of the filter wrench and the direction of flow.

7. TROUBLESHOOTING

This section provides solutions to common issues you might encounter with your Brio Whole House Filtration System.

Problem	Possible Cause	Solution
Reduced Water Flow/Pressure	Clogged filters (most common); air in the system; kinked water line.	Replace filters (refer to Section 6). Flush the system to remove air. Check water lines for obstructions.
Unusual Taste or Odor in Water	Filters have reached end of life; new system not adequately flushed.	Replace filters (especially GAC+KDF and CTO). Flush the system thoroughly (10-15 minutes).
Water Leaks from Housings	Housings not tightened properly; damaged or misaligned O-rings.	Ensure housings are securely tightened with the wrench. Turn off water, depressurize, remove housing, inspect and reseal O-rings. Replace O-rings if damaged.
System Not Filtering Effectively	Incorrect filter installation; filters are expired.	Verify filters are installed in the correct order and orientation. Replace all three filters.

If you experience issues not covered here or require further assistance, please contact Brio Customer Support.

8. SPECIFICATIONS

Below are the technical specifications for the Brio 3-Stage Whole House Filtration System (Model: FSWH300KDF):

Attribute	Value
Model Number	FSWH300KDF
Product Dimensions (L x W x H)	23.59" x 8.77" x 30.26" (59.91 cm x 22.28 cm x 76.86 cm)
Item Weight	60 Pounds (27.2 kg)
Flow Rate	Up to 900 Gallons Per Hour (GPH)
Filter Lifespan	Up to 100,000 Gallons or 12 Months (whichever comes first)
Connection Size	1-inch NPT (Standard)
Special Features	Heavy Duty Construction, Heavy Metal Reduction
Installation Type	Whole House (Can be floor-standing or wall-mounted)

Quality Designed for Long-Term Durability

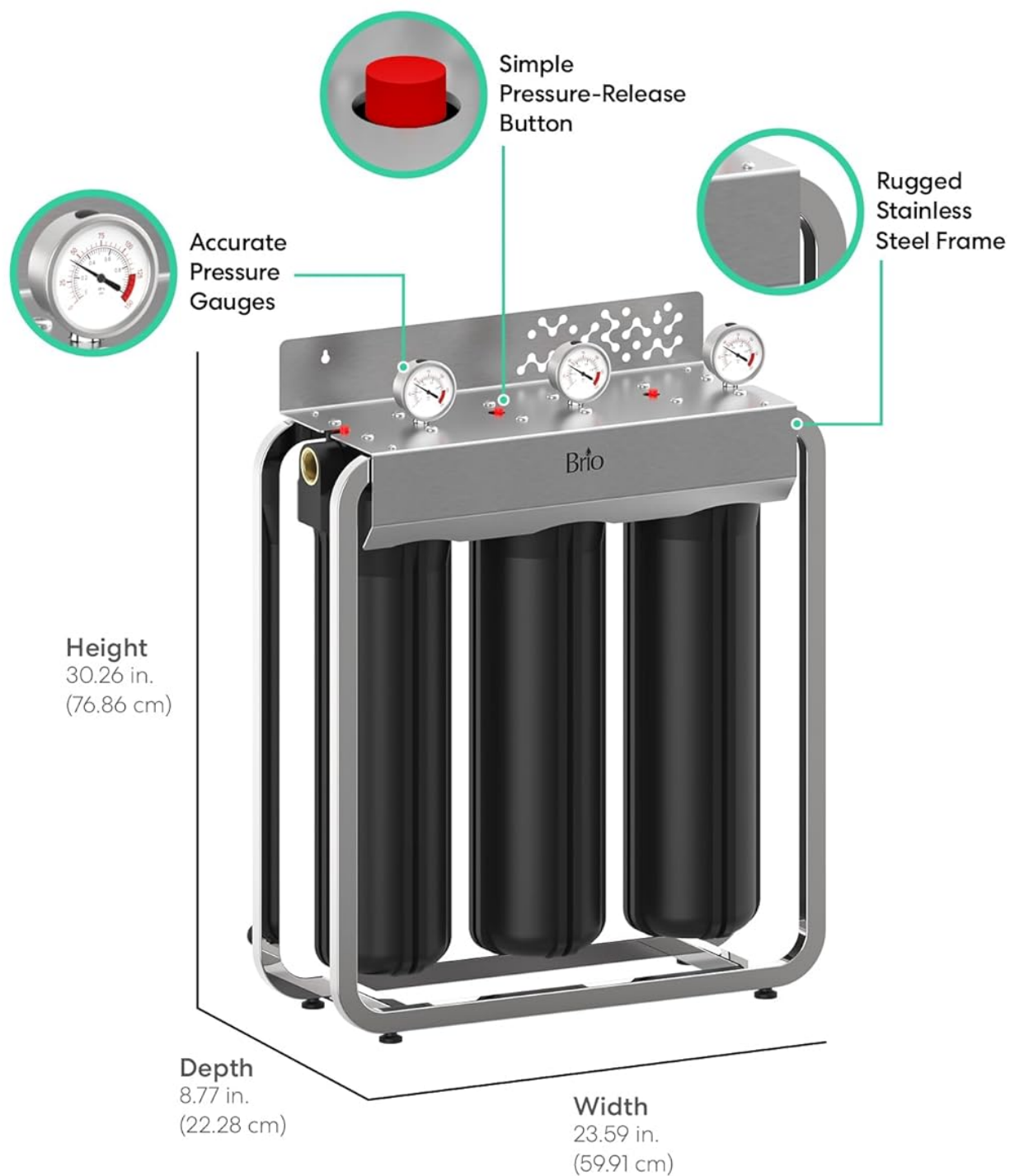

Image: Detailed dimensions and features like pressure gauges and rugged stainless steel frame.

9. WARRANTY AND SUPPORT

Brio stands behind the quality of its products. For specific warranty terms and conditions applicable to your Brio 3-Stage

Whole House Filtration System, please refer to the warranty card included with your product packaging or visit the official Brio website.

Customer Support:

If you have any questions, require technical assistance, or need to order replacement parts, please contact Brio Customer Support. Our team is available to help you with any inquiries regarding your filtration system.
For the most up-to-date contact information, please visit the [Brio Store on Amazon](#) or the official Brio website.

