



[Manuals.plus](#) /

› [RFVUC](#) /

› RFVUC 6-in-1 Wireless Charging Station User Manual

RFVUC Y21

RFVUC 6-in-1 Wireless Charging Station User Manual

MODEL: Y21

Introduction

Thank you for choosing the RFVUC 6-in-1 Wireless Charging Station. This versatile device combines wireless charging capabilities for multiple devices, a digital clock, and customizable ambient lighting, designed to streamline your charging experience and declutter your space. This manual provides detailed instructions to help you set up, operate, and maintain your charging station effectively.



This image displays the RFVUC 6-in-1 Wireless Charging Station in use, simultaneously charging a smartphone, earbuds, smartwatch, and a tablet. The tablet is positioned on the adjustable stand, showcasing its multi-device charging capability and integrated clock display.

Package Contents

- Wireless charger station
- 30W charging adapter
- Type-C charging cable
- User Manual

Setup Instructions

1. Connecting Power

Connect the provided Type-C charging cable to the 'Input' port on the back of the charging station. Plug the other end of the cable into the 30W charging adapter, and then plug the adapter into a wall outlet. The digital clock display will illuminate upon successful connection.

2. Adjusting the Stand

The charging station features a rotating and folding adjustable bracket for your tablet or smartphone. Gently lift the stand to your desired height and angle. It can rotate 180 degrees and fold 270 degrees for optimal viewing and compact storage.

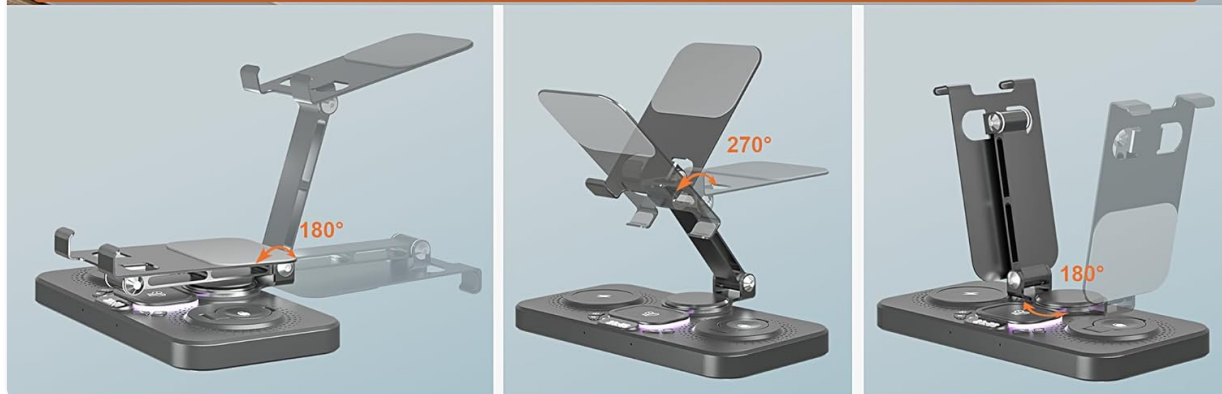

This image set illustrates the versatility of the charging station's adjustable bracket, showing its 180-degree rotation and 270-degree folding capabilities for optimal viewing angles and portability.

3. Setting the Clock

- **Set Key:** Short press once to adjust the hour. Short press twice to adjust the minute. Short press again to return to time display.
- **Adjustment Keys (+/-):** Use these keys to increase or decrease the hour or minute values.
- **Power On/Off:** Long press the Set Key to power the clock display on or off.

4. Adjusting Ambient Light

The charging station includes 7 customizable ambient light colors. Use the dedicated LED Light control button to cycle through the colors and modes, allowing you to personalize your desk or nightstand ambiance.

Operating Instructions

1. Charging Devices

This 6-in-1 station can simultaneously charge up to four devices:

- **Smartphone (15W Max):** Place your Qi-compatible smartphone on the designated wireless charging pad (marked with a lightning bolt). Ensure it is centered for optimal charging.
- **Wireless Earbuds (5W Max):** Place your wireless charging earbud case on the dedicated earbud charging pad.
- **Smartwatch (3W Max):** Position your Apple Watch on the integrated smartwatch charging stand.
- **Tablet/Other Devices (10W Max):** Use the Type-C output port on the back of the station to connect your iPad or other compatible devices for wired charging. The adjustable stand is ideal for holding your tablet while charging.



This diagram shows the charging station with power flow indicators, emphasizing its 30W ultra-fast charging capability for phones (15W), earbuds (5W), and smartwatches (3W), along with 10W wired charging for tablets.



Compatibility & Important Notices

Please check your phone and watch model before buying!



Support for all wireless charging phones

Other: Wireless charging-enabled phones

15W Max

- ✔ iPhone16/16 Plus/16 Pro /16 Pro Max
- ✔ iPhone15/15 Plus/15 Pro /15 Pro Max
- ✔ iPhone14/14 Plus/14 Pro /14 Pro Max
- ✔ iPhone13/13 Pro/13 Pro Max/13 Mini
- ✔ iPhone12/12 Pro/12 Pro Max/12 Mini
- ✔ iPhone 11/11 Pro/11 Pro Max
- ✔ iPhone X/XR/XS/XS Max
- ✔ iPhone 8/8 Plus/ iPhone SE 2
- ✔ Galaxy Z Flip4/GalaxyZ Fold4
- ✔ Galaxy Z Fold3/Galaxy Z Fold2
- ✔ Galaxy Z Flip3/Galaxy Z Flip2
- ✔ Samsung S23 Ultra/S23+/S23
- ✔ Samsung S22 Ultra/S22+/S22
- ✔ S21/S21+/S21Ultra/S21 FE 5G
- ✔ S20/S20+/S20Ultra
- ✔ S10/S10e/S10+
- ✔ S9/S9+/S8/S8+/S7/S7 edge
- ✔ Note20/20Ultra
- ✔ Pixel 6/Pixel 6Pro
- ✔ Pixel 5A/Pixel 4A/LG V60/LG G8



For AirPods with wireless charging case

Other :Wireless charging-enabled Buds

5W Max

- ✔ AirPods with wireless charging case
- ✔ AirPods Pro 2/Pro,Airpods 4,3,2
- ✔ Samsung Galaxy buds,+ ,live, pro, 2
- ✔ Other earbuds with wireless charging case
- ✘ AirPods with standard case
- ✘ Earbuds without wireless charging function



For Apple Watches

3W Max

- ✔ Apple Watch Series 10
- ✔ Apple Watch Series 9
- ✔ Apple Watch Series 8
- ✔ Apple Watch Series 7
- ✔ Apple Watch Series 6
- ✔ Apple Watch Series SE
- ✔ Apple Watch Series 5
- ✔ Apple Watch Series 4
- ✔ Apple Watch Series 3
- ✔ Apple Watch Series 2
- ✔ Apple Watch Series 1
- ✘ Other brand watches



For Tablet

10W Max

- ✔ iPad with Type-C charging port
- ✔ Other brands tablet with Type-C charging port

Other tablets:
Suitable for all types of tablets
(Type-C charging cable)

Avoid thick phone case(>5mm)



Multi-layer like Otterbox defender series, Popsockets, Cardholder, Meralllic etc.

A detailed compatibility chart illustrating various compatible devices, including specific iPhone, Samsung Galaxy, Apple Watch, and AirPods models. It also highlights the maximum charging wattage for each device type and notes to avoid phone cases thicker than 5mm.

2. Smart Charging & Safety Features

The built-in smart charging chip automatically adjusts power output for optimal performance. The station includes multiple safety features such as overcurrent, overvoltage, and short circuit protection to ensure the safety of your devices during charging.

Maintenance

To ensure the longevity and optimal performance of your RFVUC 6-in-1 Wireless Charging Station, follow these simple maintenance guidelines:

- **Cleaning:** Disconnect the power before cleaning. Use a soft, dry cloth to wipe down the surface. Avoid using abrasive cleaners, solvents, or harsh chemicals.
- **Placement:** Place the charging station on a stable, flat surface away from direct sunlight, excessive heat, or moisture.
- **Cable Care:** Avoid bending or crimping the charging cable excessively, as this can damage the internal wires.

Troubleshooting

If you encounter any issues with your charging station, please refer to the following common problems and solutions:

- **Device not charging:**
 - Ensure the device is properly aligned on the charging pad.
 - Check if your phone case is thicker than 5mm, as this can interfere with wireless charging.
 - Verify that the charging station is securely plugged into a working power outlet.
 - Remove any metal objects or foreign materials between the device and the charging pad.
- **Clock display is off or dim:**
 - Long press the 'Set Key' to turn the clock display on.
 - Short press the 'Set Key' to adjust brightness levels.
- **Charging is intermittent or slow:**
 - Ensure you are using the original 30W charging adapter and Type-C cable provided.
 - Avoid charging too many devices simultaneously if experiencing slow charging.
 - Check for proper device alignment on the charging pads.
- **Station randomly resets:**
 - Ensure a stable power supply. Avoid connecting to overloaded power strips.
 - If the issue persists, try unplugging and re-plugging the power cable.

Specifications

Feature	Specification
Model Number	Y21
Package Dimensions	8.74 x 5.12 x 2.32 inches
Item Weight	1.26 pounds
Connectivity Technology	USB
Connector Type	USB Type C
Input Voltage	9 Volts
Total USB Ports	2
Wattage	30W
Special Feature	Travel, Multi Device Charging, Fast Charging, Wireless Charging

Warranty and Support

For warranty information or technical support, please refer to the contact details provided on the product packaging or visit the official RFVUC website. Keep your purchase receipt for warranty claims.

