



Manuals.plus /

› Huhomco /

› Huhomco Cordless 200Bar/2900PSI High Pressure Washer Model 6005 Instruction Manual

Huhomco 6005

Huhomco Cordless High Pressure Washer Instruction Manual

Model: 6005 | Brand: Huhomco

1. IMPORTANT SAFETY INSTRUCTIONS

Please read and understand all safety warnings and instructions before operating this product. Failure to follow the warnings and instructions may result in electric shock, fire, and/or serious injury.

- Always wear appropriate personal protective equipment, including eye protection, when operating the pressure washer.
- Do not direct the water stream at people, pets, or electrical devices. The high pressure can cause injury.
- Ensure all connections are secure before operation to prevent leaks and maintain pressure.
- Keep the work area clear of obstructions and ensure stable footing.
- Do not operate the pressure washer in explosive atmospheres, such as in the presence of flammable liquids, gases, or dust.
- Store the pressure washer in a dry, secure location, out of reach of children.
- This device is compatible with Makita batteries. Ensure you use compatible batteries and chargers. (Note: Battery not included with purchase).

2. PRODUCT OVERVIEW

The Huhomco Cordless High Pressure Washer is designed for portable and efficient cleaning tasks. It features a powerful brushless motor, adjustable pressure settings, and a versatile nozzle for various applications.

2.1 Components

- Pressure Washer Unit
- 6-in-1 Multi-function Nozzle
- Water Inlet Hose with Filter Basket
- Foam Pot (Soap Dispenser)
- Quick Connector
- Charger (if included with specific package)
- Carrying Case



Image: Overview of the Huhomco Cordless High Pressure Washer and its included accessories, such as the main unit, batteries, charger, hose, foam pot, and carrying case.

2.2 Key Features

- **Powerful Performance:** Max 2900 PSI / 200 Bar pressure for effective cleaning.
- **Brushless Motor:** Upgraded 3820 brushless motor for enhanced power and durability.
- **3-Gear Speed Adjustment:** Allows precise control over water flow and pressure (0-100 BAR, 100-150 BAR, 150-200 BAR).
- **6-in-1 Nozzle:** Offers multiple spray patterns for various cleaning tasks.
- **Cordless Design:** Portable and compatible with Makita batteries (battery not included).
- **Portable Storage:** Comes with a carrying case for convenient transport and organization.



Image: Illustration highlighting the powerful copper brushless motor and its capability to deliver 2900 PSI pressure.

3. SETUP INSTRUCTIONS

Follow these steps to assemble and prepare your pressure washer for use.

1. **Install Water Filter:** Attach the water filter to the end of the water pipe. This prevents debris from entering the pump.
2. **Connect Converter Head:** Securely install the converter head onto the water pipe.
3. **Insert Battery:** Slide a compatible Makita battery into the battery slot on the pressure washer unit until it clicks into place. Ensure it is fully seated.
4. **Connect Water Hose:** Attach the water hose with the quick connector to the water inlet on the pressure washer unit. Ensure a tight and secure fit.
5. **Attach Sprinkler/Nozzle:** Connect the 6-in-1 multi-function nozzle to the spray wand. Rotate to lock it in position.
6. **Submerge Filter:** Place the water filter end of the hose into a water source (e.g., bucket, pool, or stream). Ensure the filter is fully submerged.

Better Quality Longer Water Pipe and High Quality Filter Basket



Image: A visual guide demonstrating the six steps for assembling the pressure washer, from attaching the water filter to completing the installation.



Image: Close-up of the water pipe featuring a high-quality filter basket designed to prevent debris from entering the system, suitable for various water sources.

4. OPERATING INSTRUCTIONS

Once assembled, follow these steps to operate your pressure washer.

4.1 Powering On and Priming

1. Ensure the water filter is submerged in your water source.
2. Press and hold the trigger on the pressure washer handle. The unit will start to draw water.
3. Allow the unit to run for a few seconds until a steady stream of water emerges from the nozzle, indicating it is

primed.

4.2 Adjusting Pressure (3 Gears)

The pressure washer features three adjustable speed/pressure gears. Use the control panel on the unit to select the desired setting:

- **Gear 1:** 0-100 BAR (Lower pressure for delicate surfaces or light rinsing).
- **Gear 2:** 100-150 BAR (Medium pressure for general cleaning).
- **Gear 3:** 150-200 BAR (Highest pressure for stubborn dirt and heavy-duty cleaning).

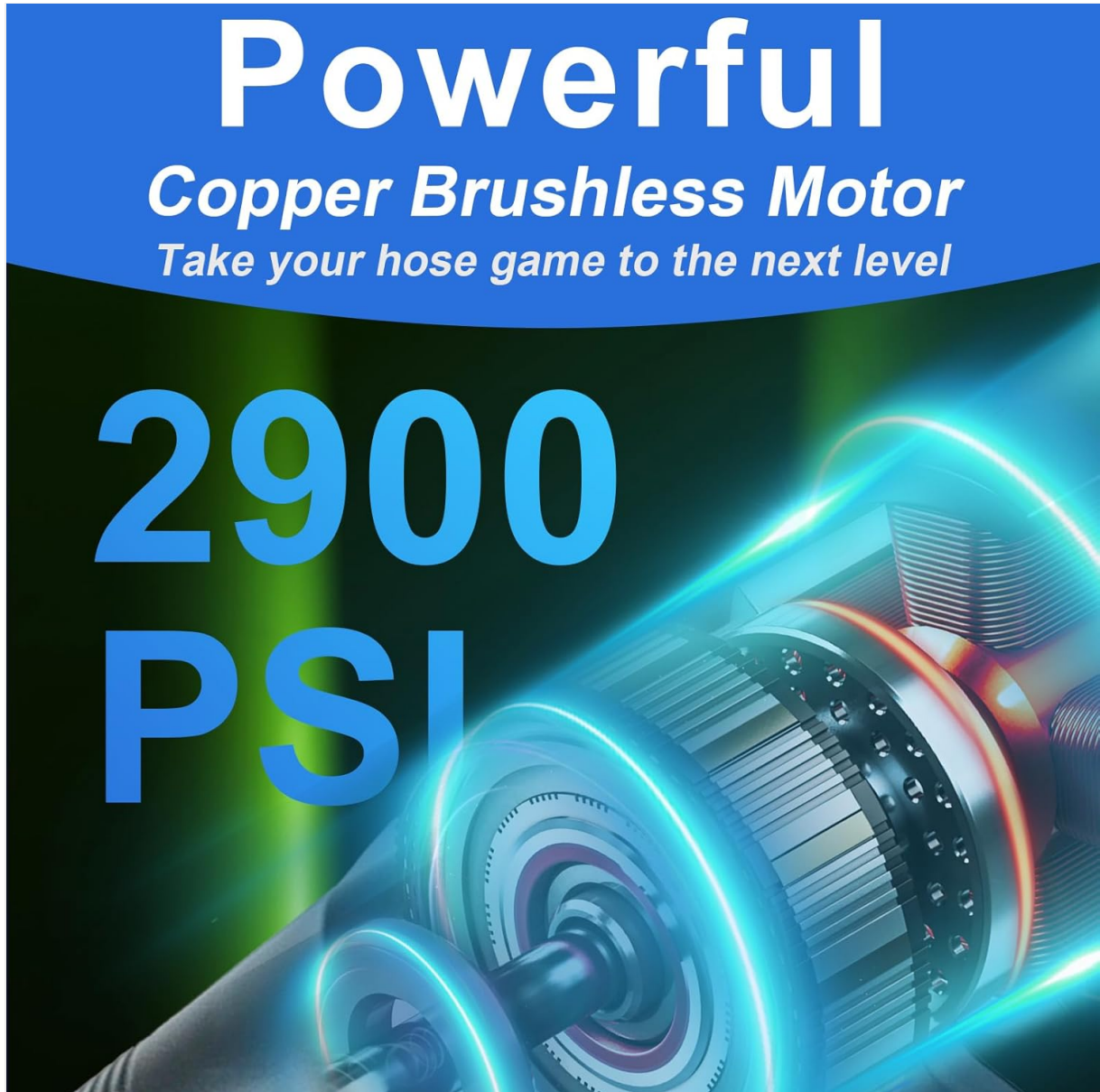

Image: The pressure washer in use, demonstrating the 3-gear speed adjustment feature on the control panel, allowing users to select between 100 BAR, 150 BAR, and 200 BAR settings.

4.3 Using the 6-in-1 Nozzle

The multi-function nozzle allows you to quickly switch between different spray patterns by rotating the nozzle head.

- **0° Jet:** Concentrated, high-impact stream for tough spots.
- **15° Fan:** Narrow fan spray for focused cleaning.
- **25° Fan:** Medium fan spray for general cleaning.
- **40° Fan:** Wide fan spray for rinsing and delicate surfaces.
- **Foam:** For applying soap or detergent using the foam pot.
- **Shower:** Gentle spray for watering plants or light rinsing.

3 Gears Speed Adjustable



Image: Visual representation of the 6-in-1 nozzle, illustrating how rotating the head allows selection of different spray patterns including 0°, 15°, 25°, 40° jets, foam, and shower modes.

4.4 Applications

This pressure washer is suitable for a variety of cleaning and watering tasks:

- Car washing and detailing.
- Cleaning patios, decks, and outdoor furniture.
- Washing garden tools and equipment.
- Watering plants and gardens (using the shower mode).
- Light household cleaning tasks.



Image: A collage showing the pressure washer being used for diverse tasks such as washing a car, cleaning vegetables, spraying a patio, bathing a dog, watering a garden, and cleaning a swimming pool.

5. MAINTENANCE

Regular maintenance ensures optimal performance and extends the lifespan of your pressure washer.

5.1 Cleaning the Water Filter

Periodically inspect and clean the water filter basket to remove any accumulated debris. A clogged filter can reduce water flow and pressure.

- Disconnect the water hose from the unit.
- Remove the filter basket from the end of the hose.
- Rinse the filter thoroughly under running water.
- Reattach the clean filter securely before next use.

5.2 Battery Care

Proper battery care is essential for performance and longevity.

- **Charging:** Charge batteries fully before first use and after each use. Charging time is approximately 2-3 hours for a 4000mAh battery.
- **Working Time:** A fully charged 4000mAh battery provides approximately 45 minutes of working time, depending on pressure setting and usage.
- **Storage:** Store batteries in a cool, dry place away from direct sunlight and extreme temperatures.
- **Compatibility:** This unit is compatible with Makita batteries. Ensure you use genuine or compatible batteries and chargers.

4000mAh Per battery

45
mins

Working time

2-3
hours

Charging time

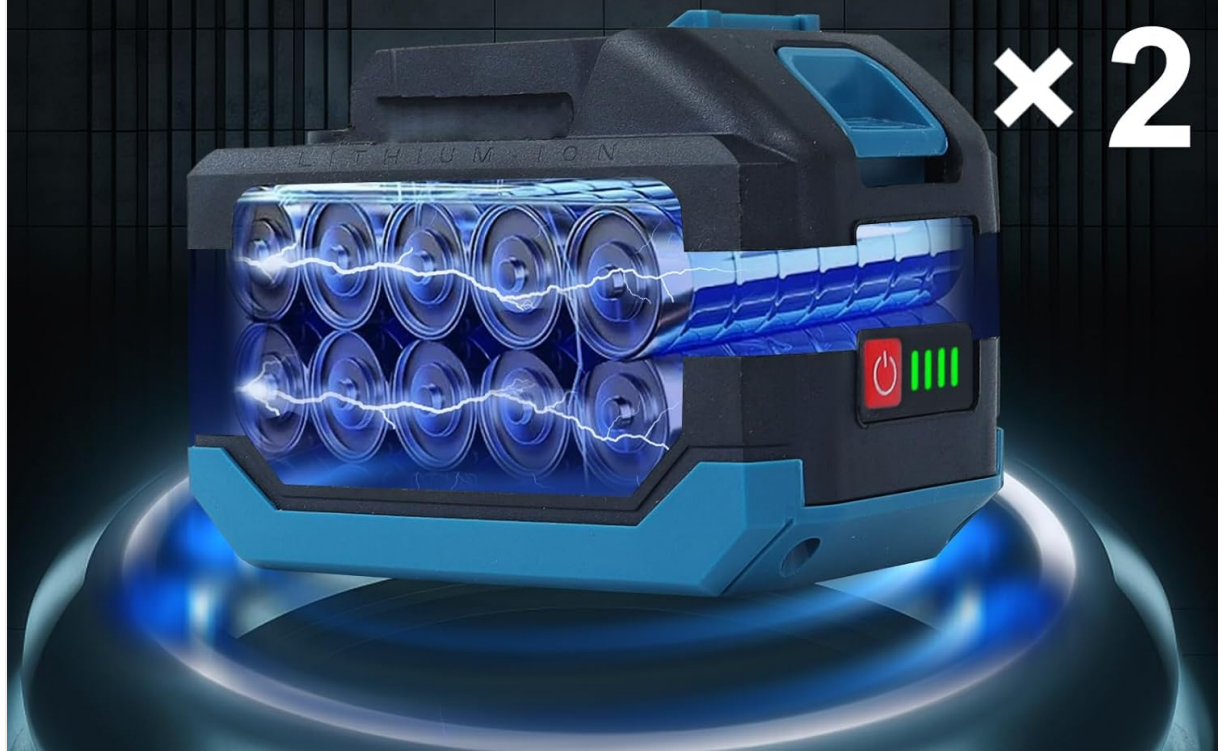

Image: An illustration detailing the specifications of a 4000mAh battery, indicating a working time of 45 minutes and a charging time of 2-3 hours.

5.3 Storage

After use, disconnect all components, drain any remaining water, and store the unit in its carrying case in a dry, protected area.

Portable & Better Storage with a Suicase



Huhomco

- ✓ Neat
- ✓ Lightweight

✓ More Convenient you just need to put all the accessories in randomly and zip it up.



Others

- ✗ Confusion
- ✗ Poor Packaging

✗ More Trouble, you can't close it unless all the accessories are placed in their original positions.





Image: The pressure washer and its accessories neatly packed into a portable carrying case, demonstrating efficient and organized storage.

6. TROUBLESHOOTING

Refer to this section for common issues and their solutions.

Problem	Possible Cause	Solution
No water flow or low pressure	<ul style="list-style-type: none"> • Water filter clogged • Insufficient water supply • Air in the pump (not primed) • Loose hose connections 	<ul style="list-style-type: none"> • Clean the water filter. • Ensure water source is adequate and filter is fully submerged. • Prime the pump by holding the trigger until a steady stream emerges. • Check and tighten all hose connections.
Unit does not start	<ul style="list-style-type: none"> • Battery not charged • Battery not properly inserted • Faulty battery or unit 	<ul style="list-style-type: none"> • Charge the battery fully. • Ensure the battery is securely clicked into place. • Test with a different charged battery if available. Contact support if issue persists.
Water leaks from connections	<ul style="list-style-type: none"> • Loose connections • Worn O-rings 	<ul style="list-style-type: none"> • Tighten all connections. • Inspect O-rings for damage and replace if necessary.

7. SPECIFICATIONS

Feature	Specification
Brand	Huhomco
Model Number	6005
Maximum Pressure	200 Bar / 2900 PSI
Motor Type	3820 Brushless Motor
Power Source	Battery Powered (Compatible with Makita batteries)
Speed Settings	3 Gears (0-100 BAR, 100-150 BAR, 150-200 BAR)
Nozzle Type	6-in-1 Multi-function Nozzle
Maximum Spray Distance	8 Meters
Product Dimensions	25.91 x 5.99 x 20.83 cm
Item Weight	907.18 g
Color	Gray

8. WARRANTY AND SUPPORT

For warranty information or technical support, please refer to the documentation provided with your purchase or contact Huhomco customer service. Keep your purchase receipt as proof of purchase.