

JALL PH-03

JALL 10.5-inch Large Digital Wall Clock (Model PH-03) Instruction Manual

1. INTRODUCTION

Thank you for purchasing the JALL 10.5-inch Large Digital Wall Clock, Model PH-03. This clock features a large LED display, multiple color modes, alarm functions, automatic Daylight Saving Time (DST) adjustment, and temperature display. Designed for clear readability from a distance, it is suitable for various environments including homes, offices, and classrooms.



Friendly for the elderly

The font is so big that the elderly can read it far away clearly.

The large display ensures clear readability for all users, even from a distance.

2. SAFETY INFORMATION

- This device is **NOT battery operated** for its main functions. It requires continuous power from the included 5V/2A power adapter and 6.5 feet cable cord.
- A CR2032 memory battery is included internally to retain settings during power outages, but it does not power the LED display.
- Ensure the power adapter is connected to a suitable power outlet.

- Do not expose the clock to water or excessive moisture.
- Avoid disassembling the device; refer to qualified personnel for repairs.

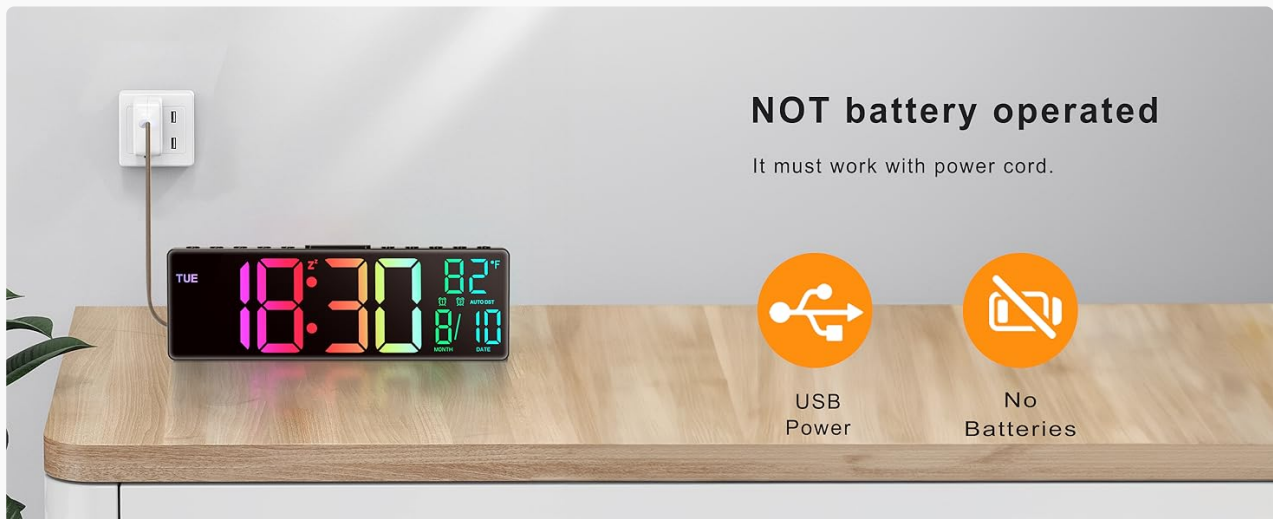

The clock requires continuous power via the included USB cable and adapter.

3. PACKAGE CONTENTS

Please check the package for the following items:

- JALL 10.5-inch Digital Wall Clock (Model PH-03)
- Remote Control
- 5V/2A Power Adapter
- 6.5 feet USB Power Cable
- Mounting Hardware (screws, wall anchors)
- User Manual (this document)

4. PRODUCT FEATURES

- **Large LED Display:** 10.5-inch screen with clear, large numbers for easy viewing.
- **Multiple Color Modes:** Choose from 8 different display colors, including pure colors and dynamic RGB color-changing options.
- **Automatic DST:** Automatically adjusts for Daylight Saving Time in March and November.
- **Auto Brightness:** Built-in light sensor adjusts display brightness for optimal viewing comfort. Manual brightness adjustment is also available.
- **Warm Night Light:** Features a back surround night light with adjustable brightness levels to create a soft ambiance.
- **Alarm Function:** Includes alarm capabilities.
- **Temperature Display:** Shows temperature in Celsius or Fahrenheit.

- **Countdown Timer:** Integrated countdown function for various activities.
- **Versatile Mounting:** Can be placed on a tabletop using its stand or mounted on a wall.

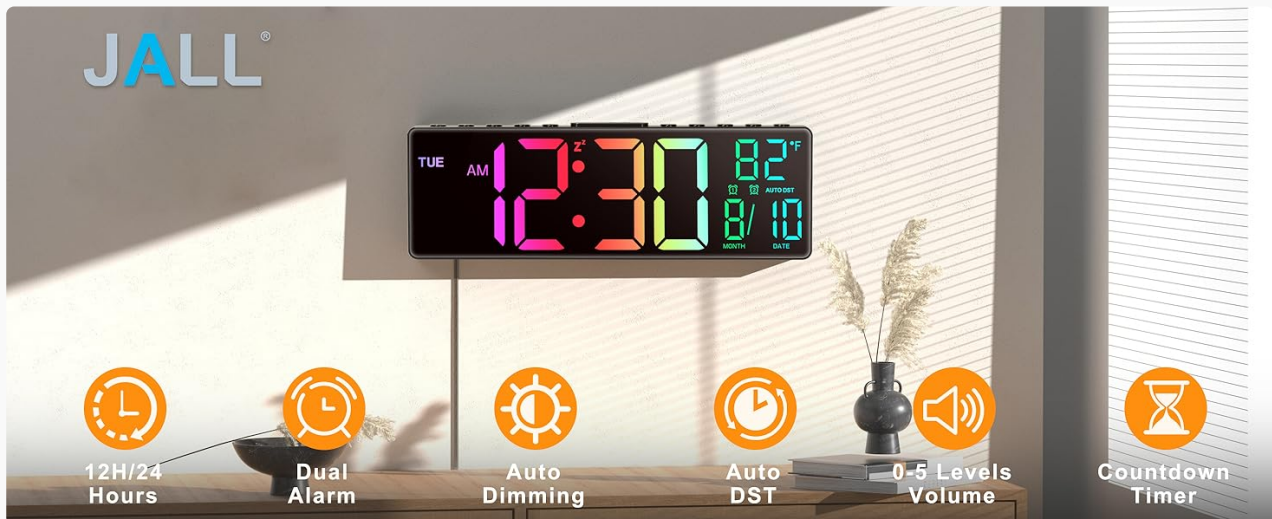

Overview of the clock's main features and display elements.

10.5" Large & Clear Display

Clearly to see the time from any angle

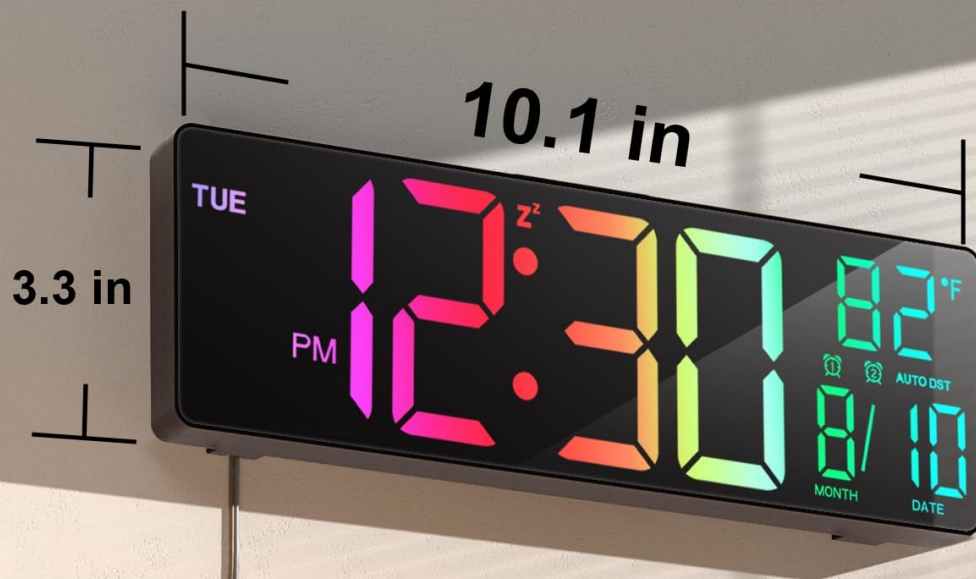

Up to 7" time display

Suitable for old people and children

Physical dimensions of the JALL digital clock.

5. SETUP GUIDE

5.1 Power Connection

1. Connect the provided USB power cable to the DC 5V-2A input port on the back of the clock.
2. Plug the other end of the USB cable into the included 5V/2A power adapter.
3. Insert the power adapter into a standard electrical wall outlet. The clock display will illuminate.

5.2 Mounting Options

The clock can be used on a tabletop or mounted on a wall.

- **Tabletop Placement:** Simply place the clock on a flat, stable surface.
- **Wall Mounting:**
 - a. Identify the hanging holes on the back of the clock.
 - b. Use the included paper hanging assistant (if provided) or measure the distance between the hanging holes.
 - c. Mark the desired wall location for the screws.
 - d. Drill pilot holes, insert wall anchors (if necessary), and screw in the mounting screws, leaving a small portion exposed.
 - e. Carefully align the clock's hanging holes with the screws and slide the clock into place.

Preset Backup Battery

No worry to reset for power outage

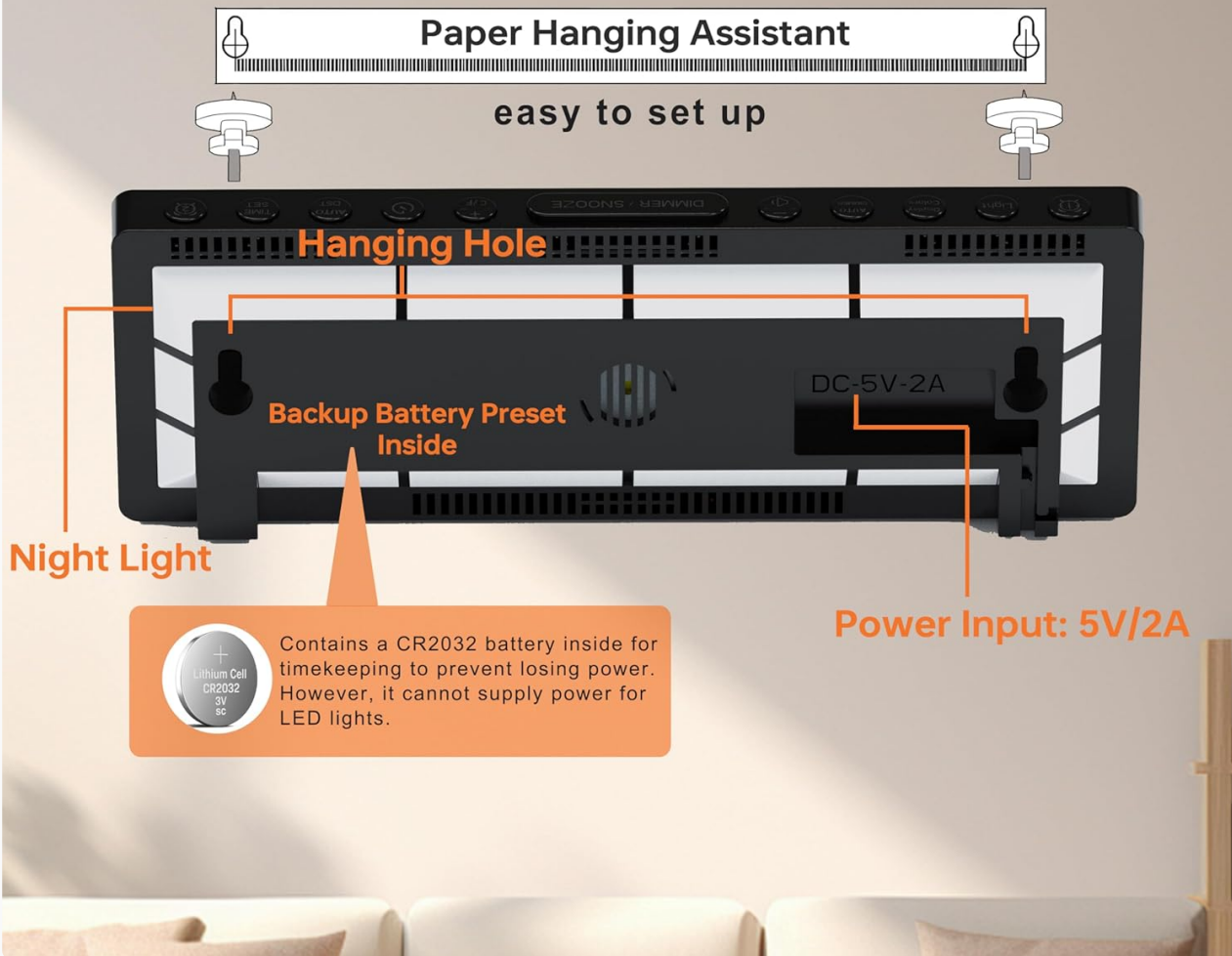

Back of the clock showing power input, hanging holes, and the internal memory battery.

6. OPERATION GUIDE

All functions are primarily controlled using the included remote control.

6.1 Basic Controls (Remote)

Refer to the remote control's button layout for specific functions. Common buttons include:

- **SET:** Enter/confirm settings.
- **UP/DOWN Arrows:** Adjust values or navigate menus.
- **MODE:** Cycle through display modes or settings.
- **ALARM:** Access alarm settings.
- **COLOR:** Change display colors.
- **BRIGHTNESS/DIMMER:** Adjust display brightness.

- **DST:** Manually enable/disable DST (if not automatic).
- **TIMER:** Activate countdown timer.

6.2 Setting Time and Date

1. Press the **SET** button on the remote. The hour digits will flash.
2. Use the **UP/DOWN** arrows to adjust the hour.
3. Press **SET** again to move to minutes, then adjust.
4. Continue pressing **SET** to cycle through year, month, day, and weekday settings, adjusting each with the **UP/DOWN** arrows.
5. Press **SET** one last time to confirm all settings.

6.3 Alarm Settings

1. Press the **ALARM** button on the remote.
2. Use **UP/DOWN** arrows to select Alarm 1, 2, or 3 (if multiple alarms are supported).
3. Press **SET** to enter alarm time adjustment.
4. Adjust hour and minute using **UP/DOWN** arrows and **SET**.
5. Follow prompts to set alarm duration, snooze time, and repetition (e.g., daily, weekdays).
6. Press **SET** to confirm and activate the alarm.

6.4 Display Modes and Colors

The clock offers 8 color modes and can display temperature or seconds.

- **Changing Colors:** Press the **COLOR** button on the remote to cycle through the 8 available color modes, including solid colors and RGB changing patterns. You can also use a 'freeze' feature (if available on your remote) to stop on a preferred color.
- **Temperature/Seconds Display:** Use the **MODE** button to toggle between displaying the temperature (C°/F°) or a seconds counter. To change between Celsius and Fahrenheit, locate the dedicated C°/F° button on the remote or cycle through display options.

8

Color Modes Display

pure colors and RGB changing colors optional

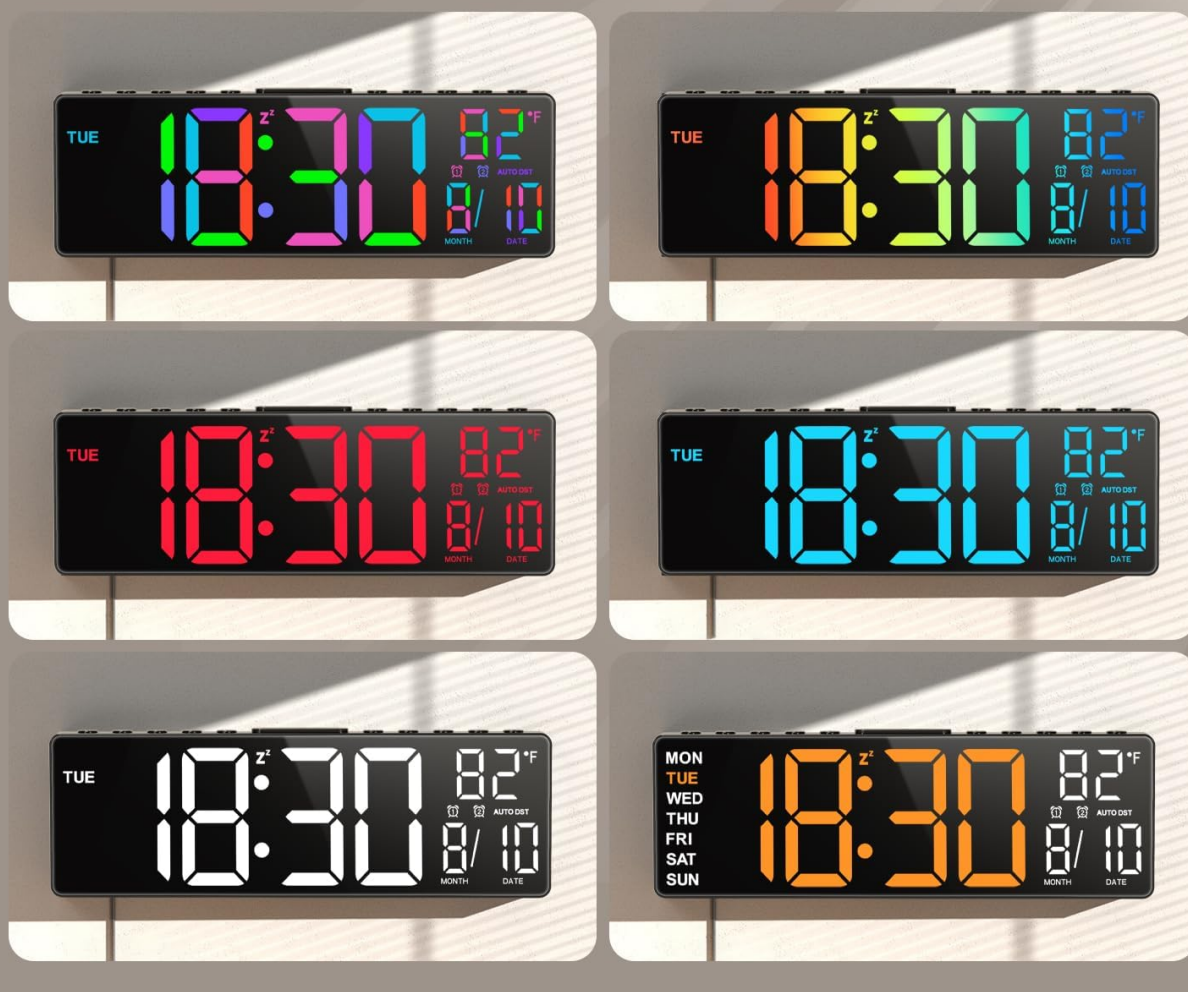

Examples of the 8 color modes available for the clock display.

6.5 Brightness Adjustment

The clock features both automatic and manual brightness control.

- **Auto Dimming:** The built-in light sensor automatically adjusts the display brightness based on ambient light conditions. This feature is designed to protect your eyes and optimize visibility.
- **Manual Adjustment:** Use the **BRIGHTNESS** or **DIMMER** buttons on the remote to manually increase or decrease the display brightness. You may also be able to turn the display off entirely for complete darkness.



Auto Dimming

Auto adjust brightness according to the environment light
to protect your eyes

The auto-dimming feature adjusts display brightness according to ambient light.

6.6 Daylight Saving Time (DST)

The clock is designed to automatically adjust for Daylight Saving Time.

- The clock will automatically change time in March (Spring Forward) and November (Fall Back).
- No manual intervention is typically required for DST adjustments.

Auto DST

No more annoying to change time in spring and autumn.



The clock automatically adjusts for Daylight Saving Time.

6.7 Countdown Timer

The integrated countdown timer can be used for various activities.

1. Press the **TIMER** button on the remote.
2. Use the **UP/DOWN** arrows to set the desired countdown duration (e.g., up to 30 minutes).
3. Press **SET** or **START** (if available) to begin the countdown.
4. An audible alert will sound when the timer reaches zero.

Count-down Timer

Suitable for yoga, gym, office, classroom



The countdown timer function is suitable for various activities.

6.8 Night Light Function

The clock features a back surround night light.

- Press the dedicated **NIGHT LIGHT** button (if available) or cycle through display modes to activate the night light.
- Use the **UP/DOWN** arrows or brightness controls to adjust the 5 brightness levels of the night light.
- This feature provides a warm, ambient glow without being overly bright.

Warm Night Light

5 brightness Level adjustable



The warm night light offers 5 adjustable brightness levels.

7. MAINTENANCE

- To clean the clock, gently wipe the display and casing with a soft, dry, or slightly damp cloth.
- Do not use abrasive cleaners, solvents, or chemical sprays, as these may damage the surface.
- Ensure the clock is unplugged before cleaning.

8. TROUBLESHOOTING

Problem	Possible Cause	Solution
---------	----------------	----------

Problem	Possible Cause	Solution
Clock display is off.	No power supply.	Ensure the power adapter is securely plugged into the clock and a working wall outlet. Check the power cable for damage.
Settings are lost after power outage.	Memory battery depleted or missing.	The internal CR2032 memory battery should retain settings. If not, contact customer support.
Temperature display is inaccurate.	Internal sensor reading clock's own temperature.	The internal temperature sensor may be influenced by the clock's internal components. Consider this a general indicator rather than a precise room temperature. You can switch to seconds display if preferred.
Remote control not working.	Remote battery depleted or obstruction.	Replace the remote control battery. Ensure there is no obstruction between the remote and the clock's sensor.
Auto-dimming not working as expected.	Light sensor obstructed or insufficient ambient light.	Ensure the light sensor on the clock is not covered. In very low light conditions, the auto-dimming may make the display very dim. Adjust manually if needed.

9. TECHNICAL SPECIFICATIONS

Feature	Specification
Brand	JALL
Model Number	PH-03
Display Type	Digital LED
Display Size	10.5 inches
Product Dimensions	10"W x 3.3"H
Power Source	Corded Electric (5V/2A adapter)
Backup Battery	1 CR2032 (for memory retention)
Material	Plastic, Acrylonitrile Butadiene Styrene
Mounting Type	Tabletop or Wall Mount

Feature	Specification
Special Features	Daylight Saving, Alarm, RGB Colors, Auto Brightness, Temperature Display, Countdown Timer, Night Light
Item Weight	15.8 ounces

10. LIMITED WARRANTY

This JALL product comes with a limited warranty. Please refer to the warranty card included in your package or contact customer support for detailed information regarding warranty terms and conditions.

11. CUSTOMER SUPPORT



If you encounter any issues or have questions regarding your JALL 10.5-inch Large Digital Wall Clock, please contact our customer support team:

- **Email:** [Insert Customer Support Email Here]
- **Phone:** [Insert Customer Support Phone Number Here]
- **Website:** [Visit the JALL Store on Amazon](#)

Please have your model number (PH-03) and purchase details ready when contacting support.

© 2025 JALL. All rights reserved.

Related Documents - PH-03

	<p>JALL Digital Wall Clock User Manual</p> <p>User manual for the JALL Digital Wall Clock, providing instructions on installation, setup, features like time and alarm setting, temperature display, screen brightness, night light, countdown timer, volume control, and troubleshooting.</p>
	<p>JALL PH-10 8-in-1 Digital Wall Clock User Manual and Features</p> <p>This user manual provides comprehensive instructions for the JALL PH-10 8-in-1 Digital Wall Clock, covering installation, setup, features like time and alarm setting, temperature display, color options, countdown functions, and troubleshooting.</p>



[Amateur Radio Journal - January 1986: Wireless Institute of Australia](#)

Explore the January 1986 issue of Amateur Radio, the official journal of the Wireless Institute of Australia. This edition features articles on ionosphere variations, RTTY/FAX/CW on Apple computers, Microbee 'Porta-Bee' conversion, Yaesu FRG9600/FRG8800 receivers, WIA 75th Anniversary events, phone patch updates, band planning, and a 75 Ohm High Pass Filter. Essential reading for radio enthusiasts and electronics hobbyists.

lang:en score:24 filesize: 52.07 M page_count: 816 document date: 2020-02-06