

Manuals+

[Q & A](#) | [Deep Search](#) | [Upload](#)

Manuals.plus /

- › [LocoLee](#) /
- › LocoLee LED Light Kit Instruction Manual for LEGO The Cherry Blossom Garden 21260

LocoLee 21260

LocoLee LED Light Kit Instruction Manual for LEGO The Cherry Blossom Garden 21260

Enhance your LEGO building experience with vibrant lighting.

INTRODUCTION

This instruction manual provides detailed guidance for installing and operating your LocoLee LED Light Kit, specifically designed for the LEGO The Cherry Blossom Garden 21260 building set. This kit is intended to illuminate your existing LEGO model, bringing it to life with enhanced visual effects. **Please note: The LEGO building set itself is not included with this light kit and must be purchased separately or already owned.**

Creative Light Kit Accessories Specially Designed for Your LEGO The Cherry Blossom Garden 21260



Image: The LocoLee LED Light Kit integrated into the LEGO Cherry Blossom Garden 21260 model, showcasing the illuminated details. This image demonstrates the final appearance after successful installation.

WHAT'S IN THE BOX

Before beginning installation, please verify that all components listed below are present in your package. If any items are missing or damaged, please contact customer support.

- LED Light Kit components (various lights and connecting wires)
- Instruction Manual (online video/PDF instructions are primary)
- Expansion Board (quantity may vary, typically 1 or more)
- Power Supply (e.g., battery box or USB power cable)

LED Light Make Legos Glow **NO LEGOS** What Package Included?

1. LED Light Kit

2. Instruction

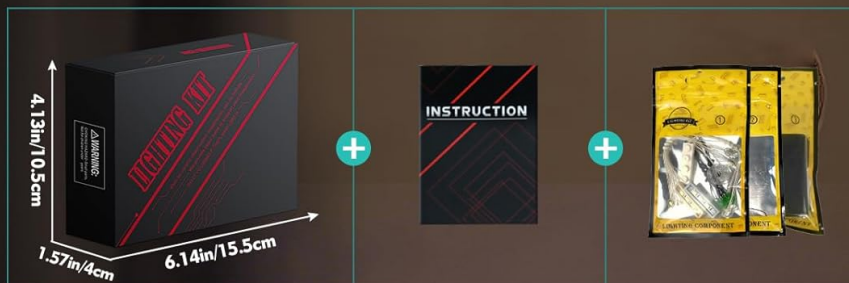

💡 Lights



Image: A visual representation of the package contents, showing the light kit box, a small instruction booklet, and sealed bags containing the LED components. The LEGO model is explicitly not included.

Package List (NO LEGOS)

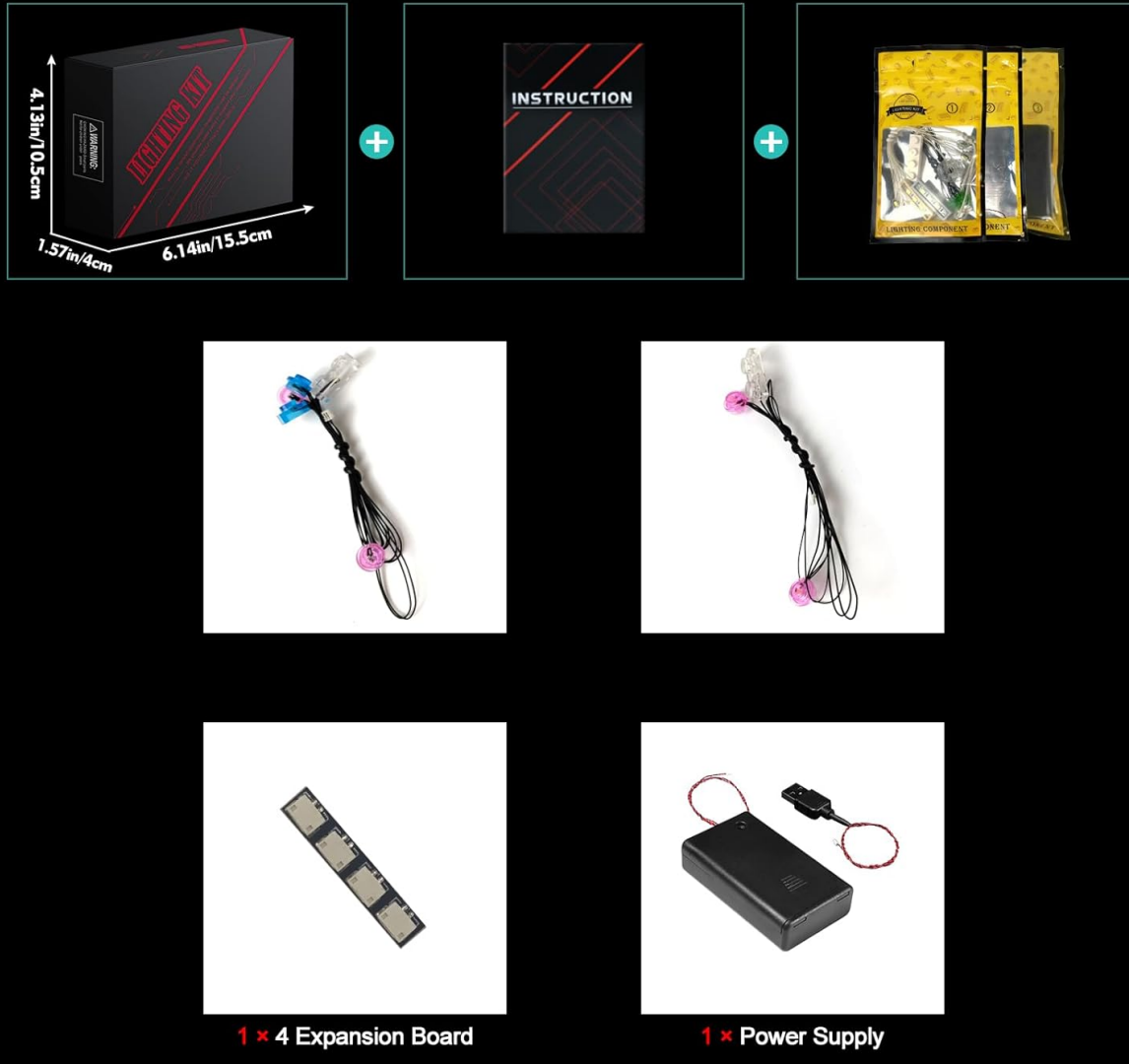

Image: Close-up of the light kit components, displaying various LED light strings, an expansion board, and a power supply unit (battery box). These are the essential parts for illuminating your LEGO model.

SETUP AND INSTALLATION

The installation process involves carefully integrating the LED lights into your LEGO The Cherry Blossom Garden 21260 model. Detailed step-by-step video and PDF instructions are available online. These instructions are numbered and guide you through disassembling specific LEGO bricks to place the light fixtures.

1. **Access Online Instructions:** Refer to the website address provided in the included booklet or packaging.
2. **Locate Instructions:** Enter the model number (21260) or the LEGO model name ("The Cherry Blossom Garden") on the website to find the specific video or PDF guide.
3. **Follow Step-by-Step Guide:** Watch the video or follow the PDF instructions carefully. The process typically involves removing a few LEGO bricks, placing the LED lights and wires, and then reassembling the bricks.
4. **Handle Wires Carefully:** The light wires are flexible but delicate. Avoid pulling them too hard to prevent damage.
5. **Test Components:** Before fully assembling, it is recommended to test each light part to ensure it

functions correctly.

LED Light Kit Product Features

- 1-Light Effect Unique And Bright
- 2-Light Wires Flexible And Tough
- 3-Plug And Play
- 4-Multi Supply Methods
- 5-Step By Step Video Installation



Voltage less than 5V



Batteries not included

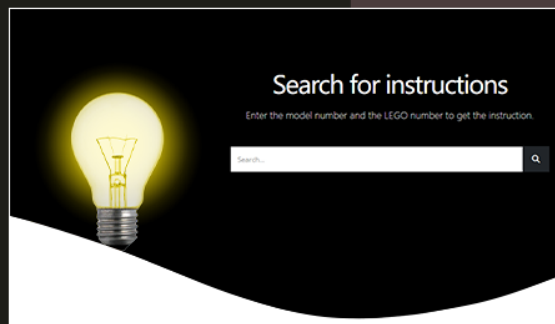

Installation Guide

1. Click the website printed in the booklet
 2. Enter the code behind the packing box or Lego model
 3. Click the picture to watch the video or PDF
- *.No Paper Instruction**

Image: An illustration of the online installation guide portal, indicating where users can search for instructions by model number or name. This is the primary method for accessing detailed setup steps.

OPERATING INSTRUCTIONS

Once the LED light kit is installed, you can power it using one of the following methods:

- **USB Power:** Connect the light kit to a USB power source (e.g., power bank, USB wall adapter, computer USB port). Ensure the voltage is less than 5V. Using USB power generally provides brighter illumination.
- **Battery Power:** If your kit includes a battery box, insert the required AAA batteries (not included) into the battery box and connect it to the light kit.

After connecting the power, the lights should illuminate your LEGO model. No further operation is typically required beyond connecting and disconnecting the power source.

Visual Upgrade Details About Lights

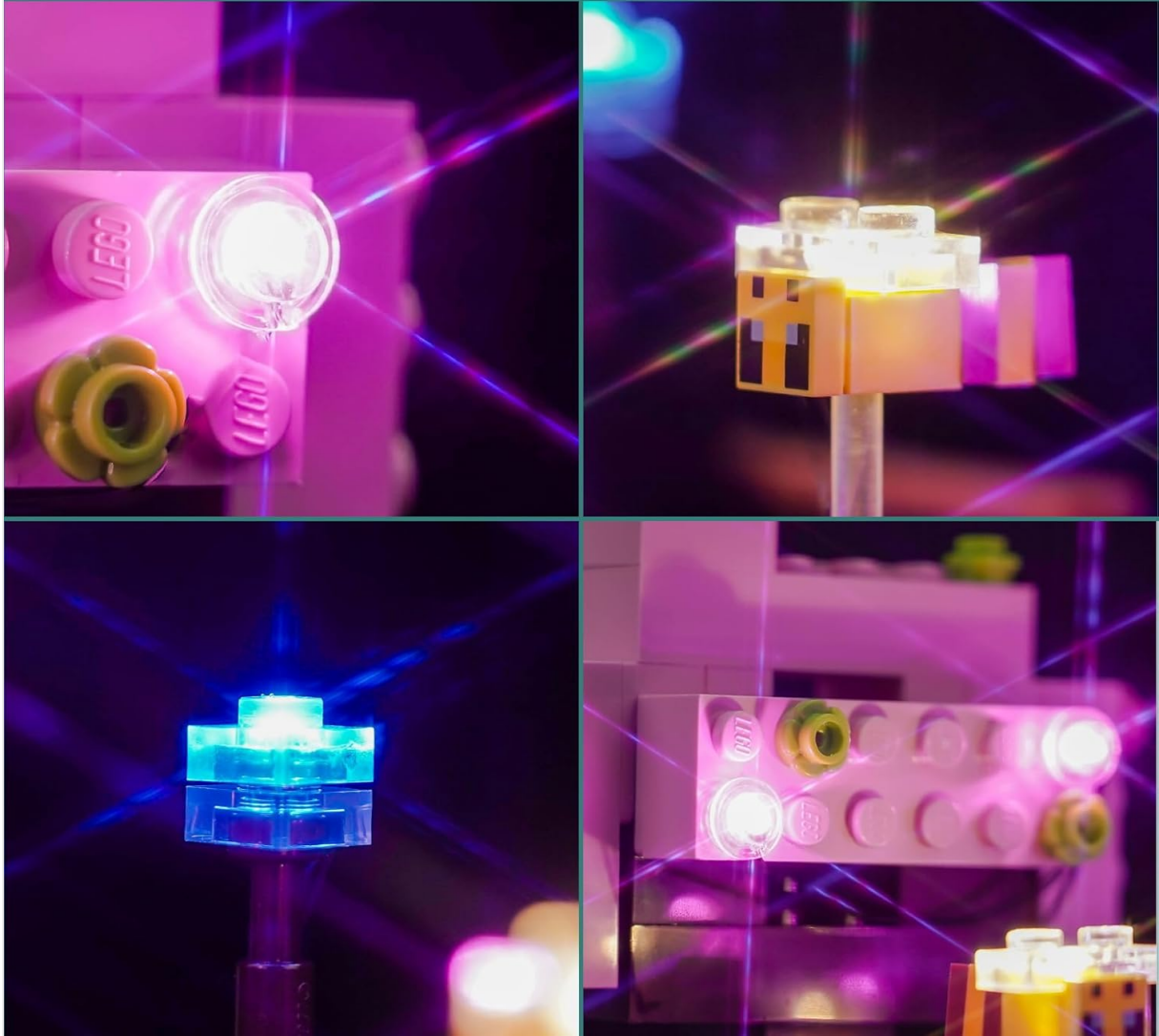

Image: Detailed views of the installed LED lights, highlighting the bright and vivid lighting effects on different parts of the LEGO model, including white and blue lights, and a unique bee-shaped light.

MAINTENANCE

The LocoLee LED Light Kit requires minimal maintenance. Follow these guidelines to ensure longevity:

- **Cleaning:** Gently dust the lights and wires with a soft, dry cloth. Avoid using liquids or abrasive cleaners.
- **Wire Management:** Ensure wires are not pinched or excessively bent, as this can damage the internal conductors.
- **Storage:** If disassembling the kit for storage, carefully disconnect all components and store them in a dry, cool place away from direct sunlight.
- **Power Source:** When not in use for extended periods, disconnect the power source (unplug USB or remove batteries) to prevent unnecessary power drain or potential battery leakage.

TROUBLESHOOTING

Problem	Possible Cause	Solution
---------	----------------	----------

Problem	Possible Cause	Solution
Lights do not turn on.	<ul style="list-style-type: none"> Loose connection. No power or low battery. Damaged wire or LED. 	<ul style="list-style-type: none"> Check all connections to ensure they are secure. If using batteries, replace them. If using USB, try a different USB port or power adapter. Inspect wires for visible damage. If a specific LED is out, it might be faulty.
Lights are dim.	<ul style="list-style-type: none"> Low battery power. Insufficient USB power. 	<ul style="list-style-type: none"> Replace batteries. Ensure USB power source provides adequate current (e.g., a dedicated wall adapter instead of a computer port).
Flickering lights.	<ul style="list-style-type: none"> Loose connection. Intermittent power supply. 	<ul style="list-style-type: none"> Verify all connections are firm. Check power source stability.

If you encounter issues not covered here, please refer to the online installation guide or contact customer support.

SPECIFICATIONS

- **Product Model:** 21260 (Compatible with LEGO The Cherry Blossom Garden)
- **Power Input:** USB (less than 5V) or AAA Batteries (not included)
- **Materials:** High-quality copper lines, ABS plastic
- **Product Dimensions:** 6.04 x 3.97 x 1.26 inches (packaging)
- **Item Weight:** 3.52 ounces
- **Recommended Age:** 16 years and up

WARRANTY AND SUPPORT

LocoLee provides a quality guarantee for this LED light kit. The product is manufactured with high-quality copper lines and ABS plastic, designed to be perfectly hidden within your LEGO blocks.

For any questions or concerns regarding the product, installation, or troubleshooting, please contact LocoLee customer support via email. Refer to the contact information provided in your product packaging or on the official LocoLee website.

Email Support: Please check your product packaging for the specific support email address.