

## Hiseeu US-2WTDK05

# Hiseeu Solar Camera 4MP Wireless Outdoor Security Camera

MODEL: US-2WTDK05

User Manual

## Introduction

This manual provides detailed instructions for the installation, setup, and operation of your Hiseeu 4MP 100% Wireless WiFi Solar Camera. Please read this guide thoroughly to ensure proper use and optimal performance of your device. Keep this manual for future reference.

## What's in the Box

Verify that all components are present in your package:

- Solar Camera x 2
- Solar Panel x 2
- User Manual

## Setup Guide

### 1. Solar Panel Installation

Mount the solar panel in a location that receives direct sunlight for several hours daily to ensure continuous power to the camera. Use the provided screws and mounting base to secure the panel.

Your browser does not support the video tag.

Video: How to install the solar panel. This video demonstrates the steps for securely mounting the solar panel to a wall.



**100% wireless**  
More Convenient to Install

Image: The Hiseeu solar camera and its solar panel mounted on a house wall, highlighting its wireless design for easy installation.

## 2. App Download and Registration

Download the "Eseecloud" app from your device's app store (iOS 9.0 or above, Android 5.0 or above). Register an account using your phone number or email address. Follow the on-screen prompts to complete the registration and setup of your password.

Your browser does not support the video tag.

Video: Eseecloud APP Manual. This video provides a visual guide for navigating the Eseecloud app, including device addition and settings.

## 3. Camera Connection

After powering on the camera, open the Eseecloud app and select "Add smart camera". You can connect the camera via QR code scanning or by connecting it to your router's LAN port using an Ethernet cable for initial setup. Ensure your home WiFi is 2.4GHz (5GHz is not supported) and the WiFi name/password do not contain special characters and are not over 12 characters.

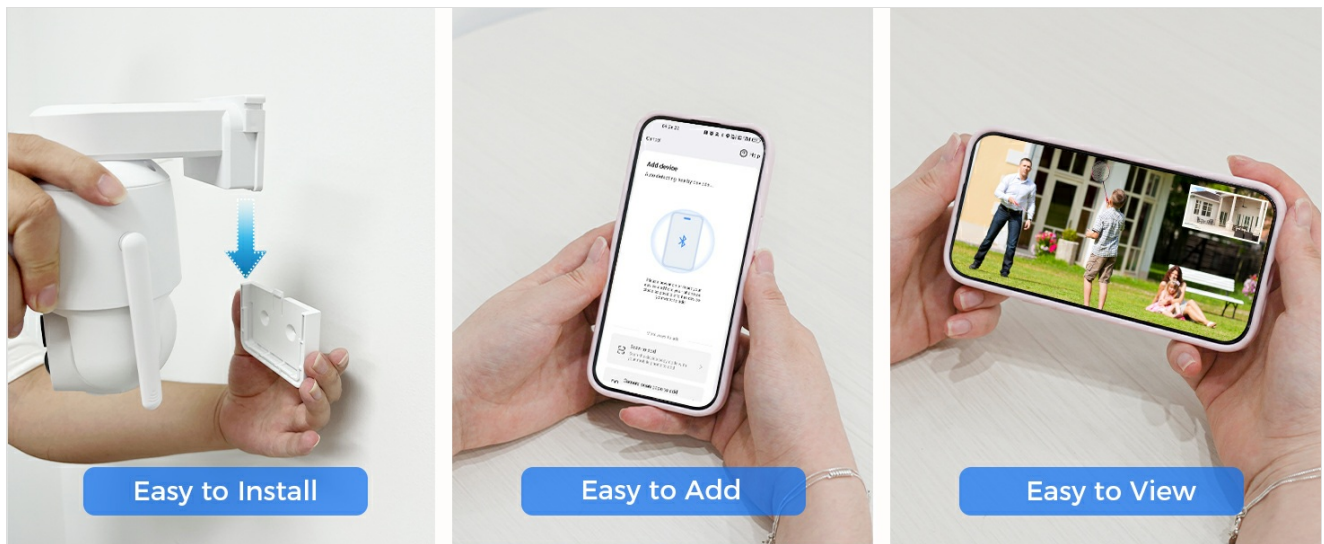

Image: Visual guide demonstrating the ease of installation, adding the device to the app, and viewing the live feed.

## Operating Instructions

### 1. PTZ (Pan, Tilt, Zoom) Control

The camera features 355° pan and 90° tilt capabilities, allowing for comprehensive area coverage. Use the Eseecloud app to remotely adjust the camera's viewing angle. Digital zoom is available by swiping the screen in the app.

# 24 Hours Remote Control

355° rotation and 90° tilt



Image: The camera's pan and tilt range, illustrating its 355° rotation and 90° tilt for wide coverage.

## 2. Night Vision Modes

The camera offers both full-color night vision and infrared night vision. You can select your preferred mode through the app settings. Full-color night vision provides detailed, colored images in low-light conditions, while infrared night vision offers clear black-and-white footage.



# 4MP HD Wireless Camera



## Color Night Vision



## Infrared Night Vision



Image: A side-by-side comparison demonstrating the clarity of color night vision versus infrared night vision.

### 3. Humanoid Detection & Alerts

The camera features advanced humanoid detection to minimize false alarms. When human movement is detected, the app will send an alarm notification to your smartphone. You can customize detection sensitivity and specific monitoring areas within the app.



Image: An illustration of the camera's PIR Humanoid Detection feature, showing an alert on a smartphone.

#### 4. Two-Way Audio

Utilize the built-in microphone and speaker for two-way communication. This allows you to speak with visitors or deter unwanted individuals directly through the camera via the Eseecloud app.

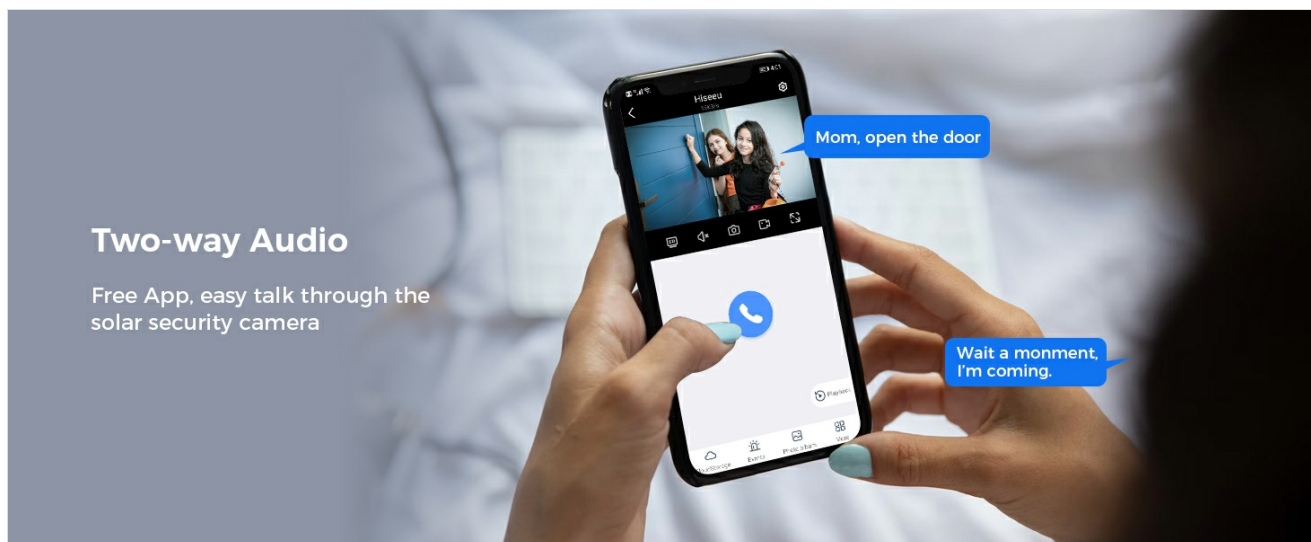

## Two-way Audio

Free App, easy talk through the solar security camera

Image: A visual representation of the two-way audio function through the app.

## 5. Recording & Storage

The camera supports local storage via an SD card (up to 128GB, not included) and optional cloud storage (subscription may apply). Recordings can be stored for approximately 30 days. You can access and review footage through the app's playback feature.

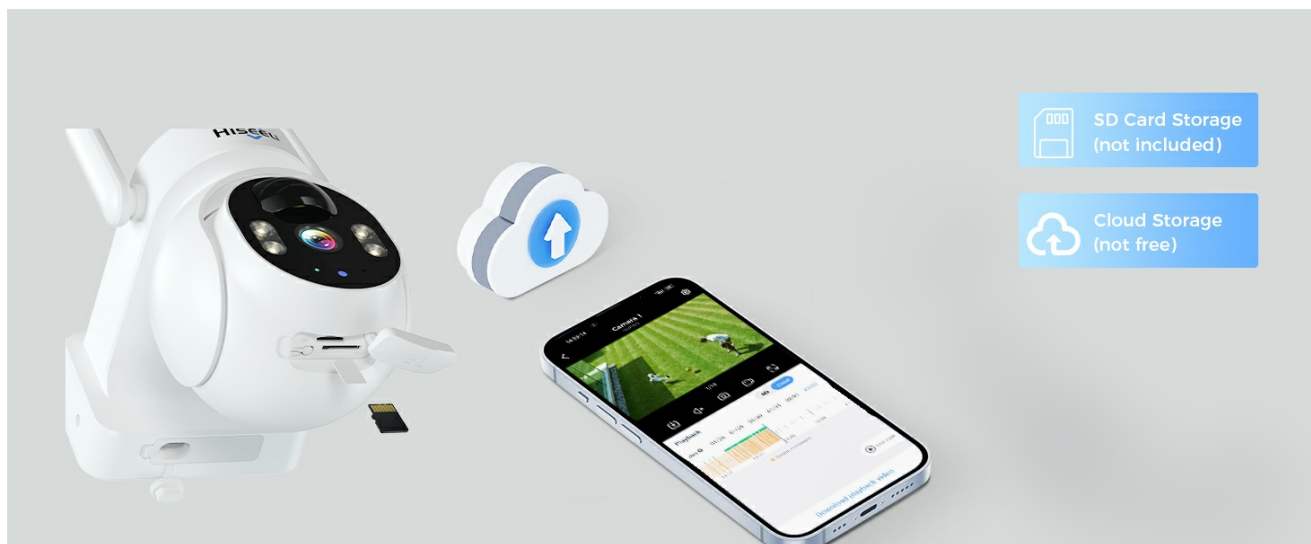

Image: Depiction of SD card and cloud storage options for the camera.

## 6. Siren/Spotlight Alarm

In the event of suspicious activity, you can activate a siren or spotlight alarm directly from the app to deter intruders. The camera can also be configured to trigger these alarms automatically upon detection.



# Siren/Spotlight Alarm

protect your family even at night



Image: The camera's siren and spotlight alarm features in action, providing security at night.

## Maintenance

To ensure optimal performance and longevity of your Hiseeu Solar Camera, consider the following maintenance tips:

- **Solar Panel Cleaning:** Periodically clean the surface of the solar panel to remove dust, dirt, or debris that may obstruct sunlight and reduce charging efficiency. Use a soft, damp cloth.
- **Weather Resistance:** The camera is IP66 waterproof, designed to withstand various weather conditions including rain and snow. However, avoid direct high-pressure water jets.
- **Battery Health:** The solar panel continuously charges the camera's internal battery. Ensure the solar panel is positioned for maximum sun exposure to maintain battery charge.
- **Firmware Updates:** Regularly check the Eseecloud app for available firmware updates to ensure your camera has the latest features and security enhancements.





Image: The camera's ability to withstand various weather conditions, including rain and snow.

## Troubleshooting

If you encounter issues with your Hiseeu Solar Camera, refer to the following common solutions:

- **Camera Not Connecting to WiFi:** Ensure your WiFi network is 2.4GHz. Verify the WiFi password is correct and does not contain special characters or exceed 12 characters. Try restarting your router and the camera.
- **Frequent False Alarms:** Adjust the motion detection sensitivity in the app settings. Define specific detection areas to exclude irrelevant zones like public pathways or moving foliage.
- **Poor Night Vision Quality:** Ensure the camera lens is clean. Check if there are any obstructions blocking the infrared lights or spotlights. Verify the selected night vision mode in the app.
- **Battery Not Charging:** Confirm the solar panel is clean and positioned to receive adequate direct sunlight. Check the connection cable between the solar panel and the camera.
- **No Audio/Poor Two-Way Audio:** Ensure the microphone and speaker settings are enabled in the app. Check your phone's volume settings.

## Specifications

Feature	Detail
Indoor/Outdoor Usage	Outdoor
Power Source	Solar Powered
Connectivity Protocol	Wi-Fi (2.4G)
Video Capture Resolution	4MP
Mounting Type	Wall Mount
Viewing Angle	120 Degrees
Night Vision Range	65 Feet
Water Resistance Level	IP66 Waterproof
Item Dimensions (L x W x H)	18 x 15.99 x 20 inches

Item Weight	7.3 pounds (3.32 Kilograms)
Alert Type	Motion Only (Humanoid Detection)
Control Method	App, Remote
Special Feature	Easy to Install, Two-Way Audio, Color Night Vision, PTZ

## Warranty and Support

Your Hiseeu Solar Camera comes with a 12-month limited warranty, implemented according to local laws and regulations. For any questions or support, the Eseecloud app provides one-on-one 7/24 online support. You can contact customer service directly through the app to resolve any issues.

For additional resources, you may refer to the video on how to add devices to Alexa:

<https://www.amazon.com/vdp/02b7820d64ad4e6a457cf6d8638e830>

**Note:** If you log in to Eseecloud through a third-party software, you cannot use the Eseecloud skill on Alexa. You must register an Eseecloud app account through a phone number or email address. You must name the device, otherwise Alexa will not find it.